

# S6244

08-10 FORD SUPER DUTY, 6.4L  
POWERSTROKE, DIESEL PARTICULATE FILTER  
BACK, EC/CC SB & LB, COOL DUALS™

# MBRP INC.

PERFORMANCE EXHAUST

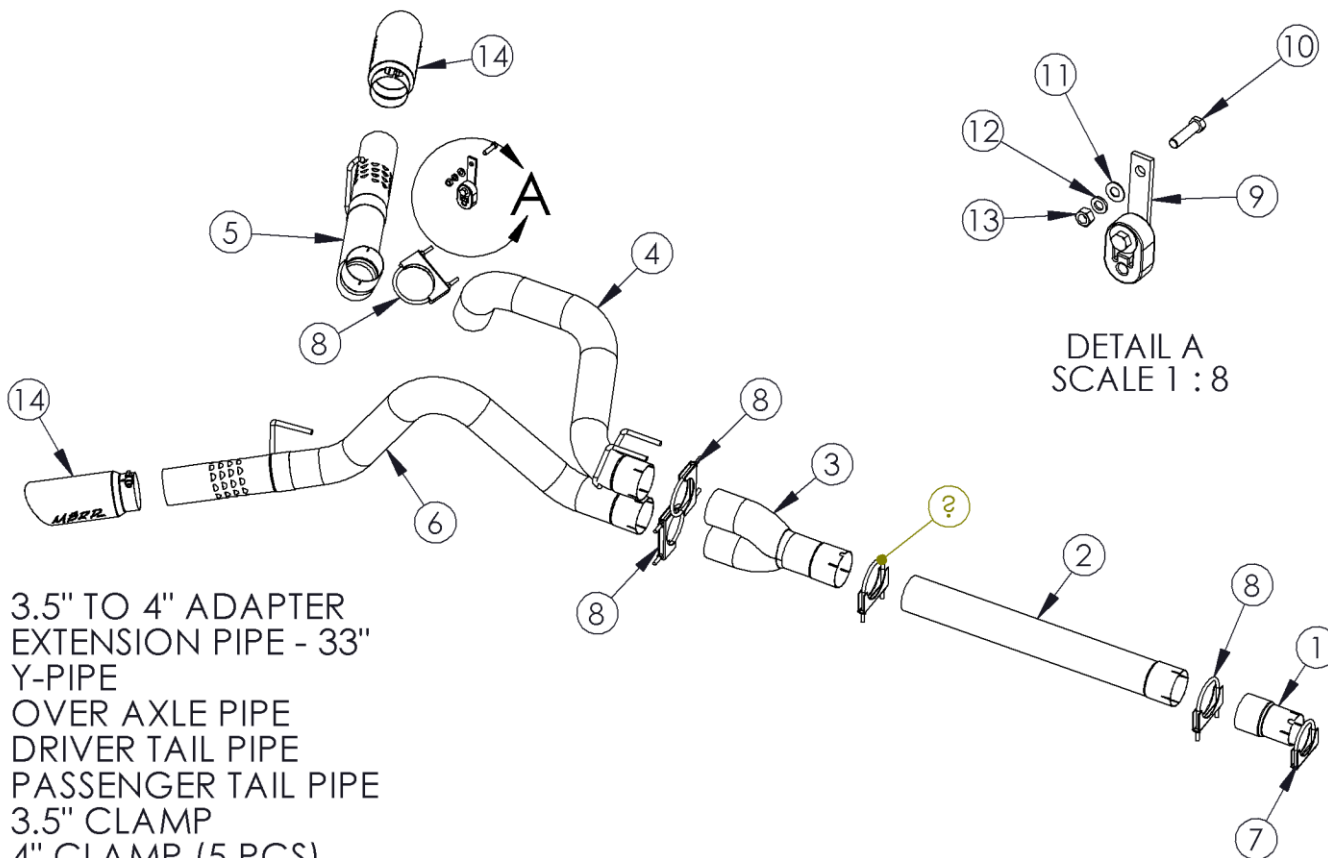

DETAIL A  
SCALE 1 : 8

1. 3.5" TO 4" ADAPTER
2. EXTENSION PIPE - 33"
3. Y-PIPE
4. OVER AXLE PIPE
5. DRIVER TAIL PIPE
6. PASSENGER TAIL PIPE
7. 3.5" CLAMP
8. 4" CLAMP (5 PCS)
9. HANGER ASM
10. 7/16" BOLT
11. 7/16" WASHER
12. 7/16" LOCK WASHER
13. 7/16" NUT
14. EXHAUST TIP (2 PCS)

## PLEASE READ BEFORE STARTING INSTALLATION

While MBRP Inc. has made every effort to ensure that all components of this system are of superior quality and properly packaged it is the installer's responsibility to ensure the following before removal of the factory exhaust:

- that ALL components shown above are present.
- that ALL mating components fit together.
- that there are no damaged components.
- that the system you have purchased is appropriate for your vehicle year, model and configuration.
- that the system will not interfere with any modifications previously installed or planned.
- that you have read and understand these instructions.

If you have any questions or are uncertain about any aspect of the installation of this system to your vehicle please contact your dealer before commencing installation.



**Figure 1**



**Figure 2**



**Figure 3**



**Figure 4**

### Removal of Stock System:

1. Apply penetrating lubricant liberally to all exhaust fasteners, hangers and rubber insulators.
2. Loosen the nut on the band clamp located behind the particulate filter using a 15mm wrench or socket. **Refer to Figure 1.**
3. Remove the muffler and tail pipe from the OEM rubber hangers. Cut exhaust as shown in **Figure 2**. Remove from vehicle.

### Installation of MBRP Inc. Performance Exhaust:

1. Install the **Adaptor** over the particulate filter using the **3.5" Clamp**. Leave the clamp loose until final alignment. **Refer to Figure 3.**
2. The **Extension Pipe** provided is pre-cut for the crew cab long bed configuration. Cut the **Extension Pipe** to length as required. **See Figure 5.** The **Extension Pipe** is not required on a super cab short box (6.5'). Slide a **4" Clamp** over the **Extension Pipe** and install onto the **Adaptor** installed in Step 1. The clamp should remain loose enough for adjustability. **Refer to Figure 4.**

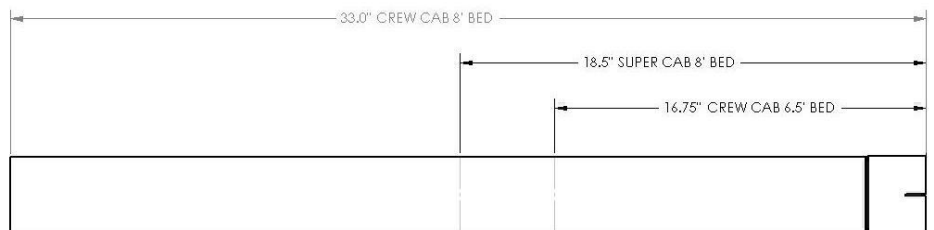

NOT REQUIRED ON SUPER CAB WITH 6.5' BED

**Figure 5**



**Figure 6**



**Figure 7**



**Figure 8**

3. Slide a **4" Clamp** onto **Y-Pipe**. Install the **Y-Pipe** over the **Extension Pipe**. Note: On the super cab 6.5' bed it would be installed to the **Adaptor**.
4. Slide a **4" Clamp** onto the lower outlet of the **Y-Pipe**. Install the **Passenger Side Tail Pipe** from the rear of the truck, over the axle and attach to the lower section of the **Y-Pipe**.
5. Slide a **4" Clamp** onto the upper section of the **Y-Pipe**. Install the **Over Axle Pipe** from the rear of the truck, over the axle and attach to the upper section of the **Y-Pipe**. Install the **Over Axle Pipe** into the OEM hangers, slide Clamps into position but don't tighten.
6. Install the **Hanger Kit** on the driver's side of the vehicle. Refer to **Figure 7**. Slide a **4" Clamp** onto the end **Driver Side Tail Pipe** then attach to the **Over Axle Pipe**. Refer to **Figure 8**.
7. Install and adjust **Exhaust Tips** to suit. Using a 17mm wrench tighten the lock bolt located on each **Exhaust Tip**.
8. Check along the whole length of the exhaust system to ensure that there is adequate clearance around the fuel and brake lines or any wiring. If any interference is detected relocate or adjust.
9. Make sure everything is in place before tightening the clamps. Start at the front of the exhaust system and begin tightening all connections.



**Congratulations!** You are ready to begin experiencing the improved power, sound and driving excitement of your MBRP Inc. performance exhaust system. We are certain that you will enjoy your purchase.