

S6243

2008-10 FORD F250/350/450 6.4L
POWERSTROKE DPF BACK 4"
SINGLE SIDE DUAL OULET

MBRP
INC.
PERFORMANCE EXHAUST

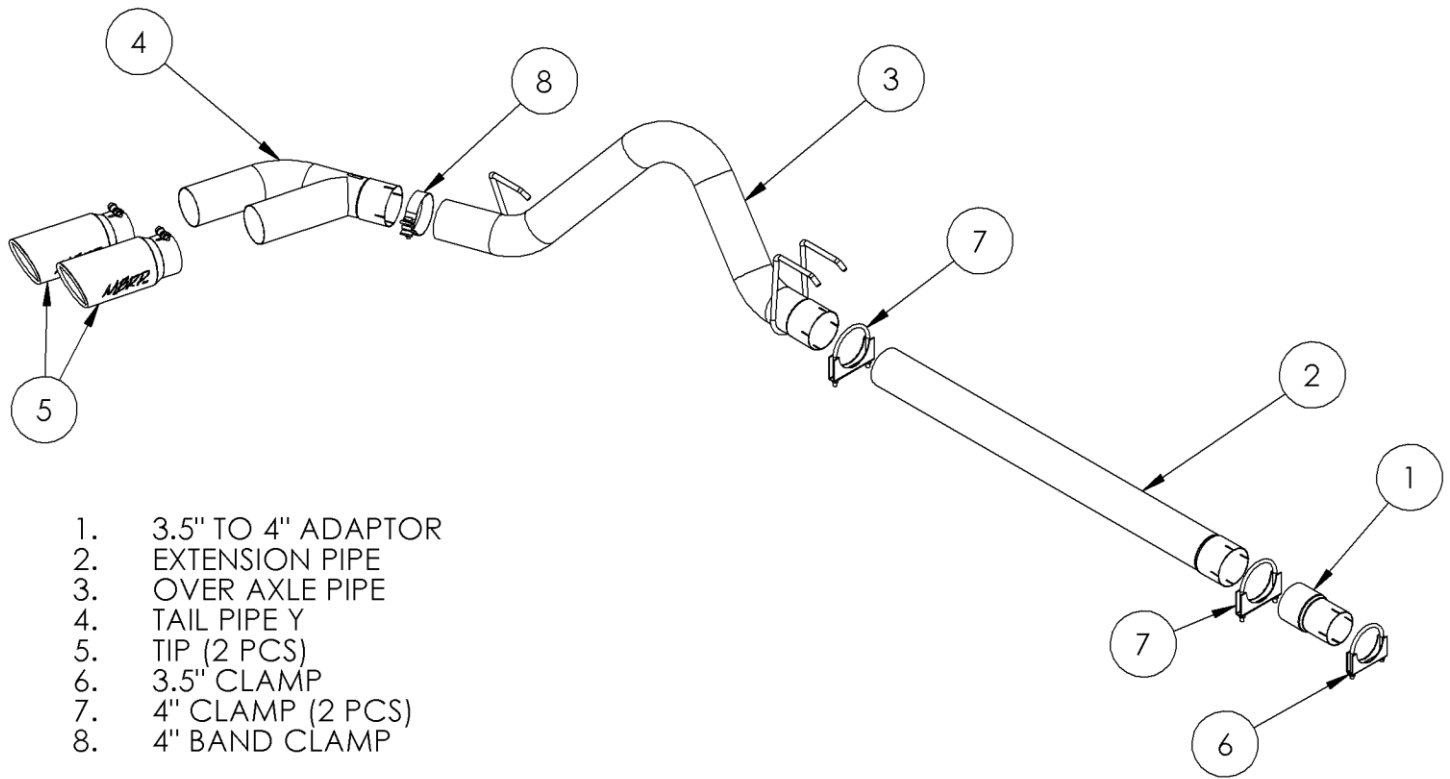

1. 3.5" TO 4" ADAPTOR
2. EXTENSION PIPE
3. OVER AXLE PIPE
4. TAIL PIPE Y
5. TIP (2 PCS)
6. 3.5" CLAMP
7. 4" CLAMP (2 PCS)
8. 4" BAND CLAMP

PLEASE READ BEFORE STARTING INSTALLATION

While MBRP Inc. has made every effort to ensure that all components of this system are of superior quality and properly packaged, it is the installer's responsibility to ensure the following before removal of the factory exhaust:

- that ALL components shown above are present.
- that ALL mating components fit together.
- that there are no damaged components.
- that the system you have purchased is appropriate for your vehicle year, model and configuration.
- that the system will not interfere with any modifications previously installed or planned.
- that you have read and understand these instructions.

If you have any questions or are uncertain about any aspect of the installation of this system to your vehicle please contact your dealer before commencing installation.

Removal of Stock System:



Figure 1

1. Apply some penetrating lubricant liberally to all exhaust fasteners, hangers and rubber insulators.

2. Loosen the nut on the band clamp located behind the particulate filter using a 15mm wrench or socket.

Refer to Figure 1.



Figure 2

3. Cut the exhaust as shown in **Figure 2**. Remove the muffler and tail pipe from the OEM rubber insulators. Remove from the vehicle.

Installation of MBRP Inc. Performance Exhaust:

1. The **Extension Pipe** provided is pre-cut for the crew cab long bed configuration. Cut the **Extension Pipe** to the required length for the vehicle being installed to. **Refer to Figure 3.**

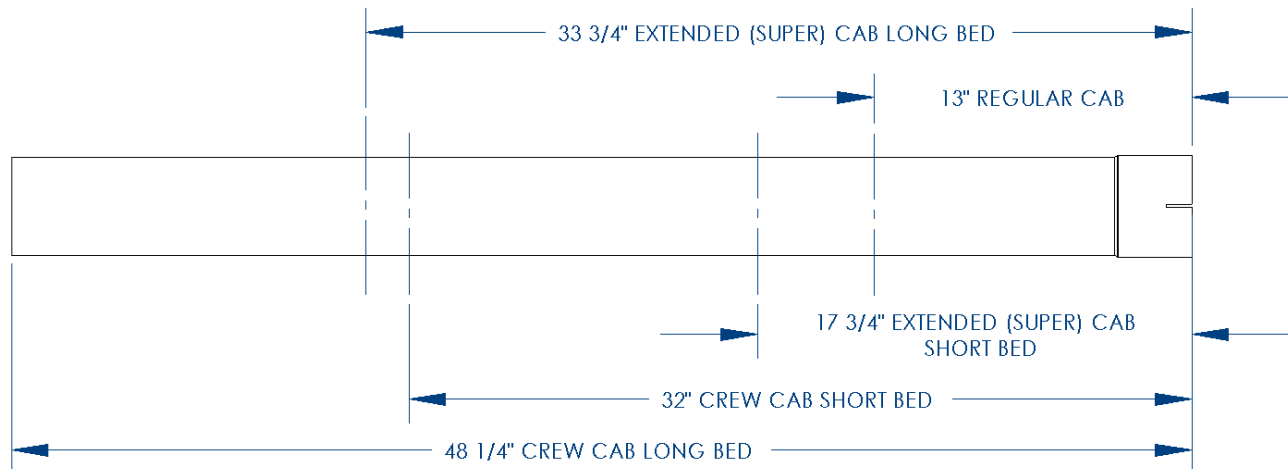

Figure 3



Figure 4

2. Slide the **3.5" Clamp** over the **3.5" to 4" Adapter** and install it to the particulate filter.

Refer to Figure 4.

3. Slide the **4" Clamp** onto the end of the **3.5" to 4" Adapter** install the **Extension Pipe**.

Refer to Figure 4.

4. Install the **Over Axle Pipe** onto the **Extension Pipe**. Install the **Over Axle Pipe** hangers into the OEM rubber insulators starting with the rear hanger.

Refer to Figure 5.



Figure 5

5. Place the **4" Band Clamp** over the **Tail Pipe** inlet and install the **Tail Pipe** onto the **Over Axle Pipe**. Snug, but do not completely tighten the **Clamp**.

Refer to Figure 6.

6. Install the **Exhaust Tips** and adjust to your liking. The **Exhaust Tips** can only be installed on the straight sections of the **Tail Pipe**. Attempting to force them back farther may not allow them to tighten and align properly.

7. Once everything is aligned completely tighten all **Clamps**.

6. Check along the whole length of the exhaust system to ensure that there is adequate clearance around the spare tire, fuel and brake lines or any wiring. If any interference is detected relocate or adjust.

7. It is recommended to tack weld each joint, including the **Exhaust Tips** to ensure vibrations do not allow any pieces to become detached.



Figure 6



Congratulations! You are ready to begin experiencing the improved power, sound and driving experience of your MBRP Inc. performance exhaust system. We hope you enjoy your purchase.