

S6035

CHEV/GMC 2016 2500/3500 DURAMAX,
FILTER BACK, COOL DUALS

MBRP INC.
PERFORMANCE EXHAUST

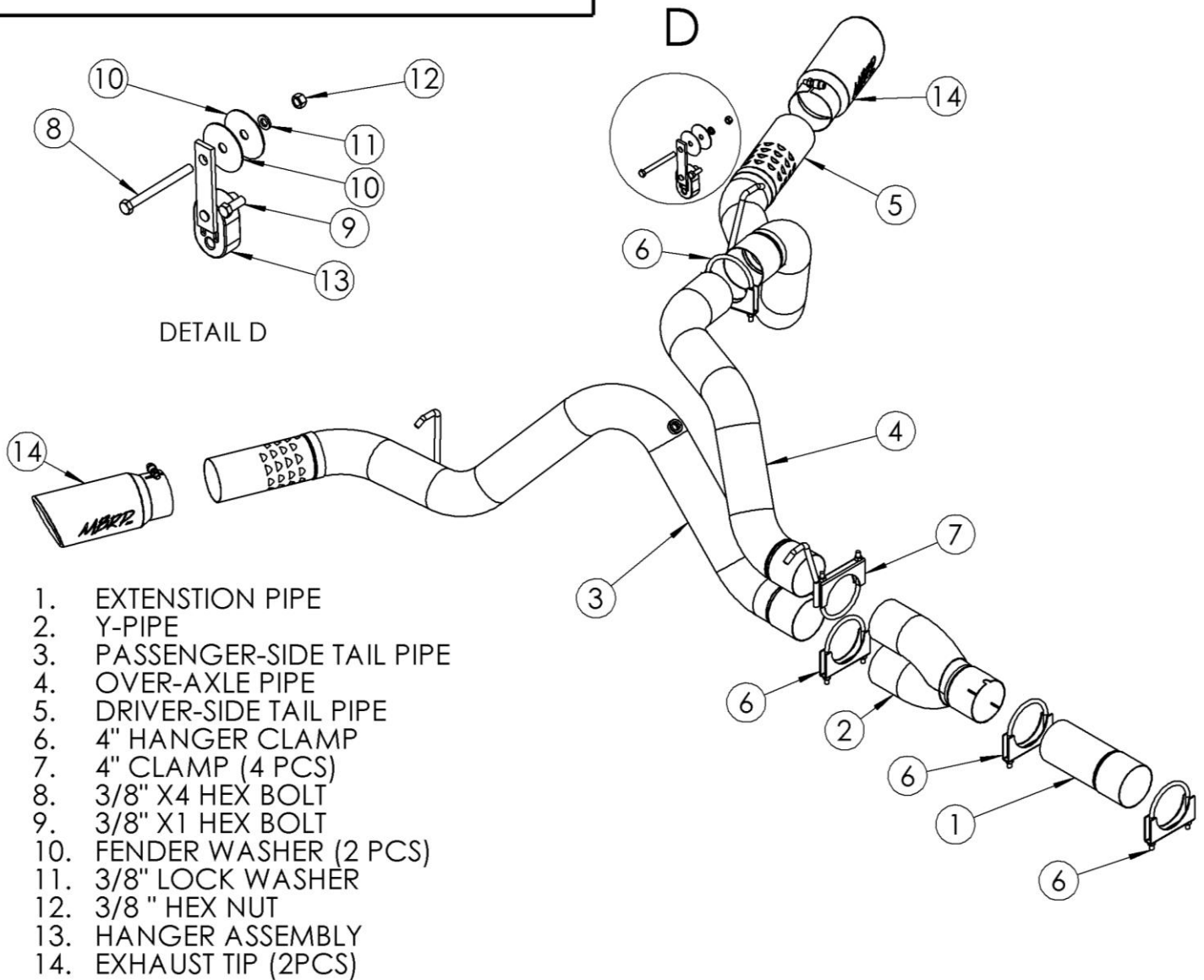

DETAIL D

1. EXTENSION PIPE
2. Y-PIPE
3. PASSENGER-SIDE TAIL PIPE
4. OVER-AXLE PIPE
5. DRIVER-SIDE TAIL PIPE
6. 4" HANGER CLAMP
7. 4" CLAMP (4 PCS)
8. 3/8" X4 HEX BOLT
9. 3/8" X1 HEX BOLT
10. FENDER WASHER (2 PCS)
11. 3/8" LOCK WASHER
12. 3/8" HEX NUT
13. HANGER ASSEMBLY
14. EXHAUST TIP (2PCS)

PLEASE READ BEFORE STARTING INSTALLATION

While MBRP Inc. has made every effort to ensure that all components of this system are of superior quality and properly packaged, it is the installer's responsibility to ensure the following before removal of the factory exhaust:

- that ALL components shown above are present.
- that ALL mating components fit together.
- that there are no damaged components.
- that the system you have purchased is appropriate for your vehicle year, model and configuration.
- that the system will not interfere with any modifications previously installed or planned.
- that you have read and understand these instructions.

If you have any questions or are uncertain about any aspect of the installation of this system to your vehicle please contact your dealer before commencing installation.



Figure 1

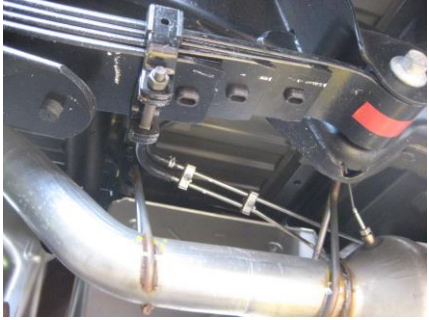

Figure 2



Figure 3

Removal of Stock System:

1. Apply a penetrating lubricant liberally to all exhaust fasteners, hangers and rubber isolators.
2. Remove temperature sensor from passenger-side tail pipe. Some models may be equipped with a plug in place of the sensor. **Do not discard plug as it is required for installation.**
Refer to Figure 1.
3. Refer to the illustration in **Figure 4** and the chart below to determine where to cut the existing exhaust rear of the particulate filter.

Cab Style	Box Style	Wheelbase	Dimension A	Extension pipe
CREW	8' 2"	167.7"	14"	YES
	6' 6"	154.2"	6"	NOT REQUIRED
EXTENDED	8' 2"	157.7"	14"	YES
	6' 5"	144.2"	6"	NOT REQUIRED

4. Remove the factory tail pipe assembly from the factory rubber isolators. Remove the tail section from the vehicle.
Refer to Figures 2 & 3.

Installation of MBRP Inc. Performance Exhaust:

Note: the **Extension Pipe** will only be used with some applications. The photos shown are of the installation of an Extended Cab with a Standard Box (144.2" wheelbase).

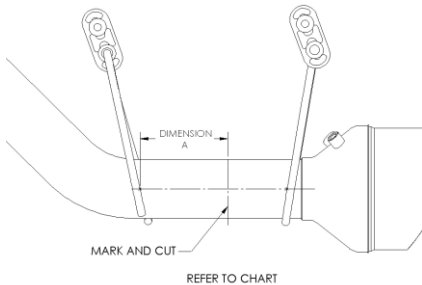

Figure 4

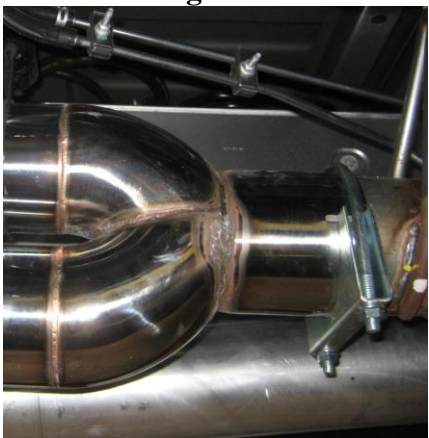

Figure 5

1. Using the clamps provided install **Extension Pipe** or **Y-Pipe** to the pipe behind the particulate filter.
Refer to Figure 5 and the chart above.



Figure 6



Figure 7



Figure 8



Figure 9

2. Use the **4" Hanger Clamp** to install the **Over-Axle Pipe** to the **Y-Pipe**. The expanded end slides over the upper outlet of the **Y-Pipe**.
Refer to Figure 6 & 7.
3. Slide a **4" Clamp** over bottom outlet of the **Y-Pipe**. Install the **Passenger-Side Tail Pipe** from the rear of the truck, over the axle and slide on the lower outlet of the **Y-Pipe Assembly**. Install the Tail Pipe hanger into the factory rubber insulators.
Refer to Figures 6 & 8.
4. Fasten temperature sensor or plug in bung on **Passenger-Side Tail Pipe**.
5. Slide a **4" Clamp** over the outlet of the **Over-Axle Pipe**. Install the **Driver-Side Tail Pipe** from the rear of the truck, between the shock and spare tire and slide the expansion over the outlet of the **Over-Axle Pipe**.
Refer to Figure 10.
6. Install the **Hanger Kit** on the frame in the large existing hole as shown. Secure with the supplied **3/8"** hardware, refer to **Detail D** in the **Illustration**.
Refer to Figure 9.
Note: the **3/8" x 1" Hex bolt** will be used with a 3500 Dual Wheeled vehicle and be mounted through the inside frame rail only.
7. Install the **Driver-Side Tail Pipe** hanger into the **Hanger Kit** previously installed in **Step 5**.
Refer to Figure 10.



Figure 10



Figure 11



Figure 12

8. Install and adjust the **Tips** to your preference. Secure the **Tips** by tightening the lock bolts.

Refer to Figure 11.

9. Align the **Tail Pipes** and tighten **Clamps** starting at the front and working rearward to secure the system.
10. Check along the full length of the exhaust system to ensure there is adequate clearance for fuel lines, break lines, and any wiring, etc. If there is any interference detected, relocate or adjust to provide adequate clearance.

Congratulations! You are ready to begin experiencing the improved performance and driving pleasure of your MBRP Inc. performance exhaust system. We know you will enjoy your purchase.