

# S6012

06-07(CLASSIC) CHEV/GMC 2500/3500  
6.6L DURAMAX, CAT BACK, EC/CC, 4"  
SINGLE SIDE

**MBRP**  
INC.  
PERFORMANCE EXHAUST

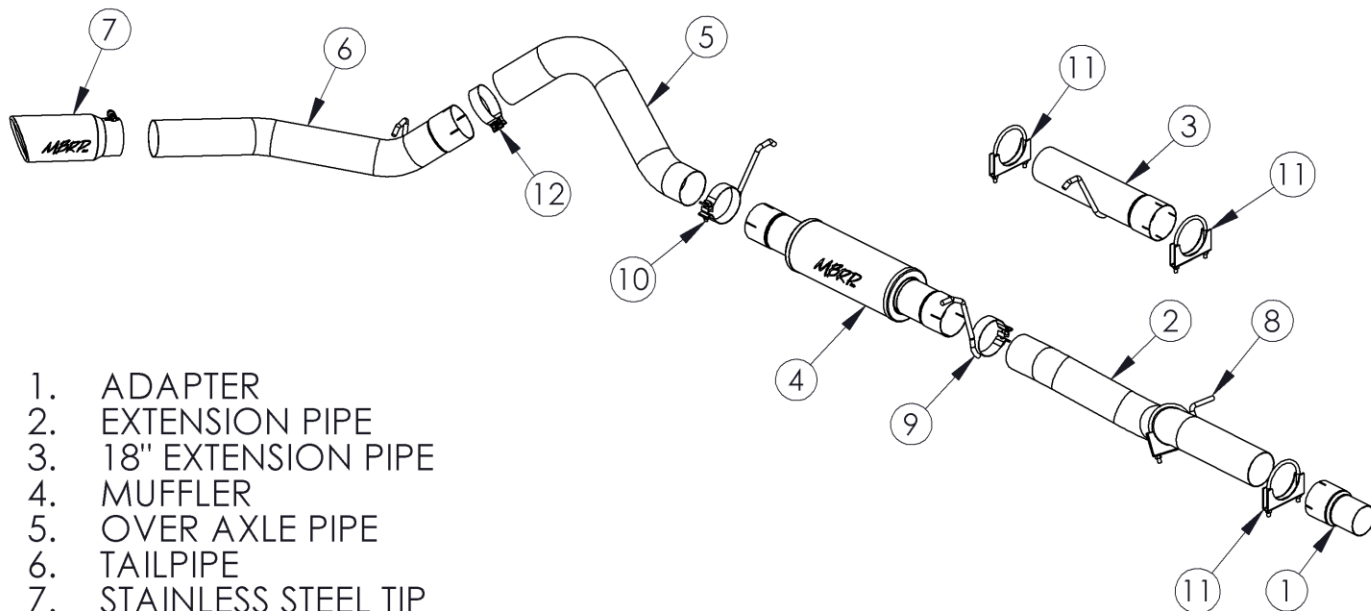

1. ADAPTER
2. EXTENSION PIPE
3. 18" EXTENSION PIPE
4. MUFFLER
5. OVER AXLE PIPE
6. TAILPIPE
7. STAINLESS STEEL TIP
8. 4" HANGER CLAMP
9. 4" HANGER BAND CLAMP
10. 4" HANGER BAND CLAMP
11. 4" CLAMP [3 PCS]
12. 4" BAND CLAMP

\*MUFFLER MAY NOT BE EXACTLY AS SHOWN

## PLEASE READ BEFORE STARTING INSTALATION

While MBRP Inc. has made every effort to ensure that all components of this system are of superior quality and properly packaged it is the installer's responsibility to ensure the following before removal of the factory exhaust:

- that ALL components shown above are present.
- that ALL mating components fit together.
- that there are no damaged components.
- that the system you have purchased is appropriate for your vehicle year, model and configuration.
- that the system will not interfere with any modifications previously installed or planned.
- that you have read and understand these instructions.

If you have any questions or are uncertain about any aspect of the installation of this system to your vehicle please contact your dealer before commencing installation.

### Removal of Stock System:

1. Apply a penetrating lubricant liberally to all exhaust fasteners, hangers and rubber insulators.
2. Loosen the band clamp behind the catalytic converter and disconnect the factory exhaust system.
3. Remove the exhaust system from the rubber insulators and remove from under the vehicle. If a hoist is not available for use, it may be necessary to cut the tail pipe behind the muffler for removal of the system.

### Installation of MBRP Inc. Performance Exhaust:

1. Place the **Adapter** provided into the factory band clamp located behind the catalytic converter. Install the **Extension Pipe** into the **Adapter** placing the bend under and around the cross member. Rotate the **Extension Pipe** to position the bend towards the driveshaft. **See Figure 1.** The **Extension Pipe** does not require cutting to fit crew cab trucks. For extended cab trucks, approximately 9 ½" needs to be cut off the end with the longest section of pipe. (**Installation tip:** Temporarily hang the **Muffler, Over Axle Pipe,** and **Tailpipe** in place and measure to the **Adapter** to verify the length required).
2. Position the **Extension Pipe** as shown and loosely install the **Hanger Clamp** with the shortest hanger. **See Figure 2.** This will support the **Extension Pipe** during the **Muffler** installation.
3. Crew cab & extended cab long box trucks require the use of the **18" Extension Pipe** provided. This is to be positioned between the **Muffler** and **Extension Pipe**. **See Figure 3.** The **18" Extension Pipe** is not required with short box trucks.
4. Install the shorter **Hanger Band Clamp** and **Muffler** onto the **Extension Pipe**. **See Figure 4.**



**Figure 1**



**Figure 2**

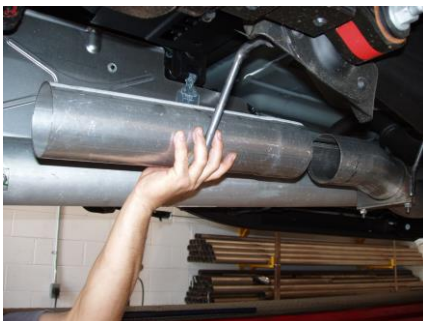

**Figure 3**

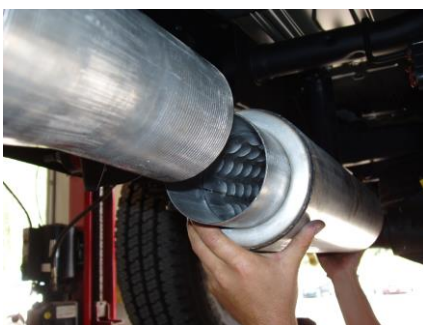

**Figure 4**



**Figure 5**



**Figure 6**

5. Install the **Hanger Band Clamp** with the longest hanger at the connection between the **Muffler** and the **Tailpipe** and into the OEM rubber hanger at this position. **See Figure 6.**
6. Slide the **4" Band Clamp** onto the **Tailpipe** Then install onto the **Over Axle Pipe** and attach to the **Muffler Outlet**. Install the tail pipe hanger into the OEM hanger; adjust for best axle clearance and **Tailpipe** exit location to complete. **See Figure 5.**
7. Install remaining **Clamps** around pipes as shown in the opening diagram. Adjust **Tailpipe** and check along the whole length of the exhaust system to ensure that there is adequate clearance around the spare tire, fuel and brake lines or any wiring. If any interference is detected, relocate or adjust.
8. Make sure the exhaust is in place before tightening clamps. Start at the front of the exhaust system and begin tightening all connections.
9. Install and adjust the **Tip** to suit.



**Congratulations!** You are ready to begin experiencing the improved power, sound and driving excitement of your MBRP Inc. performance exhaust system. We know you will enjoy your purchase.