



# AIRCHARGER®

## HIGH-FLOW INTAKE KITS

NOT LEGAL FOR SALE OR USE ON ANY POLLUTION CONTROLLED MOTOR VEHICLE IN CALIFORNIA OR STATES ADOPTING CALIFORNIA EMISSION PROCEDURES.  
See knfilters.com for CARB status on each part for a specific vehicle

### INSTALLATION INSTRUCTIONS

63-2597

FORD

2017-18 F250 / F350

V8-6.7L Turbo Diesel

**TOOLS NEEDED:**

- Ratchet
- Extension
- 8mm socket
- 10mm socket
- t20 TORX
- flat blade screw driver
- 10mm wrench
- 3mm allen key
- 4mm allen key

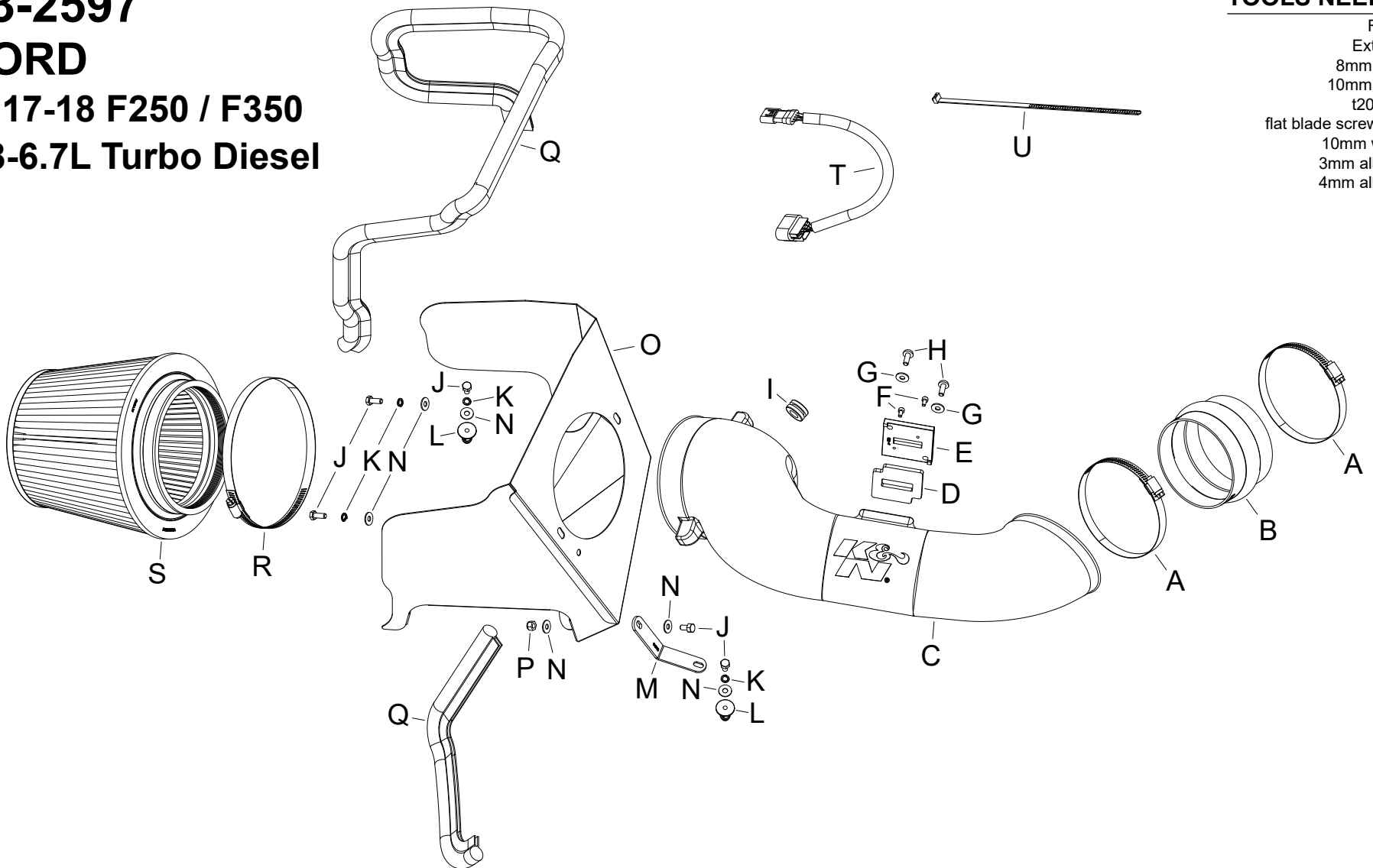

**PARTS LIST:**

Description	Qty.	Part #	Description	Qty.	Part #	Description	Qty.	Part #
A HOSE CLAMP #72	2	08671	H BOLT; M6 X 1.00 X 16MM, SS	2	07730	O HEAT SHIELD	1	073248
B HOSE; 4-1/2" ID X 3" L HUMP	1	08695	I GROMMET; 1"OD, 1/2"ID, 1/2"	1	08064	P NUT; 6MM NYLOCK, HEXHEAD	1	07512
C INTAKE TUBE (LU)	1	087338A	J BOLT; 6MM-1.00 X 16MM, SS	5	07812	Q EDGE TRIM (61")	1	102492
D GASKET; 57-2556, 3/16 PORON	1	09069	K WASHER, M6 SPLIT LOCK ZINC	4	1-3025	R HOSE CLAMP; #104	1	08697
E ADAPTOR; 57-2556, NYLON	1	21515	L MOUNT, PLASTIC AIRBOX	2	8-186-1	S FILTER CHARGER	1	RC-5179
F BOLT; M4 - 0.07 8MM, A/H CAP	2	07733	M BRACKET; L, 63-2597, STL	1	064346	T MAF EXTENSION HARNESS	1	21780
G WASHER; 6MM FLAT, SS	2	08269	N WASHER; 1/4"ID X 5/8"OD	6	08275	U CABLE TIES; 11" BLACK	1	21590

If you need any assistance please call 1-800-858-3333 to speak with a representative in our Customer Service Center before returning the product.

**NOTE: FAILURE TO FOLLOW INSTALLATION INSTRUCTIONS AND NOT USING THE PROVIDED HARDWARE MAY DAMAGE THE INTAKE TUBE, THROTTLE BODY AND ENGINE.**

**TO START:**

1. Turn off the ignition and disconnect the negative battery cable.  
**NOTE: Disconnecting the negative battery cable erases pre-programmed electronic memories. Write down all memory settings before disconnecting the negative battery cable. Some radios will require an anti-theft code to be entered after the battery is reconnected. The anti-theft code is typically supplied with your owner's manual. In the event your vehicles anti-theft code cannot be recovered, contact an authorized dealership to obtain your vehicles anti-theft code.**



2. Release the locking tab and then disconnect the mass air sensor electrical connection.

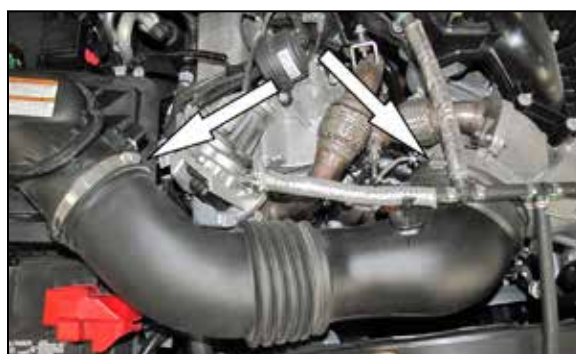

3. Loosen the hose clamps that secure the factory intake tube to the turbo inlet and air filter housing. Then remove the intake tube from the vehicle.



4. Remove the two filter housing mounting bolts shown and then remove the complete air filter housing from the vehicle.  
**NOTE: K&N Engineering, Inc., recommends that customers do not discard factory air intake.**



5. Remove the two bolts shown that secure the air filter housing bracket to the inner fender and then remove the bracket from the vehicle.

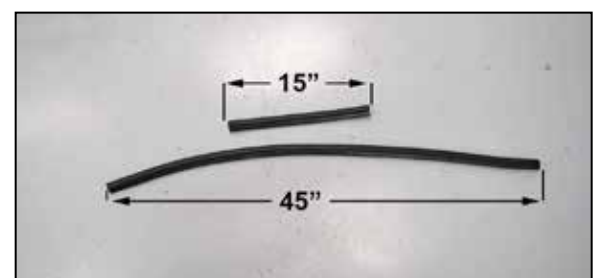

6. Cut the provided edge trim into two lengths, one should be 15" long and the other should be 45" long.

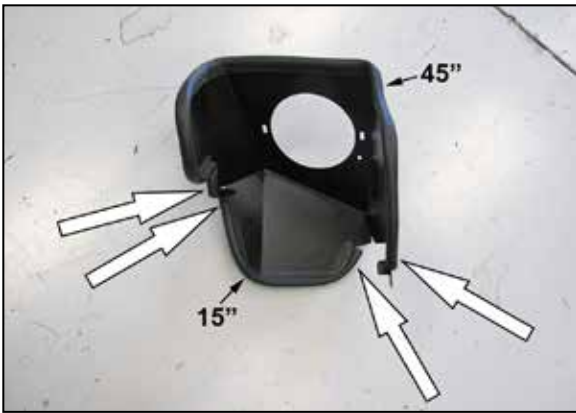

7. Install the edge trim onto the heat shield as show.



8. Using the provided hardware install one of the mounting studs onto the heat shield as shown.



9. Install the remaining mounting stud onto the provided bracket (08695) using the provided hardware.

**NOTE: The mount is to be attached onto the longer leg of the bracket.**

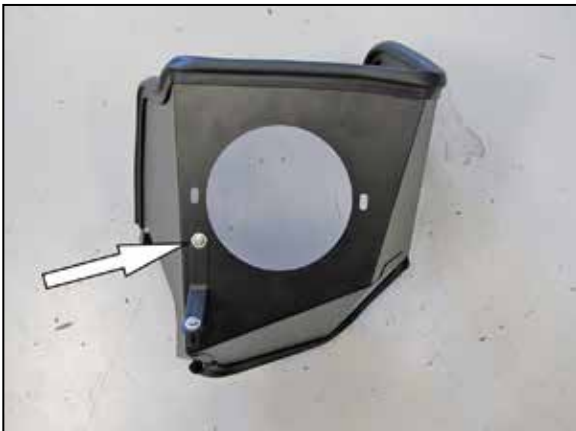

10. Attach the bracket assembly onto the heat shield as shown and secure with the provided hardware.



11. Install the heat shield into the vehicle so that the mounting studs insert into the factory air filter housing mounting grommets.

**NOTE: During and after installation, be sure to adjust any wiring harness that may be being pinch or pulled by the heat shield.**



12. Install the provided coupler hose (08695) onto the turbo inlet and secure with the provided hose clamp.



13. Install the provided gasket onto the K&N® mass air sensor adapter.



14. Remove the mass air sensor from the factory air filter housing.



15. Install the sensor into the K&N® mass air sensor adapter and secure with the provided hardware.



16. Install the mass air sensor assembly into the K&N® intake tube as shown and secure with the provided hardware.



17. Remove the factory filter minder from the air filter housing.



18. Install the filter minder using the provided grommet into the K&N® intake tube.



19. Install the intake tube into the heat shield and then into the coupling hose at the turbo inlet, adjust the tube for best fit and then install the provided bolts through the heat shield to secure the tube to the heat shield. Then secure the tube to the coupling hose with the provided hose clamp.



20. Install the K&N® air filter onto the intake tube and secure with the provided hose clamp.  
**NOTE: Drycharger® air filter wrap; part # RC-5139DK is available to purchase separately. To learn more about Drycharger® filter wraps or look up color availability please visit <http://www.knfilters.com>.**



21. Connect the provided mass air sensor extension harness to the factory wiring harness and then into mass air sensor. Using the provided tie wrap, secure the extension harness to the factory harness so that it does not interfere with and potentially moving parts as shown.



22. Reconnect the vehicle's negative battery cable. Double check to make sure everything is tight and properly positioned before starting the vehicle.

23. It will be necessary for all K&N® high flow intake systems to be checked periodically for realignment, clearance and tightening of all connections. Failure to follow the above instructions or proper maintenance may void warranty.

#### **ROAD TESTING:**

1. Start the engine with the transmission in neutral or park, and the parking brake engaged. Listen for air leaks or odd noises. For air leaks secure hoses and connections. For odd noises, find cause and repair before proceeding. This kit will function identically to the factory system except for being louder and much more responsive.

2. Test drive the vehicle. Listen for odd noises or rattles and fix as necessary.

3. If road test is fine, you can now enjoy the added power and performance from your kit.

4. K&N Engineering, Inc., requires cleaning the intake system's air filter element every 100,000 miles. When used in dusty or off-road environments, our filters will require cleaning more often. We recommend that you visually inspect your filter once every 25,000 miles to determine if the screen is still visible. When the screen is no longer visible some place on the filter element, it is time to clean it. To clean and re-oil, purchase our filter Recharger® service kit, part number 99-5050 or 99-5000 and follow the easy instructions.

**NOT LEGAL FOR SALE OR USE ON ANY POLLUTION CONTROLLED MOTOR VEHICLE IN CALIFORNIA OR STATES ADOPTING CALIFORNIA EMISSION PROCEDURES.**

See [knfilters.com](http://knfilters.com) for CARB status on each part for a specific vehicle