



INSTALLATION INSTRUCTIONS



2007.5-2017 GM 2500/3500 6.6L

PART NO. 17064

BILL OF MATERIALS:

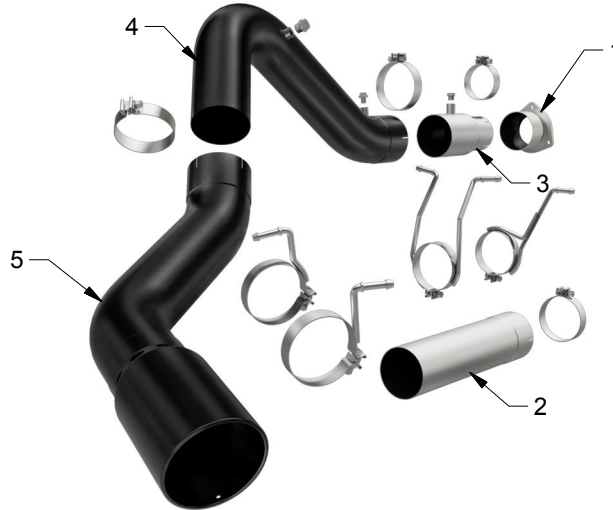

- 1. INLET NIPPLE
- 2. EXTENSION PIPE
- 3. 4"-5" NIPPLE
- 4. OVER AXLE PIPE ASSY
- 5. TAIL PIPE ASSY



WEAR SAFETY GLASSES



READ INSTRUCTIONS THOROUGHLY BEFORE INSTALLING PRODUCT

SHOP SUPPLIES:



SPRAY LUBRICANT

To ease removal of existing exhaust components (especially on older vehicles) spray penetrating lubricant on all fasteners and hangers/insulators that will be loosened or removed and let soak before disassembly.

HARDWARE KIT:

- 1.[3] 5.00" Clamp
- 2.[4] 5.00" Welded Hanger Clamp
- 3.[1] 4.00" Clamp
- 4.[3] Sensor Plugs
- 5.[3] Hex Bolt
- 6.[3] Hex Nut

MINIMUM REQUIRED TOOLS:



15mm
23mm



Hanger Tool
(Or Pry Bar)



SAWZALL, SIMILAR
CUTTING TOOL

MAGNAFLOW RECOMMENDS PROFESSIONAL INSTALLATION ON ALL THEIR PRODUCTS



WARNING: When working on, under, or around any vehicle exercise caution. Please allow the vehicle's exhaust system to cool before removal, as exhaust system temperatures may cause severe burns. If working without a lift always consult vehicle manual for correct lifting specifications. Always wear safety glasses and ensure a safe work area. Serious injury or death could occur if safety measures are not followed.

ATTENTION: Always install any supplied band or U-bolt clamps to the proper torque specifications of 40-45 ft-lbs for band clamps and 30-35 ft-lbs for U-bolt clamps. Over tightening will result in the clamp breaking and will NOT be warranted by MagnaFlow.

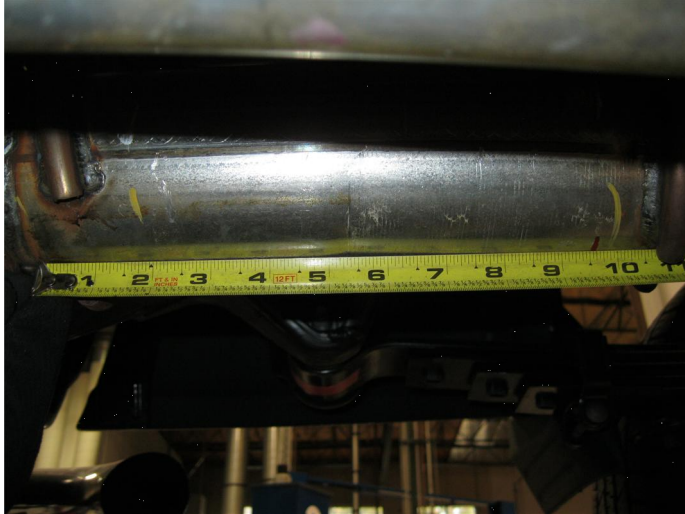

Step 1. 2014-2017 Installation: To begin the removal of the OEM system check to see if it has sensor(s) connected to it, if so, remove the sensor(s) and hang it/them out of the way. Next, you will need to cut the exhaust pipe behind the DPF measuring from the rear weld junction to the rear of the vehicle. See Table 1. for where to cut for your vehicle. Once cut, you can then disengage the welded hangers from the rubber insulators, working rearward removing the system. Do not damage or discard the rubber insulators, as they will be reused to mount the new system.

2007.5-2013 Installation: To remove the OEM system, you will need to cut the tailpipe just behind the OEM muffler. You can then unbolt the muffler at the 3-bolt flange, and disengage the welded tailpipe hangers from the rubber insulators. Do not damage or discard the OEM gasket, fasteners, or rubber insulators, as they will be reused to mount the new system.

TABLE 1.

Configuration	2014-2016	2017
CrewCab/Long Box	26.50	16.25
CrewCab/Standard Box	13.25	3.00
DoubleCab/Long Box	18.40	8.15
DoubleCab/Standard Box	4.50	N/A



Step 2. 2014-2017 Installation: Begin installation of the Magnaflow system by first clamping the 4"-5" Adapter Nipple to the newly cut outlet of the DPF using the supplied 4.00" clamp. If your vehicle has any sensor(s) re-install at the appropriate locations. Any boss that doesn't get a sensor installed into it must be closed off with a provided screw in plug. Next attach the adapter nipple to the extension pipe using the supplied 5.00" clamps and fitting the welded hanger clamp in the rubber insulators (leave all clamps loose for final adjustment of the complete system).

2007.5-2013 Installation: Install the new inlet nipple using the OEM gasket and supplied fasteners, but leave all clamps and fasteners loose for final adjustment of the complete system. Install the extension pipe and tailpipe extension using the supplied 5.00" clamps and by fitting the welded hanger clamp into the rubber insulators.

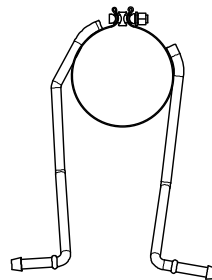

FOR 2014 - 2017 (FRONT)
WELD HANGER CLAMP

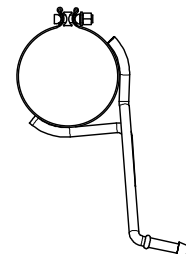

FOR 2007.5-2013 (FRONT)
WELD HANGER CLAMP



Step 3. Next Install the Tail Pipe Assembly in a similar fashion using the supplied 5.00" clamp and by fitting the welded hanger clamp into the rubber insulators.

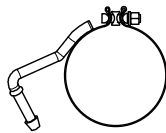

FOR 2014-2017 (REAR)
WELD HANGER CLAMP

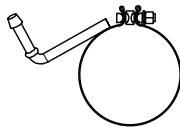

FOR 2007.5-2013 (REAR)
WELD HANGER CLAMP



Step 4. Once a final position has been chosen for the new exhaust system, evenly tighten all clamps from front to rear using the torque specifications on page one of the instructions. Inspect all fasteners after 25-50 miles of operation and re-tighten if necessary.