

# Installation Guide for the TechLogix TL-RK01 Mounting Bracket

This guide provides a brief introduction and usage method for the TL-RK01 Mounting Bracket.

## 1. Preparation

### ✓ Unpacking

Remove the spare parts from the TL-RK01 packaging and verify all of the below items are present.

Packing List:		
24 x Support Brackets <sup>1</sup>	12 x Support Brackets <sup>2</sup>	1 x Main Frame
2 x Panels	2 x Metal Rods	22 x Screws(2.5*5mm)
44 x Screws(3*6mm)	11 x Baffle plates	

### ✓ Prepare Spare Parts

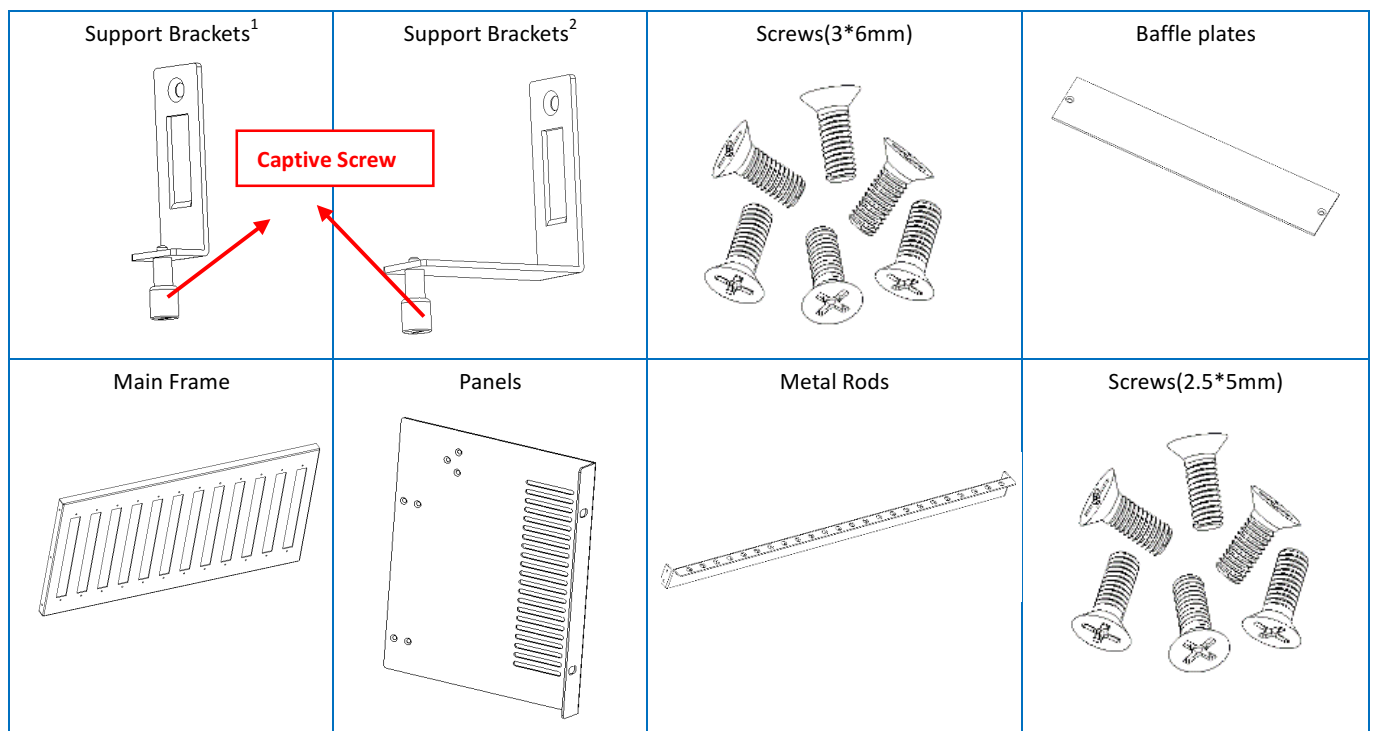

- ✧ Pictures are for reference only
- ✧ The TL-RK01 is designed for mounting compatible TechLogix electronics only; contact the factory for a list of compatible products
- ✧ All compatible Electronics are sold separately

## 2. Installation procedure

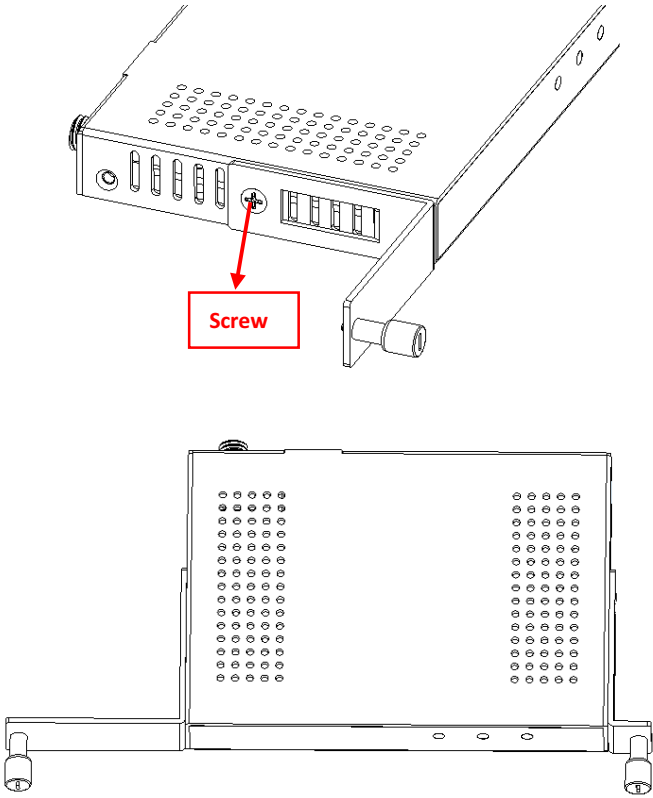
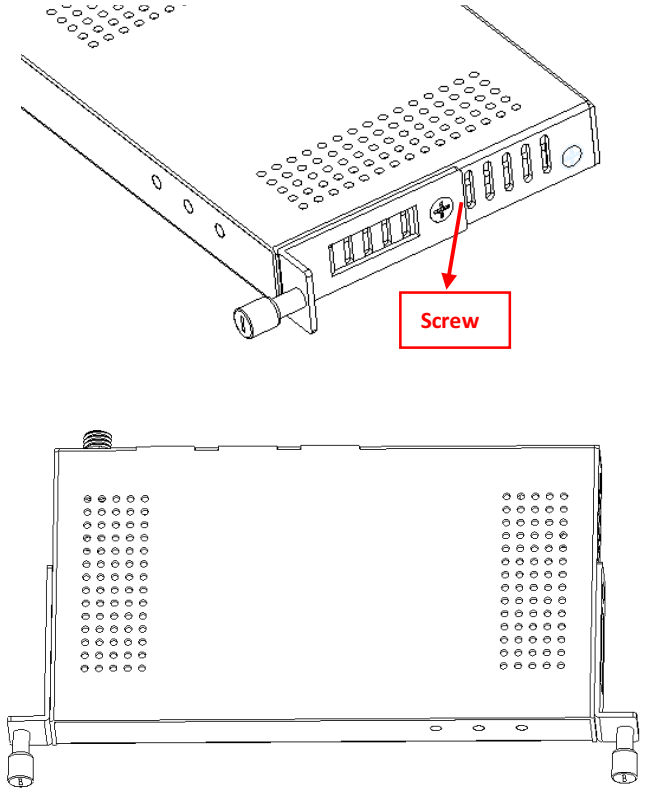
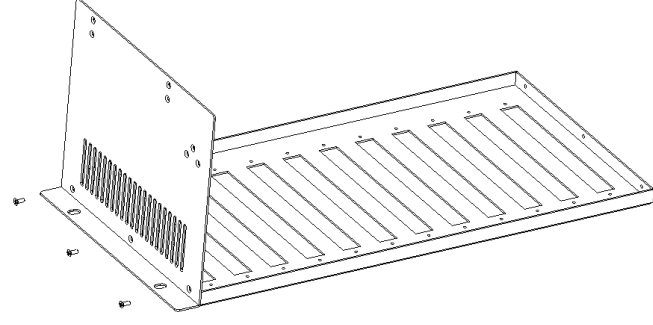
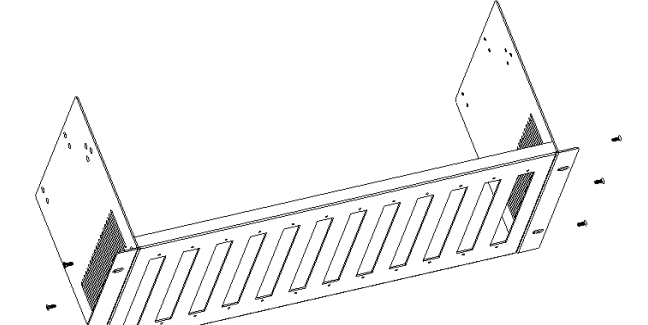
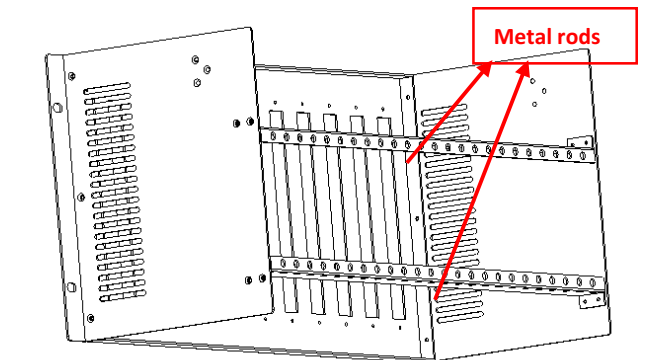
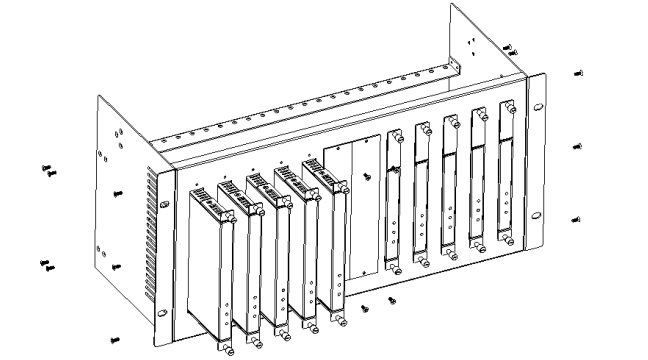
 <p><b>Step 1 (for small sized devices).</b> Connect one Bracket<sup>1</sup> and one Bracket<sup>2</sup> to a compatible electronic device (sold separately), and affix them with screws (3*6mm).</p>	 <p><b>Step 1 (for large sized devices).</b> Connect two Brackets<sup>1</sup> to a compatible electronic device, and affix them with screws (3*6mm).</p>
 <p><b>Step 2.</b> Connect one panel to the one side of main frame with screws (3*6mm).</p>	 <p><b>Step 3.</b> Connect the opposite panel to the other side of main frame with screws (3*6mm).</p>
 <p><b>Step 4.</b> Install the two metal rods with screws (3*6mm).</p>	 <p><b>Step 5.</b> Install the electronics with the brackets in the slots and tighten the captive screws.</p>

