

# Flex Cable Short Barrel 1 Hole Compression Lugs

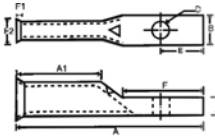

- ▶ High Conductivity Seamless Copper
- ▶ Electro-Tin Plating Resists Corrosion, reduces Contact Resistance for Maximum Conductivity
- ▶ Flared/Belled Entry for Easy Insertion of Fine Strand Flexible Cable - Class G, H, I, K(Battery), M(Welding), DLO
- ▶ Color Coded Die Index and Crimp Marks Printed on Barrel
- ▶ UL 486A Listed for Applications Thru 35KV



**New!  
Available  
January 2015**

Dimensions = Inches

Cat. No.	Wire Range	Stud Size	Color Code	COMM	ASTM Class H	Welding Class M	DLO	A	A1	B	C	D	E	F	F1	F2	Box Qty
94602	8	#10	Red	8	10	10	-	1.20	.44	.42	.08	.21	.28	.59	.12	.32	50
94606	6	1/4	Blue	6	8	8	(61)	1.50	.71	.42	.08	.25	.30	.67	.16	.34	50
94610	4	5/16	Gray	4	6	6	(105)	1.50	.71	.49	.08	.33	.31	.67	.16	.42	50
94614	2	5/16	Brown	2	4	4	(125)	1.80	.83	.60	.10	.33	.37	.81	.18	.49	25
94618	1	5/16	Green	1	2	2	(150)	1.83	.83	.67	.11	.33	.37	.81	.18	.53	25
94622	1/0	3/8	Pink	1/0	1	1	(225)	1.83	.83	.74	.13	.41	.37	.81	.18	.56	10
94626	2/0	1/2	Black	2/0	1/0	1/0	1/0(275)	2.24	.94	.81	.12	.51	.47	1.06	.24	.64	10
94630	3/0	1/2	Orange	3/0	2/0	-	2/0(325)	2.36	.98	.90	.13	.51	.47	1.06	.24	.72	10
94634	4/0	1/2	Purple	4/0	3/0	2/0	3/0(450)	2.36	.98	1.00	.13	.51	.47	1.06	.26	.77	10
94636	250	1/2	Yellow	250	-	3/0	4/0(550)	2.48	1.06	1.09	.15	.51	.47	1.06	.26	.84	10
94637	300	1/2	White	300	4/0	4/0	262.6	2.49	1.06	1.19	.15	.51	.52	1.06	.31	.94	10
94638	300	5/8	White	300	4/0	4/0	262.6	2.80	1.06	1.19	.15	.67	.52	1.38	.31	.94	10
94639	350	1/2	Red	350	250	250	313.1	2.61	1.10	1.28	.17	.51	.52	1.06	.33	1.02	10
94640	350	5/8	Red	350	250	250	313.1	2.91	1.10	1.28	.16	.67	.52	1.38	.33	1.02	10
94641	400	1/2	Blue	400	300	300	350	3.08	1.18	1.39	.18	.51	.52	1.38	.38	1.08	10
94642	400	5/8	Blue	400	300	300	350	3.08	1.18	1.39	.18	.67	.52	1.38	.38	1.08	10
94643	500	1/2	Brown	500	350	350	373.3	3.28	1.38	1.54	.22	.51	.52	1.38	.35	1.20	10
94644	500	5/8	Brown	500	350	350	373.3	3.28	1.38	1.54	.22	.67	.52	1.38	.35	1.20	10
94646	600	5/8	Green	600	400	400	444.4	3.50	1.50	1.72	.25	.67	.69	1.46	.38	1.34	6
94647	750	5/8	Black	750	600	500	-	4.37	1.85	1.90	.27	.67	.69	1.85	.43	1.47	3

# Flex Cable Long Barrel 1 Hole Compression Lugs



- ▶ High Conductivity Seamless Copper
- ▶ Electro-Tin Plating Resists Corrosion, reduces Contact Resistance for Maximum Conductivity
- ▶ Flared/Belled Entry for Easy Insertion of Fine Strand Flexible Cable - Class G, H, I, K(Battery), M(Welding), DLO
- ▶ Color Coded Die Index and Crimp Marks Printed on Barrel
- ▶ UL 486A Listed for Applications Thru 35KV

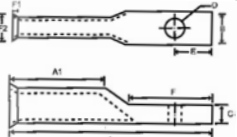

**New!  
Available  
January 2015**

Dimensions = Inches

Cat. No.	Wire Range	Stud Size	Color Code	COMM	ASTM Class H	Welding Class M	DLO	A	A1	B	C	D	E	F	F1	F2	Box Qty
94650	8	1/4	Red	8	10	10	-	1.52	.81	.42	.08	.25	.28	.59	.12	.32	50
94652	6	#10	Blue	6	8	8	(61)	1.77	.98	.42	.08	.21	.30	.67	.15	.34	50
94653	6	1/4	Blue	6	8	8	(61)	1.77	.98	.42	.08	.25	.30	.67	.15	.34	50
94656	4	10	Gray	4	6	6	(105)	1.77	.98	.49	.09	.21	.31	.67	.16	.42	50
94657	4	1/4	Gray	4	6	6	(105)	1.77	.98	.49	.09	.25	.31	.67	.16	.42	50
94659	4	5/16	Gray	4	6	6	(105)	1.77	.98	.49	.09	.33	.31	.67	.16	.42	50
94661	2	5/16	Brown	2	4	4	(125)	2.07	1.10	.60	.10	.33	.37	.81	.18	.49	25
94663	1	5/16	Green	1	2	2	(150)	2.11	1.10	.67	.11	.33	.37	.81	.15	.53	25
94665	1/0	5/16	Pink	1/0	1	1	(225)	2.21	1.20	.74	.13	.33	.37	1.06	.18	.56	10
94666	1/0	3/8	Pink	1/0	1	1	(225)	2.21	1.20	.74	.13	.41	.37	1.06	.18	.56	10
94667	1/0	1/2	Pink	1/0	1	1	(225)	2.50	1.20	.74	.13	.51	.47	1.06	.18	.56	10
94668	2/0	3/8	Black	2/0	1/0	1/0	1/0(275)	2.68	1.38	.81	.12	.41	.47	1.06	.24	.64	10
94669	2/0	1/2	Black	2/0	1/0	1/0	1/0(275)	2.68	1.38	.81	.12	.51	.47	1.06	.24	.64	10
94671	3/0	1/2	Orange	3/0	2/0	-	2/0(325)	2.80	1.38	.90	.13	.51	.47	1.06	.24	.72	10
94674	4/0	1/2	Purple	4/0	3/0	2/0	3/0(450)	2.80	1.42	1.00	.13	.51	.52	1.06	.26	.77	10
94676	250	1/2	Yellow	250	-	3/0	4/0(550)	3.03	1.61	1.09	.15	.51	.52	1.06	.26	.64	10
94677	300	1/2	White	300	4/0	4/0	262.6	3.39	1.97	1.19	.15	.51	.52	1.06	.31	.94	10
94678	350	1/2	Red	350	250	250	313.1	3.46	1.97	1.28	.17	.51	.52	1.06	.53	1.02	10
94679	350	5/8	Red	350	250	250	313.1	3.46	1.97	1.28	.17	.67	.51	1.06	.53	1.02	10
94680	400	1/2	Blue	400	300	300	350	3.86	1.97	1.39	.18	.51	.51	1.38	.33	1.08	10
94681	400	5/8	Blue	400	300	300	350	3.86	1.97	1.39	.18	.67	.51	1.38	.33	1.08	10
94683	500	5/8	Brown	500	350	350	373.3	4.13	2.24	1.54	.22	.67	.51	1.38	.35	1.20	10
94684	600	5/8	Green	600	400	400	444.4	4.25	2.24	1.72	.25	.67	.69	1.46	.38	1.34	6
94685	750	5/8	Black	750	600	500	-	5.16	2.64	1.90	.27	.67	.69	1.85	.43	1.47	3