

Aluminum Long Barrel 1 Hole Compression Lugs

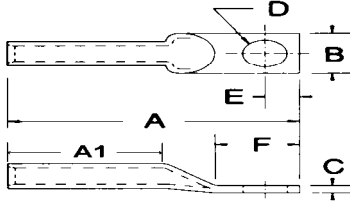

- ▶ AL9CU Listed - for both Aluminum and Copper Conductors
- ▶ Pre-filled with Oxide Inhibitor
- ▶ Made of High-Conductivity Seamless Aluminum
- ▶ Electro-Tin Plating resists corrosion, reduces contact resistance for Maximum Conductivity
- ▶ Single Mounting Hole
- ▶ Color Coded Die Index and Crimp Marks Printed on Barrel
- ▶ UL 486B AL9CU Listed for Applications Thru 35KV

Dimensions = Inches

Cat. No.	Wire Range	Stud Size	Color Code	ID	OD	A	A1	B	C	D	E	F	Box Qty
93005	8 Str.	10	Blue	.16	.30	1.81	.56	.63	.09	.21	.31	.81	20
93008	8 Str.	1/4	Blue	.16	.30	1.81	.56	.63	.09	.25	.31	.81	20
93006	8 Str.	5/16	Blue	.16	.30	1.81	.56	.63	.09	.33	.31	.81	20
93007	8 Str.	3/8	Blue	.16	.30	1.81	.56	.63	.09	.41	.31	.81	20
93009	6 Str.	10	Gray	.20	.34	2.01	.86	.57	.10	.21	.38	.88	50
93010	6 Str.	1/4	Gray	.20	.34	2.01	.86	.57	.10	.25	.38	.88	50
93012	6 Str.	5/16	Gray	.20	.34	2.01	.86	.57	.10	.33	.38	.88	50
93014	6 Str.	3/8	Gray	.20	.34	2.01	.86	.57	.10	.41	.38	.88	50
93016	4 Str.	1/4	Green	.25	.44	2.31	1.1	.57	.19	.25	.38	.88	30
93018	4 Str.	5/16	Green	.25	.44	2.31	1.1	.57	.19	.33	.38	.88	30
93020	4 Str.	3/8	Green	.25	.44	2.31	1.1	.57	.19	.41	.38	.88	30
93022	2 Str.	1/4	Pink	.31	.53	2.50	1.2	.71	.22	.25	.38	.88	30
93024	2 Str.	5/16	Pink	.31	.53	2.50	1.2	.71	.22	.33	.38	.88	30
93026	2 Str.	3/8	Pink	.31	.53	2.50	1.2	.71	.22	.41	.38	.88	30
93027	2 Str.	1/2	Pink	.31	.53	2.50	1.2	.71	.22	.51	.38	.88	30
93028	1 Str.	1/4	Gold	.35	.53	2.50	1.2	.73	.18	.25	.38	.88	15
93030	1 Str.	5/16	Gold	.35	.53	2.50	1.2	.73	.18	.33	.38	.88	15
93032	1 Str.	3/8	Gold	.35	.53	2.50	1.2	.73	.18	.41	.38	.88	15
93033	1 Str.	1/2	Gold	.35	.53	2.50	1.2	.73	.18	.41	.38	.88	15
93034	1/0 Str.	1/4	Tan	.39	.63	2.81	1.2	.85	.24	.25	.50	.93	20
93036	1/0 Str.	5/16	Tan	.39	.63	2.81	1.2	.85	.24	.33	.50	.93	20
93038	1/0 Str.	3/8	Tan	.39	.63	2.81	1.2	.85	.24	.41	.50	.93	20
93039	1/0 Str.	1/2	Tan	.39	.63	2.81	1.2	.85	.24	.51	.50	.93	20
93040	2/0 Str.	1/4	Olive	.44	.69	2.81	1.3	.94	.24	.25	.50	1.12	20
93042	2/0 Str.	5/16	Olive	.44	.69	2.81	1.3	.94	.24	.33	.50	1.12	20
93044	2/0 Str.	3/8	Olive	.44	.69	2.81	1.3	.94	.24	.41	.50	1.12	20
93046	2/0 Str.	1/2	Olive	.44	.69	2.81	1.3	.94	.24	.51	.50	1.12	20
93048	3/0 Str.	1/4	Ruby	.48	.76	3.00	1.4	1.03	.28	.25	.50	1.12	15
93050	3/0 Str.	5/16	Ruby	.48	.76	3.00	1.4	1.03	.28	.33	.50	1.12	15
93052	3/0 Str.	3/8	Ruby	.48	.76	3.00	1.4	1.03	.28	.41	.50	1.12	15
93054	3/0 Str.	1/2	Ruby	.48	.76	3.00	1.4	1.03	.28	.51	.50	1.12	15
93056	4/0 Str.	1/4	White	.55	.84	3.43	1.4	1.15	.29	.25	.56	1.31	10
93058	4/0 Str.	5/16	White	.55	.84	3.43	1.4	1.15	.29	.33	.56	1.31	10
93060	4/0 Str.	3/8	White	.55	.84	3.43	1.4	1.15	.29	.41	.56	1.31	10
93062	4/0 Str.	1/2	White	.55	.84	3.43	1.4	1.15	.29	.51	.56	1.31	10
93064	250MCM	3/8	Red	.59	.92	3.50	1.5	1.26	.32	.41	.63	1.31	9
93066	250MCM	1/2	Red	.59	.92	3.50	1.5	1.26	.32	.51	.63	1.31	9
93067	300MCM	5/16	Blue	.65	1.01	4.00	1.6	1.37	.35	.33	.63	1.50	9
93068	300MCM	3/8	Blue	.65	1.01	4.00	1.6	1.37	.35	.41	.63	1.50	9
93070	300MCM	1/2	Blue	.65	1.01	4.00	1.6	1.37	.35	.51	.63	1.50	9
93072	350MCM	3/8	Brown	.72	1.12	4.25	1.9	1.52	.39	.41	.69	1.50	6
93074	350MCM	1/2	Brown	.72	1.12	4.25	1.9	1.52	.39	.51	.69	1.50	6
93076	400MCM	3/8	Green	.76	1.19	4.60	2.3	1.61	.42	.41	.69	1.50	6
93078	400MCM	1/2	Green	.76	1.19	4.60	2.3	1.61	.42	.51	.69	1.50	6
93080	500MCM	3/8	Pink	.84	1.32	4.75	2.5	1.79	.47	.41	.75	1.50	6
93082	500MCM	1/2	Pink	.84	1.32	4.75	2.5	1.79	.47	.51	.75	1.50	6
93084	500MCM	5/8	Pink	.84	1.32	4.75	2.5	1.79	.47	.67	.75	1.50	6
93085	600MCM	1/2	Black	.92	1.44	5.12	2.6	1.96	.51	.51	.75	1.87	4
93086	600MCM	5/8	Black	.92	1.44	5.12	2.6	1.96	.51	.67	.75	1.87	4
93087	750MCM	1/2	Yellow	1.03	1.60	6.12	3.2	2.19	.55	.51	.94	2.00	4
93088	750MCM	5/8	Yellow	1.03	1.60	6.12	3.2	2.19	.55	.67	.94	2.00	4