



Catalog Number See Table
UPC Number
Description Two Conductor Vertical Stacked
 Aluminum Mechanical Lug
 Two Mounting Holes



Features

- Manufactured from High Strength High Conductivity Aluminum Alloy
- Electro-Tin Plated
- CU-AL Dual rated for AL/AL, AL/CU, CU/CU Applications
- Two Conductor Two Hole Configuration - Stacked

General

Material: 6061-T6 Aluminum Alloy
Finish: Electro-Tin Plating
Screw Type: Hex Head
Wire Range: 3/0 - 750 MCM

Dimension Information

See Table

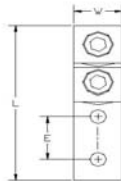
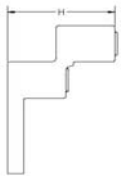

Specifications

Temperature Rating 90° C
Voltage Rating 600
Flammability Rating N/A
Amp Rating To Conductor

Packaging

Box Qty See Table

Certifications

UL UL 486B UL 41968 CU9AL Dual Rated
CSA LR27194
RoHS Yes

Cat. No.	AWG	Wire Range	Box Qty	L	W	H	Hole Space	Bolt
PANELBOARD LUGS - 2 CONDUCTORS								
90914	600	600MCM - 3/0STR.	3	4.94	1.5	3	1.38	0.41
90916	750	750MCM - 3/0STR.	3	4.94	1.5	3	1.38	0.41