

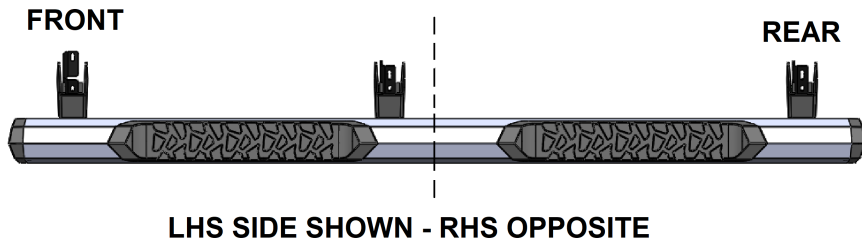

### OCTA SERIES TUBES INSTALLATION INSTRUCTIONS

VEHICLE APPLICATION(S):

2016+   
TOYOTA TACOMA  
DOUBLE CAB

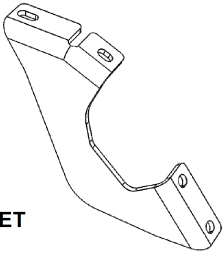
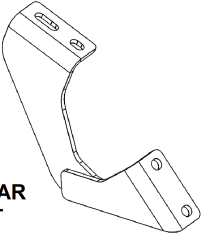
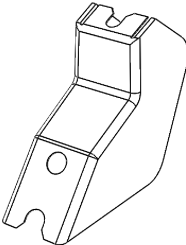

Components - Componentes - Composants

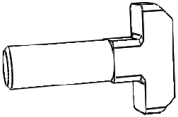
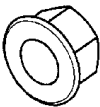
<p><b>A</b></p>  <p>FRONT BRACKET</p>	<p><b>B</b></p>  <p>MID &amp; REAR BRACKET</p>	<p><b>C</b></p> 	<p><b>D</b></p>  <p><b>M8</b></p>
<p><b>E</b></p>  <p><b>M8</b></p>	<p><b>F</b></p>  <p><b>M8</b></p>		

TOOLS REQUIRED  
HERRAMIENTAS NECESARIAS  
OUTILS NÉCESSAIRES

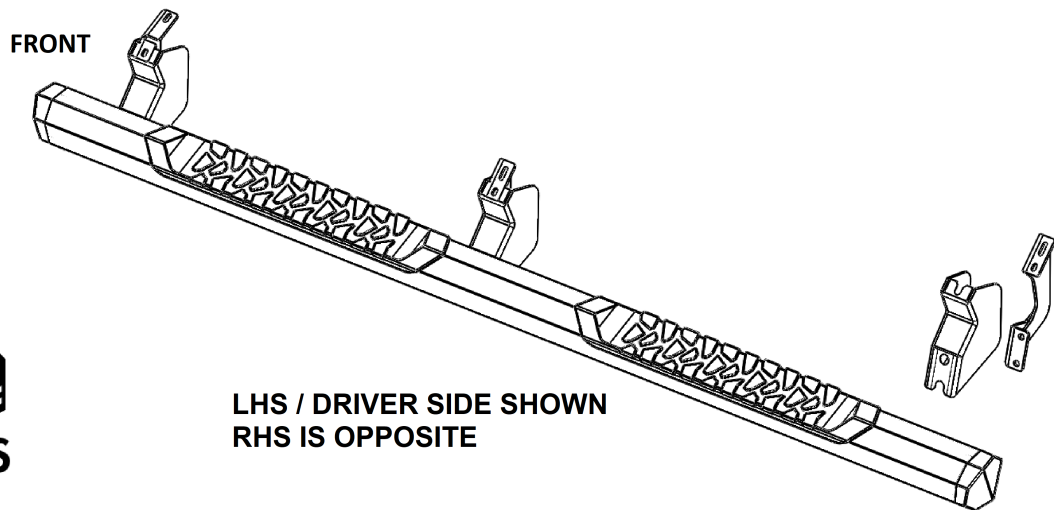
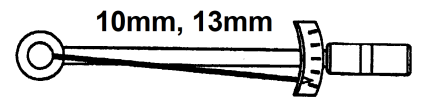
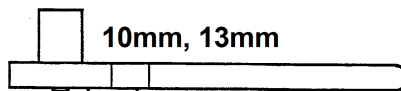

1

PART NO. 300075/76  
REV. 2

From underneath the vehicle locate the plastic caps covering the threaded mounting holes in the vehicle. Remove and discard plugs located at each bracket mounting location.

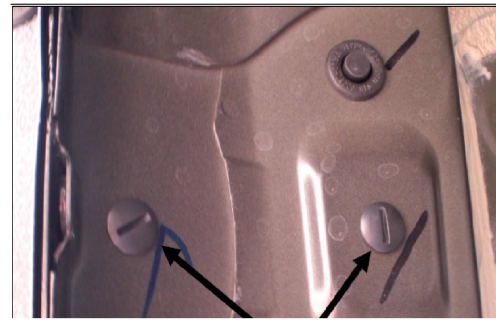

REMOVE AND DISCARD

2

Position front bracket (Item A) against inner rocker and secure with two M8 SEMS bolts (Item D). Repeat with brackets (Item B) at middle and rear attachment locations.

Tighten bolts only finger tight at this time.

3

Position bracket cover (Item C) over each bracket.

In each brackets lower two mounting holes, install a T-bolt (Item E) from the outside, and just start threading on a flange nut (Item F) from the backside. Leave very loose and only just start the threads.

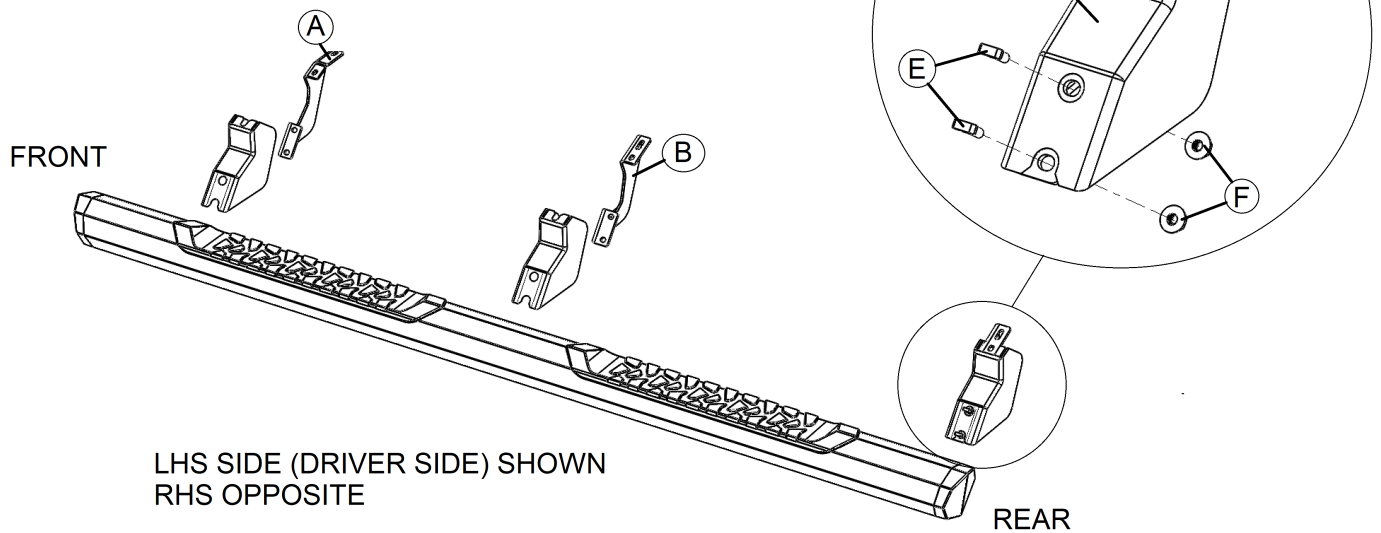

4

Position step tube over protruding t-bolts. From behind bracket, PUSH UP AND TURN Flange nuts (Item F) to engage t-bolts in slots and tighten.

CAUTION: BE SURE TO CHECK THAT T-BOLT HAS TURNED AND FULLY ENGAGED INTO SLOT IN BACK OF STEP TUBE

**Torque all fasteners.** Repeat for passenger side

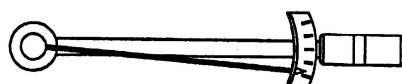

**M8 - 14 ft.lbs (20Nm)**