

4

3

2

1

Item	PartNo	Description	Qty
1	CMGP-2016-3PTL	CAM, GRIP, 3 PT LATCH, 20X16	1
2	2016CHO-M3P	COVER, MACHINED, TPL, 20X16	1
3	20160855	HINGE PIN, 20X16	1
4	GSR2016	STIFFENER RING, MOLDED, 20X16	1
5	201608BH	BASE, W/INSERTS, 20X16X08	1
6	PLATE-2016-3PTL	PLATE, 3PT LATCH, 20X16	2
7	9912595-82-10	SCREW, PAN HD, #10-16 X 1/2 LG, THD CUTTER, S.S.	8
8	20160835	RAIL, MULTI-MAX, W/INSERT, 20X16	1
9	PLSTRK-3PTL	PLATE, STRIKER, 3 PT LATCH	1
10	9912636-87-10	SCREW, FLAT HD, #10-32 X 0.38LG, S.S.	1
11	GPCL-KIT-2PK	NON-METALLIC LATCHES - 2 PACK	1
12	KIT-GMMR8	KIT, RAIL, MULTI-MAX, 20X16	1
13	9912673-87-10	COMPRESSION WASHER, 1/4"	1
14	9912537-82-10	SCREW, PAN HD, #10-32 UNF X 1/2 LG, MACH, S.S.	2
15	9912544-87-10	WASHER, #10, SPLIT LOCK, S.S.	2
16	GB-3PTL	GUIDE, BLOCK, 3PT LATCH	2
17	RB-2016-3PTL	ROD, BAR, 20X16, 3 PT LATCH	2
18	9912676-87-10	SCREW, PAN HEAD, #8-32 UNC X 3/4 LG, MACH, S.S.	2
19	9912678-87-10	NUT, NYLOK, #8-32 UNC, S.S.	2
20	9912523-80-10	WASHER, FLAT, 7/8", SS	1
21	LHDL-3PTL	L-HANDLE, INCLUDES SCREW & DIRECTIONAL WASHER	1

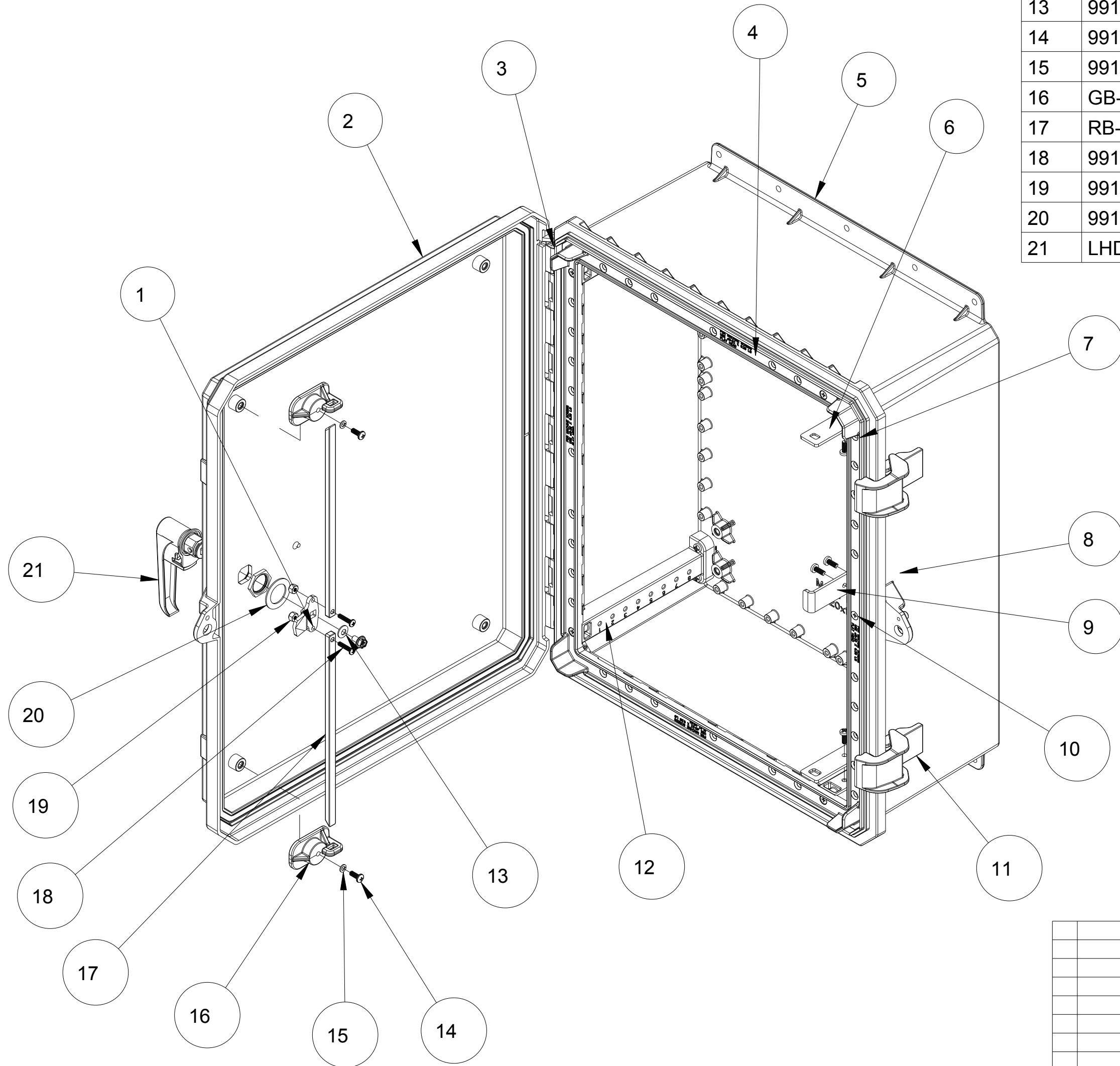

DEFAULT TOLERANCES				MUM INDUSTRIES 7750 TYLER BLVD MENTOR, OHIO, U.S.A. (440) 269-8155 FAX (440) 269-8166	
DECIMAL	.XX ± 0.03 .XXX ± 0.010	SCALE	0.250	SHEET	1 of 1
FRACTIONAL	± 1/16	TITLE			
ANGULAR	± 5°	GENESIS 20X16X08 3 POINT LATCH ASSY			
A INITIAL RELEASE TO PRODUCTION		W.T.	03-29-2016	DRAWN BY	
REV		BY	DATE	ECN NO.	APPROVED BY
		DATE		DRAWING NUMBER	
		03.29.16		G201608TPL	
				REV	

4

3

2

1