

FITTING DIAGRAM

VW MK6 R V3 : REAR SPAT + ADJUSTABLE REAR WINGLETS

INSTALLATION AND FITTING SERVICES

If you are having any difficulties please seek professional advise from the listed International and Domestic Authorised Dealers on our website.

www.flowdesignsaustralia.com

**BUMPER REMOVAL
NOT REQUIRED**

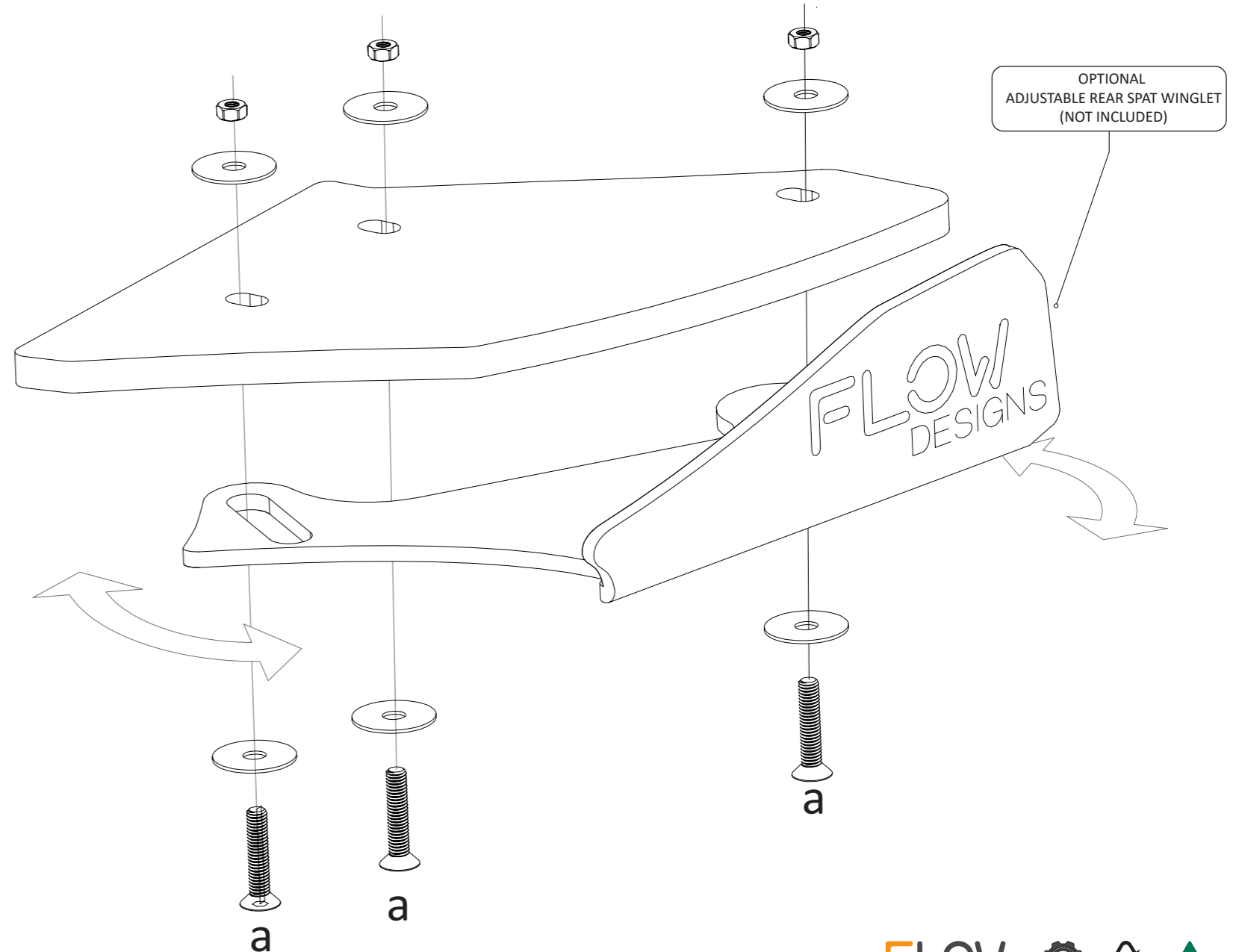
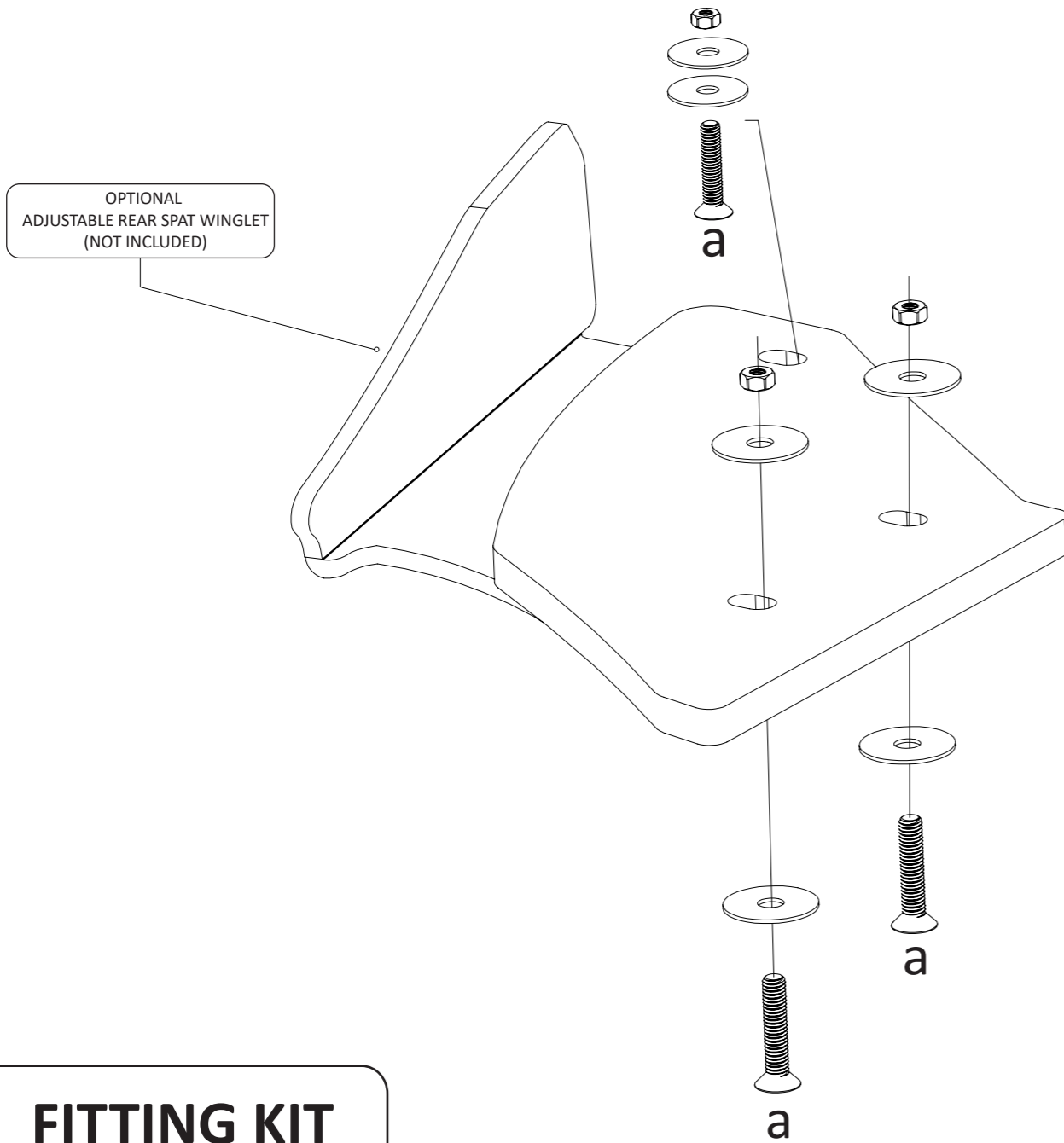

FITTING KIT

a

**M6 BOLT
30mm LONG**

X 4

PLEASE NOTE:
DRILLING **REQUIRED**
TO FASTEN TO BUMPER

PLEASE USE 8mm DRILL BIT