

### SINGLE CANARD SETUPS

#### CONFIGURATION 1

LOWER SHORT  
DIVE PLANE

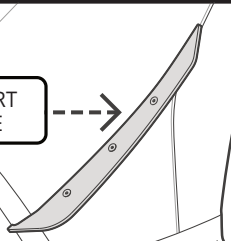

#### CONFIGURATION 2

LOWER LONG  
DIVE PLANE

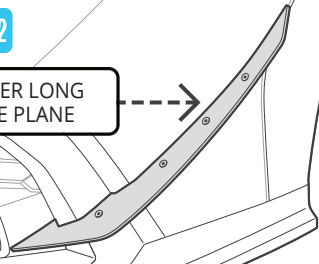

#### CONFIGURATION 3

UPPER DIVE PLANE

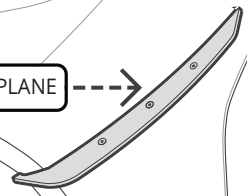

### DUAL CANARD SETUP

#### CONFIGURATION 4

UPPER  
CANARD

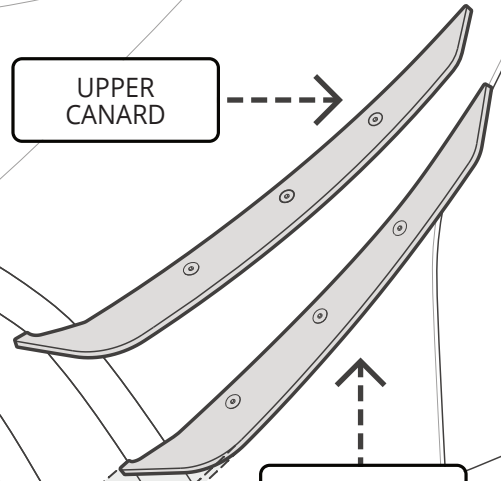

SHORT / LONG  
LOWER CANARD

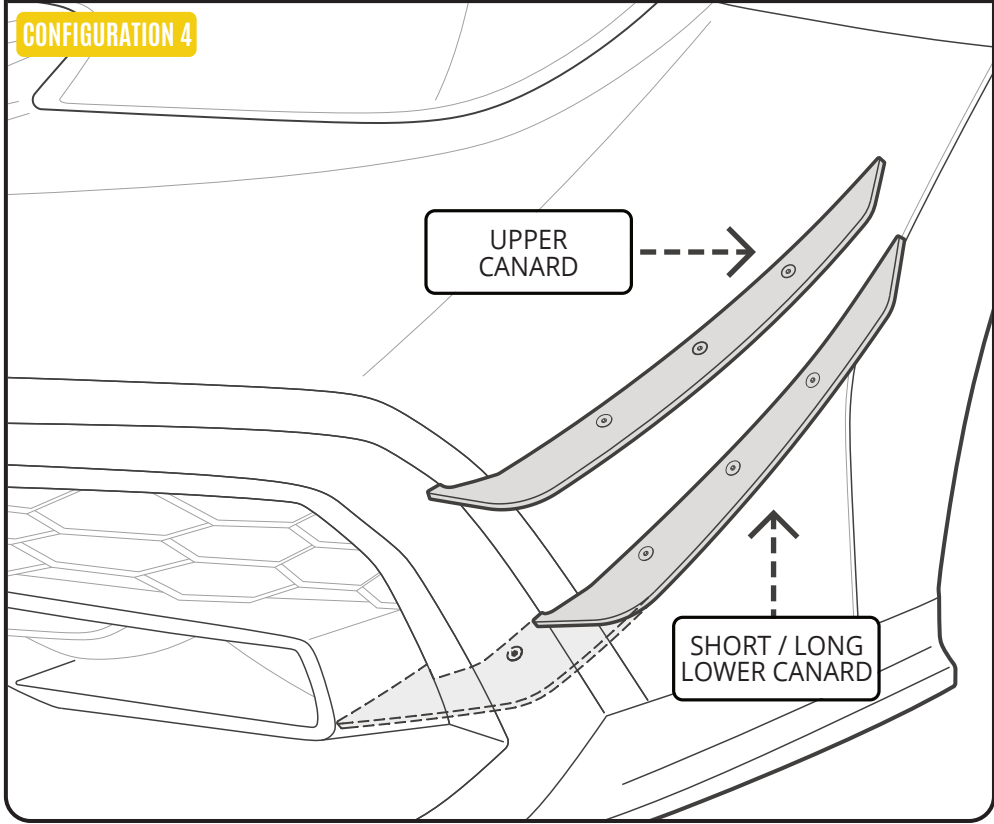

## CONFIGURATION 1

### SHORT LOWER CANARD

#### CONFIGURATION 1 - LOWER CANARD SHORT SOLD SEPARATELY

Lower canard set comes with both short and long dive planes. Sold separately.

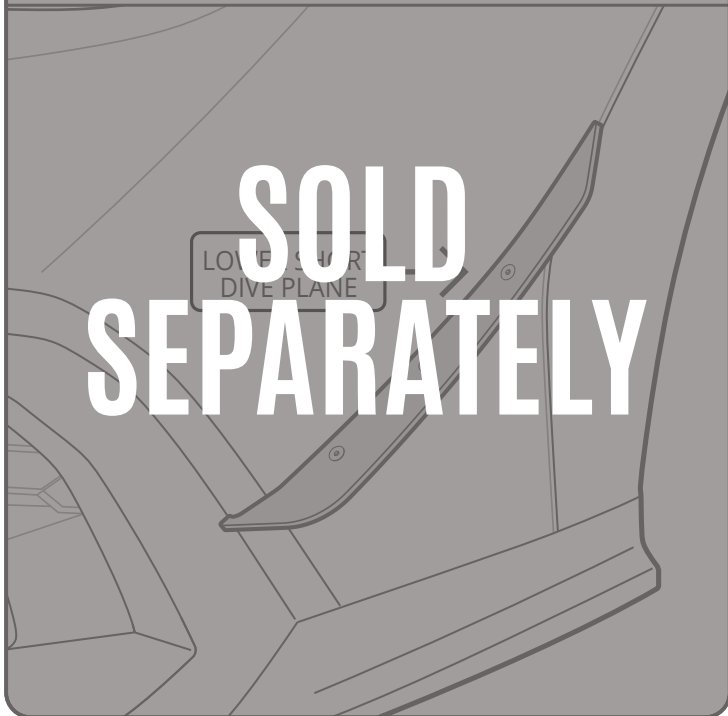

## CONFIGURATION 2

### LONG LOWER CANARD

#### CONFIGURATION 2 - LOWER CANARD LONG SOLD SEPARATELY

Lower canard set comes with both short and long dive planes. Sold separately.

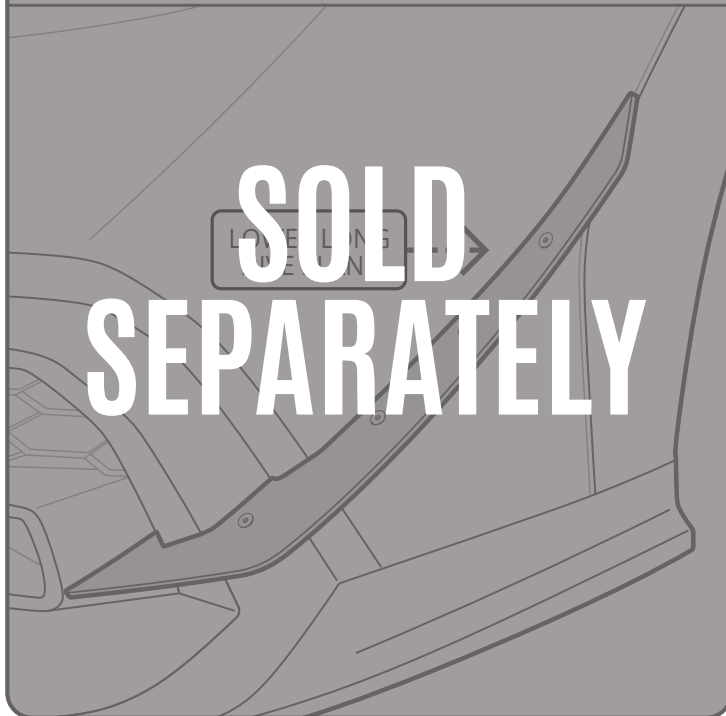

# CONFIGURATION 3

## UPPER CANARD ONLY

### CONFIGURATION 3 - UPPER CANARD INSTALLATION PAGE 06-08

Upper canard sold separately or purchased together as dual canard setup.  
Refer to Page 06-08 for installation or upper canard instruction.

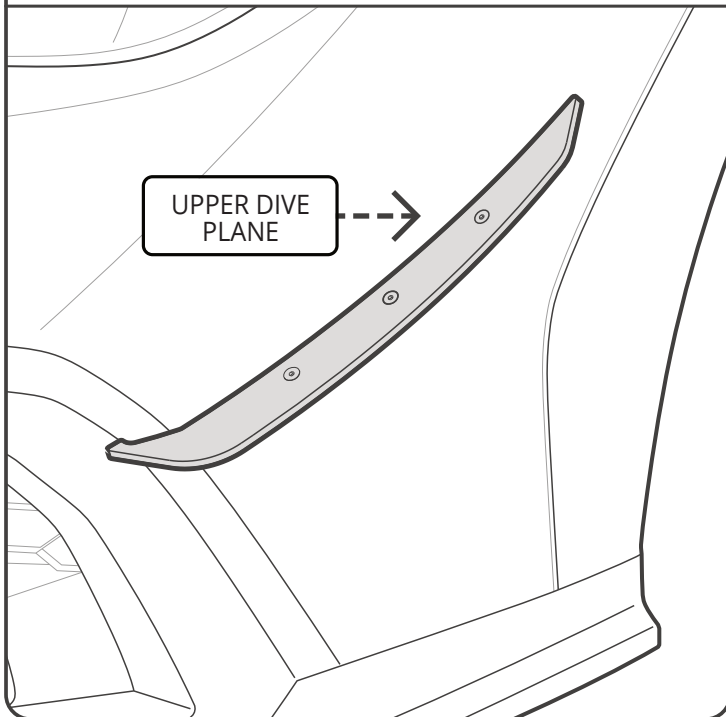

# CONFIGURATION 4

## DUAL CANARD SETUP

### CONFIGURATION 4 - DUAL CANARD SOLD SEPARATELY

Dual canard setup consists of upper canard and lower canard sets. Lower canard can be installed with either short or long dive planes. Sold separately.

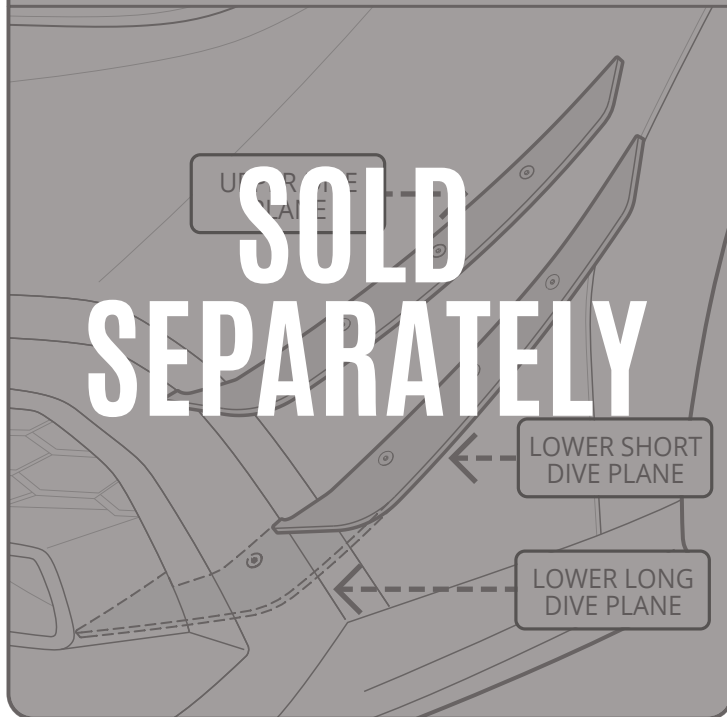

# PARTS AND ASSEMBLY COMPONENTS

## SUBARU VB WRX SEDAN UPPER CANARDS

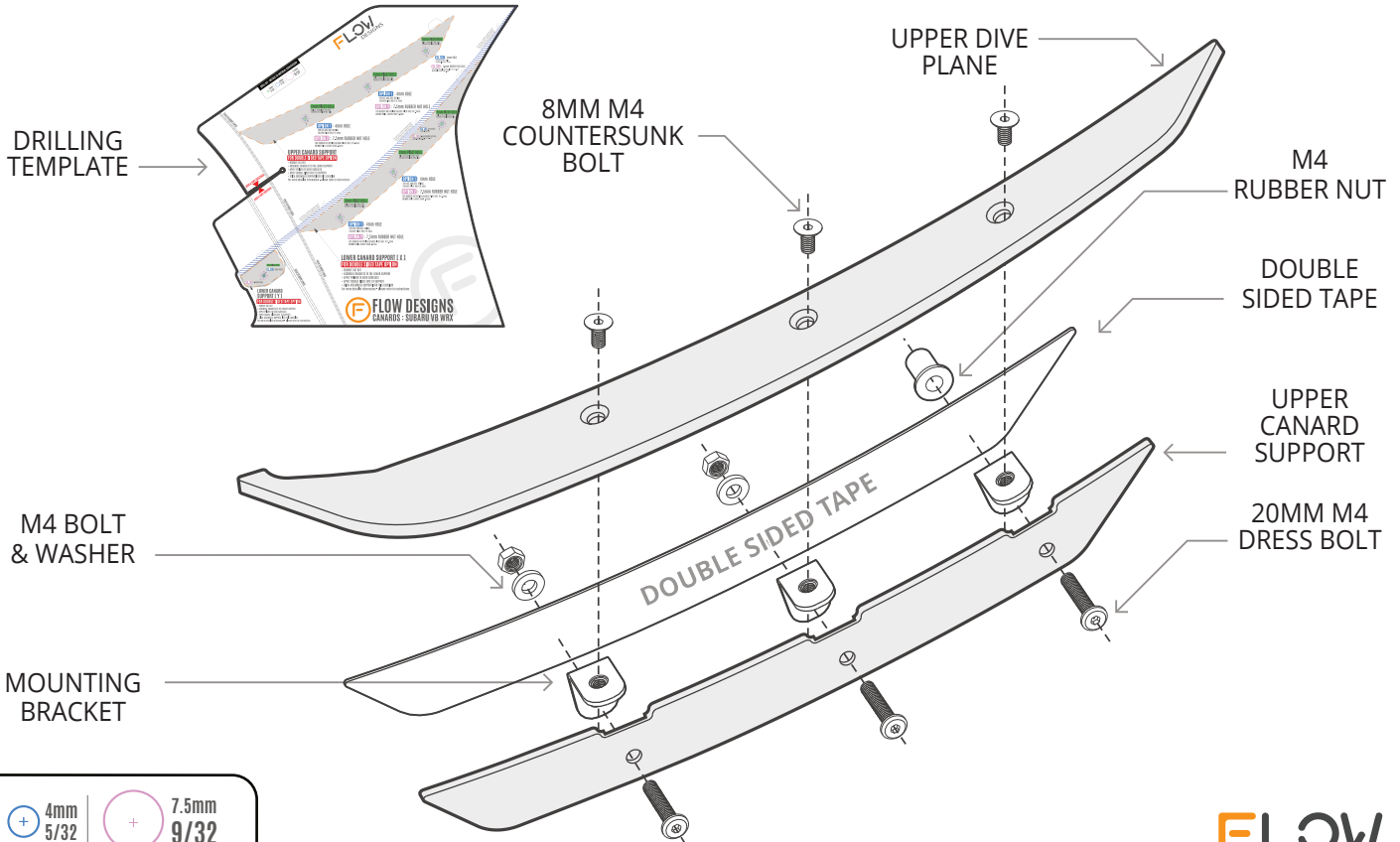

2mm 5/64 | 4mm 5/32 | 7.5mm 9/32

DRILL BIT - METRIC TO IMPERIAL CONVERSION

# PARTS AND FITTING KIT

## SUBARU VB WRX SEDAN UPPER CANARDS

**PAGE 05**

### PARTS LIST

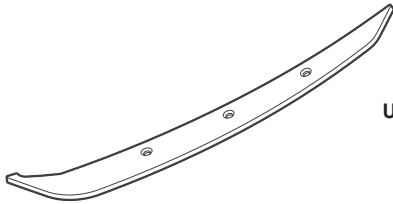

UPPER DIVE  
PLANE  
**X 2**

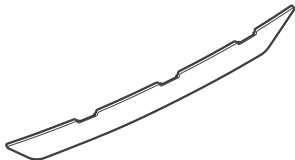

UPPER CANARD  
SUPPORT  
**X 2**



MOUNTING  
BRACKETS  
**X 6**



ALCOHOL  
SWAB  
+  
PRIMER  
**X 2**

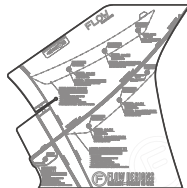

DRILLING  
TEMPLATE  
**X 2**



M4  
NUT & 9MM  
WASHER  
**X 6**



M4  
RUBBER NUT  
**X 6**

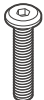

DRESS BOLT  
BLACK STAINLESS  
M4 X 20MM  
**X 6**



COUNTERSUNK  
BOLT  
BLACK STAINLESS  
M4 X 8MM  
**X 6**

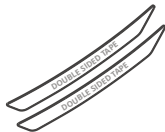

3M DOUBLE  
SIDED TAPE  
SET  
**X 1**

### OPTIONAL ACCESSORIES (SOLD SEPARATELY)



# SOLD SEPARATELY

LOWER CANARD  
SET

Dual Canard set or Single Lower  
Canard set sold separately.

### STEP 1

- **CLEAN THE BUMPER BEFORE INSTALLING CANARDS.**
- **Align the template** to the front bumper and wheel arch.
- **Contour the template** along the fold lines to suit the vehicle. **Join and tape the template** where required.
- **Tape the template** to the vehicle.

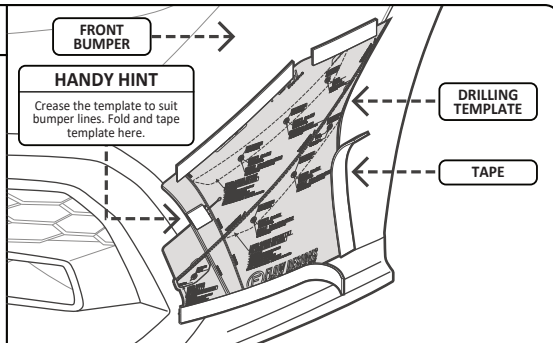

### STEP 2

- **Choose Mechanical Fastening** option;
- Option 1** - Nut & Bolt  
**Option 2** - Rubber Nut
- **Mark hole** through drilling template and **drill 2mm pilot hole.**
- **For Option 1**, enlarge hole to 4mm.
- **For Option 2**, enlarge hole to 7.5mm.
- **Drill out mounting holes on Upper Canard Support with 4.5mm bit.**

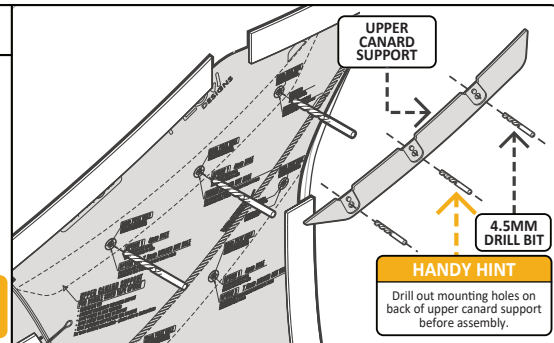

### STEP 3

- **Assemble the mounting brackets** to the **Upper Canard Support.**
- **Prime and apply Double Sided tape** to the back of the assembled canard support.
- **Peel perforated cut out** on template before applying primer to the vehicle.

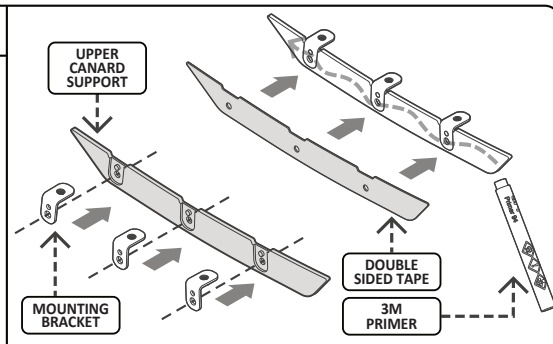

### STEP 4

- **Remove tape backing** and **align canard support** to drilled holes.
- **Stick the assembled canard support** to the vehicle and **secure using mounting bolts.**
- **Align the Upper Dive plane** to the canard support and **mount the dive plane** to the upper support using mounting bolts.

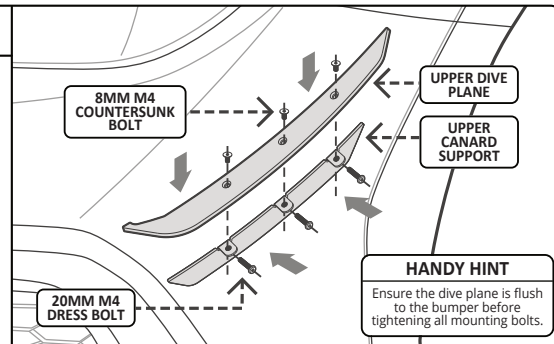

## MECHANICAL FASTENING FITTING KIT

### OPTION 1



M4  
NUT & 9MM  
WASHER

X 6

### OPTION 2



M4  
RUBBER NUT

X 6

### CANARD SUPPORT MOUNTING BOLTS

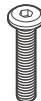

DRESS BOLT  
BLACK STAINLESS  
M4 X 20MM

X 6

### DIVE PLANE MOUNTING BOLTS



COUNTERSUNK  
BOLT  
BLACK STAINLESS  
M4 X 8MM

X 6

### MOUNTING BRACKETS



X 6

### ALCOHOL SWAB + PRIMER



X 2

### DOUBLE SIDED TAPE

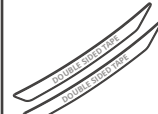

3M DOUBLE  
SIDED TAPE  
SET

X 1

## STEP 1

- **CLEAN THE BUMPER BEFORE INSTALLING CANARDS.**
- **Align the template** to the front bumper and wheel arch.
- **Contour the template** along the fold lines to suit the vehicle. **Join and tape the template** where required.
- **Tape the template** to the vehicle.

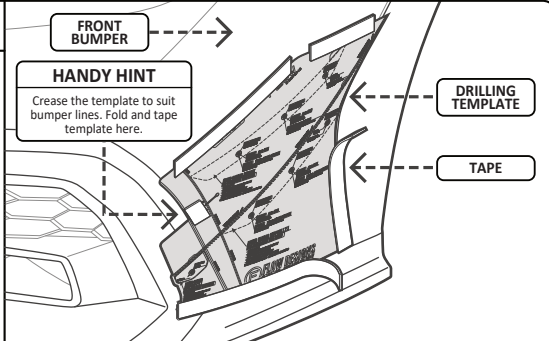

## STEP 2

- **Assemble** the mounting brackets to the **Upper canard support**.
- **Prime and apply Double Sided tape** to the back of the assembled canard support.

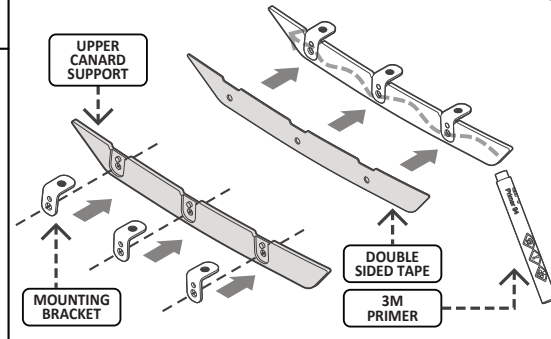

## STEP 3

- **Peel perforated cut out** on template before applying primer to the vehicle.
- **Remove tape backing and align canard support** to cutout in template.

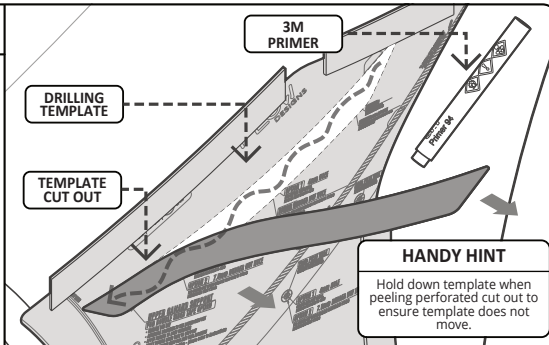

## STEP 4

- **Stick** the assembled canard support to the vehicle and **hold firmly for 2 minutes**.
- **Remove template** from front bumper.
- **Align the Upper Dive plane** to the canard support and **mount the dive plane** to the upper support using mounting bolts.

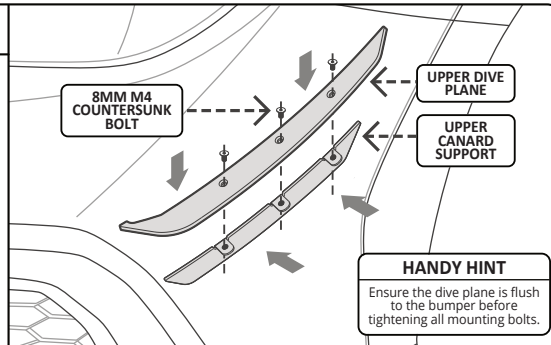

## ADHESIVE FASTENING FITTING KIT

### DOUBLE SIDED TAPE

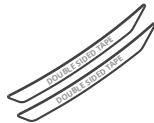

3M DOUBLE SIDED TAPE SET  
**X 1**

### DIVE PLANE MOUNTING BOLTS



COUNTERSUNK BOLT  
BLACK STAINLESS  
M4 X 8MM  
**X 6**

### MOUNTING BRACKETS



**X 6**

### ALCOHOL SWAB + PRIMER



**X 2**

# INSTALLATION DIAGRAM - DUAL CANARDS

## MOUNTING UPPER DIVE PLANE AFTER INSTALLATION OF LOWER CANARDS

PAGE 08

CONFIGURATION 4

### STEP 1

#### • CLEAN THE BUMPER BEFORE INSTALLING CANARDS.

• If lower canards are already installed on the vehicle, trim off the lower part of the template along the top of the blue line as shown.

• Align the template to the front bumper and wheel arch and to the top of the lower canard.

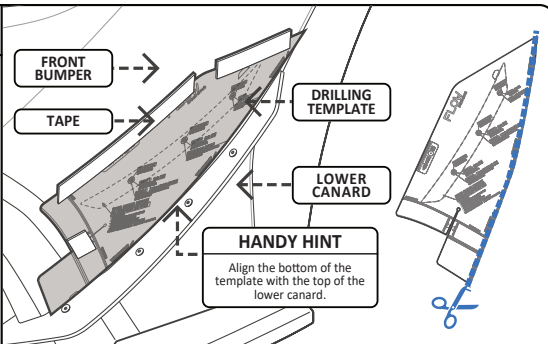

### STEP 2

• Choose Mechanical or Adhesive Fastening option.

• For Adhesive fastening, skip to next step.

• For Mechanical fastening, drill holes through template for Upper Canard Support.

• Drill out mounting holes on Upper Canard Support with 4.5mm bit.

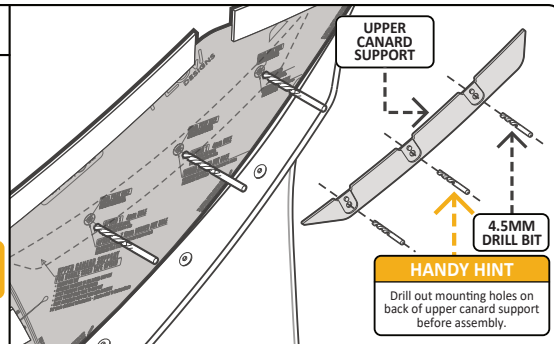

### STEP 3

• Assemble the mounting brackets to the Upper canard support.

• Prime and apply Double Sided tape to the back of the assembled canard support.

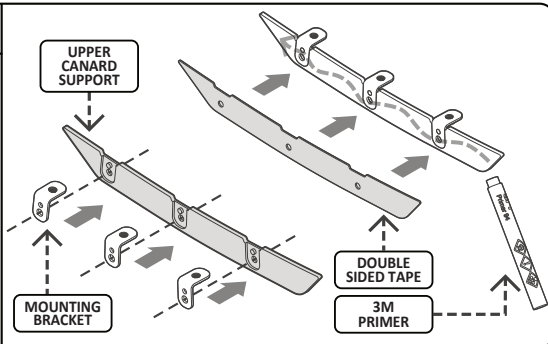

### STEP 4

• Remove tape backing and align canard support to template.

• Stick the assembled canard support to the vehicle and secure using mounting bolts if using mechanical fastening.

• Align the Upper Dive plane to the canard support and mount the dive plane to the upper support using mounting bolts.

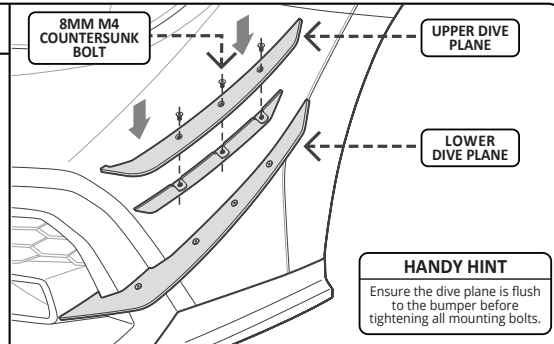

## UPPER CANARD FITTING KIT

### OPTION 1



M4 NUT & 9MM WASHER

X 6

### OPTION 2



M4 RUBBER NUT

X 6

### CANARD SUPPORT MOUNTING BOLTS

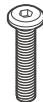

DRESS BOLT  
BLACK STAINLESS  
M4 X 20MM

X 6

### DIVE PLANE MOUNTING BOLTS



COUNTERSUNK BOLT  
BLACK STAINLESS  
M4 X 8MM

X 6

### MOUNTING BRACKETS



X 6

### ALCOHOL SWAB + PRIMER



X 2

### DOUBLE SIDED TAPE

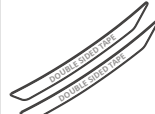

3M DOUBLE SIDED TAPE SET  
X 1