

FITTING DIAGRAM - PAGE 1

SUBARU VB WRX SEDAN: REAR SPAT INSTRUCTIONS

INSTALLATION AND FITTING SERVICES

If you are having any difficulties please seek professional advice from the listed International and Domestic Authorised Dealers on our website.

www.flowdesignsaustralia.com

**BUMPER REMOVAL
NOT REQUIRED**

INSTRUCTIONAL
VIDEO QR CODE



FITTING KIT

a

**M6 BOLT
40mm LONG
X 2**

PLEASE NOTE:
**REMOVE OEM CLIP
AND USE OEM HOLE.
ENLARGE HOLE
ON REAR MUD GUARD
USING 11MM DRILL BIT**

b

**M6 BOLT
40mm LONG
X 2**

PLEASE NOTE:
**DRILL HOLE IN
BUMPER USING
8MM DRILL BIT.
ENLARGE HOLE
ON REAR MUD GUARD
USING 11MM DRILL BIT**

c

**M6 BOLT
40mm LONG
X 2**

PLEASE NOTE:
**REMOVE OEM CLIP
AND USE OEM HOLE.
ENLARGE HOLE
ON REAR MUD GUARD
USING 11MM DRILL BIT**

d

**M6 BOLT
30mm LONG
X 2**

PLEASE NOTE:
**REMOVE OEM CLIP
AND USE OEM HOLE.
DRILLING NOT REQUIRED**

HANDY HINTS

Align corner of spat flush to the back edge of the rear bumper.

MOUNTING BOLT (B)

Clamp rear spat to rear bumper before drilling out 8mm hole for mounting bolt (b).

HANDY HINTS

For best alignment, align edge of spat to the inside edge of the rear bumper.

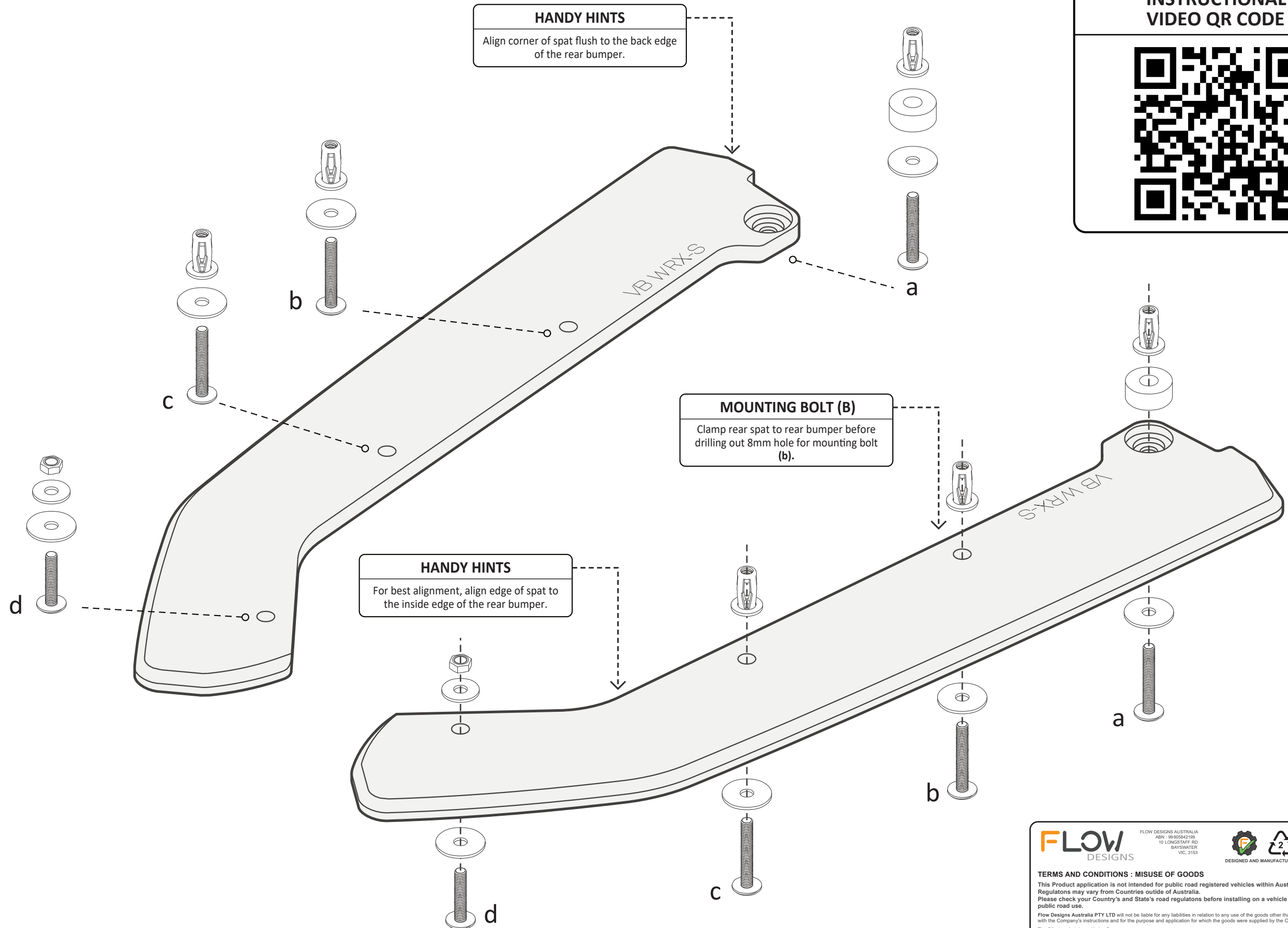

FLOW DESIGNS

FLOW DESIGNS AUSTRALIA
ABN : 99 605842199
10 LONGSTAFF RD
BAYSWATER
VIC. 3153

TERMS AND CONDITIONS : MISUSE OF GOODS

This Product application is not intended for public road registered vehicles within Australia. Regulations may vary from Countries outside of Australia. Please check your Country's and State's road regulations before installing on a vehicle intended for public road use.

Flow Designs Australia PTY LTD will not be liable for any liabilities in relation to any use of the goods other than in strict accordance with the Company's instructions and for the purpose and application for which the goods were supplied by the Company.

The Client undertakes with the Company:

- That it will acquaint itself with the requirements of all relevant government or statutory and other authorities, bodies or corporations relating to the goods and/or services and to the applications to which the goods and/or services are to be put;
- That at all times while the goods are in its possession or under its control it will comply with such requirements;
- That it will procure that any purchaser of goods from it will also acquaint itself with, and will comply with, such requirements;
- That it will indemnify the Company against any liability resulting from a breach of any such requirements.

www.flowdesignsaustralia.com

FITTING GUIDE - PAGE 2

SUBARU VB WRX SEDAN: REAR SPAT INSTRUCTIONS

INSTALLATION AND FITTING SERVICES

If you are having any difficulties please seek professional advice from the listed International and Domestic Authorised Dealers on our website.

www.flowdesignsaustralia.com

BUMPER REMOVAL NOT REQUIRED

OEM REAR MUD GUARD JACKNUT INSTALLATION GUIDE

Unclip OEM clips on rear bumper before installation of rear spat. Pull out rear mudguard to access OEM holes.

Enlarge OEM holes on rear mudguard using **11mm drill bit**. OEM mudguard does not need to be removed to install jacknuts.

Insert and compress all jacknuts. Ensure Jacknuts are completely compressed before repositioning mudguard back to align with OEM holes.

HANDY HINTS

Remove OEM clips before enlarge OEM holes in rear mud guard. Clips will be replaced with mounting bolts.

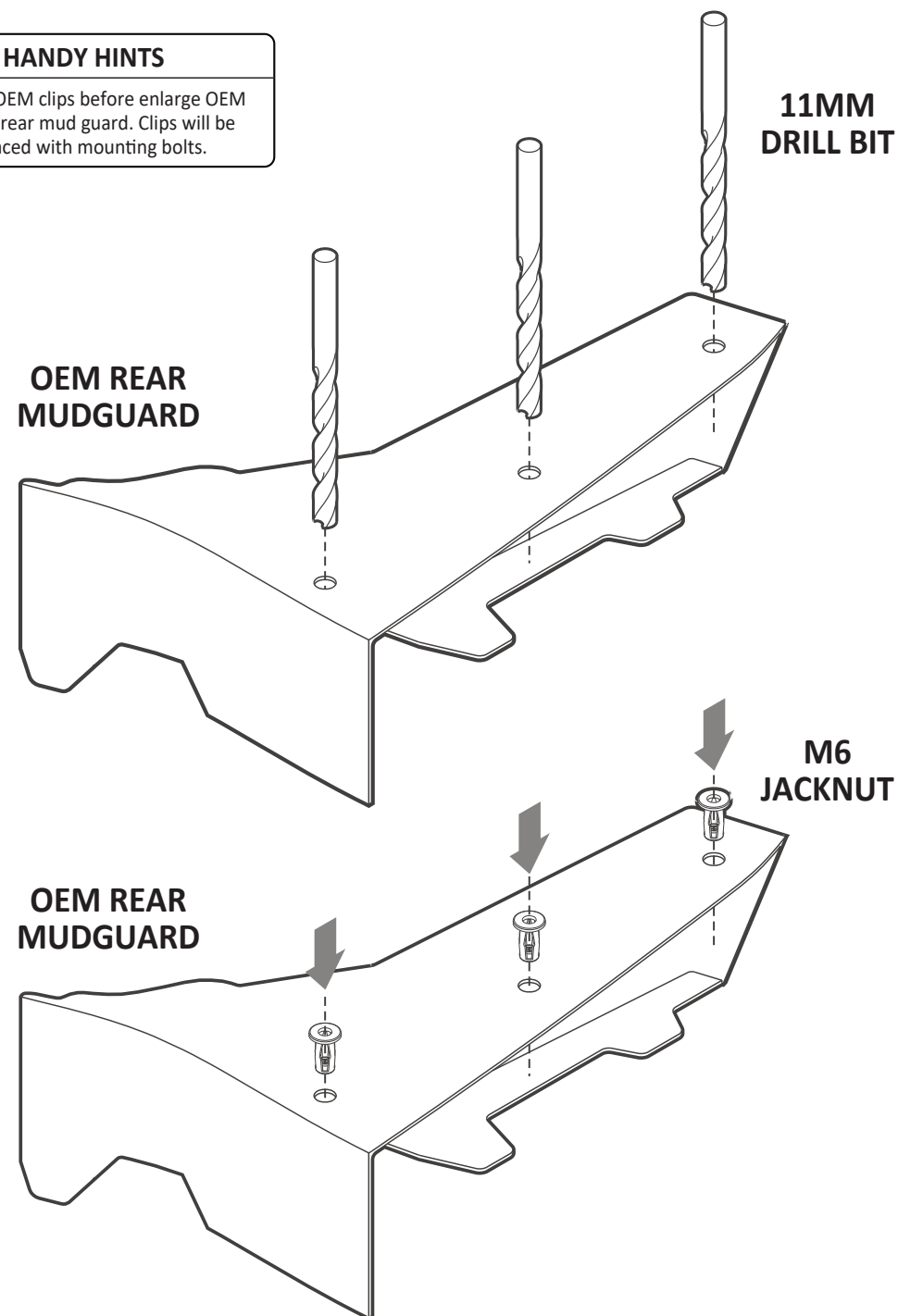

FITTING KIT - A INSTALLATION GUIDE

Install 3d printed spacer with top lip facing down as shown prior to installation of rear spat.

Push spacer into hole to lock into place.

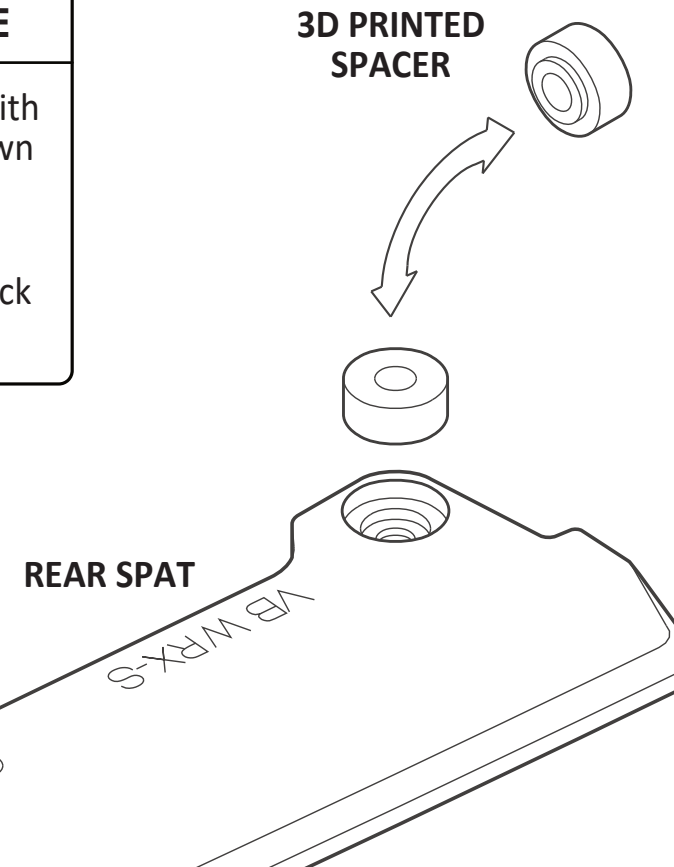

JACKNUT INSTALLATION GUIDE

Enlarge mounting hole with **11mm drill bit** for jacknut. Thread jacknut through supplied compression tool and bolt as shown above.

Insert jacknut into drilled hole in rear mud guard before compressing. Ensure jacknut is completely compressed before removing bolt.

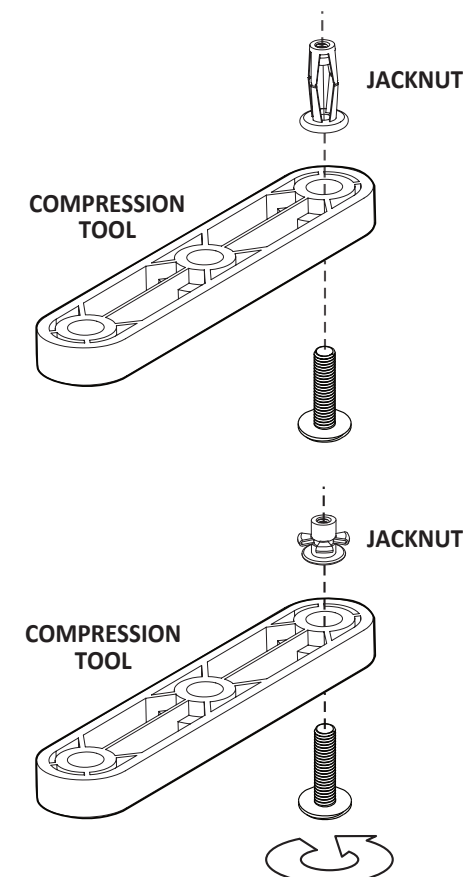

INSTRUCTIONAL VIDEO QR CODE



JACKNUT INSTALLATION VIDEO QR CODE

