

FITTING DIAGRAM

SUBARU WRX VA : REAR UNDER SPOILER

INSTALLATION AND FITTING SERVICES

If you are having any difficulties please seek professional advise from the listed International and Domestic Authorised Dealers on our website.

www.flowdesignsaustralia.com

**BUMPER REMOVAL
REQUIRED**

CRASH BAR BRACKET TO UNDER SPOILER

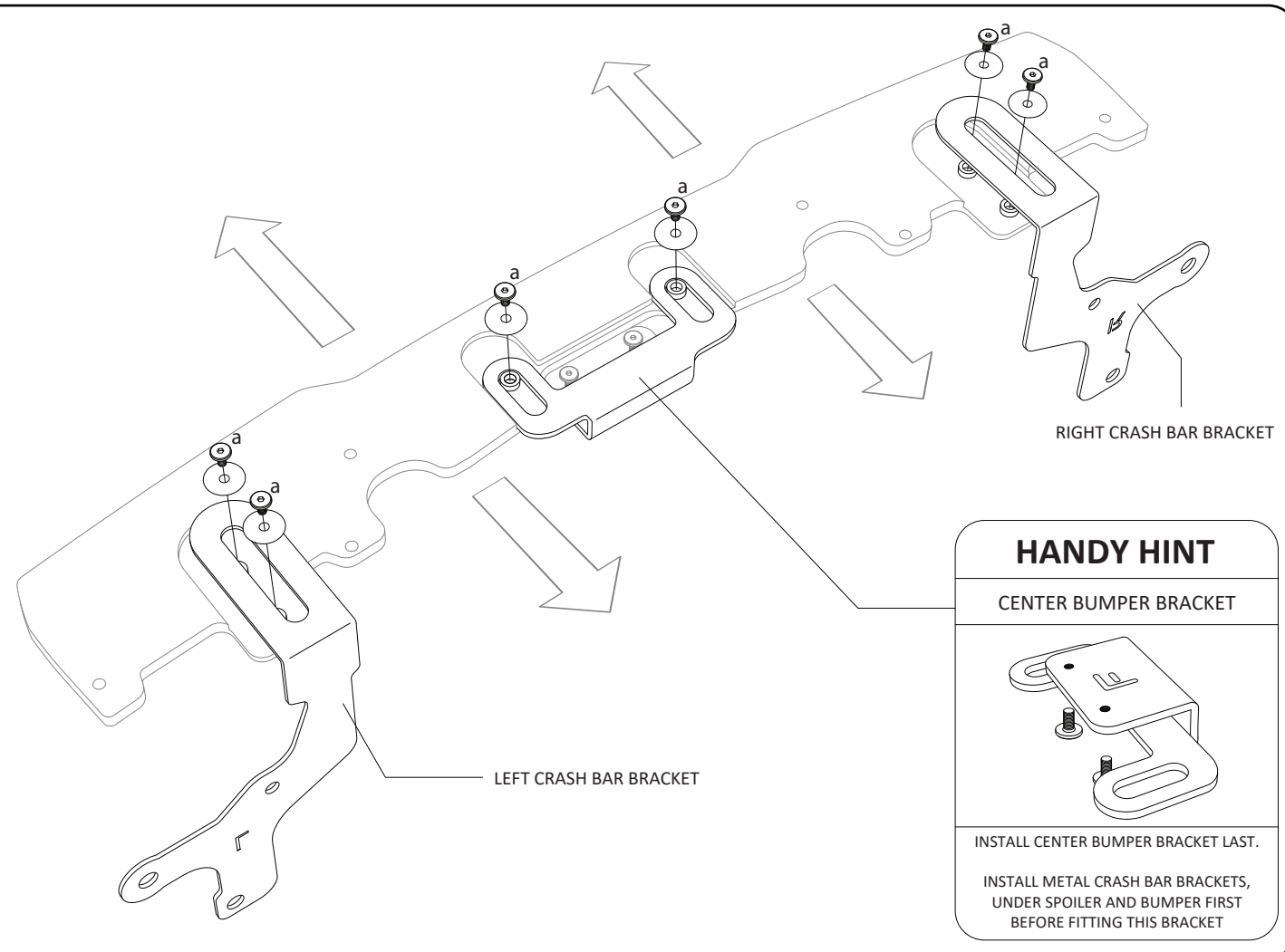

CRASH BAR BRACKET TO CRASH BAR

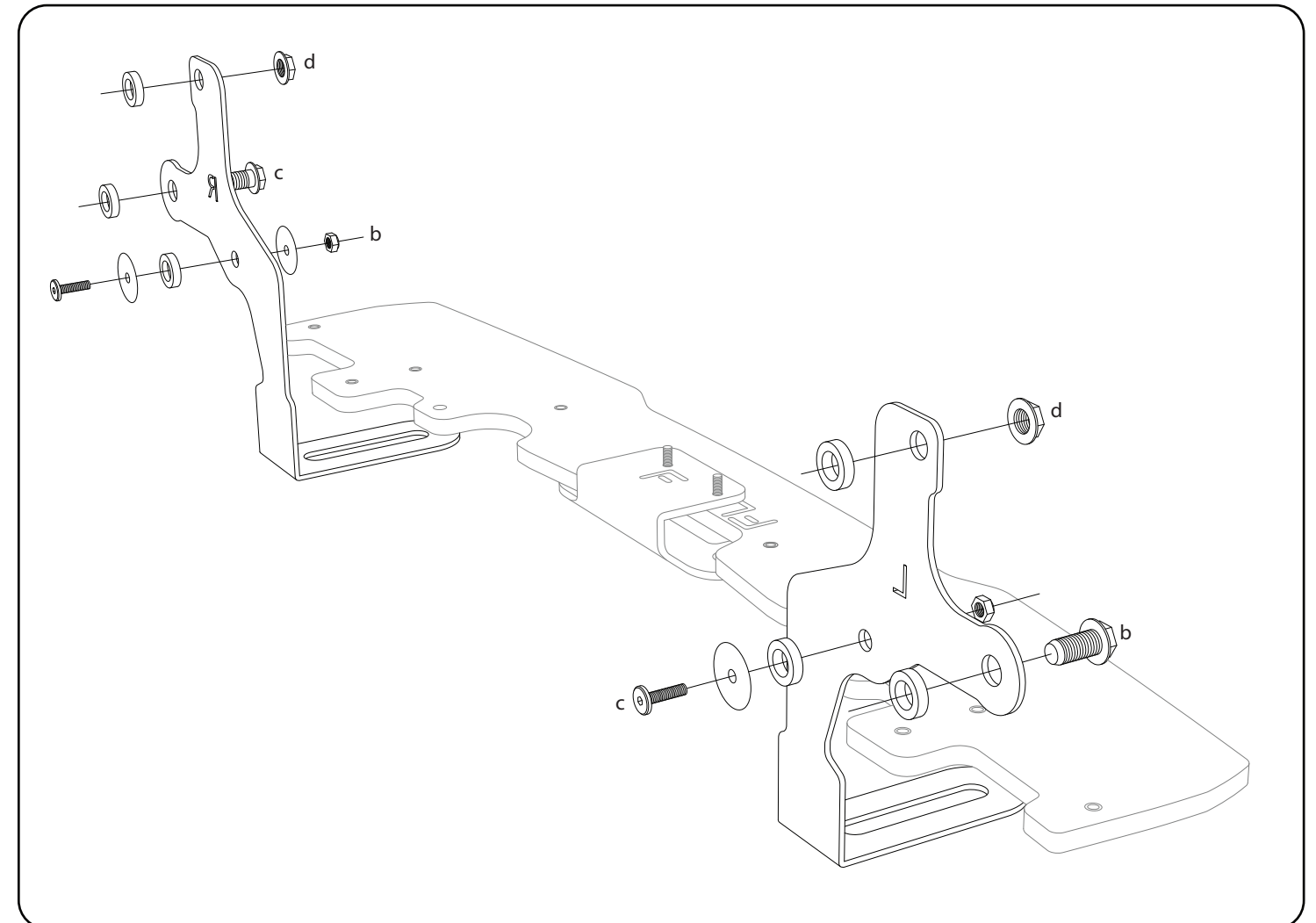

a

**M6 BOLT
12mm LONG**

X 6

PLEASE NOTE:
HAND TIGHTEN
DO **NOT** OVERTIGHTEN

**CENTER BRACKET
DRILLING TEMPLATE**

ALIGN DRILLING TEMPLATE
WITH BOTTOM OF BUMPER
UNDER REAR FOG LIGHT

USE A 7mm DRILL BIT TO DRILL
THE 2 MIDDLE HOLES

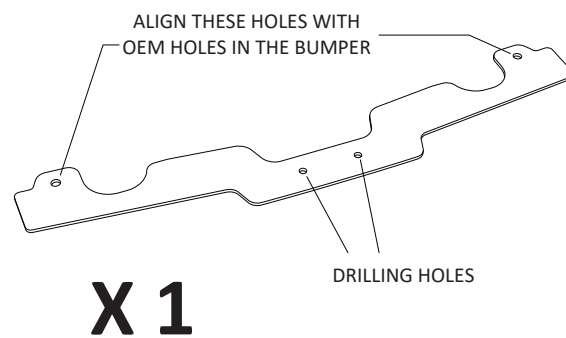

b

**M6 BOLT
25mm LONG**

X 2

PLEASE NOTE:
USE OEM HOLE

c

**SUBARU OEM
BOLT**

X 2

PLEASE NOTE:
REMOVE BOLT.
ADD ALUMINUM SPACER.
RE USE BOLT TO FASTEN.

d

**SUBARU OEM
NUT**

X 2

PLEASE NOTE:
REMOVE NUT.
ADD ALUMINUM SPACER.
RE USE NUT TO FASTEN.