

# FITTING DIAGRAM

SUBARU WRX VA : REAR UNDER SPOILER + FLOW LOCK FINS

INSTALLATION AND FITTING SERVICES

If you are having any difficulties please seek professional advise from the listed International and Domestic Authorised Dealers on our website.

www.flowdesignsaustralia.com

**BUMPER REMOVAL  
REQUIRED**

## CRASH BAR BRACKET TO UNDER SPOILER

## CRASH BAR BRACKET TO CRASH BAR

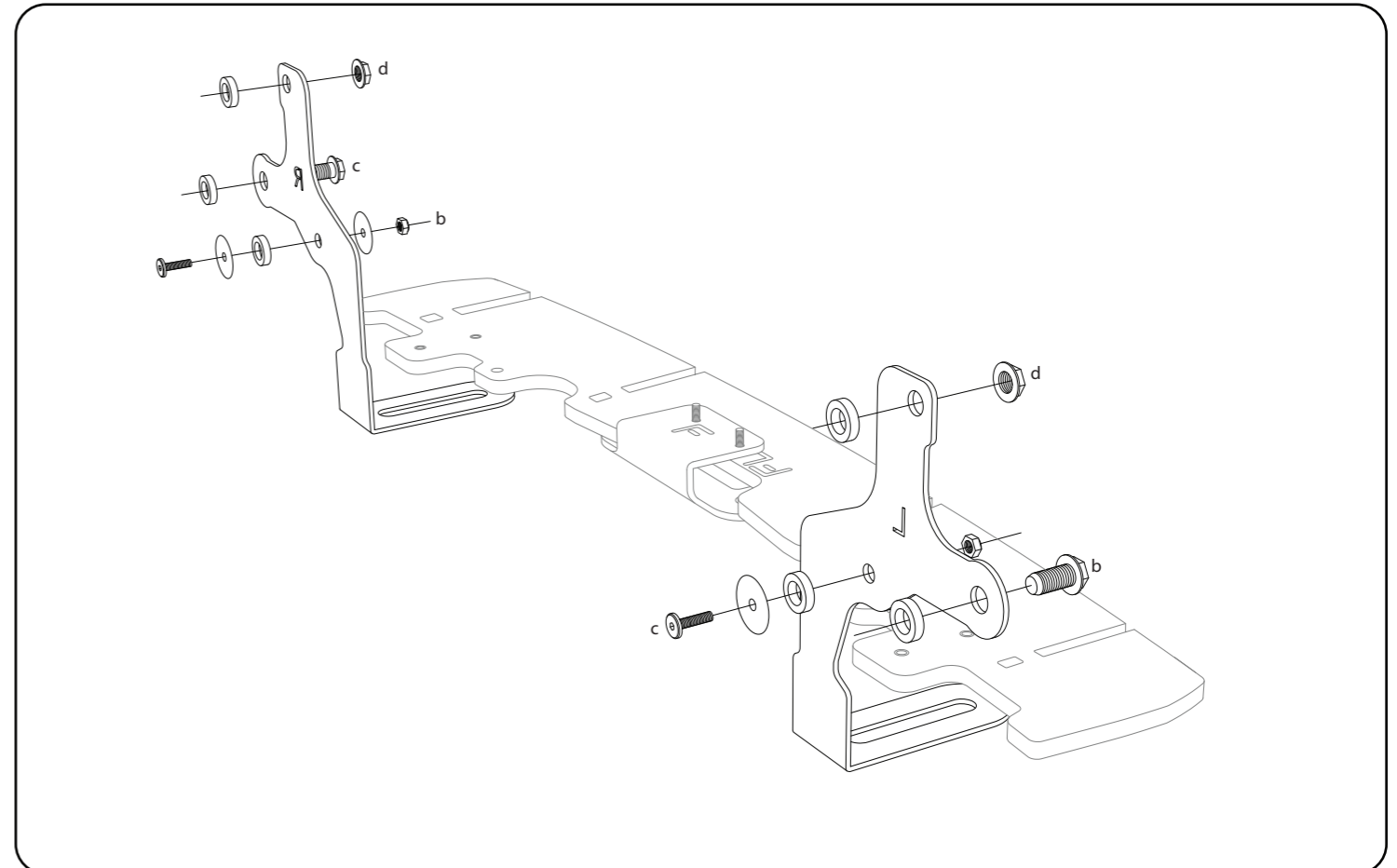
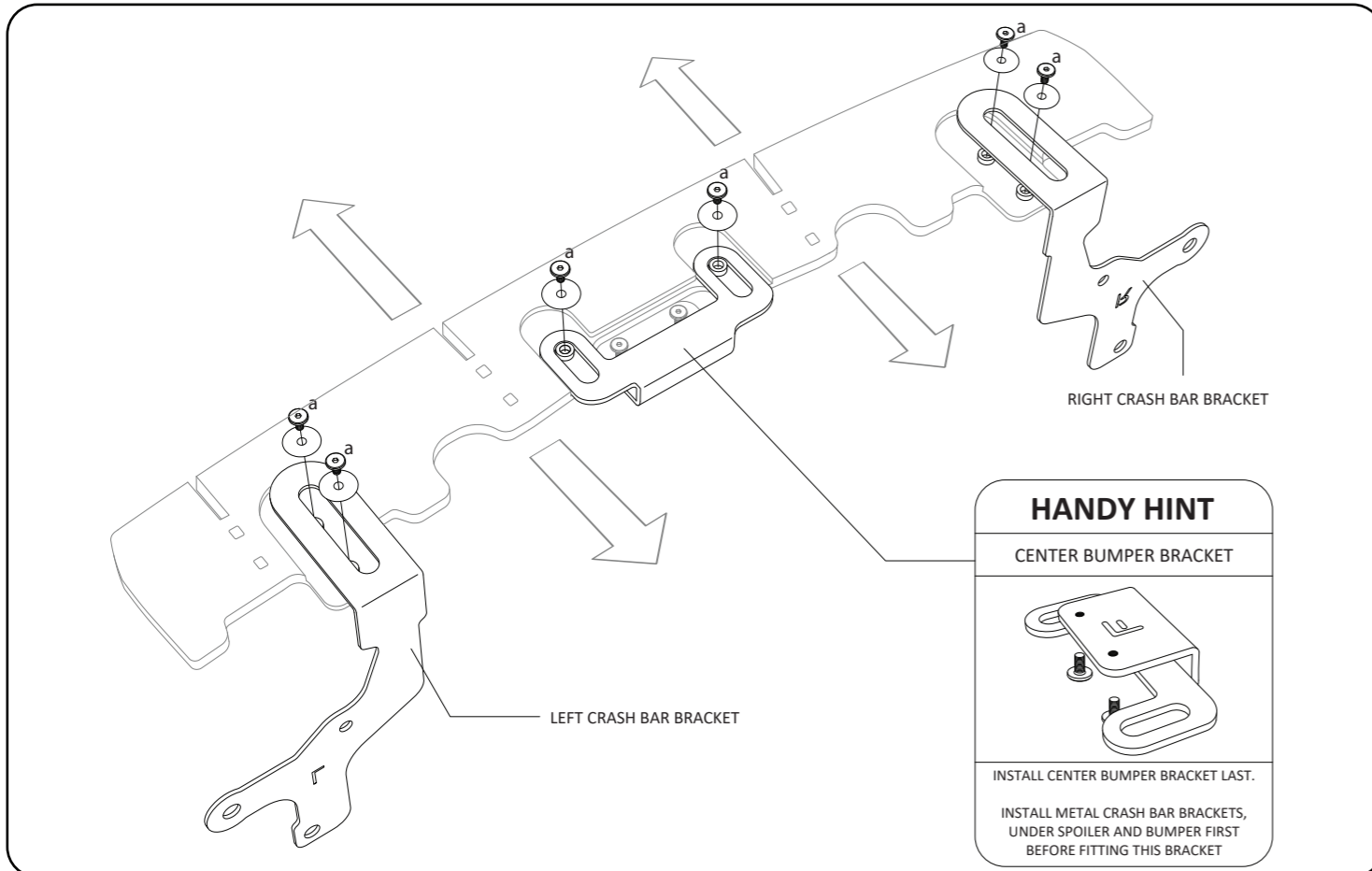

**a**

**M6 BOLT  
12mm LONG**

**X 6**

PLEASE NOTE:  
HAND TIGHTEN  
DO **NOT** OVERTIGHTEN

**CENTER BRACKET  
DRILLING TEMPLATE**

ALIGN DRILLING TEMPLATE  
WITH BOTTOM OF BUMPER  
UNDER REAR FOG LIGHT

USE A 7mm DRILL BIT TO DRILL  
THE 2 MIDDLE HOLES

ALIGN THESE HOLES WITH  
OEM HOLES IN THE BUMPER

DRILLING HOLES

**X 1**

**b**

**M6 BOLT  
25mm LONG**

**X 2**

PLEASE NOTE:  
USE OEM HOLE

**c**

**SUBARU OEM  
BOLT**

**X 2**

PLEASE NOTE:  
REMOVE BOLT.  
ADD ALUMINUM SPACER.  
RE USE BOLT TO FASTEN.

ONLY SPACER  
SUPPLIED

**d**

**SUBARU OEM  
NUT**

**X 2**

PLEASE NOTE:  
REMOVE NUT.  
ADD ALUMINUM SPACER.  
RE USE NUT TO FASTEN.

ONLY SPACER  
SUPPLIED

**PLEASE NOTE**  
FOR ADD ON ACCESSORIES

**DO NOT**  
OVERTIGHTEN FASTENERS  
INTO BRASS FITTINGS

HAND TIGHTEN ONLY

**FLOW**  
DESIGNS