

FITTING INSTRUCTIONS

MITSUBISHI CJ RALLY ART : FRONT SPLITTER

FITTING KIT

PLEASE NOTE:
BUMPER REMOVAL RECOMMENDED
FOR BETTER FITMENT

a

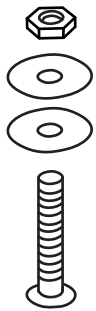

**M6 BOLT
50mm LONG**

X 4

PLEASE NOTE:
DRILLING REQUIRED
TO FASTEN TO BUMPER

b

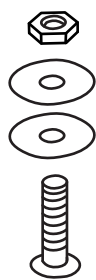

**M6 BOLT
30mm LONG**

X 10

PLEASE NOTE:
DRILLING REQUIRED
TO FASTEN TO BUMPER

