

# HYUNDAI i30 PD1 PD2 PD3 SIDE SPLITTER INSTRUCTIONS

PLEASE SCAN QR CODE  
TO WATCH INSTRUCTIONAL VIDEO  
BEFORE INSTALLING

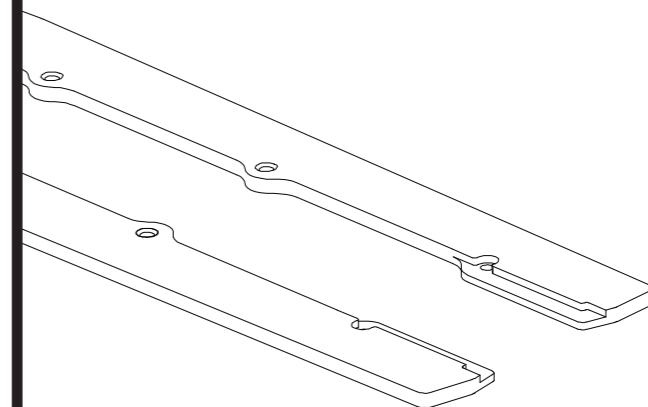
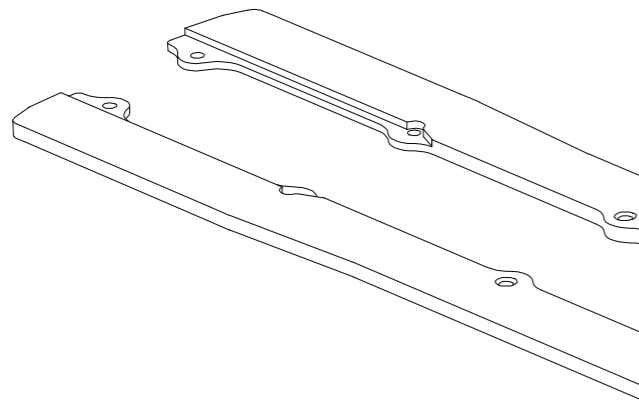

# FITTING GUIDE

## HYUNDAI i30 PD 1,2,3: SIDE SPLITTER INSTRUCTIONS PAGE 1

### INSTALLATION AND FITTING SERVICES

If you are having any difficulties please seek professional advise from the listed International and Domestic Authorised Dealers on our website.

www.flowdesignsaustralia.com

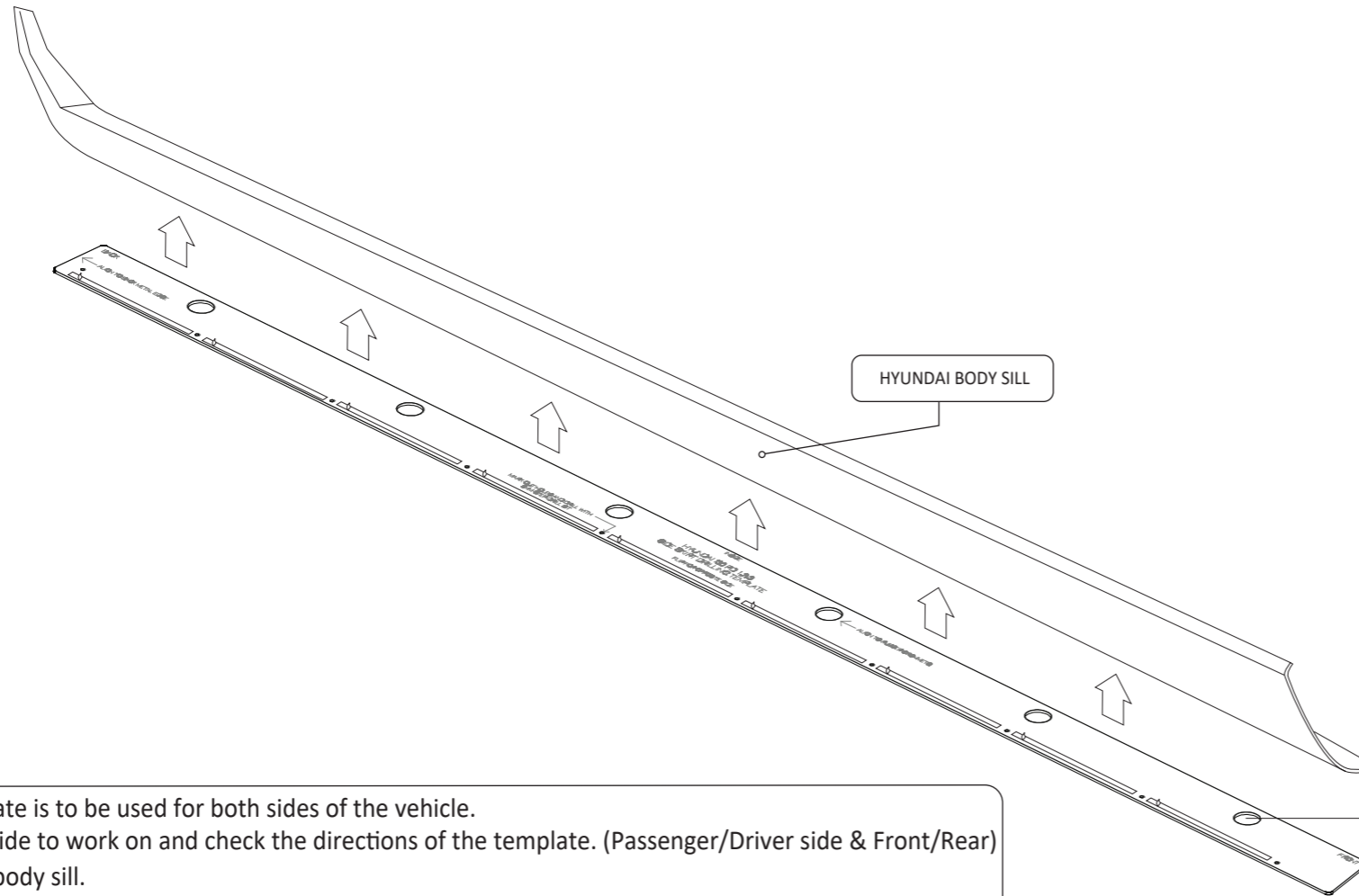

## HANDY HINTS

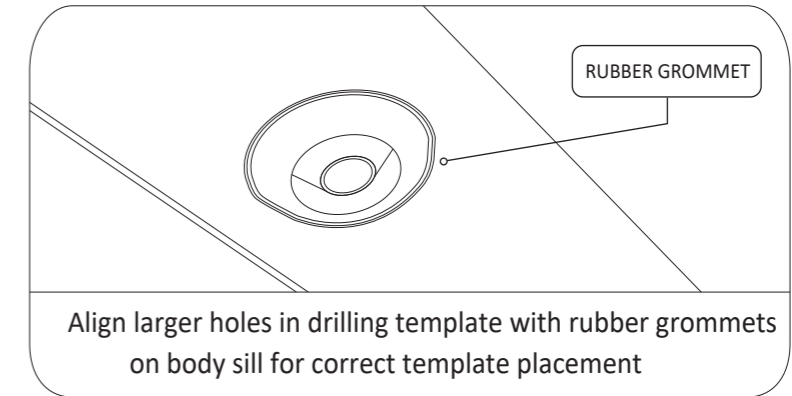

### STEP 1

- Please Note : Drilling template is to be used for both sides of the vehicle.
- Before you start, choose a side to work on and check the directions of the template. (Passenger/Driver side & Front/Rear)
- Clean the underside of the body sill.
- Peel double sided tape from the drilling template and align with the back metal edge and underside of the body sill.

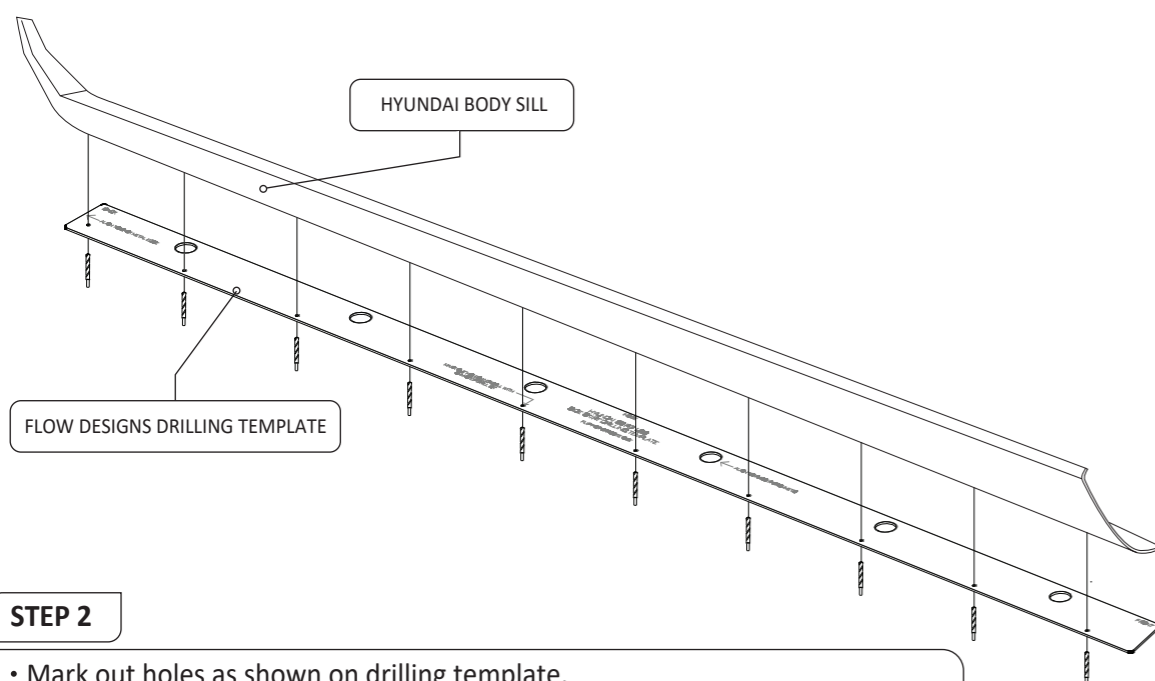

### STEP 2

- Mark out holes as shown on drilling template.
- Center punching is recommended to stop drill bits from wandering.
- Pilot drill holes with a 3mm drill bit.
- Enlarge pilot holes to 9mm with step bit or 9mm drill bit.

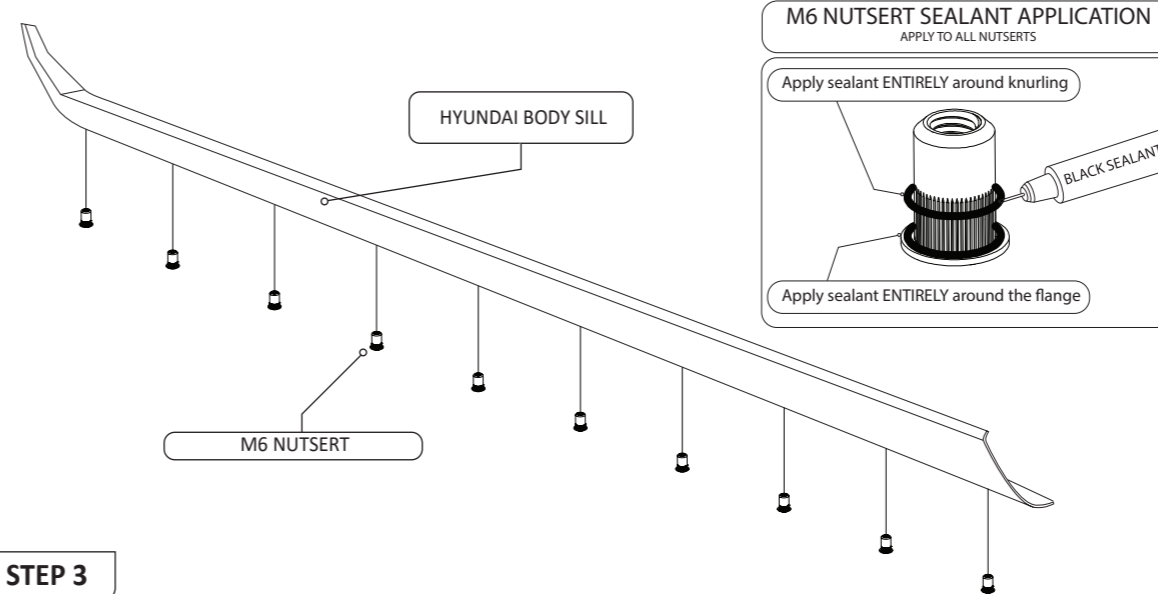

### STEP 3

- Apply sealant to nutserts.
- To ensure a watertight seal and prevent rusting, apply sealant to knurling (Top section) and flange (bottom section) of the nutsert.
- Insert nutsert into drilled holes and compress using nutsert tool. **(tool not supplied)**
- Align side splitter to body sill and install using supplied bolts (see page 2 for further details)
- Repeat this process with the other side.

Scan QR code to see Instructional video



**TERMS AND CONDITIONS : MISUSE OF GOODS**  
 This Product application is not intended for public road registered vehicles within Australia. Regulations may vary from Countries outside of Australia. Please check your Country's and State's road regulations before installing on a vehicle intended for public road use.  
 Flow Designs Australia PTY LTD will not be liable for any liabilities in relation to any use of the goods other than in strict accordance with the Company's instructions and for the purpose and application for which the goods were supplied by the Company.  
 The Client undertakes with the Company:  
 • That it will acquaint itself with the requirements of all relevant government or statutory and other authorities, bodies or corporations relating to the goods and/or services and to the applications to which the goods and/or services are to be put;  
 • That at all times while the goods are in its possession or under its control it will comply with such requirements;  
 • That it will procure that any purchaser of goods from it will also acquaint itself with, and will comply with, such requirements;  
 • That it will indemnify the Company against any liability resulting from a breach of any such requirements.  
 www.flowdesignsaustralia.com

# FITTING GUIDE

HYUNDAI i30 PD 1,2,3: SIDE SPLITTER INSTRUCTIONS PAGE 2

## INSTALLATION AND FITTING SERVICES

If you are having any difficulties please seek professional advice from the listed International and Domestic Authorised Dealers on our website.

[www.flowdesignsaustralia.com](http://www.flowdesignsaustralia.com)

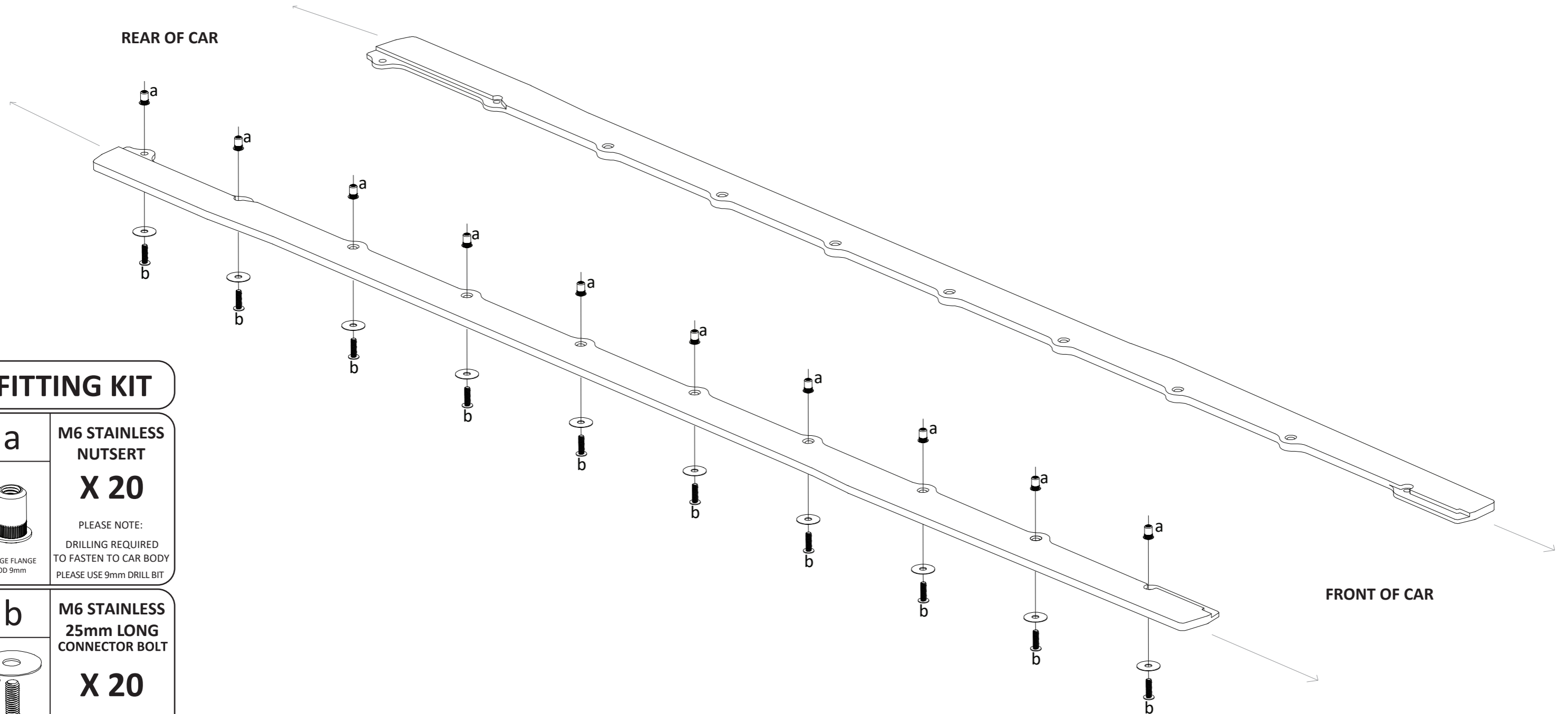

### FITTING KIT

**a**

**M6 STAINLESS NUTSERT**

**X 20**

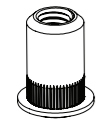

LARGE FLANGE  
OD 9mm

PLEASE NOTE:  
DRILLING REQUIRED  
TO FASTEN TO CAR BODY  
PLEASE USE 9mm DRILL BIT

**b**

**M6 STAINLESS 25mm LONG CONNECTOR BOLT**

**X 20**

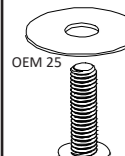

OEM 25  
M6 X 25mm STAINLESS

**BLACK ADHESIVE GLUE**

**X 1**

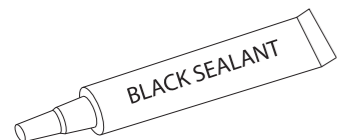

**DRILLING TEMPLATE**

**X 1**

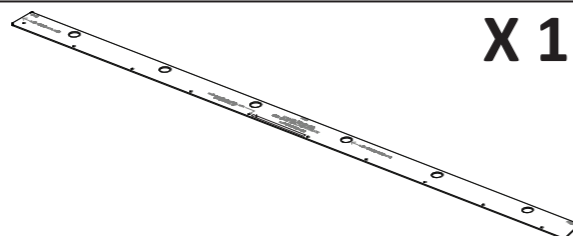

**SPARES**

**X 2**

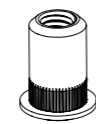

LARGE FLANGE  
OD 9mm



#### TERMS AND CONDITIONS : MISUSE OF GOODS

By taking possession of this Flow Designs Australia product, you (the buyer) agree that you have read, understood and will comply with the following disclaimer:

- This product may not be suitable for road use in your area. We cannot be held liable for any penalties or infringements that may occur as a result of installing any of our products.
- We cannot guarantee that this product will comply with subsequent aftermarket products you have applied to your vehicle.
- It is not legal to fit parts onto a road registered vehicle unless it carries and meets the design rules and public road regulations of your area, region and/or country.
- We do make our best effort to consider safety when designing our products, we want the scene to be a safe place for everyone!

This disclaimer absolves us (Flow Designs Australia) of any and all liability for breaches to any requirement as a result of installation of our products.

[www.flowdesignsaustralia.com](http://www.flowdesignsaustralia.com)