

# FITTING DIAGRAM

HYUNDAI SONATA DN8 N-LINE : SIDE SPLITTER INSTRUCTIONS

## INSTALLATION AND FITTING SERVICES

If you are having any difficulties please seek professional advice from the listed International and Domestic Authorised Dealers on our website.

[www.flowdesignsaustralia.com](http://www.flowdesignsaustralia.com)

**SIDE SKIRT REMOVAL  
NOT REQUIRED**

### HANDY HINTS

Align back edge of side splitter with jacking point cutout in OEM side skirt.

### JACKNUT INSTALLATION GUIDE FITTING KIT - A

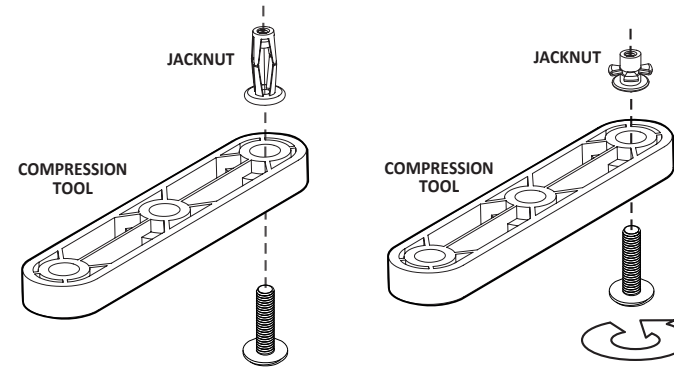

Drill mounting hole with 11mm drill bit for jacknut. Thread jacknut through supplied compression tool and bolt as shown above. Insert jacknut into drilled hole in side skirt before compressing. Ensure jacknut is completely compressed before removing bolt.

### JACKNUT INSTALLATION VIDEO QR CODE

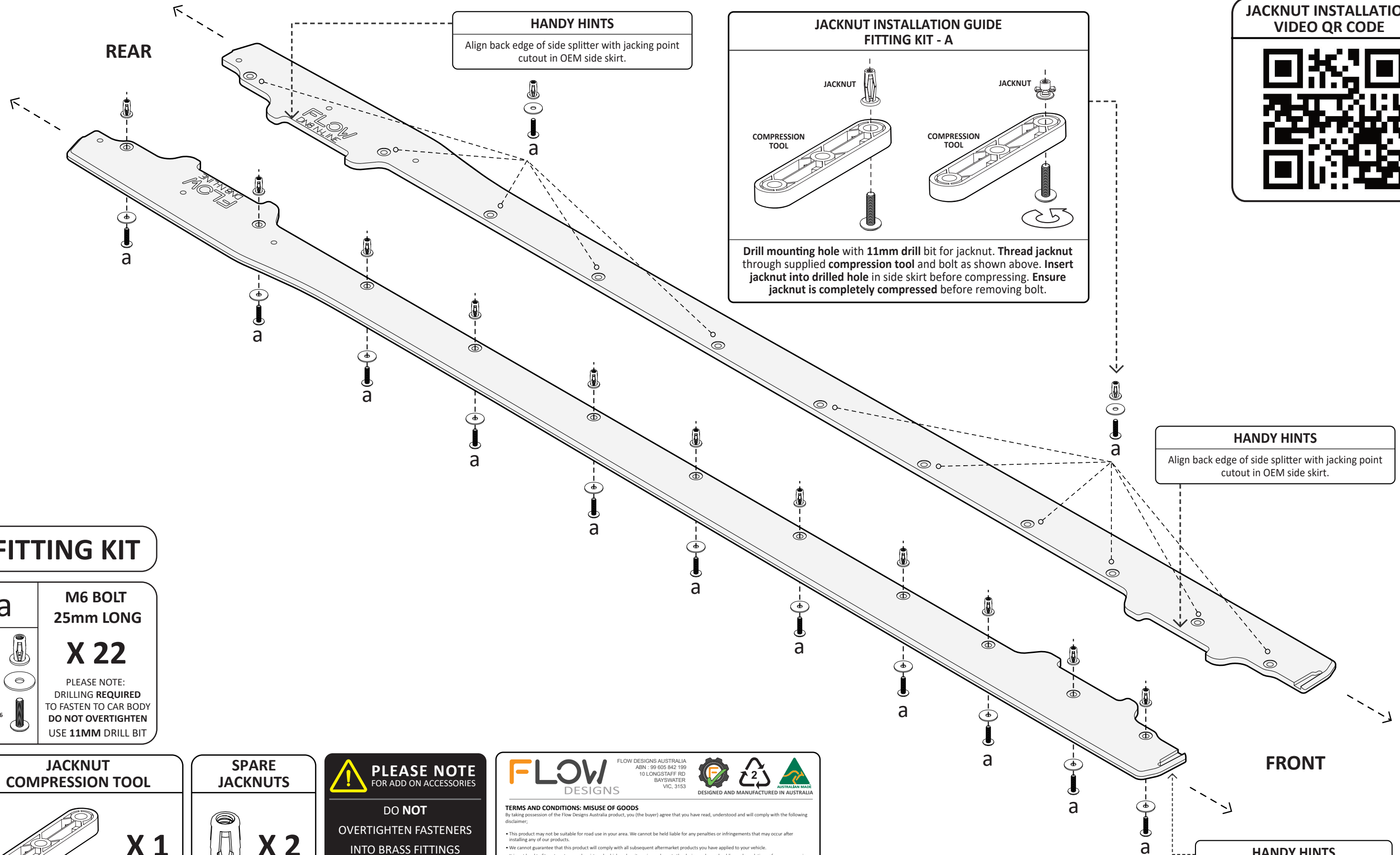

### HANDY HINTS

Align back edge of side splitter with jacking point cutout in OEM side skirt.

## FITTING KIT

**a** M6 BOLT  
25mm LONG

**X 22**

PLEASE NOTE:  
DRILLING REQUIRED  
TO FASTEN TO CAR BODY  
DO NOT OVERTIGHTEN  
USE 11MM DRILL BIT

M6 JACKNUT  
OD 25  
25mm M6



### JACKNUT COMPRESSION TOOL

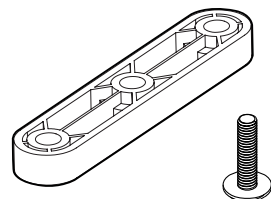

**X 1**

### SPARE JACKNUTS

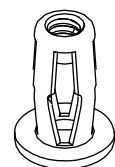

**X 2**



**PLEASE NOTE**  
FOR ADD ON ACCESSORIES

**DO NOT  
OVERTIGHTEN FASTENERS  
INTO BRASS FITTINGS**

HAND TIGHTEN ONLY

**FLOW**  
DESIGNS

**FLOW**  
DESIGNS

FLOW DESIGNS AUSTRALIA  
ABN : 99 605 842 199  
10 LONGSTAFF RD  
BAVSWATER  
VIC, 3153



#### TERMS AND CONDITIONS: MISUSE OF GOODS

By taking possession of the Flow Designs Australia product, you (the buyer) agree that you have read, understood and will comply with the following disclaimer:

- This product may not be suitable for road use in your area. We cannot be held liable for any penalties or infringements that may occur after installing any of our products.
- We cannot guarantee that this product will comply with all subsequent aftermarket products you have applied to your vehicle.
- It is not legal to fit parts onto a road registered vehicle unless it carries and meets the design rules and public road regulations of your area, region and/or country.
- We do our best effort to consider safety when designing our products. We want the scene to be a safe place for everyone!

This disclaimer absolves us (Flow Designs Australia) of any and all liability or breaches to any requirement as a result of installation of our products.

[www.flowdesignsaustralia.com](http://www.flowdesignsaustralia.com)

**FRONT**

### HANDY HINTS

For best fitment, align bevel of side splitter with front and back edge of side skirt.