

# FITTING DIAGRAM

HOLDEN COMMODORE SERIES 1 & SERIES 2 VE SEDAN & VE / VF WAGON  
REAR SPATS

INSTALLATION AND FITTING SERVICES

If you are having any difficulties please seek professional advice from the listed  
International and Domestic Authorised Dealers on our website.

[www.flowdesignsaustralia.com](http://www.flowdesignsaustralia.com)

**BUMPER REMOVAL  
NOT REQUIRED**

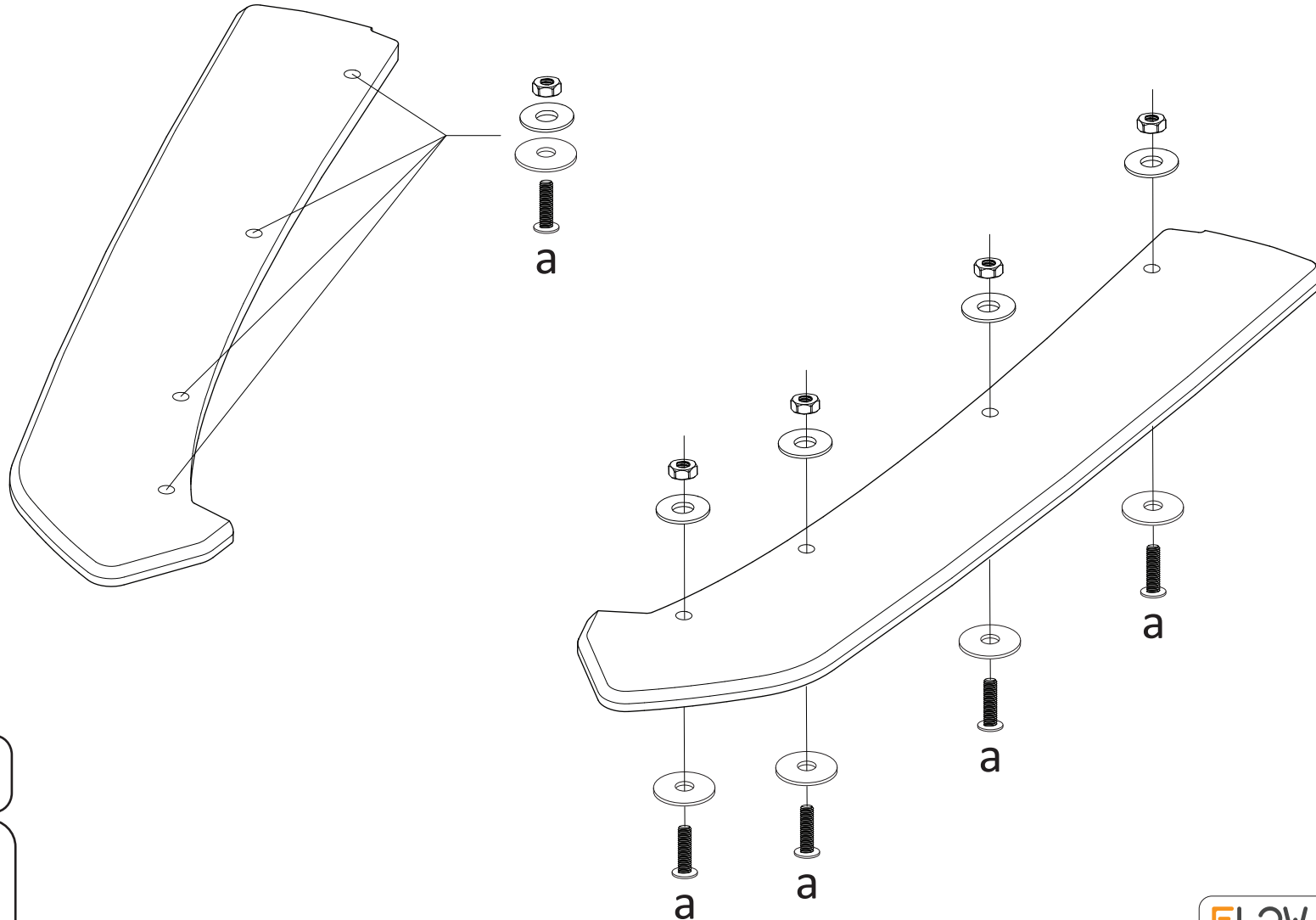

## FITTING KIT

a

M6 BOLT  
30mm LONG

**X 8**

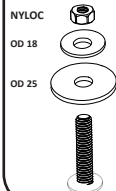

PLEASE NOTE:  
DRILLING REQUIRED  
TO FASTEN TO BUMPER

PLEASE USE 8mm DRILL BIT

**FLOW** DESIGNS

FLOW DESIGNSAUSTRALIA  
ABN 59 60542 150  
15 LONGCREST  
BAYVIEW VIC 3105

DESIGNED AND MANUFACTURED IN AUSTRALIA

**TERMS AND CONDITIONS : MISUSE OF GOODS**

This Product application is not intended for public road registered vehicles within Australia.  
Regulators may vary from Countries outside of Australia.  
Please check your Country's and State's road regulators before installing on a vehicle intended for public road use.

Flow Design Australia PTY LTD will not be liable for any liabilities relation to any use of the goods other than in strict accordance with the Company's instructions and for the purpose and application for which the goods were supplied by the Company.

The Client undertakes with the Company:

- That it will acquaint itself with the requirements of all relevant government or statutory and/or other authorities, bodies or corporations relating to the goods and/or services and to the applications to which the goods and/or services are to be put;
- That at all times, while the goods are in its possession under the contract it will comply with such requirements;
- That it will procure that any purchaser of goods from it will also acquaint itself with, and will comply with, such requirements;
- That it will indemnify the Company against any liability resulting from breach of any such requirements.

[www.flowdesignsaustralia.com](http://www.flowdesignsaustralia.com)