

# OPERATION MANUAL

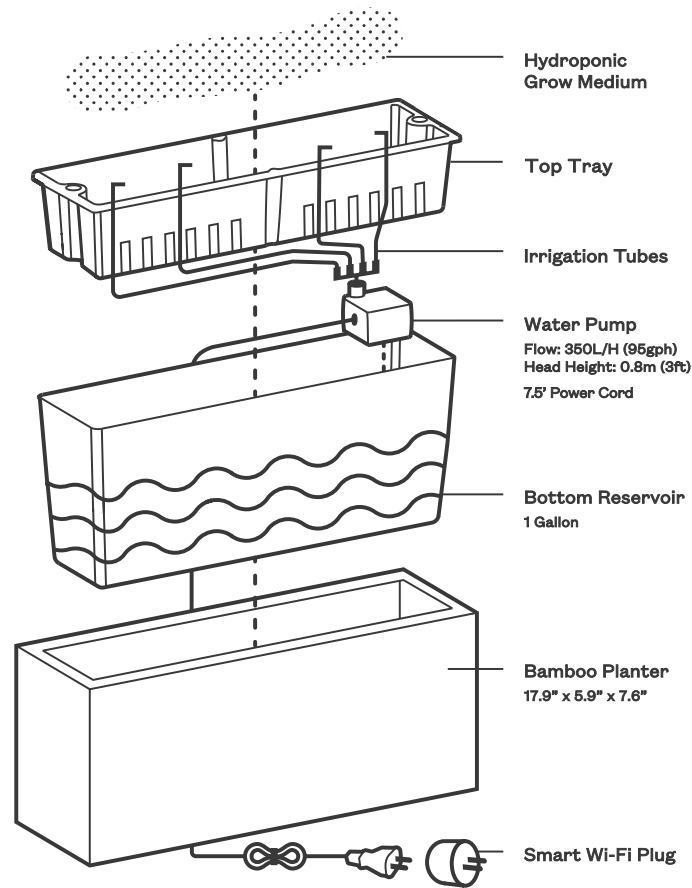

## INCLUDES

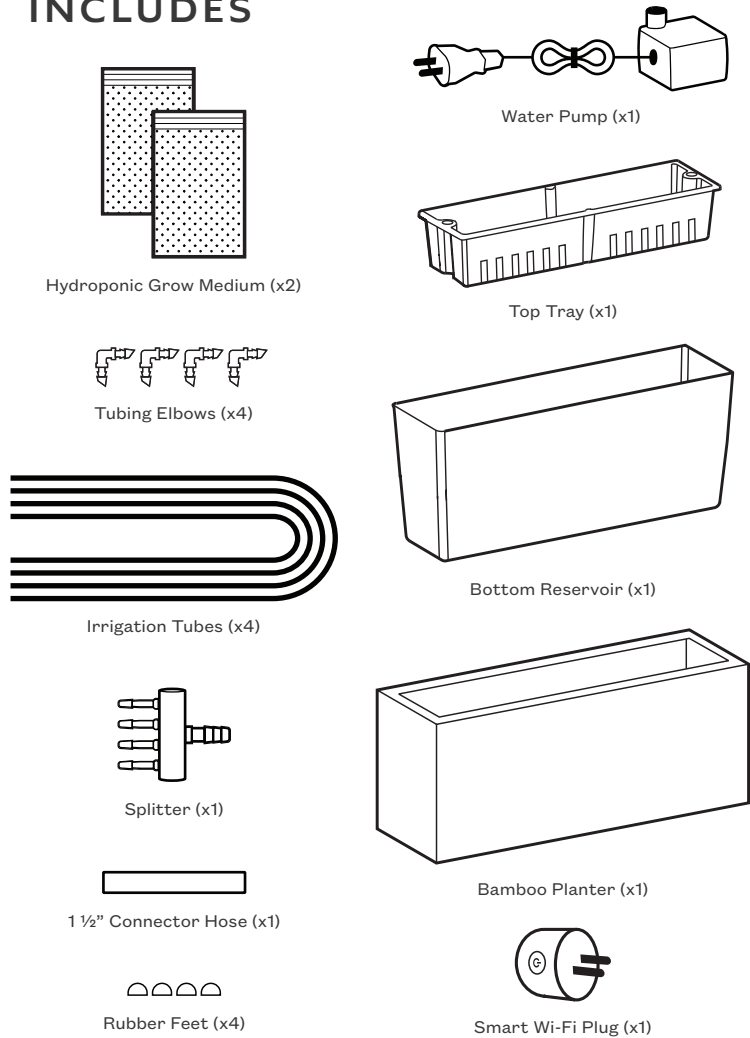

## 1. APP SETUP

This Hydroplanter is app-enabled, so you will need a smart phone and a 2.4 GHz Wi-Fi network to operate it.

### 1.1

Ensure that your smart phone is connected to your Wi-Fi network. Then, download the Modern Sprout App. Set up your account using an email and password. Follow the on-screen steps to complete login.



### 1.2

Plug the Smart Wi-Fi Plug into an outlet. Press and hold the power button on the Smart Wi-Fi Plug for 10 seconds until it starts to blink. When the light begins to rapidly blink, the plug is now in pairing mode and capable of syncing to the Wi-Fi.

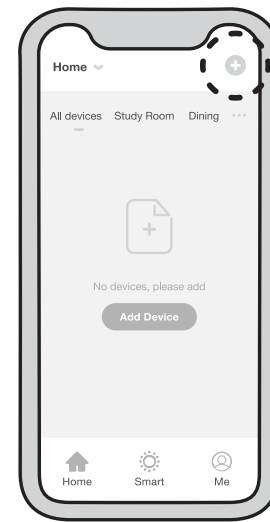
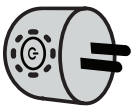

### 1.3

It's time to pair the Smart Wi-Fi Plug to the Modern Sprout App. While the Smart Wi-Fi Plug light is blinking, tap the plus symbol in the top right corner of the App to take you to the Add Device page.

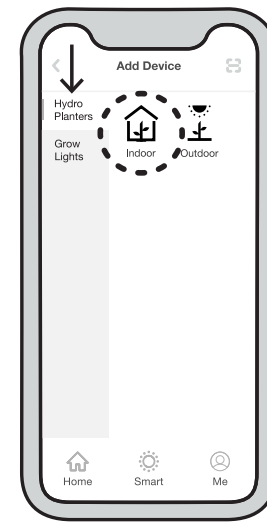

### 1.4

Select the "Hydroplanters" tab on the left-hand side. Now tap the Indoor icon.

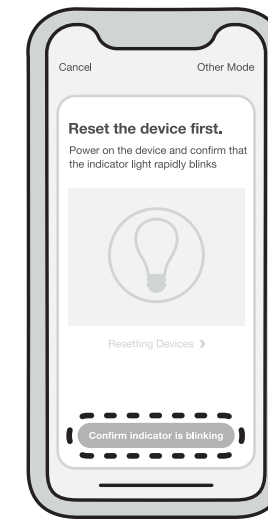

### 1.5

Tap the "Confirm indicator is blinking" button.



### 1.6

Enter your Wi-Fi name and password (both are case sensitive). Tap "Confirm" and wait for the progress indicator to complete the device connection.

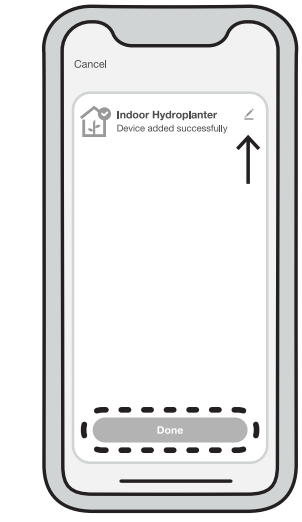
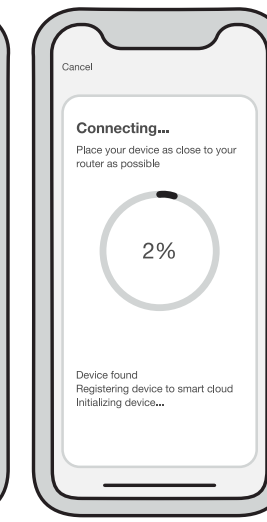

### 1.7

Once you have successfully paired your Smart Wi-Fi Plug, tap the pencil icon to rename it (not required) and tap "Done". You are now ready to set up your Hydroplanter.

## RESETTING DEVICE

- If the Smart Wi-Fi Plug does not connect, unplug for 1 minute and then plug it back in.
- Once the light is on, hold the power button on the Smart Wi-Fi Plug for 10 seconds to put it into pairing mode.
- Once the light is rapidly flashing, connect the App using steps 1.3-1.7.
- Need help? Check out Me > FAQ + Feedback in the Modern Sprout App for troubleshooting steps or to report an issue.

## 2. PLANTER SETUP

After pairing your Smart Wi-Fi Plug to the Modern Sprout App, it's time to assemble your Hydroplanter and prepare it for planting. You can also watch our setup video at: [modsprout.com/setup-videos](https://modsprout.com/setup-videos)

### 2.1 GETTING STARTED

Remove the Bamboo Planter from the box. Remove the Top Tray and all components from inside the Bottom Reservoir. After removing packaging, leave the Bottom Reservoir in place.

### 2.2 INSTALL PLANTER FEET

Firmly press the clear Rubber Feet to the bottom four corners of the Bamboo Planter. This will protect surfaces from getting scratched.

### 2.3 ASSEMBLE PUMP & IRRIGATION TUBES

Attach the four Irrigation Tubes to the four small nipples of the Splitter. Now attach the 1 1/2" Connector Hose to the large nipple of the Splitter. Attach the opposite end of the Connector Hose to the nozzle on the Pump.

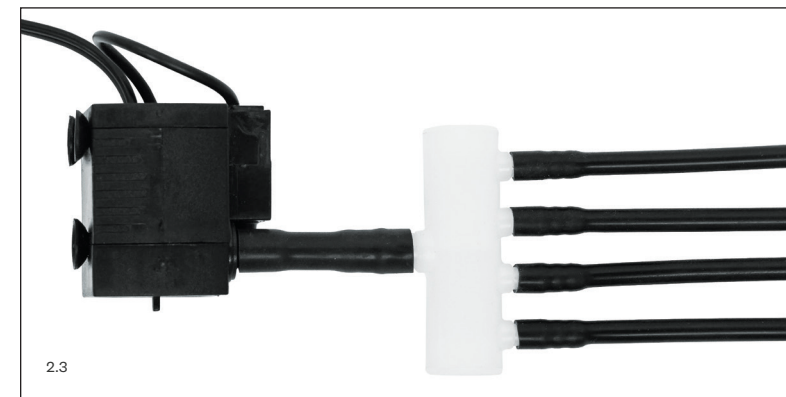

2.3

### 2.4 INSTALL PUMP ASSEMBLY INTO RESERVOIR

First, make sure the slider on the Pump's intake screen is set to the plus sign. This opens the Pump for optimal water flow (2.4.1).

Wipe off any dust on the interior of the Reservoir. Orient the Pump assembly at the bottom of the Reservoir so the suction feet are facing the short wall of the Reservoir and the intake screen is facing either side wall. Then, using the suction feet, press the Pump firmly against the side of the short wall, with the base of the Pump resting on the floor of the Reservoir (2.4.2). If the rubber feet are not sticking to the side of the Reservoir, add some moisture to the suction feet and try again by pressing firmly against the side wall.



2.4.1

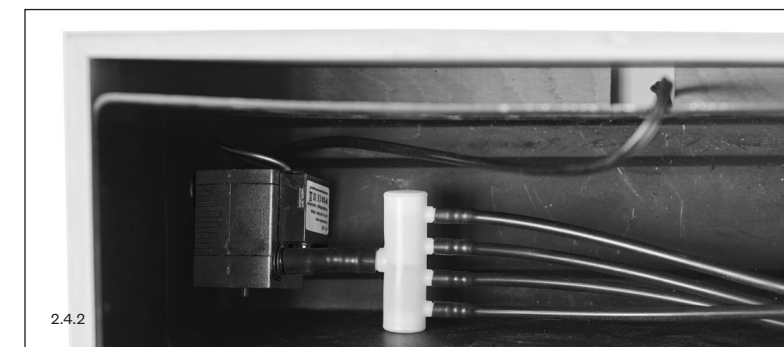

2.4.2

### 2.5 POWER CORD SETUP

Thread the power cord of the Pump through the slot in the bottom of the Bamboo Planter (2.5.1). Now, place the Reservoir inside the Bamboo Planter. Be sure to thread the power cord from the Pump through the notch on the top edge of the Reservoir (2.5.2).

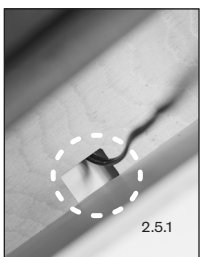

2.5.1

### 2.6 IRRIGATION TUBES SETUP

Insert the Irrigation Tubes into the Top Tray through the holes in the bottom of the Tray. Position the Tubes in a zigzag pattern across the length of the Tray to ensure balanced irrigation. Pull the Tubes up 1" below the top of the Tray (Tubes can be readjusted later). Once in place, insert a 90° Elbow into each of the Irrigation Tubes and point towards the center of the Tray (away from the walls).

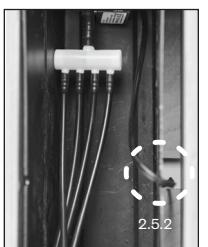

2.5.2

### 2.7 INSTALL TOP TRAY

Place the Top Tray on the Reservoir so that the top of Tray is flush with the top of the Planter. Make sure the power cord is still in the Reservoir slot.

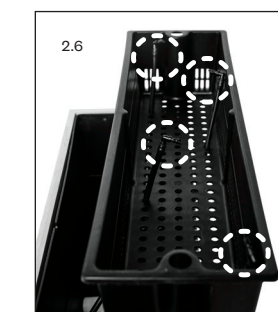

2.6

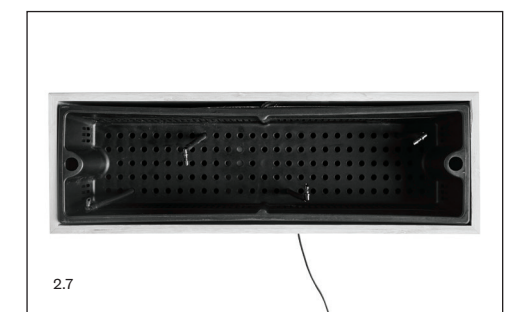

2.7

### 3. PLANTING

Pair the Hydroplanter with either transplants, clippings or seed starter cubes. Seed starter cubes are featured in this manual, but all three options follow the same guidelines. For transplants, carefully remove the excess dirt from the roots prior to planting by shaking or gently rinsing them (try to avoid damaging the roots).

You can also watch our setup video at: [modsprout.com/setup-videos](https://modsprout.com/setup-videos)

**3.1** Poke a few holes in the bottom of the Hydroponic Grow Medium bags and rinse to remove dust. Evenly distribute a shallow layer (half of one bag) of the Grow Medium into the Top Tray.

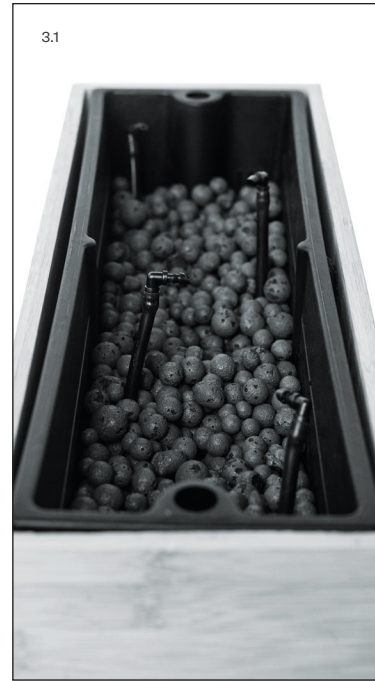

**3.2** Stage transplants, cuttings or seed starter cubes across length of the Top Tray (3.2.1). Then carefully add the remaining Grow Medium from the first bag into the Tray, around plants or seed starters. Readjust the Irrigation Tubes so that they are just below the surface of the Grow Medium (3.2.2).

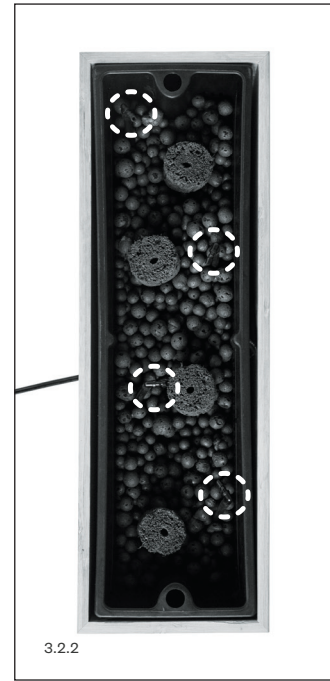
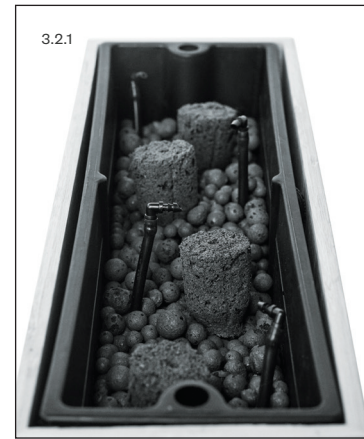

**3.3** Add the second bag of the rinsed Grow Medium around the transplants, clippings or seed starter cubes, so that the Grow Medium is level with the base of your plants or starter cubes (~1/2" below top of the Tray).

Note on transplants: Transplants may take a couple of days to acclimate, but rest assured that they will thrive with the hydroponic setup.



**3.4** Place the Planter in the desired location. If relying on natural sunlight, consider a south or west-facing window. If the location doesn't have direct sunlight, consider using a grow light.

**3.5** Add 1 gal of water into the Reservoir. Fill by pouring straight through the Top Tray or through the Reservoir's filling holes on either side of the Top Tray to avoid disturbing seeds (3.5).

**3.6** Connect the Pump's power cord to the Smart Wi-Fi Plug (3.6). Plug into an outlet.

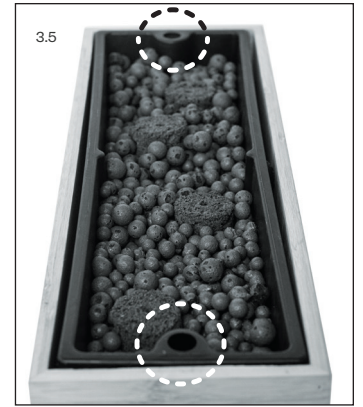

### 4. SET IRRIGATION SCHEDULE

There are three ways you can set up your irrigation schedule: MANUAL ON/OFF; PRESET SETTINGS; CUSTOM SETTINGS

#### 4.1

##### MANUAL ON/OFF

When you tap the on/off button on the Smart Wi-Fi Plug or App, irrigation will automatically turn on or off. (Note this action temporarily overrides any other presets).

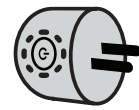

SMART WI-FI PLUG

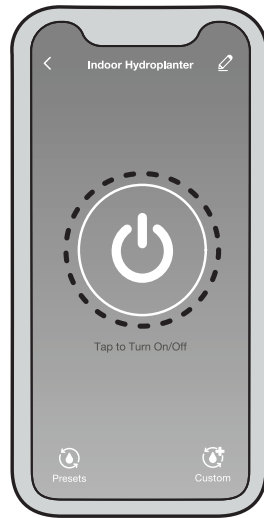

APP

#### 4.2

##### PRESET SETTINGS

Preset timer settings based on different plant types.

Tap "Presets" in the lower left corner. Now tap to select a setting. Only one setting can be selected at a time.

Preset settings schedule details are listed in the table displayed on the right.

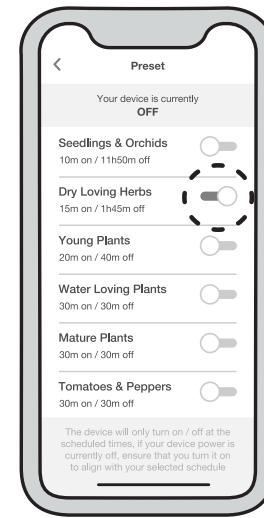
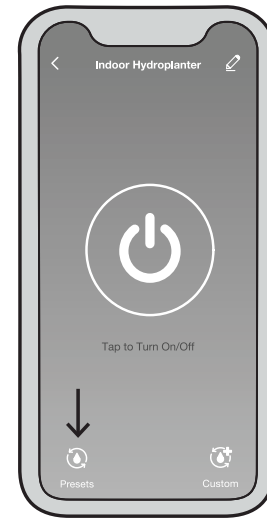

#### 4.3

##### CUSTOM SETTINGS

A fully configurable daily irrigation schedule.

- Tap "Custom" in the lower right corner.
- Tap "Add Schedule".
- Select a "Start Time".
- Select an "End Time".
- Schedule your "ON Duration". This indicates the duration the Pump will cycle water through the planter between each irrigation cycle.
- Schedule your "OFF Duration". This indicates the duration the Pump will pause between each irrigation cycle.
- \*The Pump will turn on/off for the scheduled durations until the daily end time is reached.
- Select the days you want the irrigation schedule to run. (7 days / week is recommended).
- Tap "Save" in the upper right corner. Name your setting and tap "Save" again.

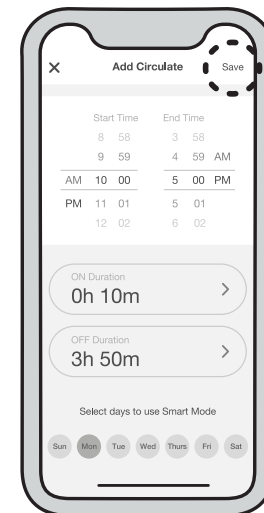
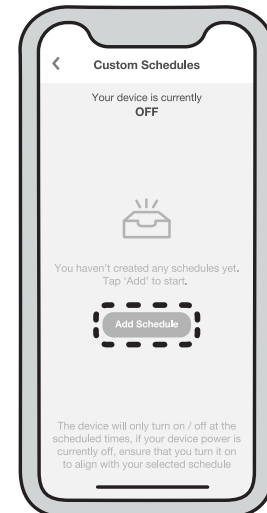
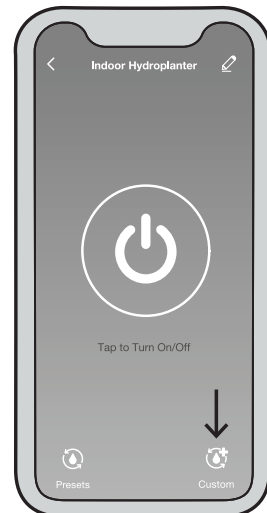

### PRESET SETTINGS

<b>SEEDLINGS &amp; ORCHIDS</b> Also good for succulents, cacti	On	Off	On	Off	On													
	8:00 AM	8:10 AM	8:00 PM	8:10 PM	8:00 AM													
<b>DRY LOVING HERBS</b> Woody stemmed herbs like rosemary, oregano, thyme	On	Off	On	Off	On	Off	On	Off										
	8:00 AM	8:15 AM	10:00 AM	10:15 AM	12:00 PM	12:15 PM	2:00 PM	2:15 PM										
<b>YOUNG PLANTS</b> Small vegetative plants, houseplants	On	Off	On	Off	On	Off	On	Off	On	...Off								
	8:00 AM	8:20 AM	9:00 AM	9:20 AM	10:00 AM	10:20 AM	11:00 AM	11:20 AM	12:00 PM	3:20 PM								
<b>WATER LOVING HERBS</b> Non-woody stemmed herbs like basil, cilantro, parsley plus lettuces	On	Off	On	Off	On	Off	On	Off	On	Off	...Off							
	8:00 AM	8:30 AM	9:00 AM	9:30 AM	10:00 AM	10:30 AM	11:00 AM	11:30 AM	12:00 PM	12:30 PM	5:30 PM							
<b>MATURE PLANTS</b> Larger houseplants, vegetative pre-fruit plants	On	Off	On	Off	On	Off	On	Off	On	Off	On	Off	...Off					
	8:00 AM	8:30 AM	9:00 AM	9:30 AM	10:00 AM	10:30 AM	11:00 AM	11:30 AM	12:00 PM	12:30 PM	1:00 PM	9:30 PM						
<b>TOMATOES &amp; PEPPERS</b> Veggies, flowering and fruiting plants	On	Off	On	Off	On	Off	On	Off	On	Off	On	Off	...Off					
	8:00 AM	8:30 AM	9:00 AM	9:30 AM	10:00 AM	10:30 AM	11:00 AM	11:30 AM	12:00 PM	12:30 PM	1:00 PM	1:30 PM	11:30 PM					

### SETUP VIDEO

[MODSPROUT.COM/SETUP-VIDEOS](https://modsprout.com/setup-videos)

modern sprout.

Many questions may be answered by visiting FAQ + Feedback in the Modern Sprout App or by visiting [modsprout.com](https://modsprout.com)  
Customer Service: [service@modsprout.com](mailto:service@modsprout.com)

GROW & TELL:   
[@modsprout](https://modsprout.com) | [#modsprout](https://modsprout.com)

modsprout.com | © Modern Sprout LLC 2020  
2010 W. Fulton St. F-304, Chicago, IL 60612