

NAT HD-9US Under Sink Standard Installation

Wood (Screw) and Drywall (Toggle) Installation Procedures

NOTE: TURN OFF WATER SUPPLY

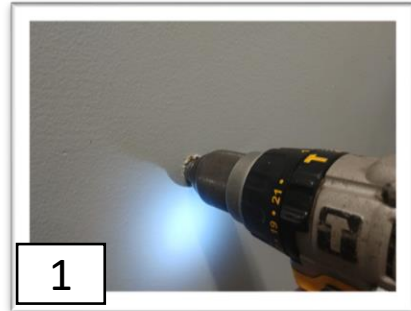

Drill an 1/8" Pilot Hole for Wood Installation.
Drill 7/8" Hole for Drywall Installation.

TOOLS REQUIRED

- Power Drill
- 1/8" Drill Bit
- 7/8" Drill Bit or 7/8" Step Drill
- Phillips Screwdriver



UNBOX HD-9US KIT

- HD-9 UNIT
- 1/2" Faucet Line
- Wall Anchor
- 1/4" Wood Screw



Press HD-9 Unit into Mounting Clamp until it latches in place.

TURN ON WATER SUPPLY AND CHECK FOR LEAKS



Insert Wood Screw through Clamp and Tighten. *Insert Toggle into Hole for Drywall Installation.*

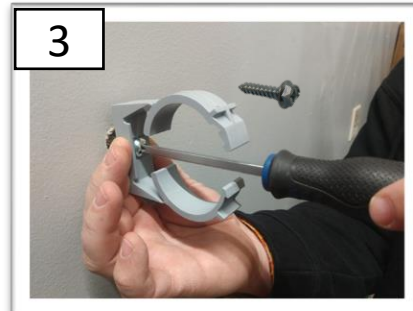

Use 1/4" Wood Screw for Wood Installation.
Pull on Toggle and Tighten Fastener until tight against the Drywall.



Cut Side of Cap and Remove Thread Protector.



Route Cold Water Supply Line to Bottom of Unit and secure with Wrench.

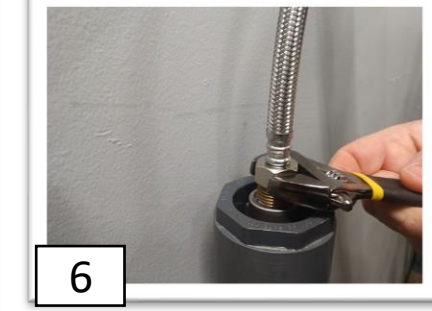

Attach provided 1/2" Supply Line from Unit to Faucet and SECURE with Wrench.