

INSTRUCTIONS

TILT LED DESK LAMP

8622.30 8622.31

Please read the instructions before commencing use and retain for future reference.

SPECIFICATIONS:

- **Fitting:** Body made in aluminium with metal base?? and polycarbonate diffuser.
pc&aluminum&iron. (Sophia we need to define which part of the fitting these materials relate too)
- **Lamp types:**
SMD 4W/100-240V/50HZ 5.5W / 230V / LED 3000-6500K (as per spec sheet you sent me)
- **Protection against electric shock:** CLASS III.
- **Ingress Protection:** IP20. Protection against the entry of solid bodies with dimensions more than 12mm.
- **Ballast:** not required.
- **Quality/Corrosive rating:** Suitable for domestic and commercial indoor use only except in corrosive environments.
- **Ambient temperature range:** -20°C to +50°C.

WARNING:

- Ensure all items and screws are secure and fitted correctly.

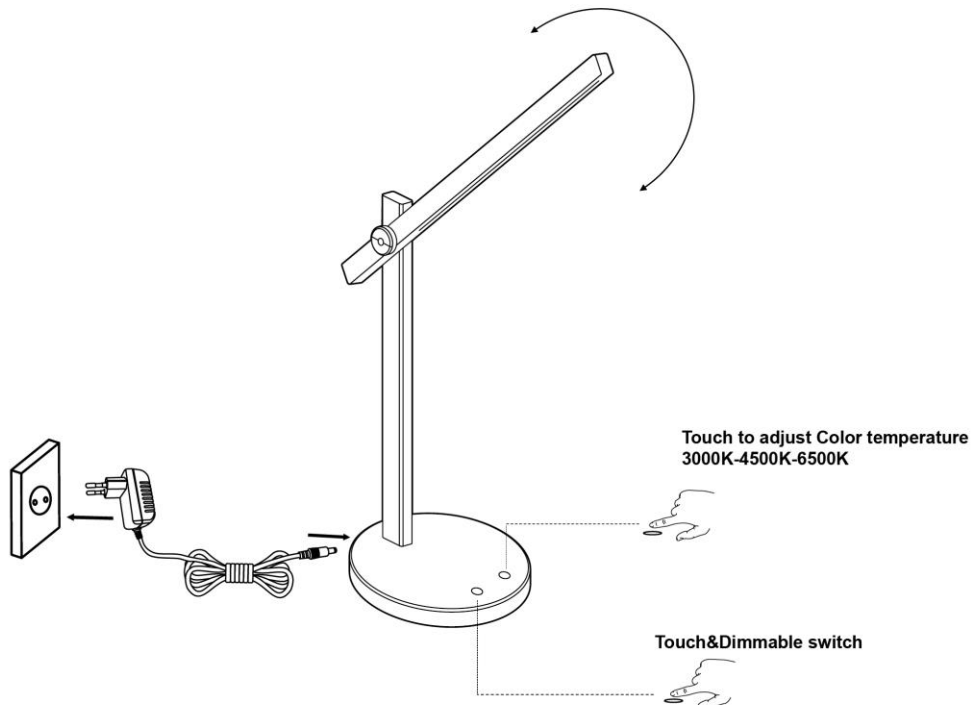

Spazio Lighting (Pty) LTD

JOHANNESBURG OFFICE: 52 Andries Street North | Wynberg/Sandton | Tel: +27 11 555 5555 | Fax: +27 11 555 5544

CAPETOWN OFFICE: 36 Milner Street | Paarden Eiland | 8001 | Tel: +27 21 461 0061 | Fax: +27 21 461 0063

info@spazio.co.za

