

INSTRUCTIONS

HUGO PENDANT

Ø310: 8535.30.20 8535.30.30 8535.30.31
Ø470: 8535.40.20 8535.40.30 8535.40.31

Please read the instructions before commencing installation and retain for future reference.

SPECIFICATIONS:

- **Fitting:** Aluminum shade and metal base
- **Lamp types:** max. 60W / E27
- **Protection against electric shock:** CLASS I. Requires earth connection.
- **Ingress Protection:** IP20. Protection against the entry of solid bodies with dimensions > 12mm
- **Quality/Corrosive rating:** Suitable for indoor commercial and residential applications

INSTALLATION INSTRUCTIONS:

⚠ Electrical products can cause death, injury or damage to property. Installation of this product must be carried out by a qualified electrician, in accordance with SANS 10142. On completion of installation, ensure that the Certificate of Compliance is updated.



CAUTION: Risk of electric shock.

Ensure main supply is switched off.

- Mount the two expansion anchors (supplied) into the ceiling. (Fig. 1.1)
- Mount the ceiling bracket to the anchors with the screws provided. (Fig. 1.2)
- Connect the fitting to its electrical source using the terminal block provided. (Fig. 1.3)
Brown (Live) - to Brown or Red
Blue (Neutral) - to Blue or Black
Green/Yellow (Earth) - to Green/Yellow or Copper.
- Fix the fitting base to the ceiling bracket. (Fig. 1.4)
- Adjust the length of cables as needed. (Fig. 1.5)
- Fix the base and screw tube by lock nut (Fig. 2.1)
- Join the 2 shade parts together (Fig. 2.2)
- Lock the 2 shade parts by with the retaining circle (Fig. 2.3)

Switch main supply back on

WARNING:

- Ensure all items and screws are secure and fitted correctly.

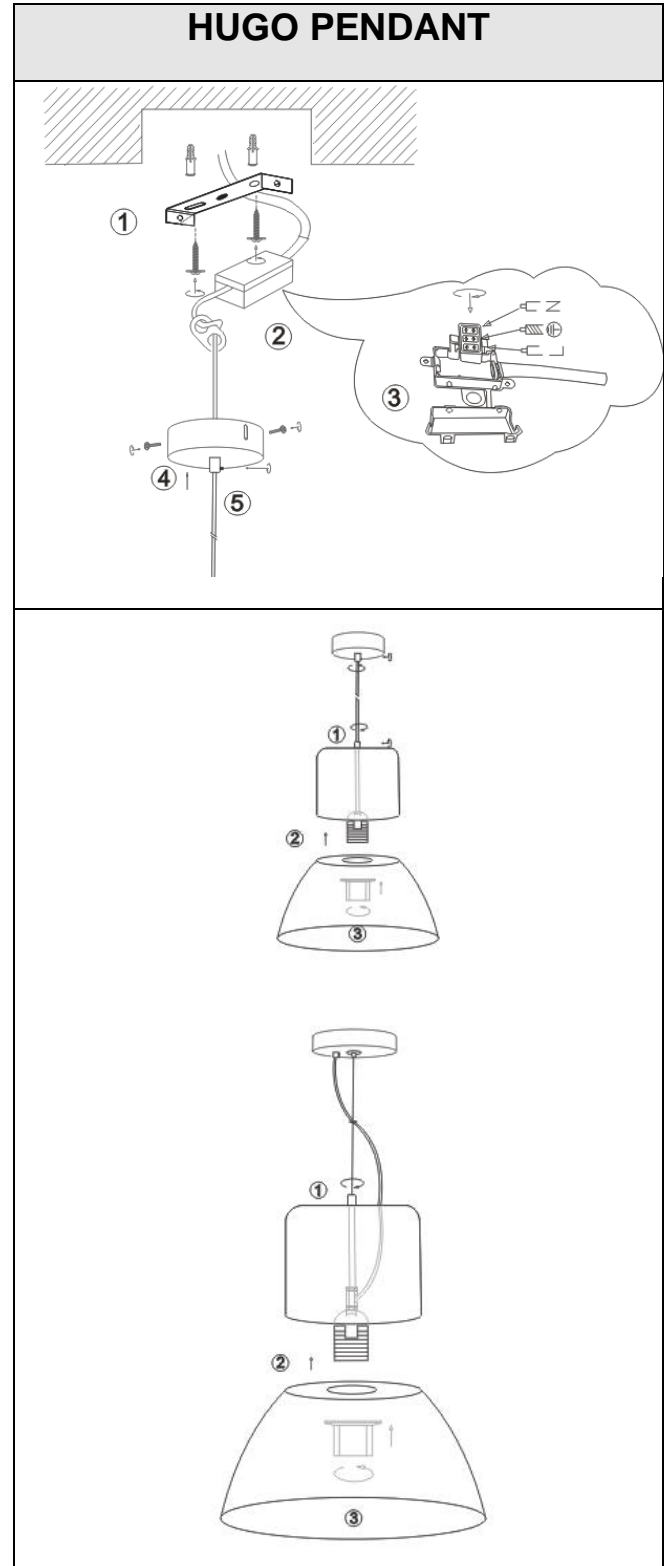

Spazio Lighting (Pty) LTD.

JOHANNESBURG OFFICE: 52 Andries Street | Wynberg/Sandton

CAPE TOWN OFFICE: 36 Milner Street | Paarden Eiland

DURBAN OFFICE: 31 Solstice Road | Umhlanga Ridge

011 555 5555 (Central Switchboard) | info@spazio.co.za