

INSTRUCTIONS



FOCAL Bollard Light

4667.3030 4667.4030

Please read the instructions before commencing installation and retain for future reference.

SPECIFICATIONS

- **Fitting:** Body made in Polycarbonate & ABS with Polycarbonate diffuser.
- **Lamp types:**
4667.3030: 6W / 230V / LED 3000K
4667.4030: 6W / 230V / LED 4000K
- **Protection against electric shock:** CLASS II.
- **Ingress Protection:** IP54. Complete protection against dust and against the effects of water jets.
- **Quality/Corrosive rating:** Suitable for outdoor applications
- **Ambient temperature range:** -20°C to +50°C.

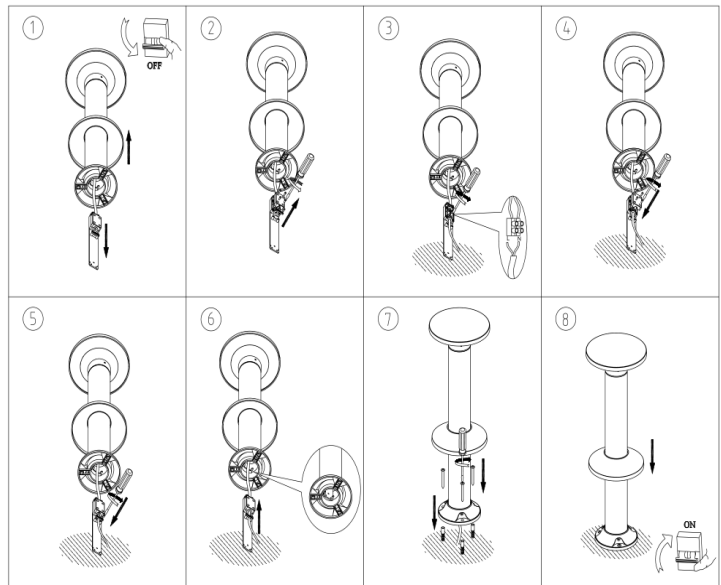

INSTALLATION INSTRUCTIONS:

⚠ Electrical products can cause death, injury, damage to property. Installation of this product must be carried out by a qualified electrician, in accordance with SANS 10142. On completion of installation, ensure that the Certificate of Compliance is updated.



CAUTION: Risk of electric shock

PLEASE NOTE: The light source contained on this luminaire shall only be replaced by the manufacturer or the service agent or a similar qualified person.

Ensure main supply is switched off.

- Remove the connection box from the lamp pole. (Fig.1)
- Unscrew the cover of the connection box. (Fig.2)
- Connect the main cable to the terminal block and ensure correct connection as marked. (Fig.3):
Brown(Live) - to Brown or Red
Blue(Neutral) – to Blue or Black
- Screw the connection box cover tightly. (Fig.4)
- Tighten the cable clip of main cable. (Fig.5)
- Put the connection box back into the pole and fix it to the buckle. (Fig.6)
- Attach the lamp base to the ground ensuring it is screwed down tightly. (Fig.7)
- Slide down the decorative cover. (Fig.8)

Turn on mains supply

WARNING: Ensure all items and screws are secure and fitted correctly.

Spazio Lighting (Pty) LTD.

JOHANNESBURG OFFICE: 52 Andries Street | Wynberg/Sandton

CAPE TOWN OFFICE: 36 Milner Street | Paarden Eiland

DURBAN OFFICE: 31 Solstice Road | Umhlanga Ridge

011 555 5555 (Central Switchboard) | info@spazio.co.za