

INSTRUCTIONS



EMERGENCY EXIT SIGN SURFACE + RECESSED MOUNTING KIT

4653 4653.RMK

Please read the instructions before commencing installation and retain for future reference.

SPECIFICATIONS:

- **Fitting:** ABS Housing + PMMA Light Guide Panel
- **Lamp types:** 3W / 230V / LED 5000K
- **Protection against electric shock:** CLASS II. Does not require earth connection.
- **Ingress Protection:** IP20. Protection against the entry of solid bodies with dimensions more than 12mm.
- **Quality/ Corrosive rating:** Suitable for interior commercial use and residential use.
- **Ambient temperature range:** 0°C to 45°C.
- **Charge time:** 24 hours
- **Test mode:** Auto test
- **Battery type:** Lithium 6.4V 600mA rechargeable
- **Emergency duration:** 3 hours

SPECIFICATIONS:



Electrical products can cause death, injury, damage to property. Installation of this product must be carried out by a qualified electrician, in accordance with SANS 10142. On completion of installation, ensure that the Certificate of Compliance is updated.



CAUTION: Risk of electric shock
PLEASE NOTE: The light source contained on this luminaire shall only be replaced by the manufacturer or the service agent or a similar qualified person.

Turn off mains supply

- Remove the mounting base from the fitting and fix it to the ceiling or wall. (Fig.1).
- Feed the electrical cable through the mounting base hole and connect the fitting to the main supply using the terminal block supplied. (Fig.2).
- Change pictogram(optional). (Fig. 3).
 Brown (Live) - to Brown or Red
 Blue (Neutral) - to Blue or Black
- Connect the AC and battery connector. (Fig. 4)
- Re-attach the housing to the mounting base. (Fig. 5)
- Side mounting (optional). (Fig.6)
- Back of the fitting to be placed 50mm from any building element above fitting (Fig 7. A), 30mm from the side of the building structure membrane (Fig 7. B) and 30mm from the side of the thermal insulation. (Fig 7. C).
- Make the recommended cut out in the ceiling. (Fig. 8)

EMERGENCY EXIT SIGN SURFACE + RECESSED MOUNTING KIT

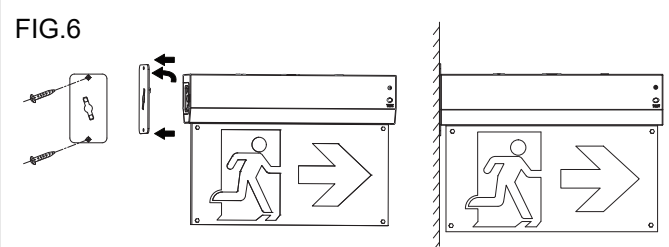
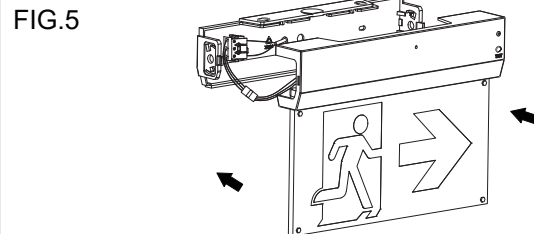
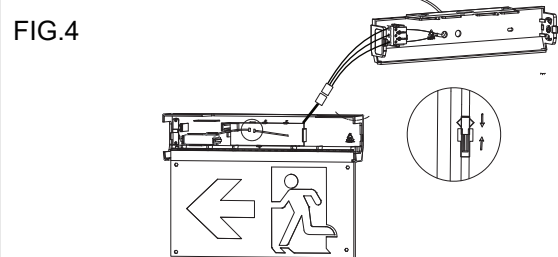
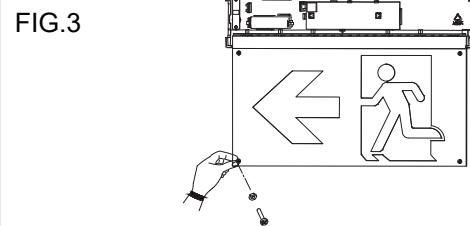
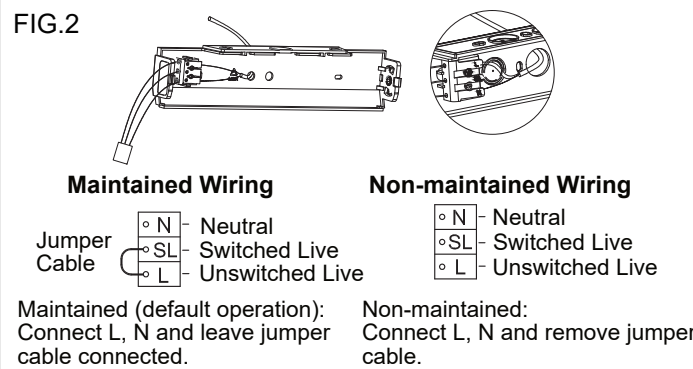
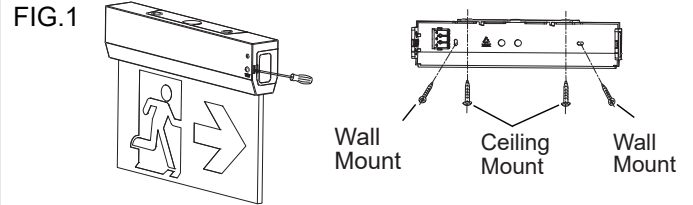

- Remove the hole plug at the test switch side and connect the test switch wire to the test switch PCB inside the fitting through the hole at the side. (Fig.9).
- Install the fitting to the recessed mounting kit, pay attention to the direction of the fitting and connect the test switch wire to the test switch PCB on the recessed kit.(Fig.10).
- Lift the spring clips and install in the ceiling. (Fig.11).

Turns on main s supply

WARNING:

- Ensure all items and screws are tight.
- Refer to product labels to confirm the input voltage.
- Confirm the fitting is installed correctly before operation.
- Check whether the fitting is clean and dry before installation.
- Do not make any modifications to the fitting at random.
- Scheduled maintenance must be performed at monthly and annual intervals. If either 90 second or 90 minute emergency readiness tests prove unsatisfactory (i.e. If the lamps don't light up) replace the emergency battery.
- Only use the specified battery.
- Battery replacement should be replaced by a suitably qualified person or service agent.

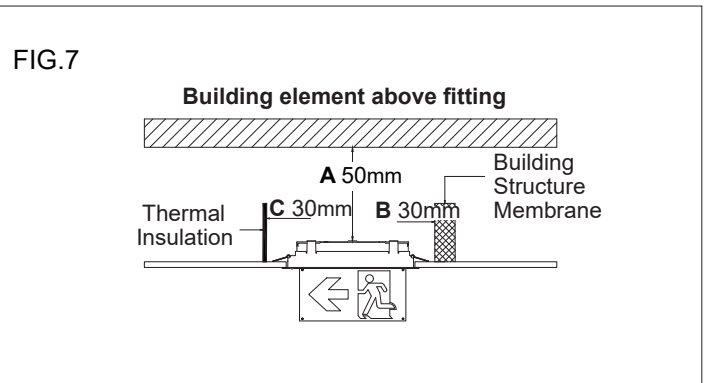

FIG.8

Emergency Exit Sign Dimension (mm)	386 x 80
Ceiling Cutout (mm)	365 x 60

