



BONNY BUNNIES- FORWARD FACING INSTRUCTIONS



1- I used the XL template but this technique works with any of the sizes. Fill the template with your base layer, this took 3.6g of Mouse wool. Stab until firm, paying attention to the points of the ears and the general outline. Keep lifting off the mat to prevent it sticking but only stab on the one side. I use a 40 spiral needle unless otherwise mentioned.

2- remove from the template and check you have no thin areas and that it is holding shape nicely. It shouldn't be rock hard as you are going to add more fluff, but it also shouldn't be loose. Put it back in the template. We now start to work on the side that has been facing the mat as it has a nicer finish.

3- using 2 spare needles, lay them on the template as shown in the diagram. This gives you a guide as to where the nose will sit.

4- take 0.5g of Mouse and stack so the fibres are all facing the same way. Fold in half-lengthways, then fold into half again widthways. This gives you a nice triangle shape which will be your nose.



5- loosely tack the triangle in around the edges. Check you're happy with the position.

6 & 7- start to felt the nose fluff in around the edges to secure. Then start to angle your needle down and inwards, so felting the wool into the centre and tip of the nose. This gives you a nicely graduating slope. The feature should blend in to the top of the head and then deepen to give the cute bunny nose shape.

8- check everything is symmetrical.

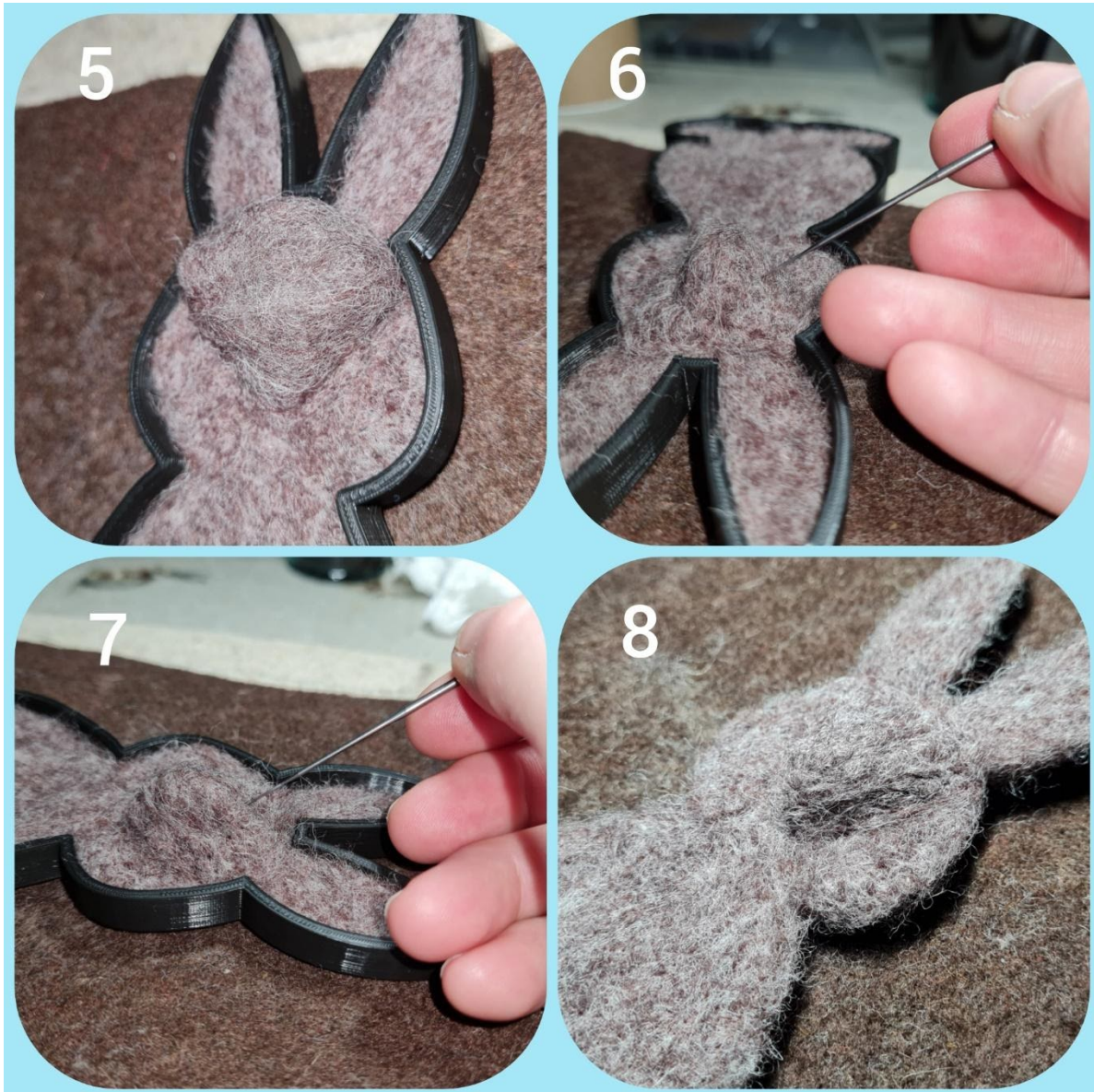

9- take 1g Mouse wool and split into two equal halves. These will be cheeks.

10- felt into two balls, approximately 15mm in diameter. These should be firm enough to hold their shape but still have some squidge.

11- place one either side of the nose and check they don't overlap the edges of the face.

12- loosely tack the cheek balls in place. They should meet under the nose when squished. Once you're happy with the position then firmly felt in place using a stronger needle, a 38 spiral was my choice. Make sure both the nose and cheeks are firmly felted so we don't distort them later.



13- now for his tummy. Take 1g Mouse wool and shape in your hands to a pear shape. Place on his tummy and give it a few stabs with your 40 spiral to get the pear shape. It should sit 5mm in from the outer edge.

14- tack the tummy to your base layer around the edges, leaving that 5mm gap between it and the edge of your work. As the tummy wool is fluffy when it is placed on to the base layer it should blend in with your base as you felt.

15 & 16- using your needle angle, felt the tummy in place to push the wool toward the centre and base of the tummy as you work, giving it a lovely, rounded shape.

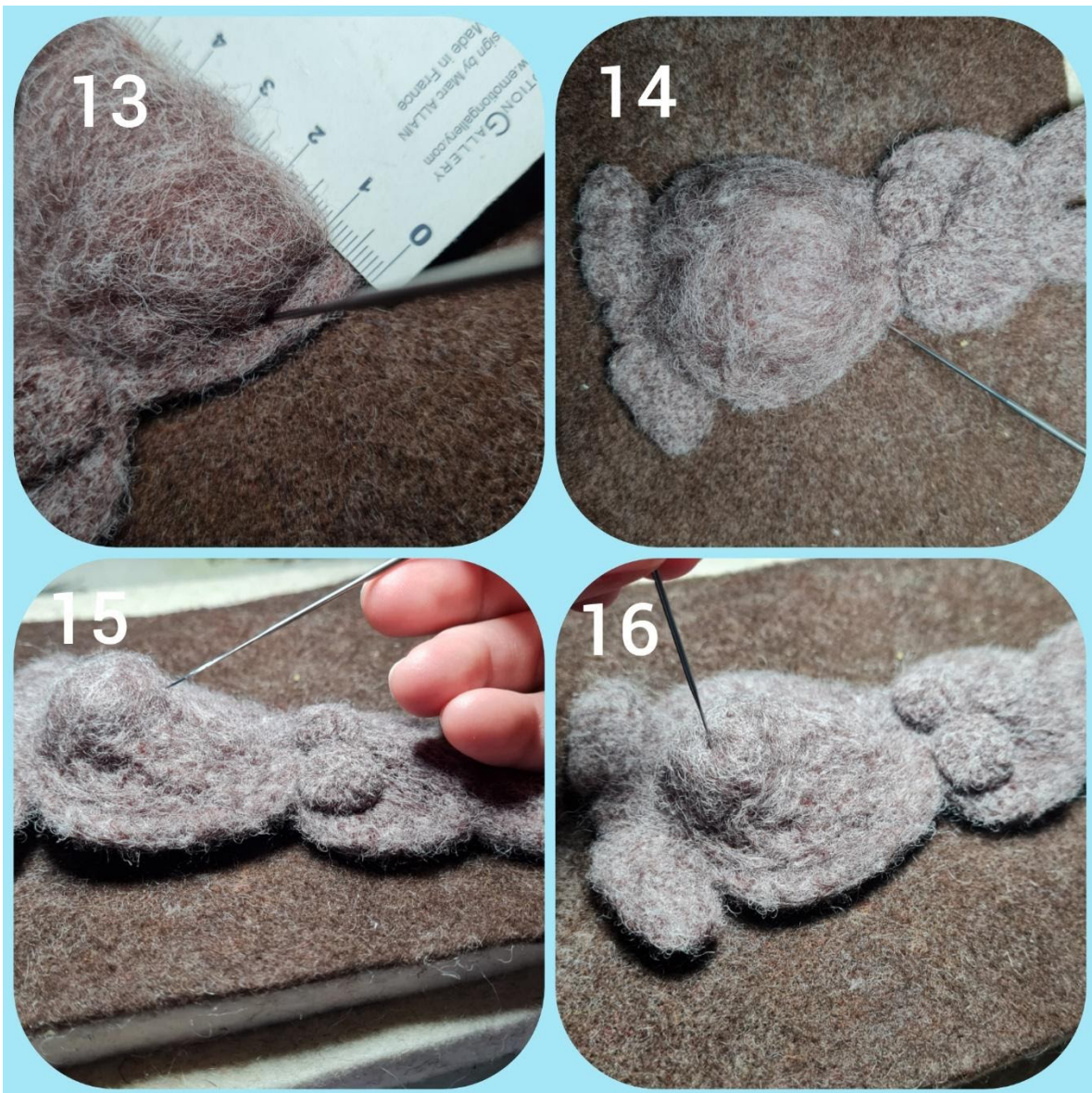

17- place Bunny back in the template and check the edges, making sure there is no distortion.

18- take a fine waft of Mouse wool as shown. We are going to use this to soften the facial features.

19- lay over the face and gently work in using your 40 spiral. Be careful to not distort your earlier shapes. There shouldn't be much give in the features by now.

20- check your overall shape again.



21- take a fine strand of Black fluff and roll into a line between your fingers. Lay it from the tip of the nose and using a 40 spiral felt it in between the cheeks, along the join.

22- take a second piece and felt your V shape under the nose.

23- Mark the eye position with pins. I used 6mm plastic eyes and cut the posts off the back. Simply superglue in place. You could also use fluff and make wool eyes.

24- take a thin piece of contrast wool. I used Off White. Stack the fibres so they all run in the same direction. Fold the top section over slightly, across the width, so that you have a nice clean edge and the fibres are double thickness at the top.

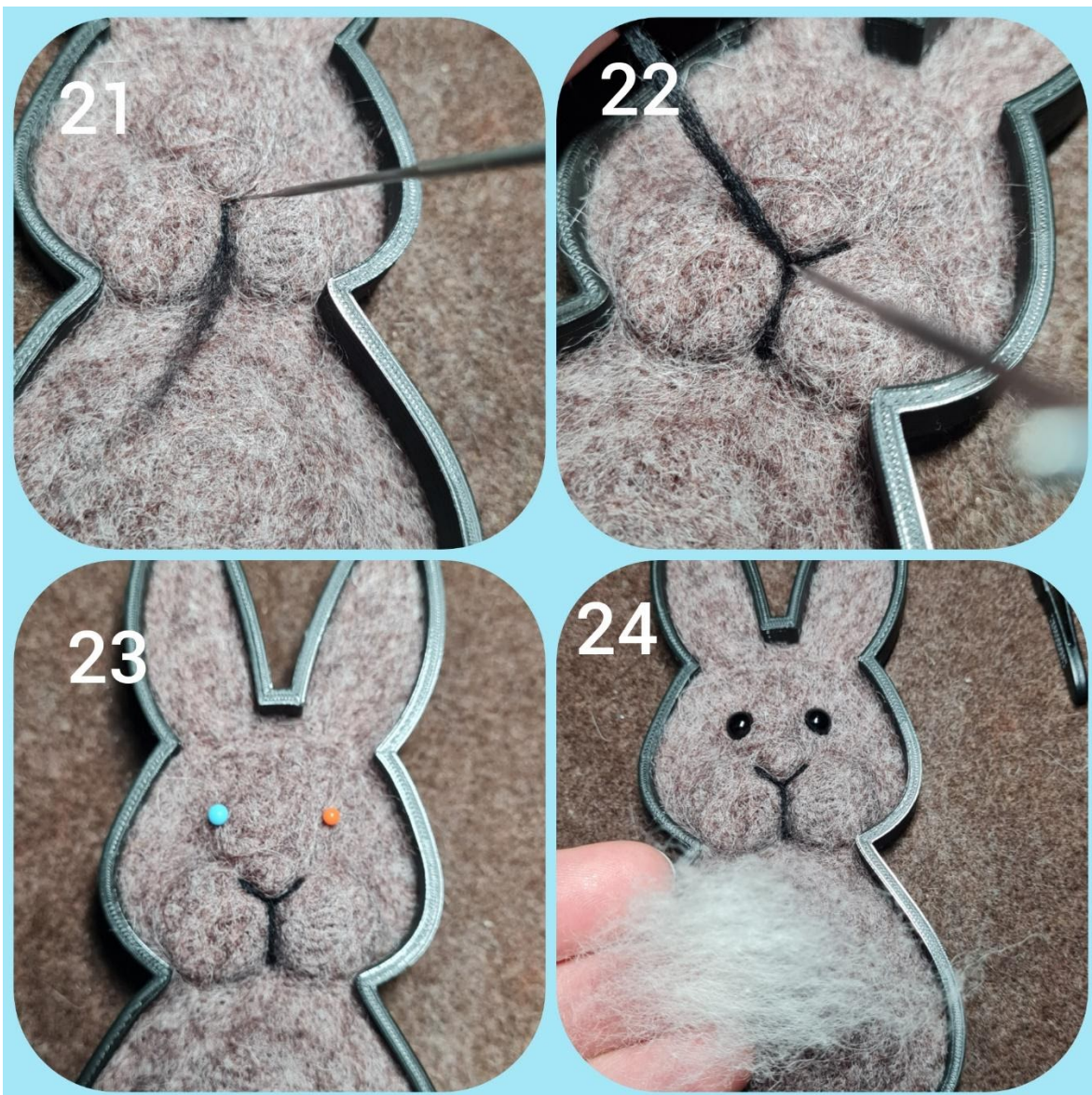

25- sit the clean edge just under the chin and tack in place. Using your fingers gently stretch the remaining fibres downwards over the tummy, fanning them out. Use your fine needle to gently tease them out and then felt them in to give a lovely, graduating, soft effect.

26 & 27- lay a loose waft of Off White on each ear. Felt it on gently, giving it a nice shape. Use your needle to guide the shape of the inner ear as you felt it.

28- use a stronger needle, I used 38 spiral, to define a channel on each side of the tummy to give an arm shape. Gently felt a small V at the paw end to differentiate from the tummy.



29- reverse felt the light area under the chin. Then refelt it with your 40 spiral. This softens the line between the colours.

30- use your fine needle to gently tidy up any lumps, bumps or loose sections of the outline. Use snippy scissors for any random, straggly bits.

31- your Bunny is finished. You can decorate him with a smart bow if you wish!

32- such a versatile template! Forward and Rear Facing Bunnies!



and there you have it, your Bonnie Bunny!

Lots of project potential with this set...

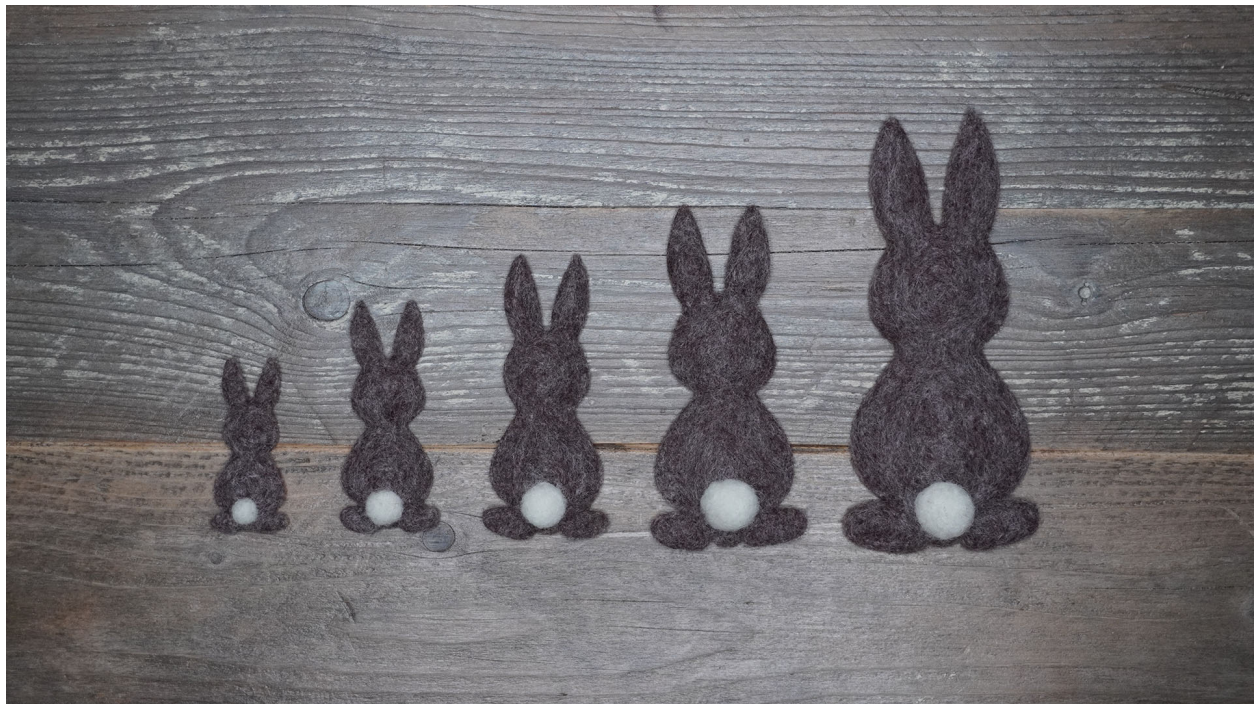

Enjoy!