

INSTALLATION MANUAL

Olide DSW-120N

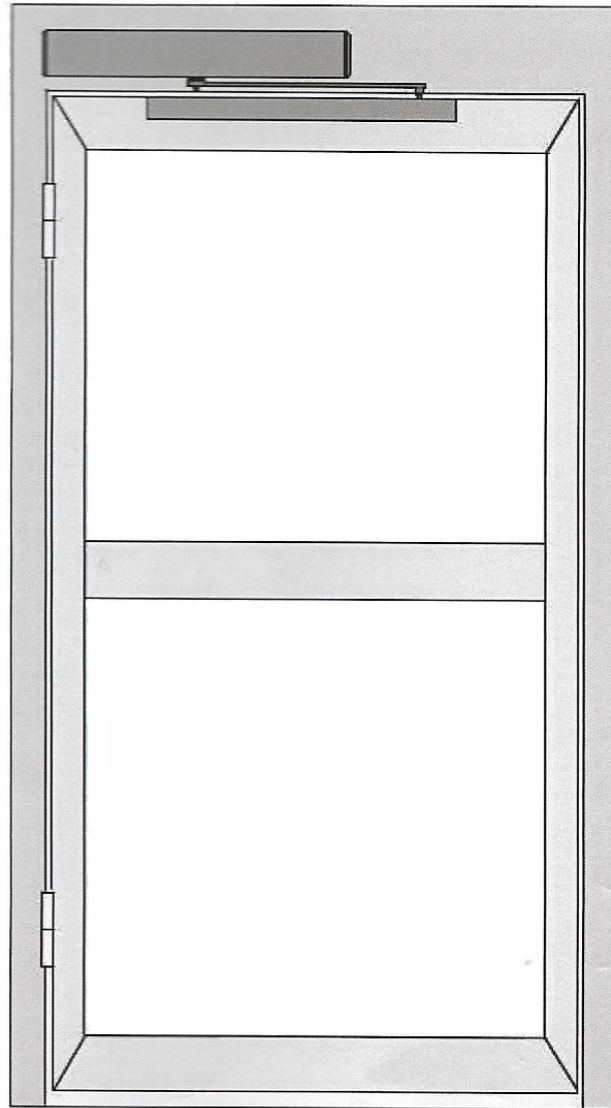

AUTOMATIC DOOR SPECIALISTS

Please note: Programming of the open and close stop points will occur after installation. An uninstalled unit will result in constant motor rotation.

For any questions, feel free to contact us.

Contents

1. Technical Parameters.....	1
2. Components.....	2
3. Installations.....	3
3.1 Installation example.....	3
3.2 Installation of base plate.....	4
3.3 Installation of pull arm.....	5
3.4 Installation of push arm.....	6
3.5 Installation of operation system.....	8
3.6 Installation of cover.....	8
3.7 Connection the operation system with the pull arm.....	9
3.8 Connection the operation system with the push arm.....	9
4. Electrical Connections.....	10
Control panel details.....	10
4.1 Connections with a keypad	10
4.2 Connections with a microwave sensor	11
4.3 Connections with PIR sensors	11
4.4 Connections for a safety motion top scan	11
4.5 Connections for push buttons.....	12
4.6 Connections for wiring disabled push buttons.....	12
4.7 Connections for wireless handicapped push buttons	12
4.8 Connections for magnetic locks	13
4.9 Connections for electric locks.....	13
4.10 Connection with the touchless hand sensor switches	13
4.11 Double door synchronous settings.....	14
4.12 Wireless push buttons settings.....	15
4.13 Remote control settings.....	16
5. Parameters Adjustment.....	17
5.1 hand programmer instruction.....	17
5.2 adjustment steps.....	18
6. Trouble Shooting.....	19

Voltage:	110-220 VAC +/-10%	
Power Consumption:	50W	
Opening Time:	3-7 sec. @ 90 degrees	
Hold Open Time:	1-30 sec. Adjustable	
Max. Door Frame Depth:	450mm / 17.7"	
Door Width:	Min. 660mm / 26"	Max. 1200mm / 47.2"
Max. Opening Angle:	120 degrees	
Environment Temperature:	-20C to 50C	-4F to 122F
Protection Class:	IP12D	
Product Weight:	6.5Kg	14.3lbs
Dimensions:	L515 x H95 x W50mm 20.3"L x 2"W x 3.75"H	

mm=Door width
kg=Door weight

 Suitable range

 Range limit

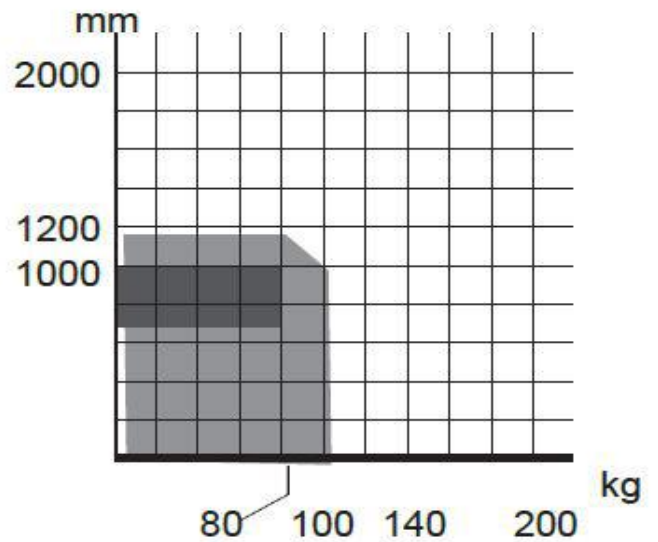

2 Component

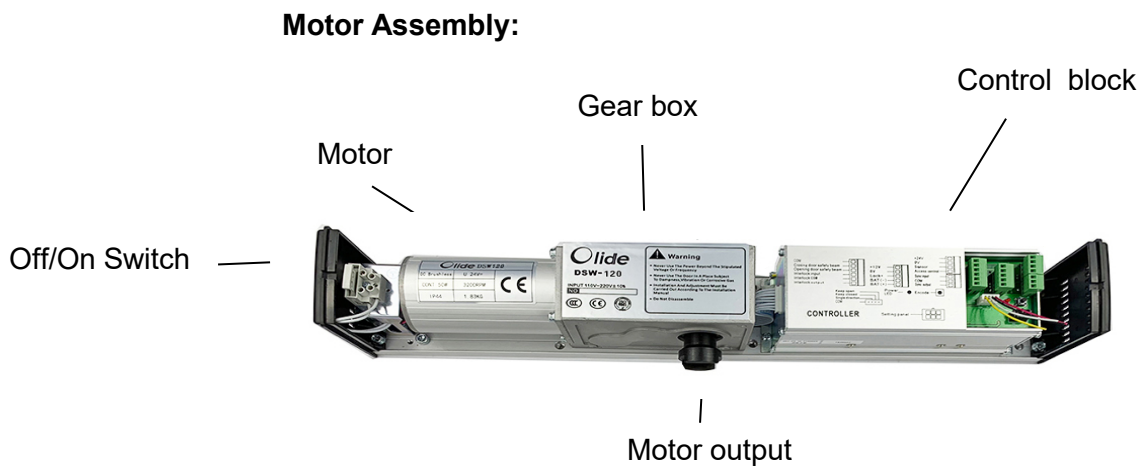

Cover Plate:



Pull Arm (Option for interior opening)



Push Arm (Option for exterior opening)



3 Installation

3.1 Installation example

Pull Arm

The door opens to the inside toward the unit using the pull arm assembly.

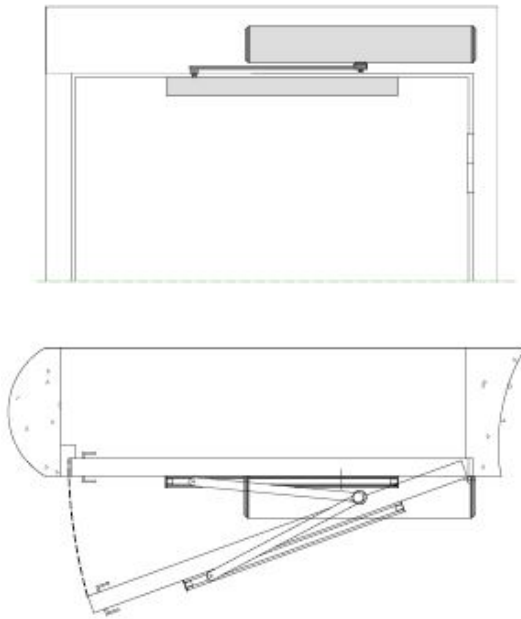

Push Arm

The door opens to the outside away from the unit using the push arm assembly.

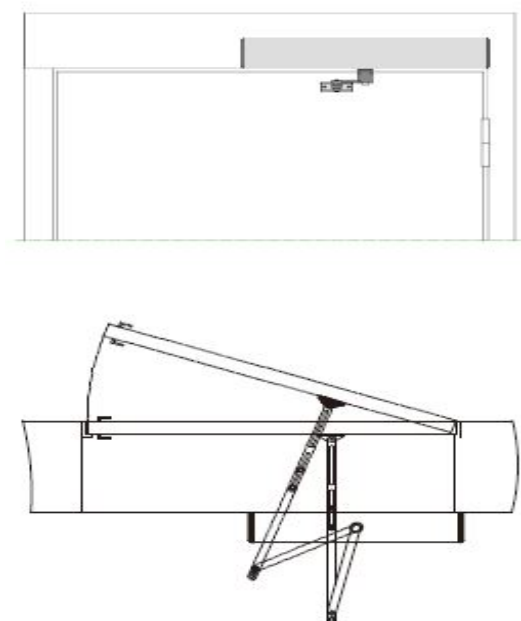

3 Installation

3.2 Installation of base plate

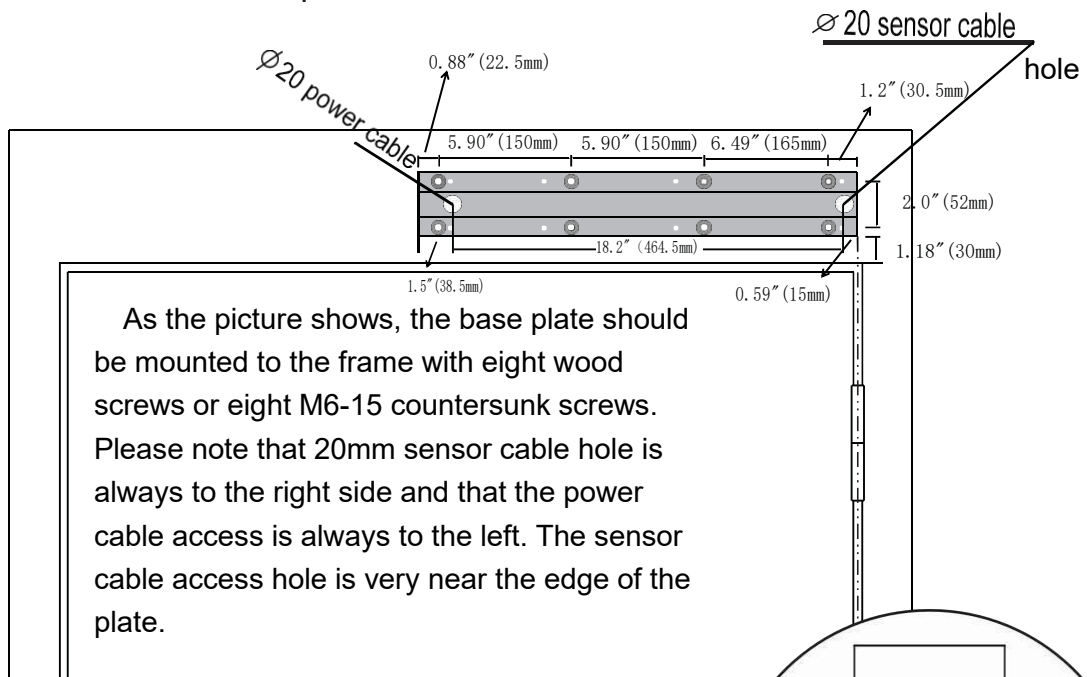

Right side hinge

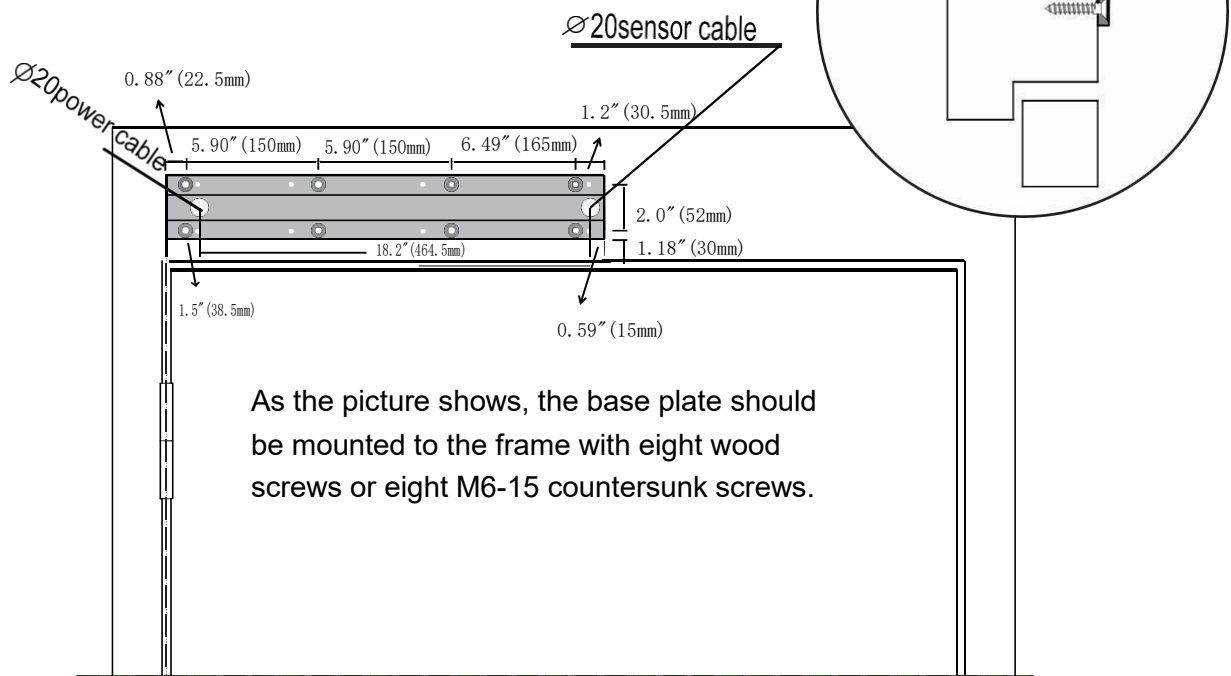

Left side hinge

3 Installation

3.3 Installation of Pull arm

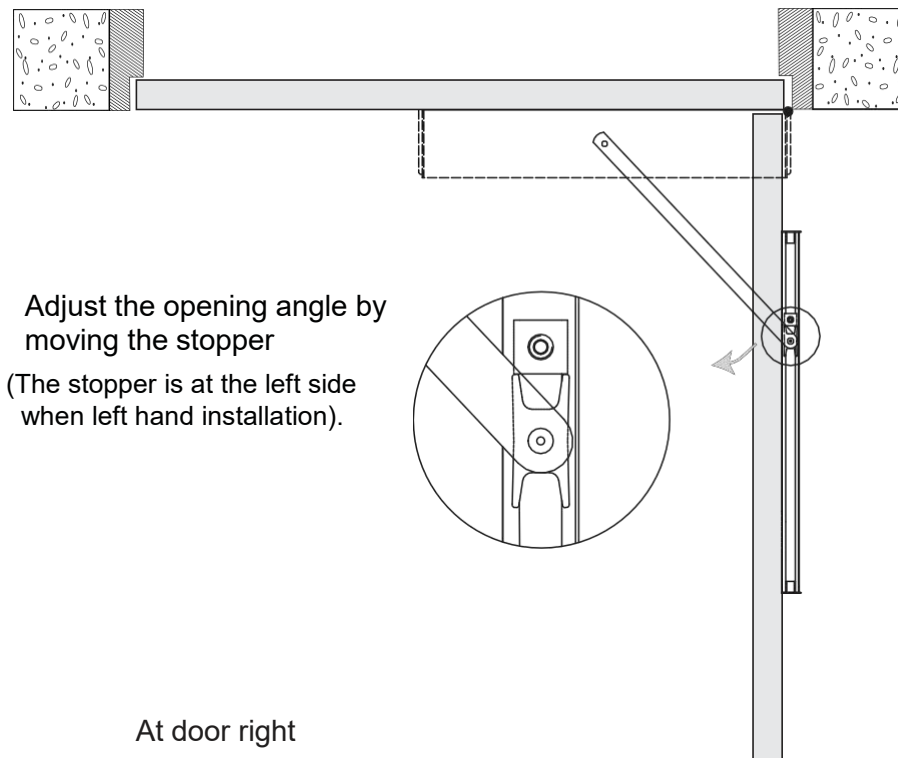
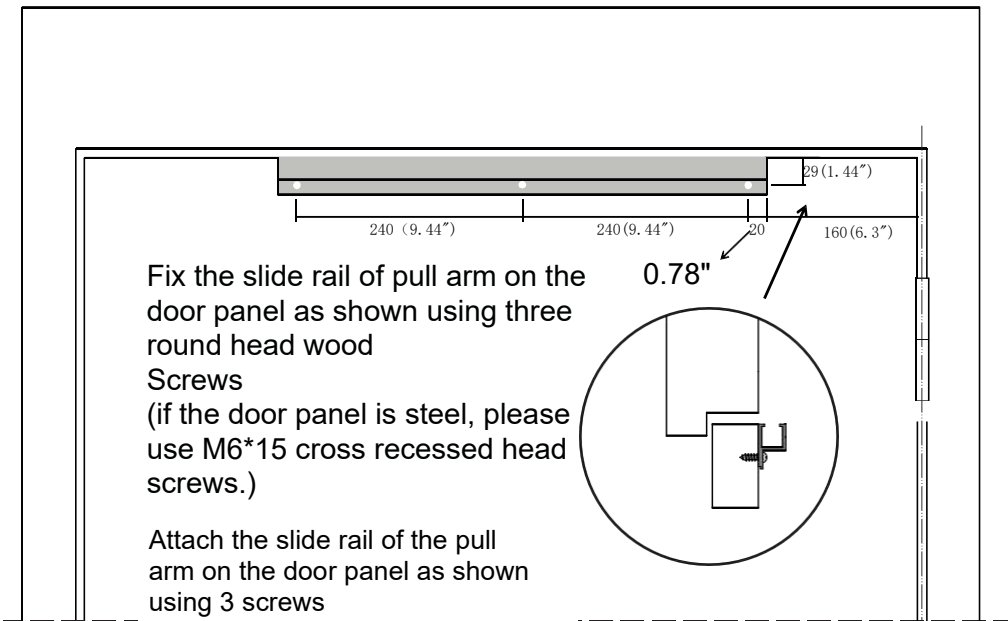

3 Installation

3.4 Installation of Push arm

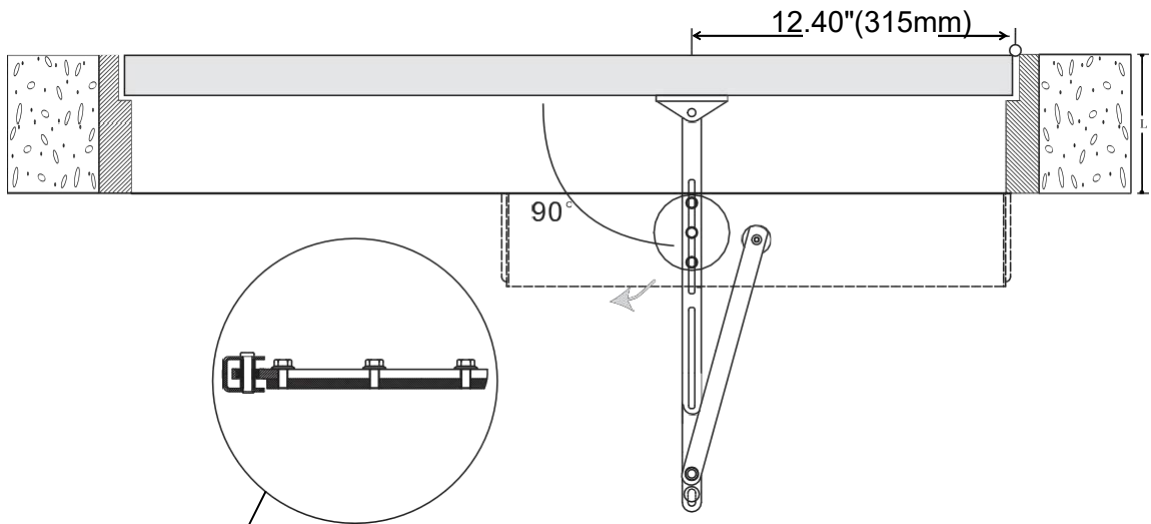
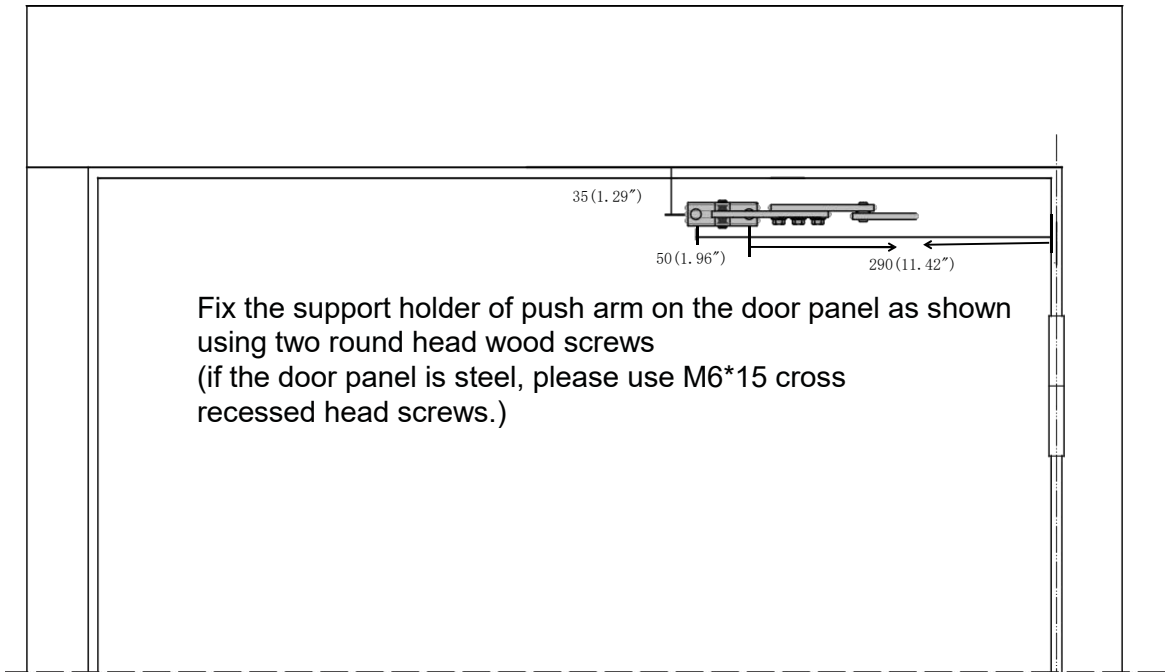

Loosen this 3 bolts and adjust the push arm length according to the door depth(L) until the angle between the push arm and the door panel is 90° .

At door right

3 Installation

3.4 Installation of Push arm

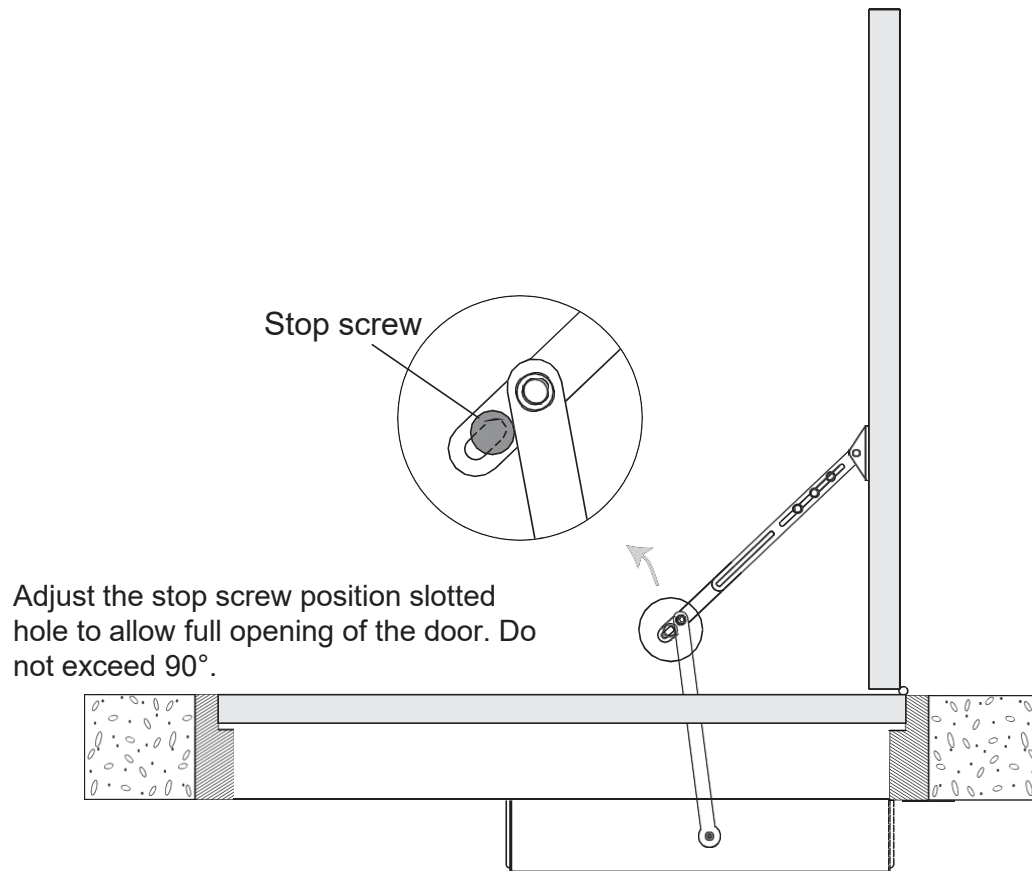

3 Installation

3.5 operation system

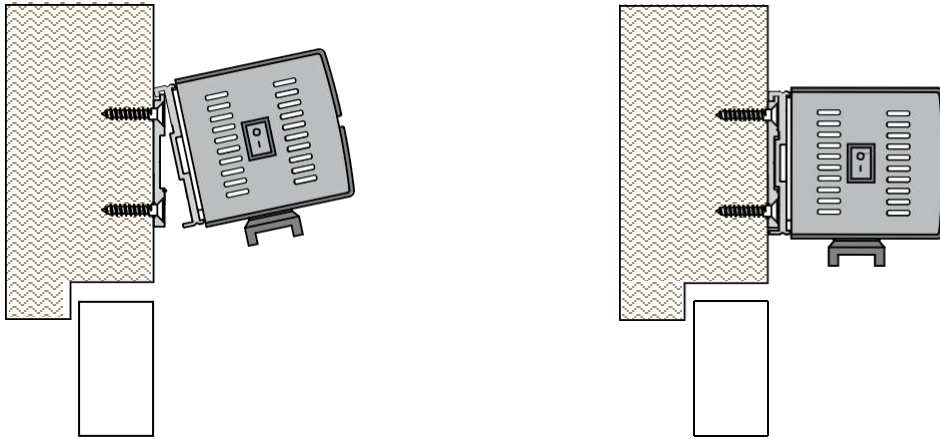

Hook the component assembly onto the base plate as shown.
Attach it with 8 allen head screws

3.6 Cover

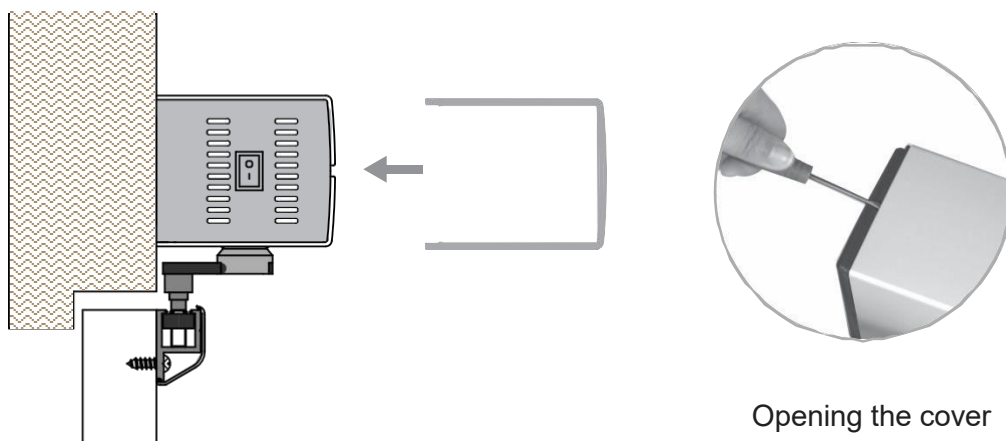

Opening the cover

3 Installation

3.7 Connect pull arm to the operation system

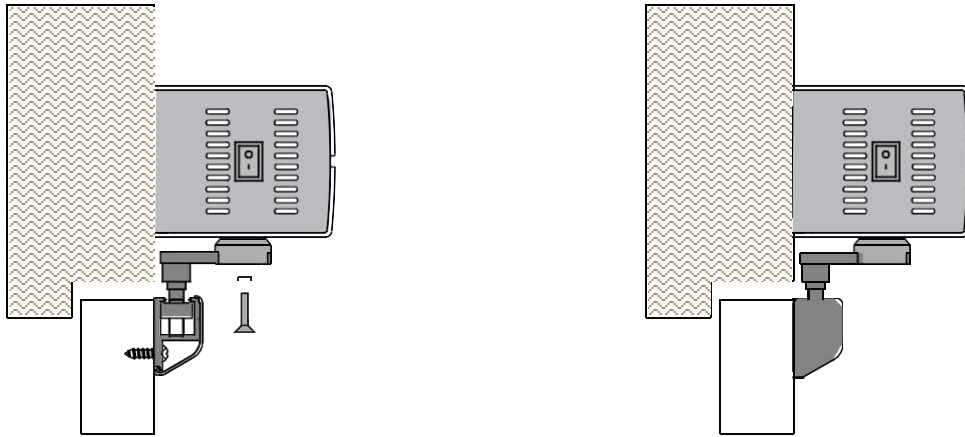

3.8 Connect the push arm to the operation system.

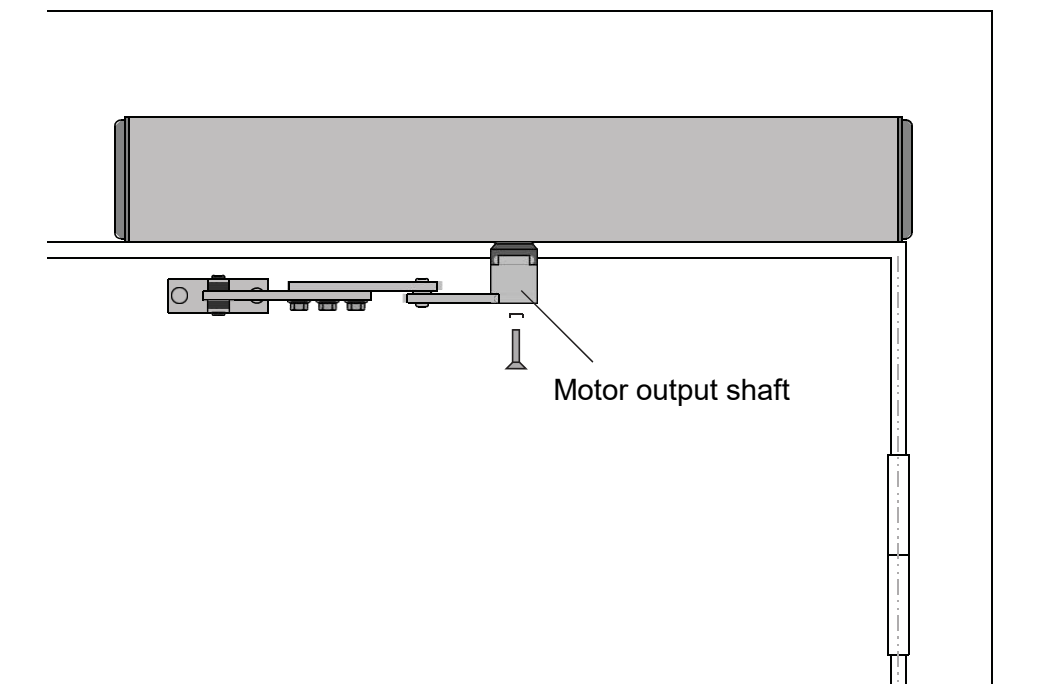

4· Electrical Connections

Control panel details

Power input located on the left side of the component assembly.

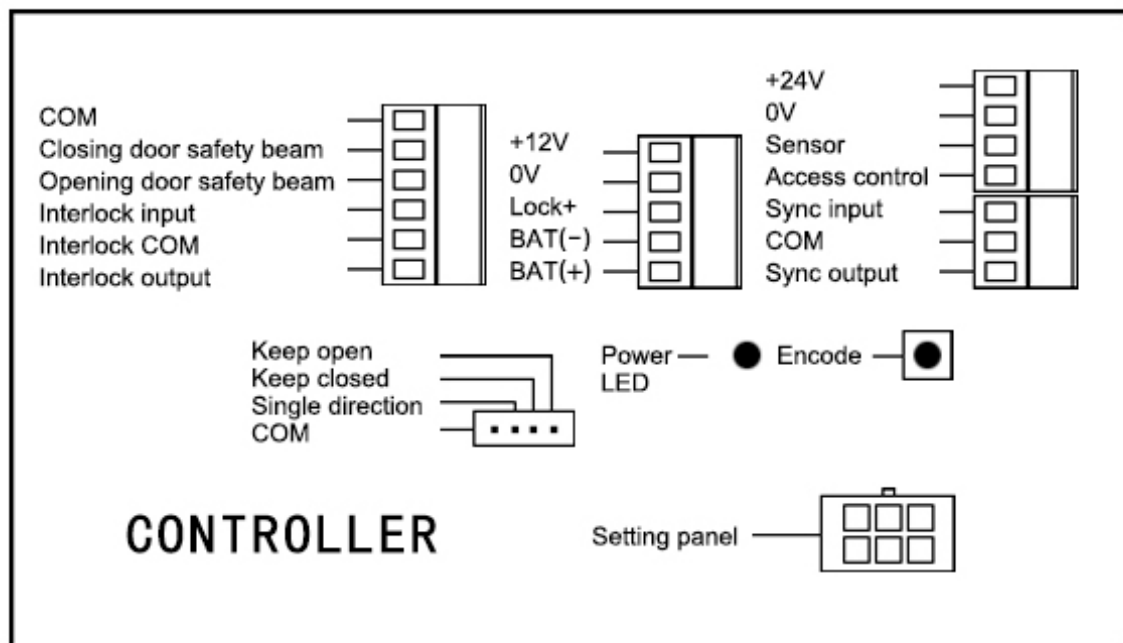
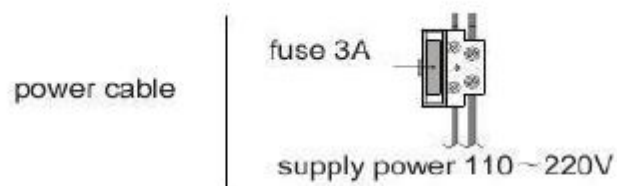

4.1 Connections with a keypad

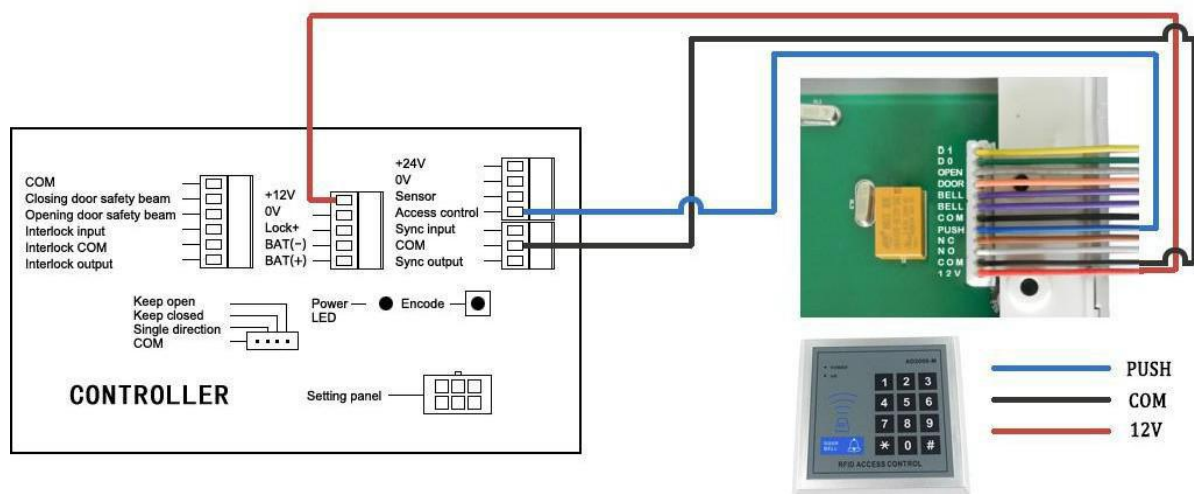

4· Electrical Connections

4.2 connections with a microwave sensor

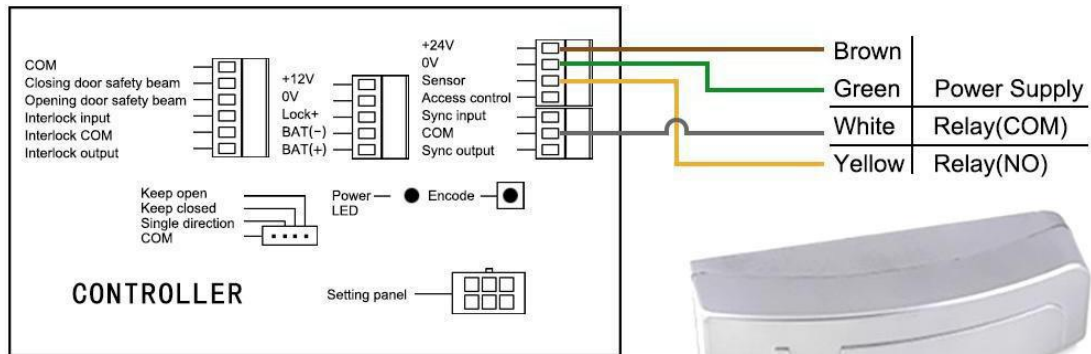

4.3 connections with PIR sensors

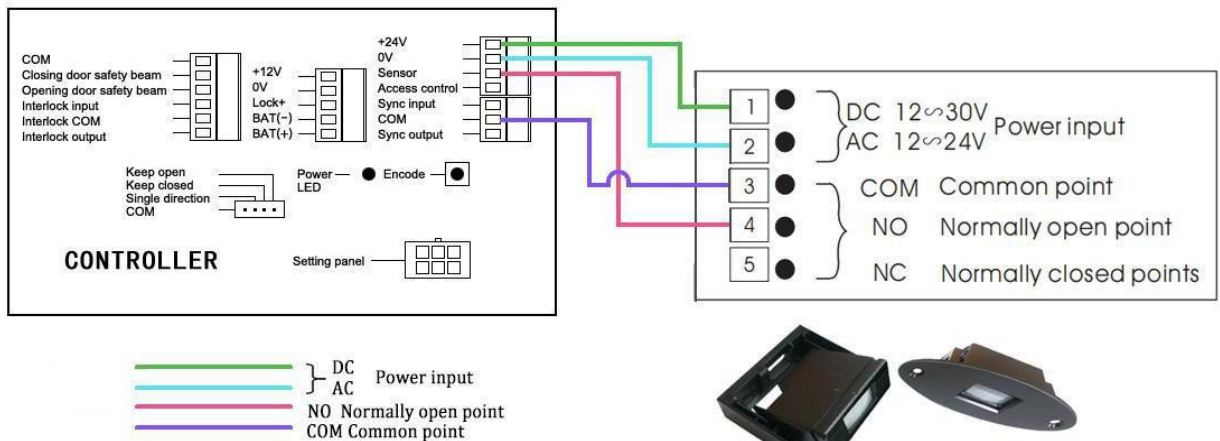

4.4 Connections for a safety motion top scan

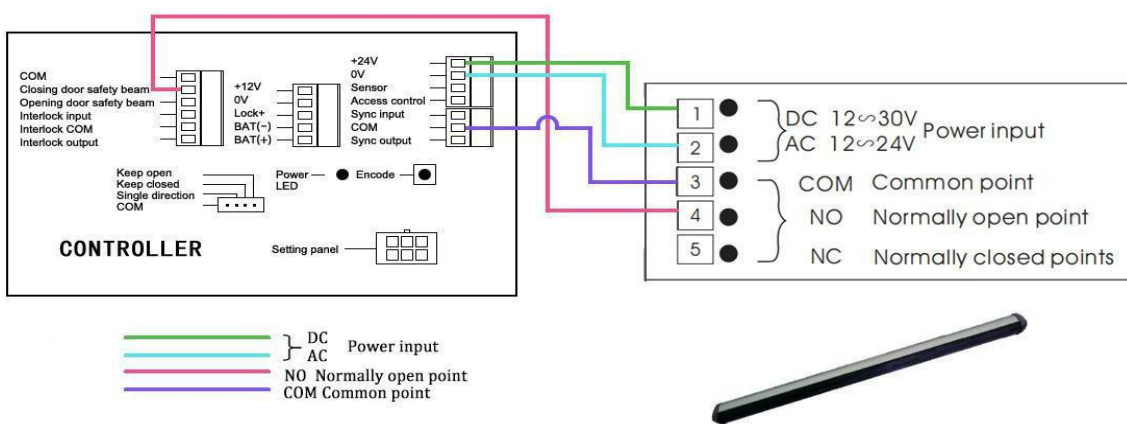

4 Electrical Connections

4.5 Connections for plastic push buttons

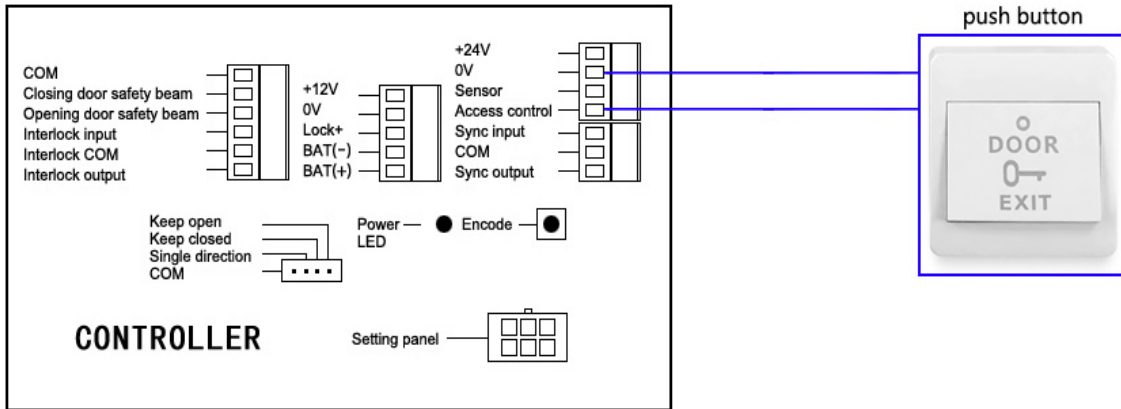

4.6 Connections for wiring disabled push buttons

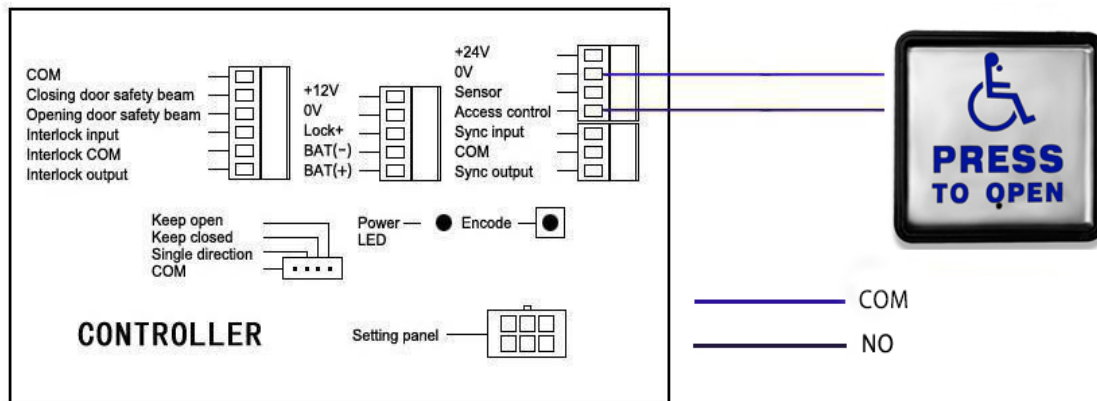

4.7 Connections for wireless handicapped push buttons

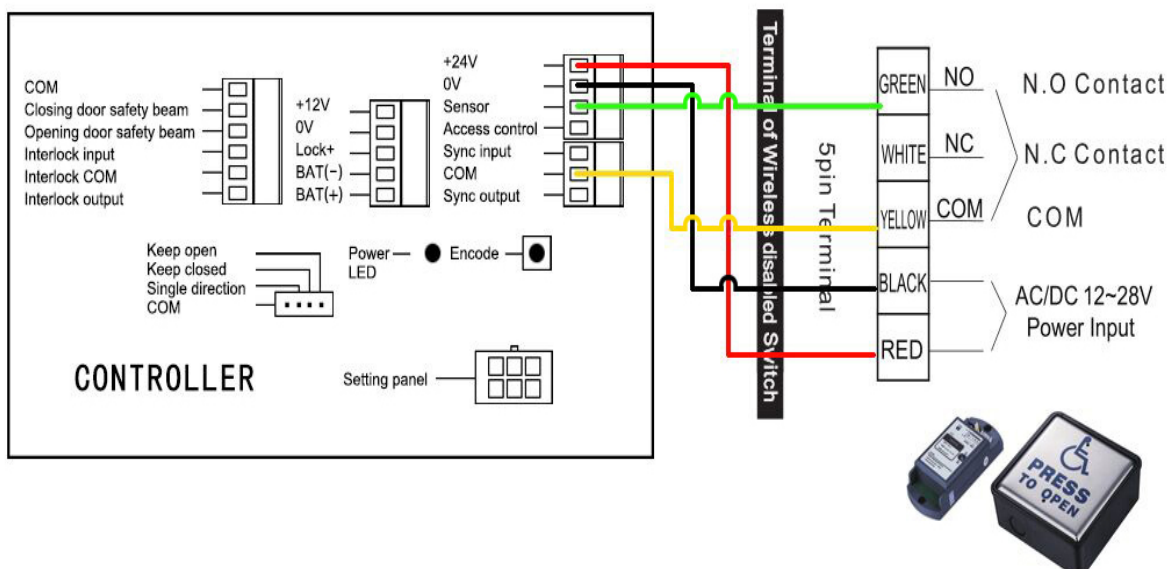

4 Electrical Connections

4.8 Connections for magnetic locks

(Need to press the lock button on remote control for the first close, then it will auto lock when close)

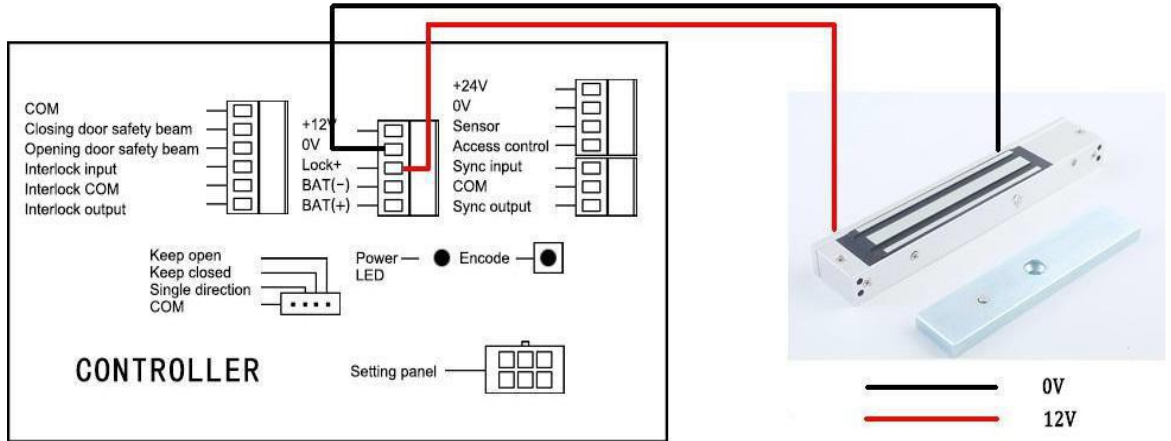

4.9 Connections for electric locks

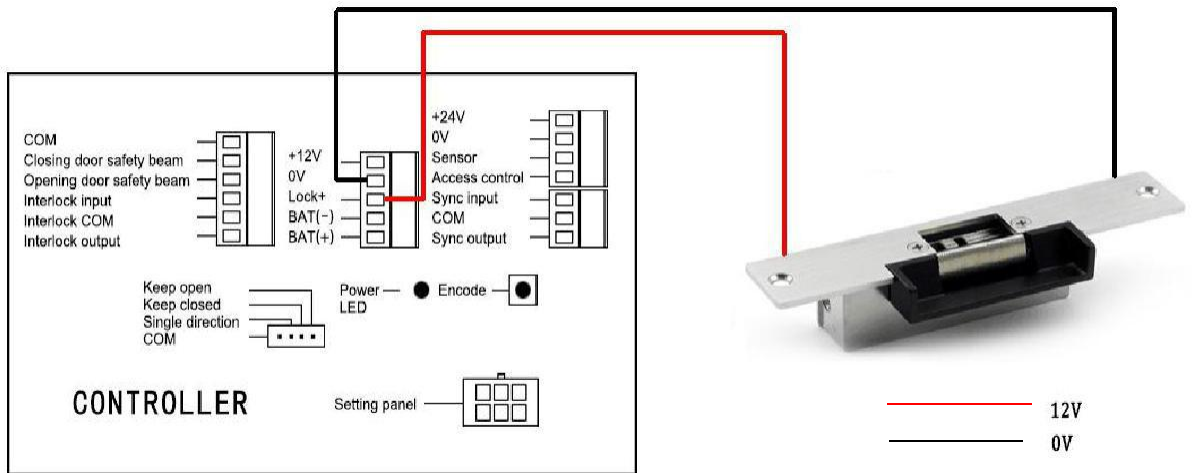

4.10 Connections for hand sensor touchless switch

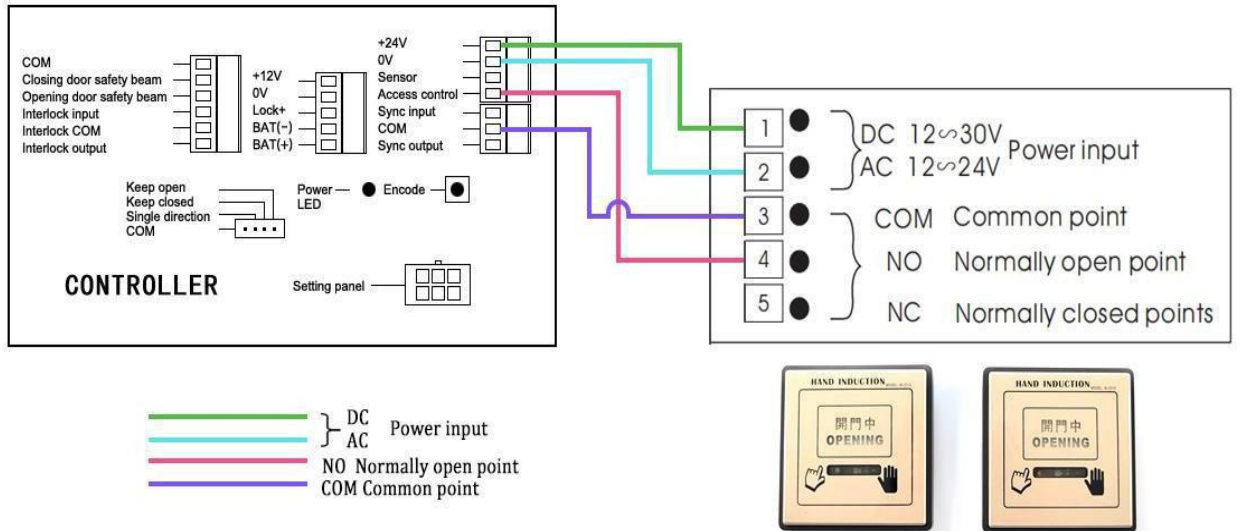

4 Electrical Connections

4.11 Double door synchronous

connections **double door synchronous** :

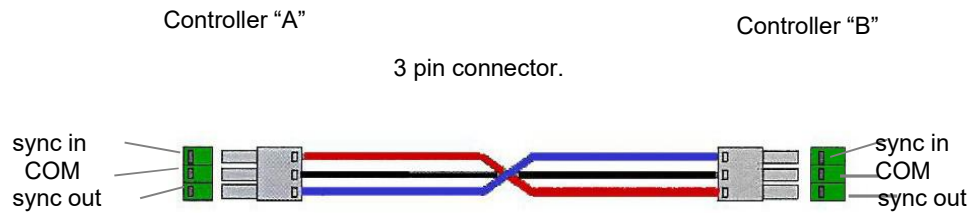

Interlock:

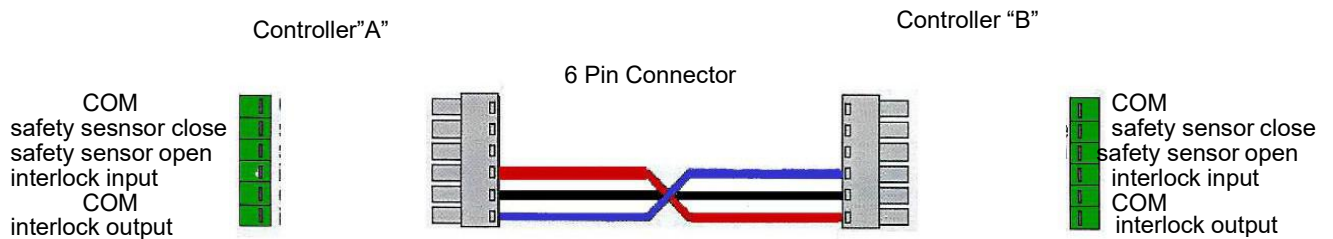

Please use the hand programmer for setting the double door synchronous . The detailed steps and written on the Page 17and 18.

4.12 Wireless push buttons settings



The wireless push buttons are encoded with the opener component assembly.

Code Learning Description:

1. Delete: Long press "encode" button, until you can not hear the buzzer sound, release the "encode" button.
2. Code: Press "encode" button once, buzzer is sounding, now press the PRESS button, the buzzer stops sounding, that indicate the code is successfully learned. When using the remote control, the buzzer will sound for 2 seconds.
3. Note: When you use the PRESS buttons, the buzzer "beep" two times, indicate that the PRESS button learning is failed, please do once more step 2.

4.13 Remote control settings

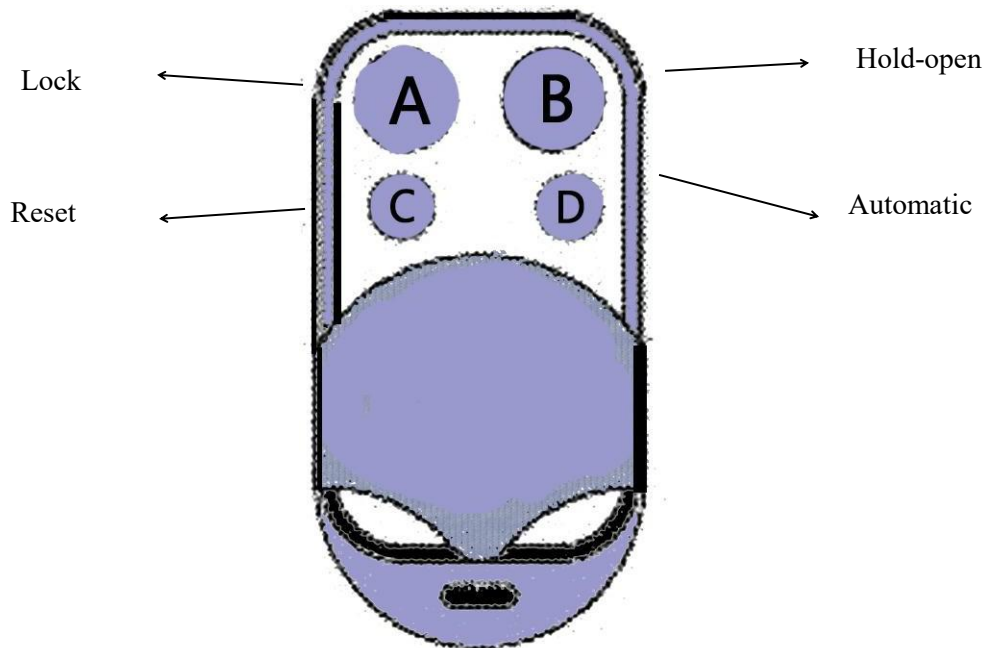

Encoding the remote with the component assembly:

1. Delete all: Hold the “Encode” button on the component assembly until the buzzer is silent.
2. Encoding: Hold the “Encode” button until the buzzer sounds.
Then press any button on the remote control.
The buzzer should silence which means that encoding is complete.
3. Now when the remote control is used the buzzer will sound for 2 seconds.
If the buzzer beeps twice the encoding has failed. Repeat step 2.
4. When pressing the automatic button “D” one time, the door will open and close one time.

Note: No more than 10 remotes can be used on any system.

5 Parameters Adjustment

5.1 Hand programmer instruction

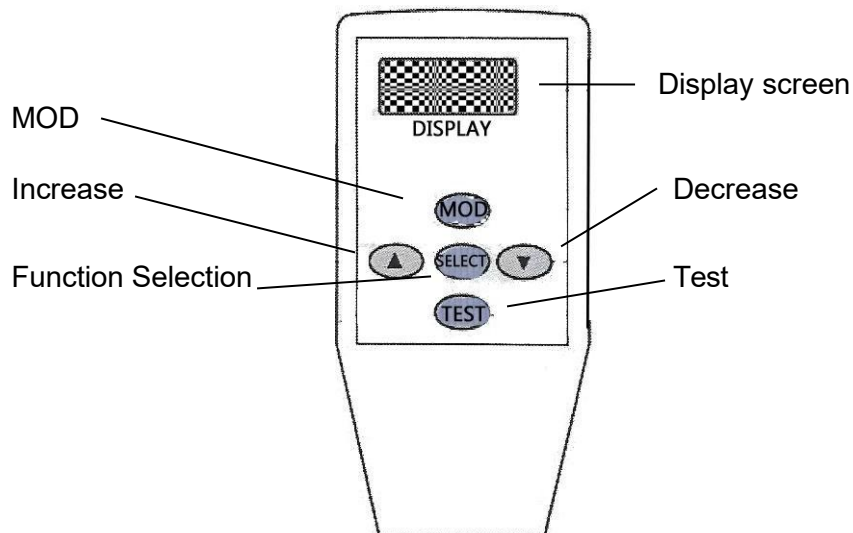

Display Screen guide and function display

F – 1 work parameters

os = opening speed

od = opening low speed angle

cs = closing speed

cd = closing low speed angle

jb = closing force

ok = opening hold time

ERR3: Time out → Need to Replug

ERR4: Date Error → Need to Repair

F – 2 door parameters

n1 single/double door

n2 master/slave

n3 synchronize settings

o manual open door settings

L lock mode selection

F open direction settings

P door closer settings

increase operation = increase data

decrease operation = decrease data

function select / confirm parameter data

→ next parameter

→ parameters saved

→ parameters send

TEST = check settings and test the door

5 Parameters Adjustment

5.2 adjustment steps

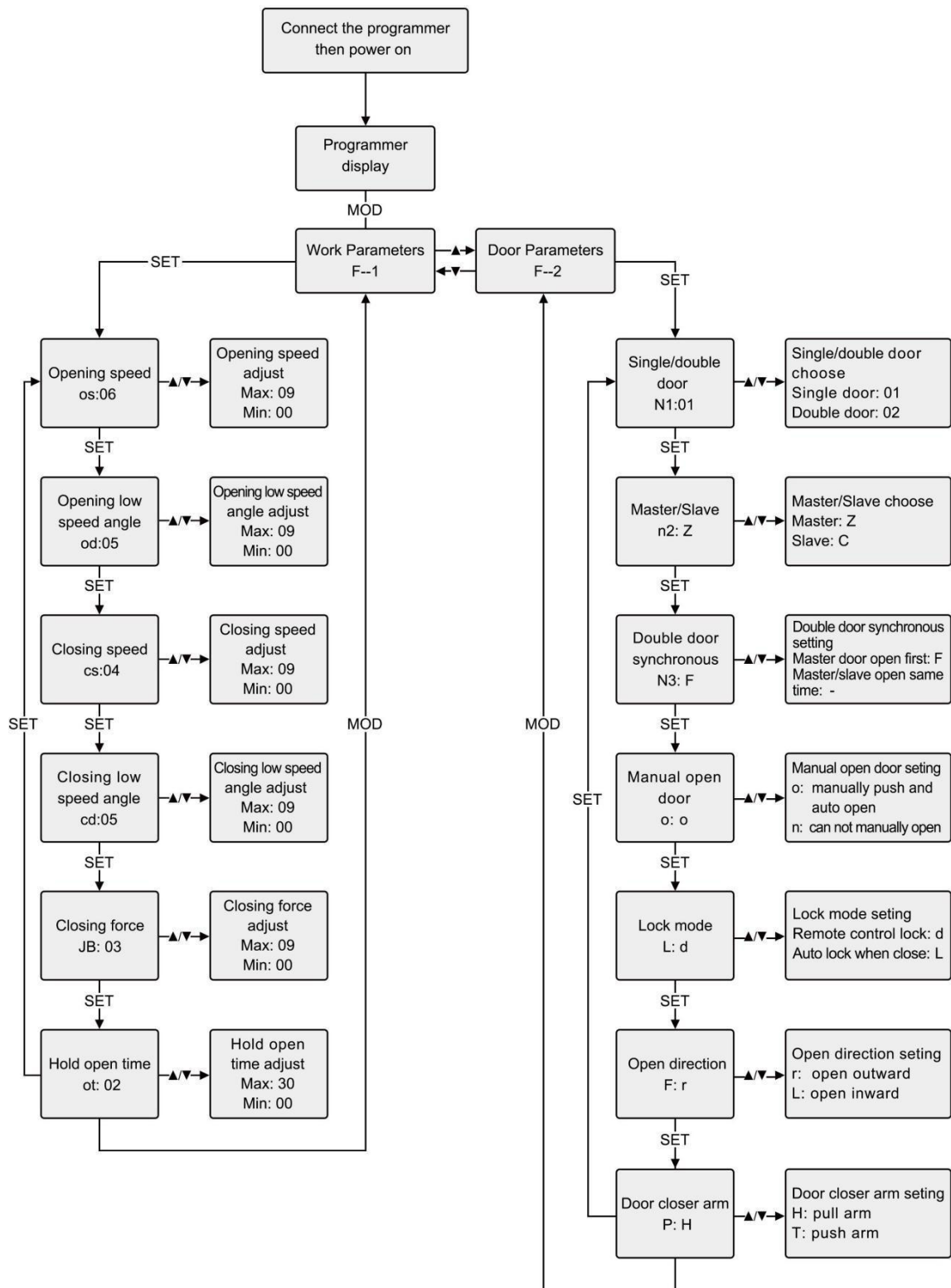

Symptoms	Remedies
The door opens in wrong direction and the machine doesn' t work.	power off, manually open the door in half open. then power on, the door goes to closing direction, if not,change the open direction.
rebound when closing the door, repeat open and close actions	<ol style="list-style-type: none">1. clear the obstacle away2. Increase the closing force with the hand programmer
Lock not work	Need to press the lock button on remote for the fist close