

BN-LINK®

PRODUCT#
BND-60/U165

24 HOUR MECHANICAL OUTDOOR TIMER



ENERGY
SAVING

Please keep this handbook

www.bn-link.com

OPERATING INSTRUCTIONS

Step 1. Pull all black pins to upper position

Note: The pins are in down position when taken out of package.



Fig 1. Pull up

Step 2. Set a period of time for the unit to be "ON"

Locate the black pins and push them down at the marked times when the attached device is to be "ON". Each pin represents a 30-minute time interval.

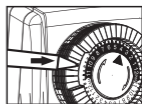

Fig 2. Push down

Note: Make sure all pins are in the upper position before beginning.

Example: "ON" time is 9:00PM, "OFF" time is 12:30AM. Push down all of the pins between 9:00PM and 12:30AM.

Note: Pins are black slices around the dial.

Step 3. Set the "CURRENT TIME"

Rotate the entire black push-pin dial clockwise until the arrow aligns with the current time of day on the dial.

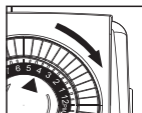

Fig 3

Example: It is 4:00PM, please rotate the dial clockwise until the arrow aligns with 4:00PM on the dial.

Note: Please pay attention to AM/PM.

Step 4. Set “BYPASS SWITCH”

When the switch is up in ON position, the unit will bypass the programming and your attached device will remain ON. When the switch is down in “⊖” position, the unit will automatically turn your attached device ON and OFF according to the programmed time.

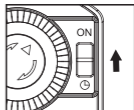

Fig 4

Step 5. Insert the plug of the timer into an wall socket

You may fix the timer on the wall with the hang hole on the cord strain relief.

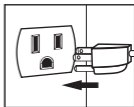

Fig 5

Step 6. Attach one or two devices to the unit

Plug device into the timer. make sure that the attached device is switched ON.

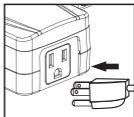

Fig 6

HELPFUL TIPS

1. This timer repeats the same settings daily.
2. To push down or pull up the push pins, use your finger or the tip of a small instrument such as a pen or pencil.
3. You can set up to 24 different "ON" and "OFF" times in a 24-hour period. Push pins pressed down represent the "ON" time, push pins in the up position represent the "OFF" time.
4. When the switch is up in the ON position, the unit will bypass programming, however, the timer dial will continue to rotate and maintain the current time.
5. Unit will stop operating if the power goes out. Once power is resumed, reset the time of day as explained in Step 3 of the instructions.

RATINGS

Rated Voltage:

125V, 60Hz

Max.Loading:

15A Max.1875W Resistive or General Purpose

8A Tungsten Lamp

1/2 HP TV-5

WARNING

- Use a grounded outlet
- Follow local electrical codes
- For indoor/outdoor use
- Keep children away
- Unplug timer before cleaning
- Fully insert plug
- Do not exceed electrical ratings

APPLICATIONS

- Lighting
- Heating systems
- Humidifiers
- Nebulizers
- Cooling systems
- Sprinklers
- Aquariums
- Ventilators

PRODUCTS VIEW

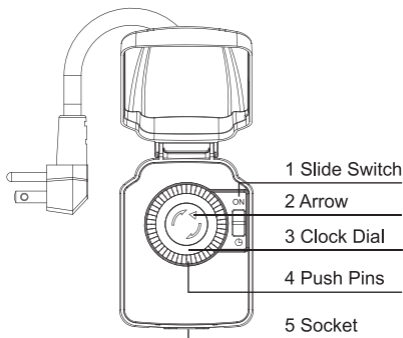

- ① **Slide Switch:** Slide the switch down for timing. Slide the switch up for always ON.
- ② **Arrow:** Indicates the current time of day.
- ③ **Clock Dial:** Black Part= 12PM-12AM Hours; White Part= 12AM-12PM Hours.
- ④ **Push Pins:** Each pin represents 30 minutes. Pins down = ON; Pins up = OFF.
- ⑤ **Socket:** Only intended to be used with a grounded device.

TROUBLESHOOTING

- **PROBLEM:**

Appliances do not turn on as programmed.

- **POSSIBLE CAUSE:**

Connected appliances are not in “ON” position; they are not functioning; timer is not receiving power, or “BYPASS SWITCH” is up in ON position.

- **CORRECTIVE ACTION:**

Ensure the connected appliances are functional by plugging them directly into the outlet. Be sure the connected appliances are in the “ON” position if they have their own switch. Make sure the power outlet which the timer is plugged into is active. Check that the “BYPASS SWITCH” is down in “⊖” icon.

- **PROBLEM:**

Appliances come on before or after programmed times.

- **POSSIBLE CAUSE:**

“CURRENT TIME” was not properly set.

- **CORRECTIVE ACTION:**

Check that the current time is correctly set. Note that the black section includes hours from 12 pm to 12 am and the white section includes hours from 12 am to 12 pm.

BN-LINK INC.

12991 Leffingwell Avenue, Santa Fe Springs
Customer Service Assistance: 1.909.592.1881
E-mail: support@bn-link.com
[Http://www.bn-link.com](http://www.bn-link.com)
Hours: 9AM - 5PM PST, Mon - Fri
Designed in California Made in China