

# UVF MOUNT (ALEXA MINI, No Clamp)

Included:

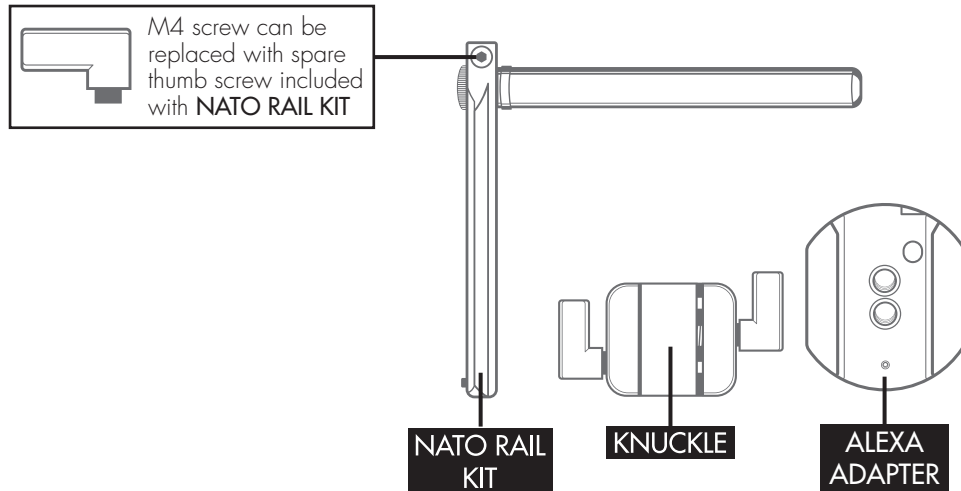

## INSTALLATION

1. Select **NATO RAIL KIT** and locate **15mm OPENING** on **NATO HANDLE PLUS**.
2. Slide **NATO RAIL KIT** into **15mm OPENING**, tighten using thumbscrew.

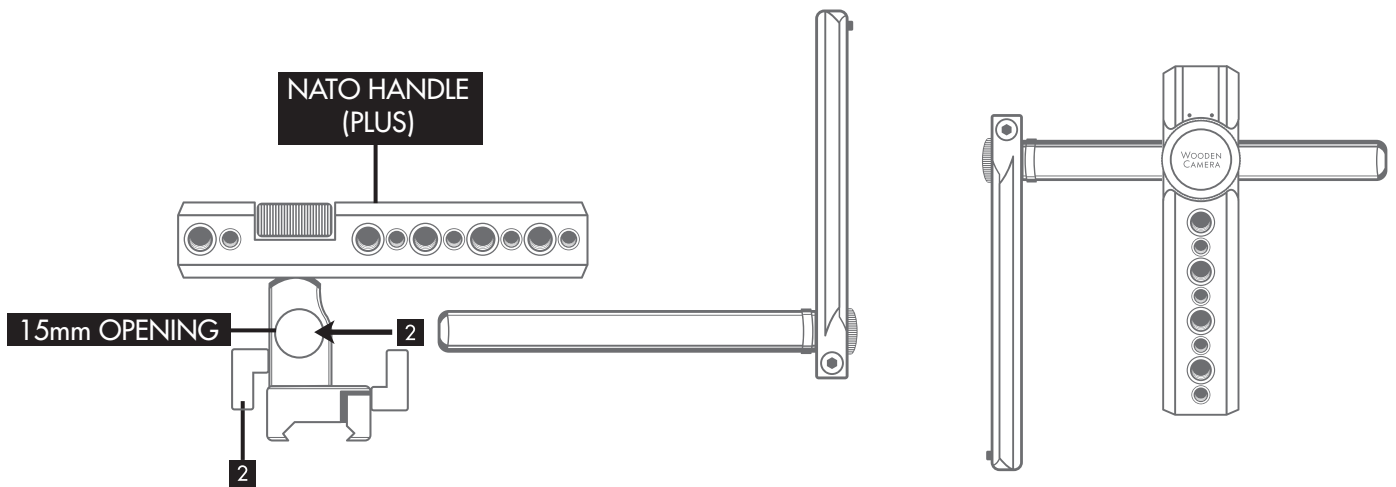

3. Slide **KNUCKLE** and **ALEXA ADAPTER** onto **NATO RAIL**.

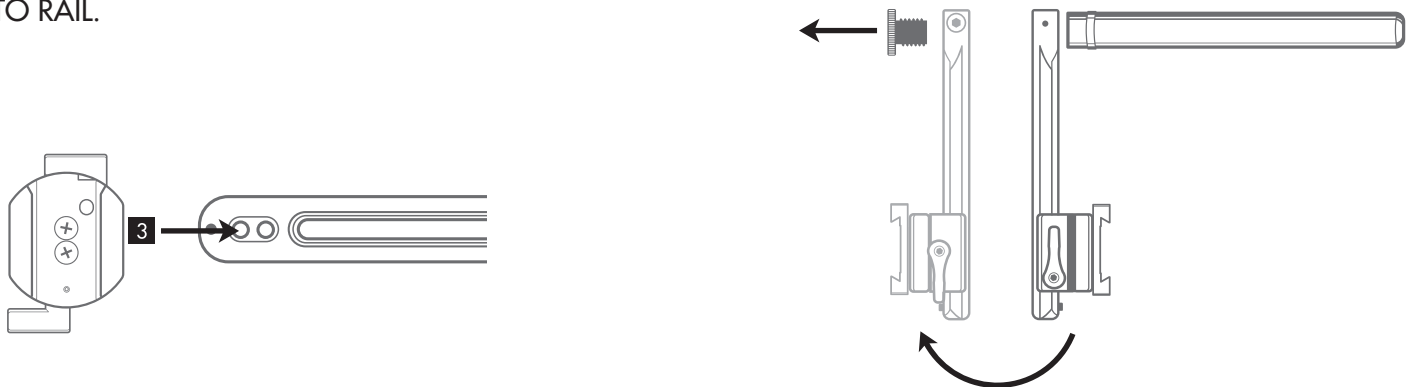

NOTE: To change viewfinder position, remove **ROD END CAP**, flip **NATO RAIL**, reinstall and adjust viewfinder using **KNUCKLE THUMBSCREW**