

# W.S. GAUGES

ENGINEERED PERFORMANCE MEASUREMENT

## PRESSURE GAUGE

www.railyardsupply.com

(610) 652-5217

DATE	DOC	CREATED BY	GRADE	
1/21/2021	V0121WSG1	RSW	INDUSTRIAL	1827 County Line Rd. Barto, PA 19504

### PRO-201D DRY/FILLABLE LOWER MOUNT



#### SPECIFICATIONS

DIAL	2-1/2" (63 mm)
CASE	Stainless Steel, Dry / Fillable
WETTED PARTS	Copper Alloy
BEZEL	Stainless Steel, Fixed
LENS	Polycarbonate
POINTER	Black Aluminum
CONNECTION	Lower Mount 1/4" MNPT
SCALE	Standard: psi/BAR (x 100 = kPa)
ACCURACY	2-1-2% of span ASME B40.1 Grade A
AMBIENT TEMP.	Glycerine Filled = 30° F to 160° F Dry = -30° F to 180° F
EST. UNIT WEIGHT	0.40 lbs. (0.20 kg)
<i>* Design meets or exceeds ASME B40.100 pressure gauge standards.</i>	

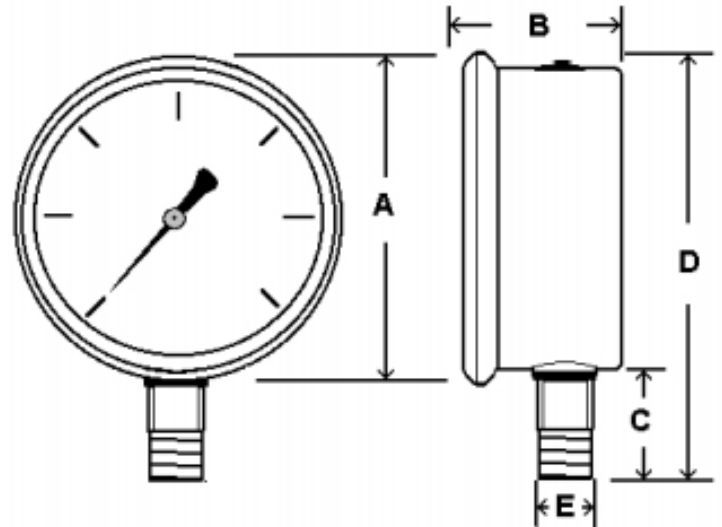

DIAL	UNIT	A	B	C	D	E
2-1/2"	Inches	2.65"	1.20"	0.88"	3.30"	1/4"
	millimeter	68	30	22	84	MNPT

**RYSC**

RYSX Railroad Equipment Specialists

1827 County Line Rd, Barto, PA 19504

(610) 652-5218 [sales@railyardsupply.com](mailto:sales@railyardsupply.com)