

Pump Specification

SUCT.FLANGE SIZE	6"	DRILLING	ANSI 150#	FACING	FF	FINISH	SERRATED
DISCH.FLANGE SIZE	4"	DRILLING	ANSI 150#	FACING	FF	FINISH	SERRATED
PUMP ROTATION (LOOKING AT PUMP FROM MOTOR)				CW			
TYPE OF LUBRICATION	FLOOD OIL			COOLED	NO		
TYPE OF STUFFING BOX	TAPER BORE PLUS WITH AXIAL RIBS			COOLED	NO		
TYPE OF SEALING	MECHANICAL SEAL						

Weights and Measurements

PUMP	275.0 lb
MOTOR/CPLG	/21.0 lb
BASEPLATE	1b
TOTAL	296.0 lb
GR.VOLUME w/BOX	17.9 ft ³
GR.WEIGHT w/BOX	386.0 lb

Motor Specification

MOTOR BY	CUSTOMER	MOUNT BY	CUSTOMER	MFG.	CUSTOMER'S CHOICE
FRAME	365TS	POWER	75.0 hp	RPM	3600
PHASE		FREQUENCY	60 HZ	VOLTS	230/460
INSULATION		S.F.	1.15 OR HIGHER		
ENCLOSURE	TEFC, SEVERE DUTY, NEMA PREMIUM EFFICIENT, EP0752 OR SIMILAR				

Notes and References

* Tolerance is -0.38 +0.38
FOR PUMP TAPPED OPENINGS REFER TO DWG.: TRG-21-11-30 01 / 75 HP unit (pump only)

Auxiliary Specification

COUPLING BY	CUSTOMER	CPLG TYPE	T.B. WOOD'S SC 9
CPL GUARD BY	CPLG GUARD MATL		
BASEPLATE			
MECH.SEAL	JOHN CRANE 5611Q X(1)F(50)IXO(58)1 (CARBON VS SILICON CARBIDE WITH VITON)		

DRAWING IS FOR REFERENCE ONLY.
NOT CERTIFIED FOR CONSTRUCTION UNLESS SIGNED.

Customer: CWI
Serial No:
Customer P.O. No:
Item No: 75 HP unit (pump only) (Alternative)
End User: CWI
Service: Fuel Loading Pump

Copyright 2021
ITT Corp

DRAWING NO A1RG-21-11-30 01/75 HP unit (pump only)

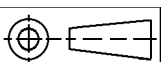

All dimensions are in inches.
Drawing is not to scale
Weights (lbs) are approximate



Model 3196 Speed 3560 RPM		Size 4x6-10G Frequency 60Hz	
Purchaser CWI End User CWI Item No. 75 HP unit (pump only) (Alternative) Service Fuel Loading Pump Perf Std HI 14.6 1B basis power Certified By	Liquid #2 Fuel Oil Nom. Temperature 70.0 deg F Spec. Gravity 0.880 Viscosity 3.520 cp Vapor Press Solids% / Size	Date 12/01/2021 Issued by: Rob Greve Quotation No. RG-21-11-30 01 Job/Inq.No. Order No.	

Rated Operating Point

Capacity 960.0 gpm Head 230.0 ft NPSHa 30.0 ft NPSHr 27.5 ft Rated Efficiency 71.0 % Suction Spec. Speed 9,717 gpm(US) ft	Power - Pump 70.6 hp Power - Loss 0.44 hp Power - Others Power - Totals 70.6 hp Power - max. 78.2 hp	No. of Stages 1 Imp. Dia. 1st Stg: 8.3750 in Imp. Dia. Adl Stg: Min. Hydraulic Flow 403.9 gpm Min. Thermal Flow N/A
--	---	--

Notes: 1. Curve shown is at ambient temperature conditions.

