

GETTING TO KNOW AND LOVE YOUR

PowerCurveMini[®] Surge Protector with 2 Rotating Outlets + 2 USB

360electrical.

360electrical.com | 

Thank you for buying a 360 Electrical PowerCurve Mini surge protector.

We truly hope it gives you peace of mind with your electronics and provides those outlets when you need them most (not to mention you'll be swarmed like a reality show "celebrity" if you pull one of these things out in an airport. Test us with this, you will not be disappointed).

This handy little guide is designed to give basic information on how to use your PowerCurve Mini as well as provide all the legal warranty-related stuff. This guide is not a replacement Yahtzee[®] score sheet nor is it a map of the San Diego Zoo.

Help Us Help You—Register Now.

Log on the ol' interweb and head to our website to register your new PowerCurve Mini. It'll initiate the rock star treatment you so richly deserve and get you advanced notice on new products from 360!

POINTY HEADED STUFF

First, a few technical things that make our engineers pretty proud:

Model #: 36053

Electrical Ratings: 15A, 120V, 60Hz, 1800W

USB Output: Combined USB output is 2.1 Amps (10 Watts) which is enough to satisfy even the thirstiest of gadgets.

Surge Energy Joule Rating: 306 Joules (a joule is a measure of how much energy a surge protector can take before it bites the dust).

Response Time (the time it takes for the surge protector to kick in): <1 Nanosecond

Maximum Spike Current: 12,000A

UL Clamping Voltage: 1200V (UL 1449, 3rd Edition)

EMI/RFI Noise Filter: 150kHz – 100MHz up to 40 Db

How Your PowerCurve Mini Protects: Inside your PowerCurve Mini is a smart little guy called a metal oxide varistor (MOV). When the voltage coming out of the wall exceeds 120 volts (standard) it acts as kind of a relief valve diverting rogue voltage from your sensitive electronics.

CONSIDER YOURSELF WARNED!

Please follow these cautionary statements. If you don't, your PowerCurve Mini might break, your warranty will be void, and you will be very unhappy with yourself.

▶ Use indoors only and do not use near water. You listening, SCUBA guy?! 

▶ Do not plug any extension cord, power strip, wall tap, or multi-outlet adapter into your PowerCurve Mini.

▶ Don't plug your PowerCurve Mini into anything but a grounded outlet (the kind with three holes in the socket).

▶ Do not plug things in that will exceed the electrical ratings (see "Pointy Headed Stuff").

▶ Don't use the PowerCurve Mini with a heater, generator, convection oven, conventional oven, microwave, sump pump, water-related device, medical device, or vehicle battery charger.

▶ Quit using your PowerCurve Mini if either indicator light is not on. (See "PowerCurve Mini Anatomy" for more information.)

▶ If you're feeling all handy and want to alter or repair your PowerCurve Mini... Don't.

POWERCURVE MINI ANATOMY

Read it. Know it. There will be a quiz.

(A) (2) 360° Rotating AC Outlets – We invented these for flexibility in dealing with giganto plugs. Just fully insert a plug and turn to fit.

(B) Dual USB Charging – Packing 2.1 Amps (that's 10 Watts for all you Apple users) this little powerhouse can charge all your electronics with ease.

(C) Advanced Surge Protection – Deep inside lies the defender of the connected devices you plug into the rotating outlets. It's there waiting to act on your behalf when evil transient voltage rears its ugly head.

(D) Blue "Protected" Light – This blue beacon of truth tells you everything's alright. If it goes out, your PowerCurve Mini has absorbed a surge and sacrificed itself to save your electronics. Shed a tear, then replace it.

(E) Green "Grounded" Light – Lets you know the outlet you're plugged into is grounded. If this light doesn't come on, no bueno, use a different outlet.

(F) Easy-Fold PLUG – Fold out when you're ready to rock or fold in when it's time to roll. Makes PowerCurve Mini a great travel companion.

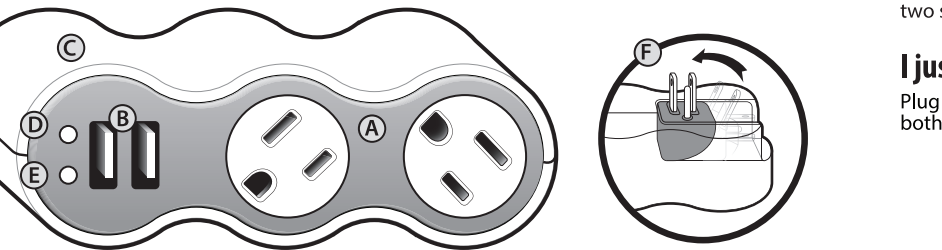

USB CHARGING PORTS

Share the love.

Did you know that almost all multi-port USB chargers share power from a single source? What does this mean? Think of it like a pipe with several faucets, the more faucets you turn on, the less water there is to flow through each faucet.

The USB ports on the PowerCurve Mini share a total of 2.1 amps/10watts of power, which is plenty of juice to charge any combination of devices. However, for those times when you need to get charged extra fast, follow the outline below.

I need a charge and I need it now!

To get the fastest charge, plug in up to two smartphones or one tablet at a time.

I just charge my stuff at night.

Plug in any combination of devices and they'll both be charged long before your alarm goes off.

QUICK SETUP

1. Plug your devices into the PowerCurve Mini.

Put standard-type plugs in the rotating outlets. Use the USB outlets for charging tablets, smartphones, and any other USB devices.

2. To fit a bulky transformer, just plug into one of the 360° rotating outlets and turn to fit another. Go ahead, show it who's boss.

3. Fold out the plug on the back of the PowerCurve Mini.

4. Now for the moment of truth... plug your PowerCurve Mini into a grounded wall outlet.

5. Now that you've figured out how to use PowerCurve Mini, it's time to graduate to utter mastery:

▶ Rest your phone right on it.

▶ Rent out unused outlets at the airport and pay for your PowerCurve Mini in one trip you crazy capitalist.

▶ Reorient or relocate the receiving antenna.

▶ Increase the separation between the equipment and receiver.

▶ Connect the equipment into an outlet on a circuit different from that to which the receiver is connected.

▶ Consult the dealer or an experienced radio/TV technician for help.

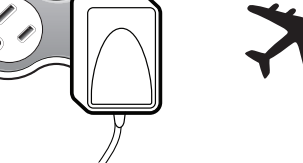
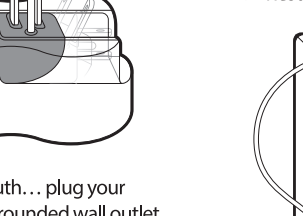
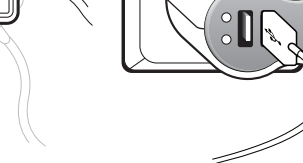
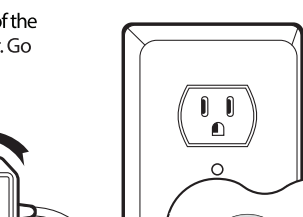

FCC STATEMENT

This device complies with part 15 of the FCC Rules. Operation is subject to the following two conditions: (1) This device may not cause harmful interference, and (2) this device must accept any interference received, including interference that may cause undesired operation.

Warning: Changes or modifications to this unit not expressly approved by the party responsible for compliance could void the user's authority to operate equipment.

Note: This equipment has been tested and found to comply with the limits for a Class B digital device, pursuant to part 15 of the FCC Rules. These limits are designed to provide reasonable protection against harmful interference in a residential installation. This equipment generates, uses and can radiate radio frequency energy and, if not installed and used in accordance with the instructions, may cause harmful interference to radio communications. However, there is no guarantee that interference will not occur in a particular installation. If this equipment does cause harmful interference to radio or television reception, which can be determined by turning the equipment off and on, the user is encouraged to try to correct the interference by one or more of the following measures:

- Reorient or relocate the receiving antenna.
- Increase the separation between the equipment and receiver.
- Connect the equipment into an outlet on a circuit different from that to which the receiver is connected.
- Consult the dealer or an experienced radio/TV technician for help.

Item - 36053 | Up to a maximum of \$50,000.00

This is a Limited Warranty and is subject to the conditions and provisions contained in the following articles. This warranty is null and void if any of the following conditions exist: (a) the equipment is not properly connected to the Surge Protector, (b) the Power Disruption damages your equipment through phone, network or coaxial lines, (c) the Surge Protector has been improperly opened or installed or has been tampered with, (d) the damage was not a result of a Power Disruption or a Power Disruption never took place, (e) or the Surge Protector was not used under normal operating conditions in accordance with the user instructions or the original purchaser does not make a claim within 15 days from the date of the Power Disruption with the purchase receipt for the Surge Protector and equipment for

CAN ICES-3 (B)/NMB-3(B)

WARRANTY

LIMITED LIFETIME WARRANTY

The Limited Lifetime Warranty of this product—360 Electrical PowerCurve Mini Surge Protector Model #36053 is subject to all of the conditions and exclusions contained in the articles below. This Limited Lifetime Warranty gives you, the original purchaser, specific legal rights along with additional rights that apply in certain states. This Limited Lifetime Warranty applies only to the enclosed 360 Electrical warranty to the verified original purchaser of this 360 Electrical Surge Protector for the life of this product that there will be no defects in craftsmanship, materials, assembly or design. Should there be any defects in any of the categories listed above 360 Electrical will, at its sole discretion, repair or replace the defective Surge Protector at no cost to the original purchaser. The Life of the Surge Protector is defined as the period of time that the Surge Protector has the capacity to protect against power surges and spikes. The "Protected" indicator light will no longer illuminate when this capacity is exceeded.

CONNECTED EQUIPMENT LIMITED WARRANTY

360 Electrical's Connected Equipment Warranty covers only equipment that is damaged or destroyed by transient voltage while properly connected to a properly wired AC power line with protective ground. Transient voltage or a "Power Disruption" is defined as a brief voltage spike and/or surge on the AC power. 360 Electrical, at its option, will pay the present fair market value for the replacement or repair of the damaged connected equipment up to the maximum amount stated below:

- 1) Mail the Surge Protector, at your expense, to the address at the bottom of the page
- 2) Provide the part number for the Surge Protector
- 3) Mail (if applicable), at your expense, the equipment that was connected to the Surge Protector
- 4) Explain in writing the extent of the damage that occurred to the connected equipment
- 5) Provide the date of the occurrence
- 6) Provide a copy of the original purchase receipt for the Surge Protector and damaged equipment
- 7) State when and where the purchases were made (if not clearly marked on the receipt)
- 8) Provide evidence of damage to connected equipment (pictures, the equipment itself, etc.)

All claims must be made within 15 days of the Power Disruption and damage to the equipment. If claims are not made within 15 days of the Power Disruption, the claim is null and void.

If 360 Electrical determines that the Connected Equipment Limited Warranty covers the damaged equipment, and that the equipment was damaged as a result of the Surge Protector which is covered under the Limited Lifetime Warranty, 360 Electrical will either 1) authorize repair of the connected equipment, at a cost up to the maximum amount set forth on the packaging of the surge protector involved; 2) provide the consumer with an equivalent equipment replacement; or 3) reimburse the consumer for the present fair market value of the damaged connected equipment. The present fair market value of the equipment will be determined according to the current value specified in the most recent edition of the Orion Blue Book by Orion Research Corporation, Roger Rohrs - Publisher.

SEND CLAIMS TO:
Attn: Claims Department | 360 Electrical, LLC
1935 East Vine Street, Suite 360
Salt Lake City, UT 84121

Or call 801-364-4900 for assistance in forwarding equipment, purchase receipts, 360 Electrical Surge Protector and how to proceed with the claim.

360electrical.

©2016, 360 Electrical, LLC

36053