

2013-2018 Focus ST Vega Modified wing extension adjustable rod install

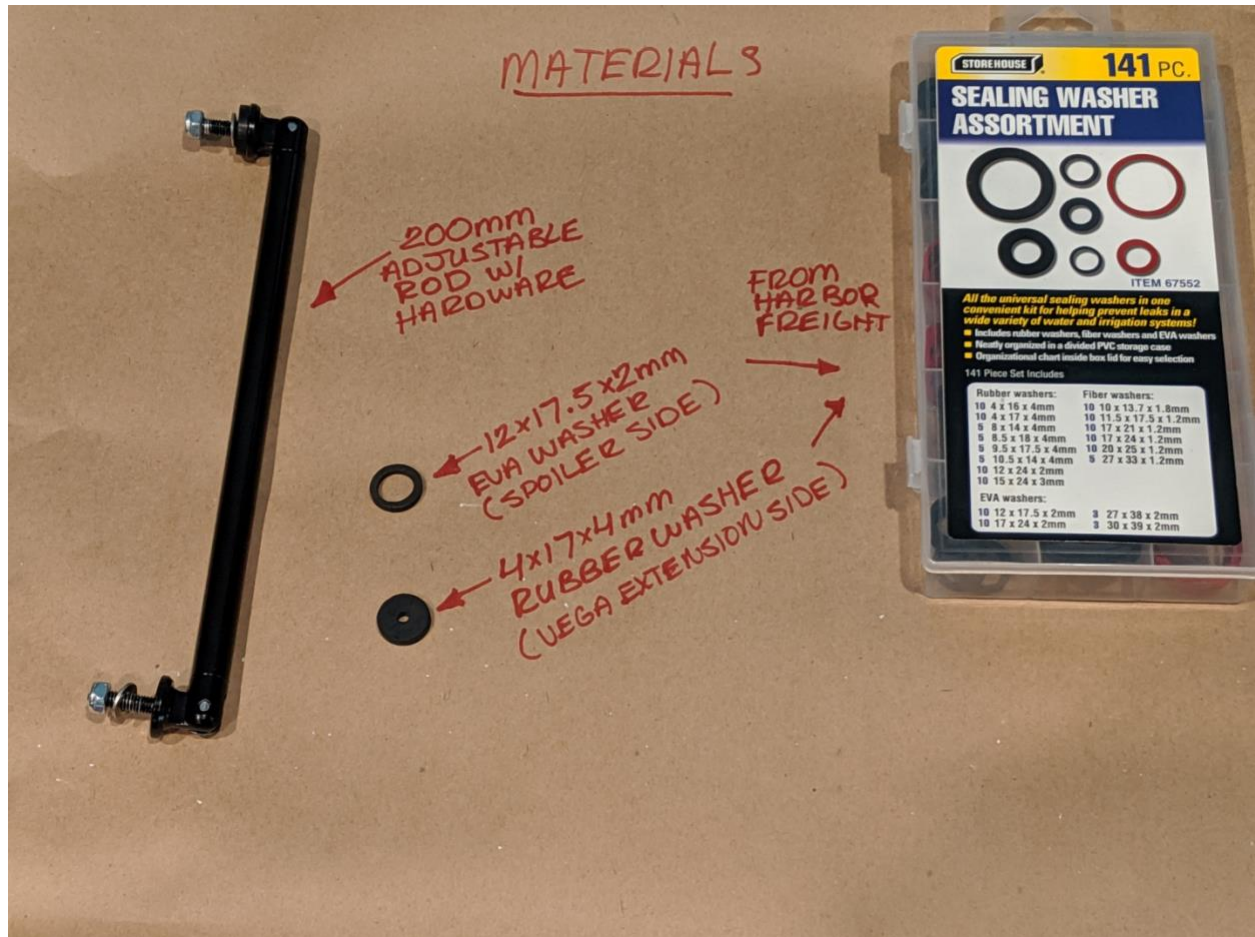

Results of this installation will yield a stiffer and more secure mount for your Vega wing extension. When purchasing support rods, keep in mind that you get what you pay for.

Parts/Materials:

- 2x 200mm adjustable support rods (splitter rods) of your choice
- 2x 4x17x4mm Rubber washers
- 2x 12x17.5x2mm EVA washers

Tools Required:

1/8" drill bit, 1/4" drill bit, and a socket and wrench that fits the hardware included with your support rod

2013-2018 Focus ST Vega Modified wing extension adjustable rod install



Step 1) Remove the inner bracket bolts on your wing extension

2013-2018 Focus ST Vega Modified wing extension adjustable rod install



Step 2) Remove the two Torx screws that are securing the third brake light, and remove the third brake light. You can just leave it hang in place.

2013-2018 Focus ST Vega Modified wing extension adjustable rod install



Step 3) Place the rubber washer on the threads of one side of the support rod. This will be the side that goes into the wing extension. Install this end of the rod through the bracket and extension, and loosely tighten it up

2013-2018 Focus ST Vega Modified wing extension adjustable rod install



Step 4) Roll the support rod to the location that you want to attach it to the spoiler. I chose to mount it on the inside of this part, but it can be mounted in any location that is accessible from behind the third brake light.

2013-2018 Focus ST Vega Modified wing extension adjustable rod install



Step 5) Drill your hole. I used the 1/8" bit for a pilot hole, to make sure I was lined up correctly. Follow that hole with the 1/4" bit. I drilled a slot in mine to have a little adjustability up and down with the support rod hardware.

2013-2018 Focus ST Vega Modified wing extension adjustable rod install



Step 6) Use your foam EVA washer to protect your paint from the support rod hardware. This is used on the side that bolt to your spoiler

2013-2018 Focus ST Vega Modified wing extension adjustable rod install



2013-2018 Focus ST Vega Modified wing extension adjustable rod install



Step 7) Use super glue, or some kind of adhesive to mount your washer to the back of your nut. This will help you to maneuver it in place. Your washer should be the same size or bigger than the surface area that you're mounting to on the outside of the spoiler.

2013-2018 Focus ST Vega Modified wing extension adjustable rod install



Step 8) Push your support rod end into your spoiler and tighten it down, snugly. Be sure to use a nylock nut or locking washer to keep it secure.

2013-2018 Focus ST Vega Modified wing extension adjustable rod install



2013-2018 Focus ST Vega Modified wing extension adjustable rod install



Step 9) Tighten up your support rod end that attaches to the extension. The rubber bushing should be smashed about halfway and will help absorb some of the shock between the extension and the wing. You can now replace your third brake light and the installation is completed.

Results:

2013-2018 Focus ST Vega Modified wing extension adjustable rod install



2013-2018 Focus ST Vega Modified wing extension adjustable rod install

