

Genie Advanced

Quick Start Guide

pumpables

Welcome to Pumpables

Congratulations on becoming the owner of a Pumpables breast pump! We are so happy to welcome you to the Pumpables family.

If you're in a hurry



If you've used a breast pump before, or you're in a hurry then feel free to go straight to the 'Getting Started' section within this manual. This contains basic information on prepping your pump and accessories for use and operating the pump.

If you're new to breast pumps or ready to learn more



We really encourage you to check out the full manual to get lots more information. We've included information on suggested pump routines, replacing parts and lots more to give you a good grounding in using your breast pump.



Check for updates



We release new features, make improvements and update manuals all the time! To make sure you have the latest version, go to **pumpables.co/manuals**

Getting help

Working out using a breast pump and breastfeeding while you care for a newborn is hard work, and you don't need to do it alone. As a Pumpables parent, you are very welcome as part of the Pumpables community. If you need help, please don't think twice about getting in touch.



Email

hello@pumpables.com

Need help or have a question?
Send us an email and we will
get right back.



Facebook Chat

fb.com/pumpables

Find us on Facebook and
send us a message. Easiest
method for busy parents!



Community

pumpables.co/community

Get support, tips and feedback
from other parents in Pump-
ables Community on Facebook.



Fitting Room

pumpables.co/fittingroom

Get a second opinion on your
shield fit & positioning from
the Pumpables team.



Issues with your pump

If you suspect a fault or something isn't right, email our customer service at **hello@pumpables.co** or fill out the claim form at **pumpables.co/warranty**. We prioritize warranty support and assist throughout the process.

What's in the box

We'll guide you through getting to know your Genie Advanced later in this manual, but for now, here's a list of everything that's included with your pump.

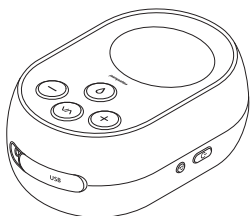

Pump unit

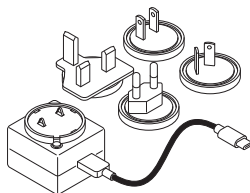

Charger +
4 international plugs

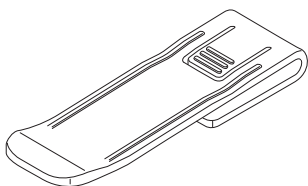

Belt Clip

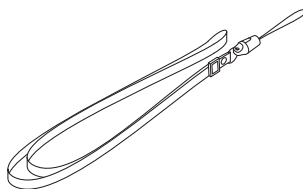

Lanyard

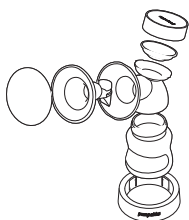

Go to the full manual to learn more about Genie Advanced and the Liquid Kit.

Get to know your Genie Advanced

You should find your Genie Advanced simple to use. Run through the functions below before you get started, and if you need help, just ask.

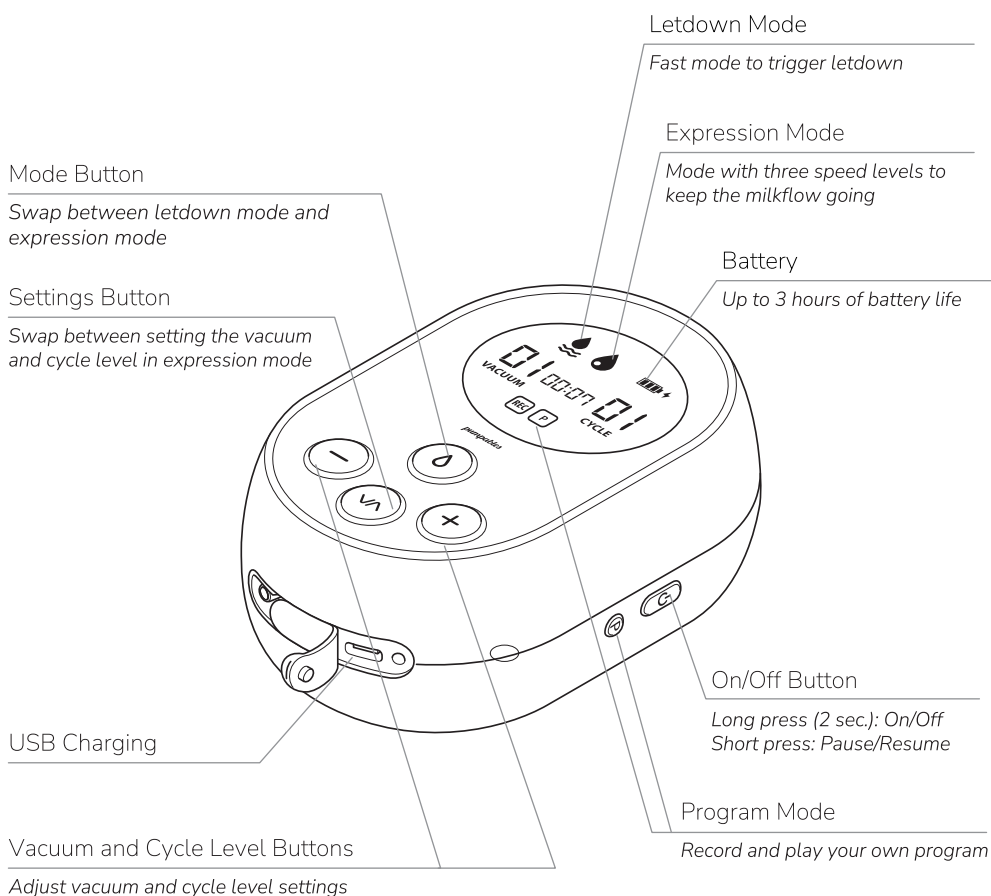

Getting started

Charging your pump

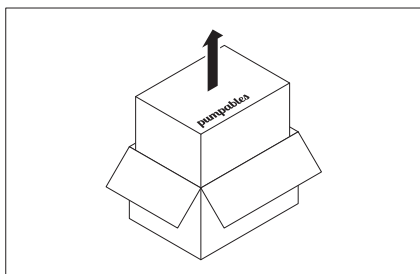

You can start using your pump right away out of the box. Once it's time to recharge, charging time is approximately 4.5 hours.

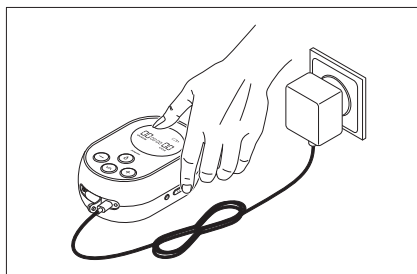

You can use the pump while charging.

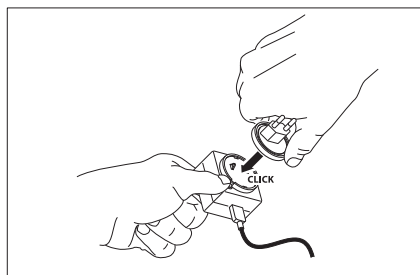

When assembling the adaptor, make sure it clicks into place.



Plug into pump.

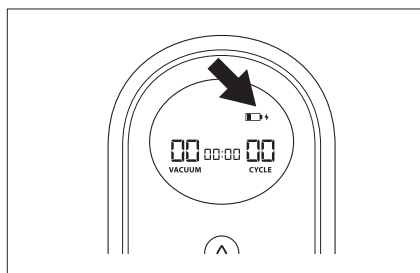

Lightening icon will blink during charging.

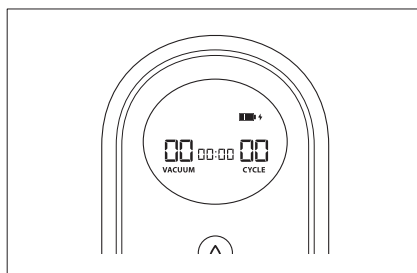

Lightening icon will stop blinking when fully charged.

Getting started

Using the belt clip

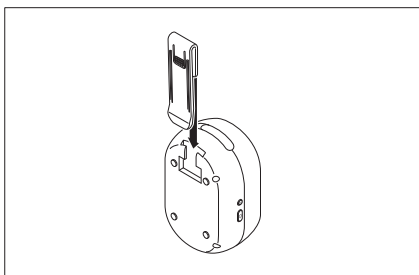

To attach the belt clip, slide it into the opening until you feel it click into place.

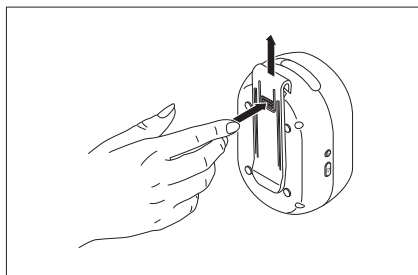

To remove the belt clip, press down and then slide the belt clip up

Attaching the lanyard

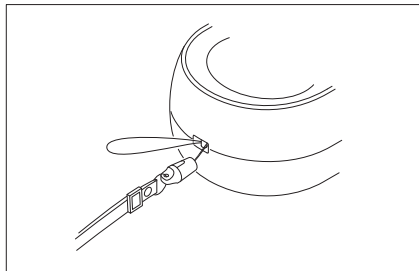

To attach the lanyard, slide the thin end through the attachment point on Genie Advanced.

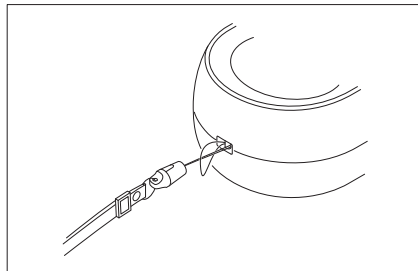

Then pull the other end of the lanyard through the loop until tightened.

Understanding the controls

Start Genie Advanced

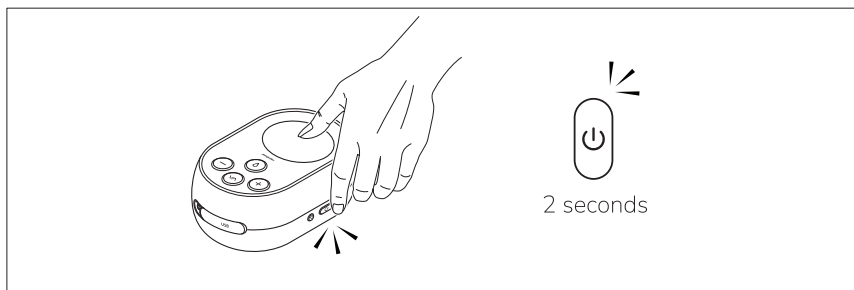

Press the power button (⏻) for 2 seconds to turn on Genie Advanced.

Switch between modes

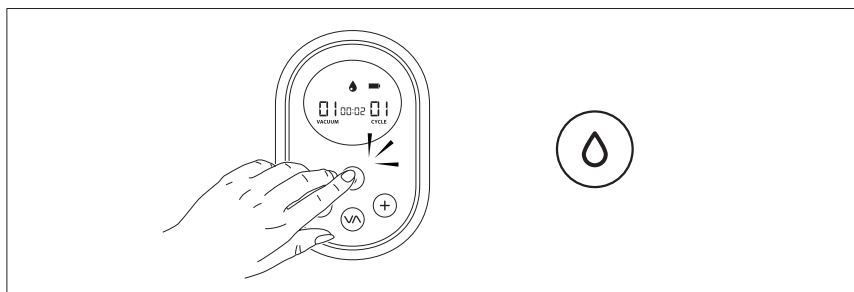

Press the mode button (💧) to swap between expression & letdown mode.

💧 Letdown mode
Vacuum level : 1-10

A light, fast pattern of suction that mimics how your baby triggers letdown, the start of milkflow

💧 Expression mode
Vacuum level : 1-10
Cycle speed : 1-3

A slower, stronger pumping mode the helps draw out milk and keep it flowing

Pause pumping during a session

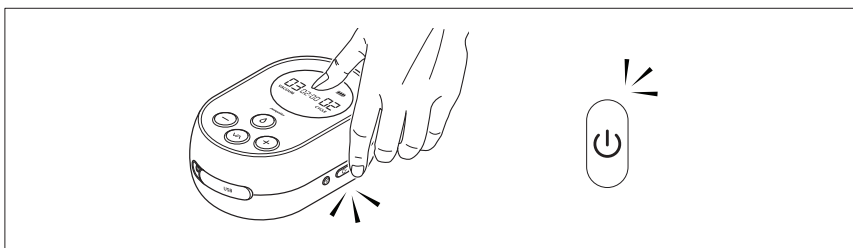

Press the power button (⏻) to pause pumping during a session. Press the power button again to resume pumping. If no buttons are pressed, the pump turns off after 1 minute. Mode icon blinks when pumping is paused.

Changing settings in letdown mode

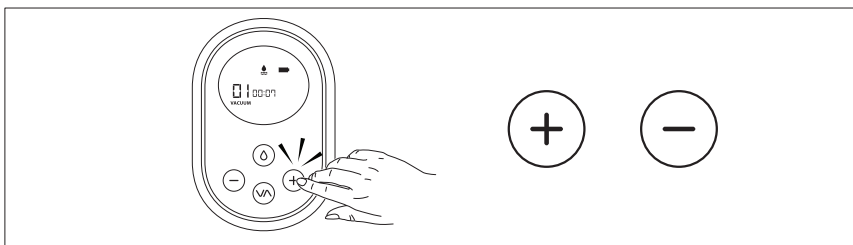

In letdown mode you can change the vacuum level only.
Increase the vacuum level with the (+) button and decrease it with the (−) button.

Changing settings in expression mode

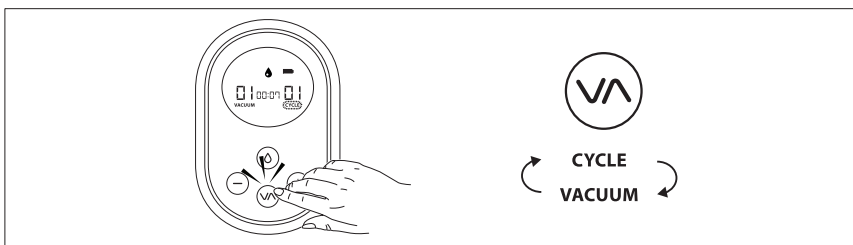

In expression mode you can adjust both vacuum level and cycle speed. There are 3 cycle speeds available on each vacuum level.

Press the settings button (Ⓥ) to toggle between vacuum level and cycle speed.
Increase the vacuum or cycle level with the (+) button and decrease it with the (−) button.

Save program to Genie Advanced

Save a favorite program to Genie Advanced's internal memory

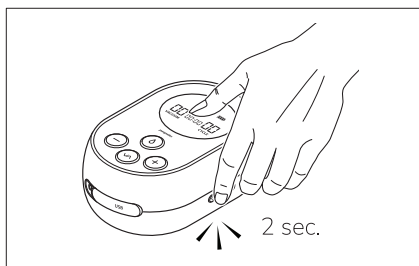

Press the program button (P) for 2 seconds to start recording.

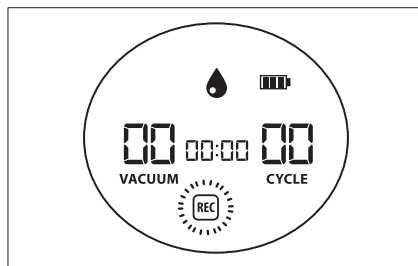

When **REC** flashes, adjust the settings as best suit you.

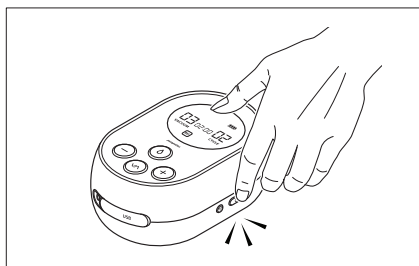

Press the power button (power icon) to pause and resume while recording.

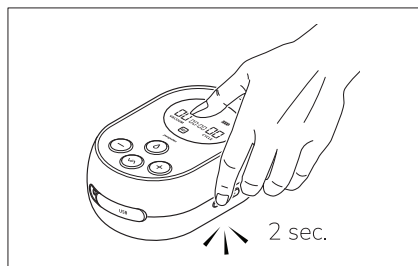

Press the program button (P) for 2 seconds to save the recording.

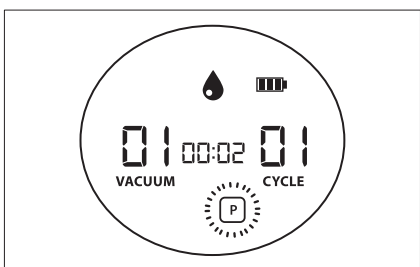

The program icon on the screen shows that your program has been stored.

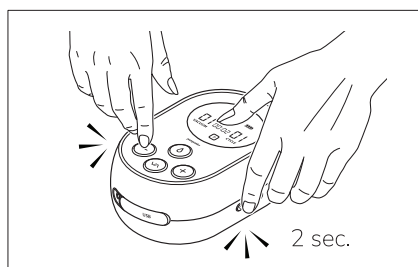

To record a new program, delete the existing program first by pressing the program button (P) and the minus button (—) for two seconds

Start your program

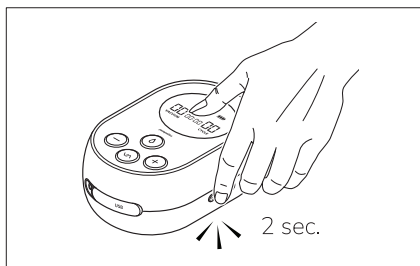

To play your pumping program, press the program button (P) for 2 seconds.

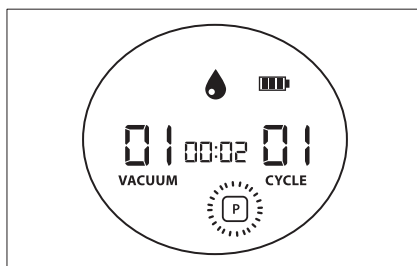

The program icon on the screen flashes while your program plays.

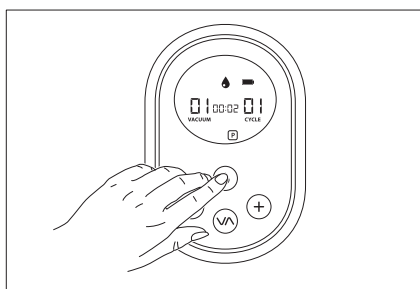

Press the mode button (O) to end the program and go back to manual mode.

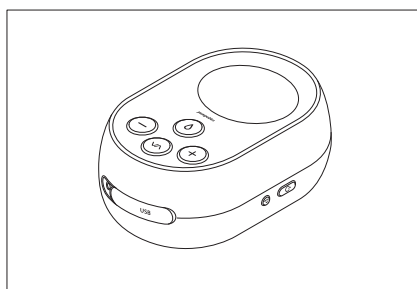

The pump stops when the program is finished, and the timer starts flashing. If no buttons are pressed, the pump turns off after 1 minute.

Delete your program before recording a new one

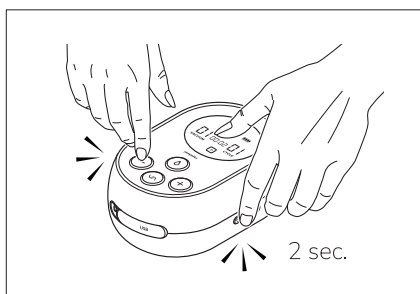

Press the program button (P) and minus button (-) for 2 seconds to delete the stored pump program.

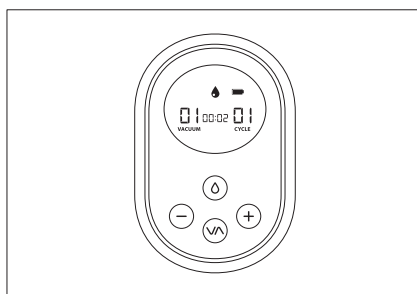

After deleting your stored program, the program icon will disappear from the screen.

Technical specifications

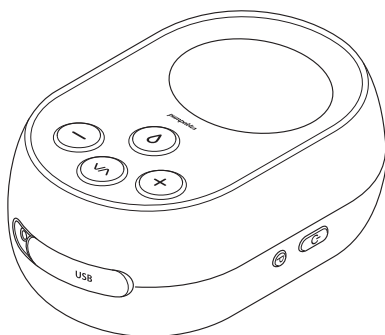

Vacuum Range	15 - 330 mmHg
Cycle Speed (Expression Mode)	24 - 70 CPM (variable)
Cycle Speed (Massage Mode)	70 CPM (constant)
Net Weight	0.33 kg (0.73 lbs)
Warranty	2 Years
Battery Life	3 Hours
Time to Charge	4.5 Hours
Motor Life	800 Hours
Country of Origin	China
Certification	CE
Color	Blue and White
Pump Type	Single or Double
Dimensions	128mm x 87mm x 58mm (5.04 in x 3.43 in x 2.28 in)
Power Supply	Rechargeable Lithium-Ion Polymer Battery or AC Adapter
Material	ABS, PP and Silicone
Voltage Input	100 ~ 240 Vac 50/60
Voltage Output	5V --- 2A
Battery Type	Lithium-Ion Polymer Battery
Li-Ion Battery Power	3.7V, 2700mAh
Total Power	10W
Noise	Less than 45dB (A)
Operating Conditions	5°C~40°C, 15%~90%Rh 800hPa to 1060hPa.
Storage andn Shipping Conditions	-25°C~60°C, 15%~93%Rh
Electric Shock Protection	Class II

pumpables

Need help? Just ask the Pumpables team!

 pumpables.co

 hello@pumpables.co

  [@pumpables](https://www.facebook.com/pumpables)