

baby exo

Extend your love

baby exo

Smart Formula Maker

INSTRUCTION MANUAL

CATALOG

Product Indication	02
Product structure	03
Installation Method	04
Install the milk powder box and three rotors	04
Install the powder box lid	04
Install the water tank	05
Install the funnel	06
Install the water tray and tray	07
Complete	07
Operating Instructions	08
Prepare before brewing milk powder	12
Cleaning and care	14
How to make the first bottle of your baby formula	15
Safe Operation Instruction	16
Attention	16
Warning	16
Storage,Transportation And Operation Regulation	17
Q & A	18
Refund Policy	20

1. Please read this manual carefully before you start to use it
2. This manual cation important information don' t lost it.

A Product Indication

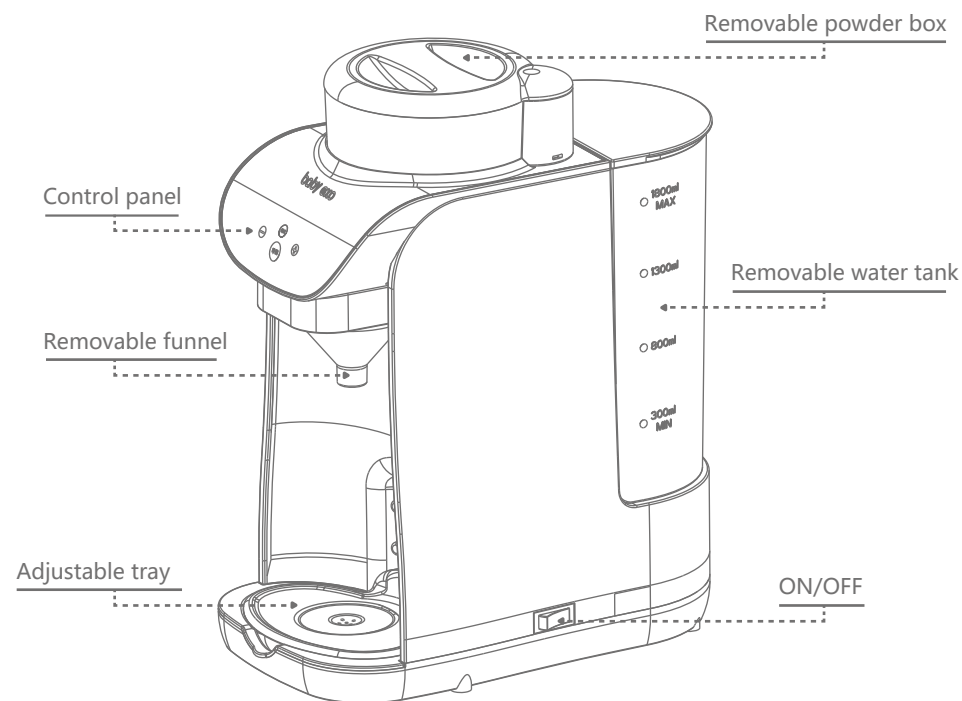

Specifications

Product	Baby EXO Formula Maker		
Powder capacity	300g	Voltage	110V
Water capacity	1800ml	Frequency	60Hz
Weight	2.75KG	Working power	550W
Size	180×300×370mm	Standby power	5W

B Product structure

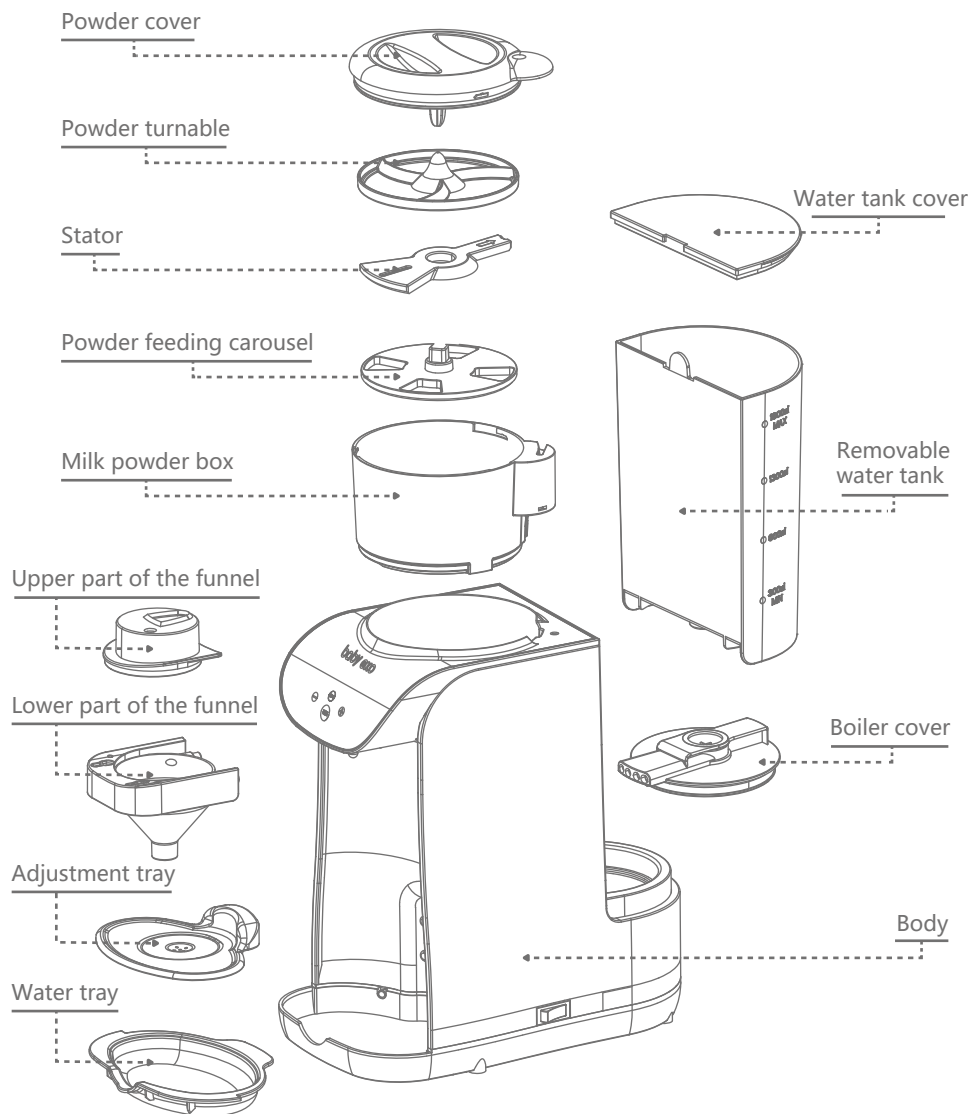

C Installation Method

1. Install the formula powder box and three rotors

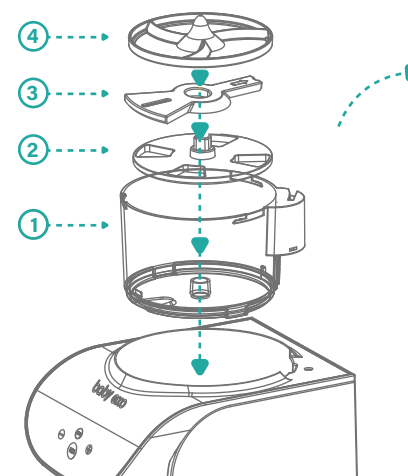

① When installing, the milk powder box must be aligned with the rails on the main unit.



② Install the powder feeding carousel

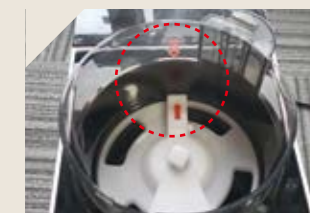

③ When installing the stator, align the red arrow of the stator with the red arrow in the box.

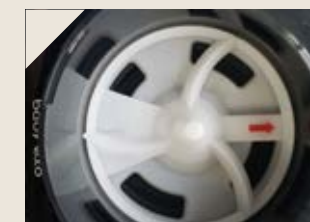

④ Installation the powder mixing turntabl.

2. Install the powder box lid

1. Pay attention to the buckle of the lid and the powder box, screw it clockwise

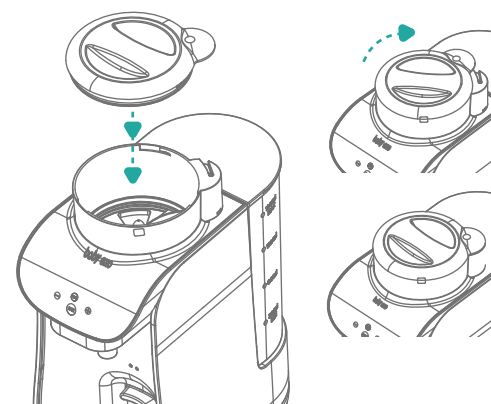

3. Install the water tank

1. Install the boiler cover

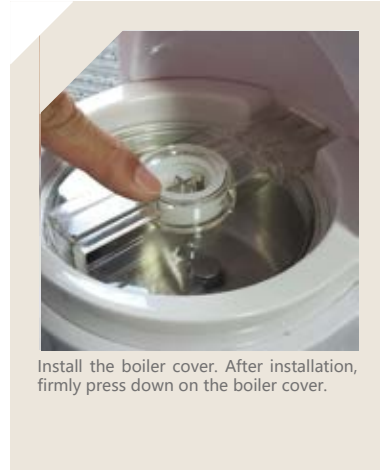
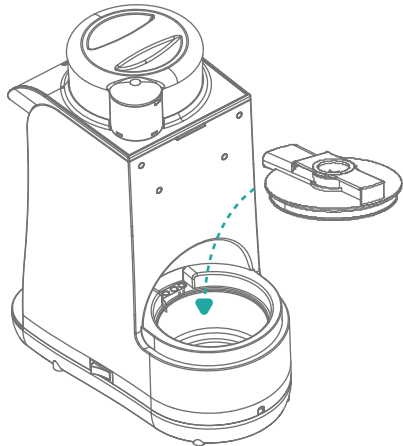

Install the boiler cover. After installation, firmly press down on the boiler cover.

2. Put on the water tank

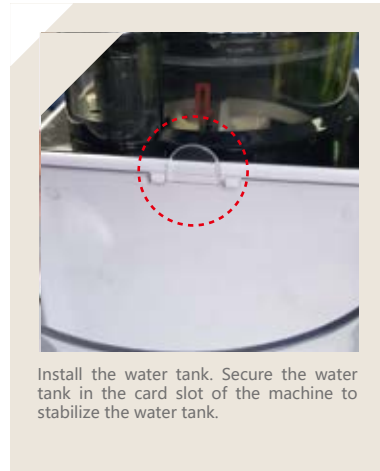
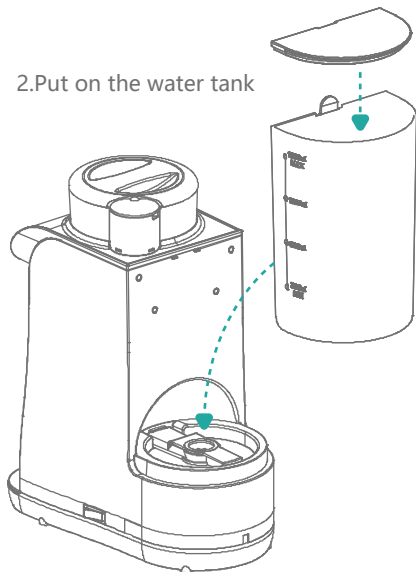

Install the water tank. Secure the water tank in the card slot of the machine to stabilize the water tank.

4. Install the funnel

1. combine the upper and lower parts first

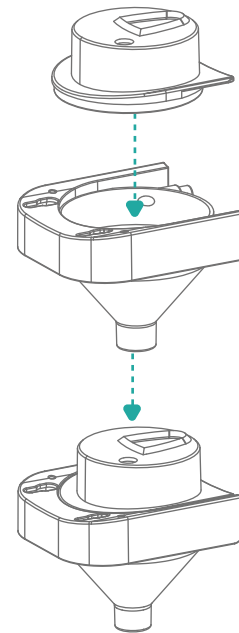

2. mixing chamber is docked with the fuselage

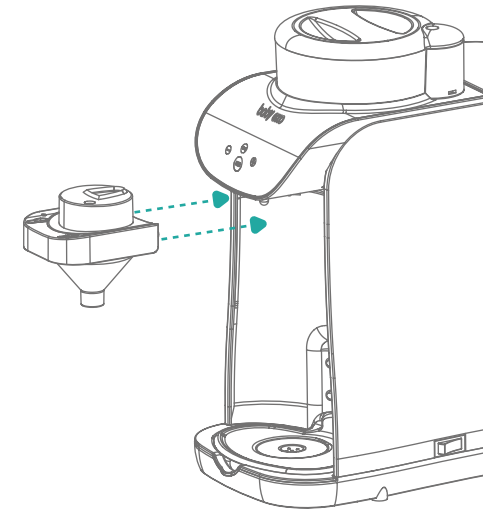

5. Install the water tray and bottle

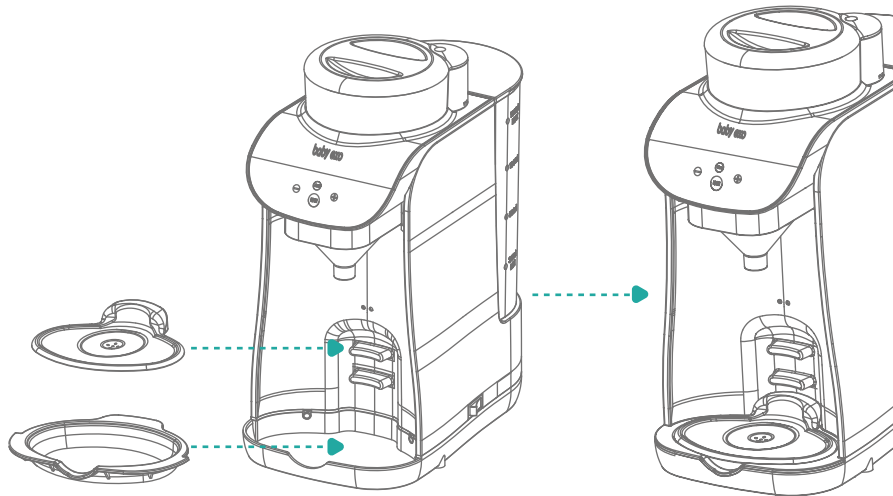

6. Complete

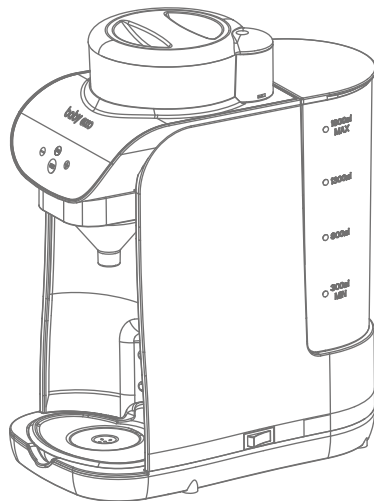





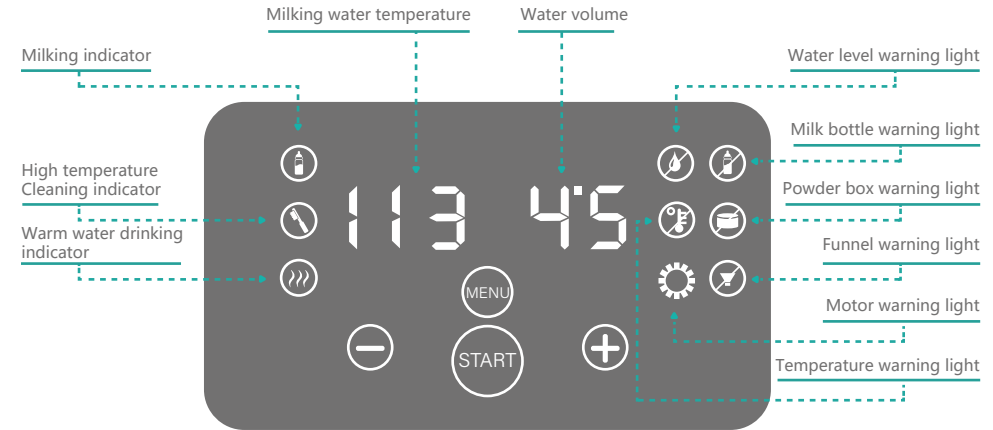

Operating Instructions

Control panel description



Warning light description

-  When the water level warning light is on, there is no water in the boiler. Please confirm whether the water tank is short of water; it will light up briefly after making milk each time.
-  When the bottle warning light is on, it means that the bottle is not placed well. Please confirm that the bottle is placed well and then make milk.
-  When the powder box warning light is on during use, it means that the powder box or the powder cover is not installed. Please check and continue to use.
-  When the funnel warning light is on during use, please check if the mixing chamber is in place.
-  When the temperature warning light is on during use, the water temperature in the boiler is higher than the set milking temperature. Please wait for the temperature to cool down.
-  When the motor warning light is on, please send it to the repair.

Operating Instructions

Brewing milk powder mode

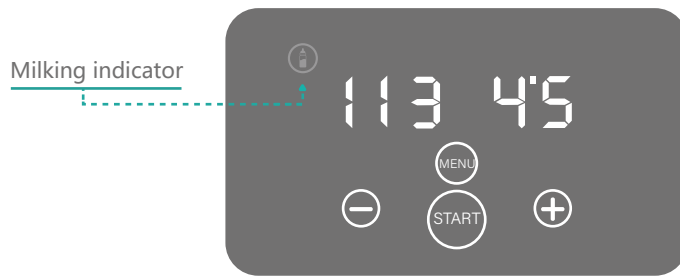

The machine defaults brewing milk mode, and the milking indicator light flashes means the water is heating. Click the \ominus / \oplus button to adjust the amount of water, and the number on the right is the current amount. When the milking indicator light is on, press START to brew milk.

NOTE

The machine is equipped with a bottle sensor to prevent the milk from being accidentally touched after the milk is flushed. If the secondary brewing is required, the bottle must be removed before re-positioning and the machine can be started

Operating Instructions

Warm water mode

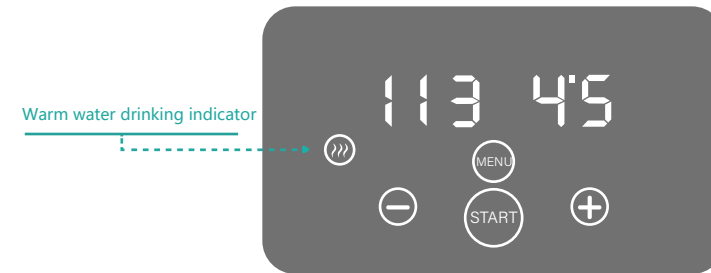

Press the MENU button to switch to the warm water drinking mode. The warm water drinking indicator lights up to indicate successful switching of the warm water drinking mode. In the warm water drinking mode, the warm water drinking indicator flashes to indicate that the water is heating. Click the \ominus / \oplus button to adjust the amount of water, and the number on the right is the current amount. When the water indicator light is on, press START to come out warm water. Click the menu button to return to the milking mode.

Temperature adjustment

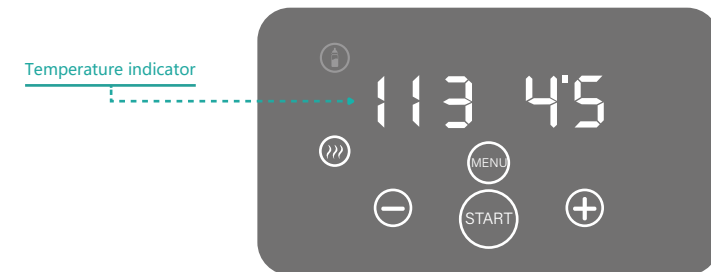

Press the menu button twice to the temperature adjustment function. When the temperature indicator flashes, it indicates that the temperature adjustment mode has been successfully entered. Click the \ominus / \oplus button to adjust the temperature and display the number as the set temperature. Click the menu button to return to the milking mode.

Operating Instructions

Formula Setting



Press the MENU button four time to the formula setting function(C2 Mode).Set the formula concentration according to your formula powder.This numerical value means the powder weight/1 oz(or 30ml)water.Click the \ominus / \oplus button to adjust the formula concentration and display the number as the set formula concentration.

Please check <How to make the first bottle of your baby formula> for more detail.

High temperature cleaning mode

High temperature cleaning

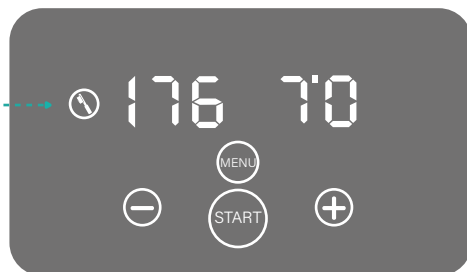

Press and hold the MENU button for three seconds to enter the high temperature cleaning mode. The high temperature cleaning indicator lights up to enter the high temperature cleaning mode. The temperature indicator appears 176°F, the water level indicator is 7.0oz, and the high temperature cleaning indicator flashes to indicate that it is heating. The temperature and water volume are fixed and cannot be adjusted. When the high temperature cleaning indicator light is on, it means the heating is completed. Click start to clean. Please do not stay in this mode for a long time.

Prepare before brewing milk powder

- 1 Please clean and dry the following parts before use.
(Warning: powder box, lunch box cover, water tank, water tank cover, adjustment tray, water tray prohibit steam sterilization of high temperature water boiler to prevent deformation. Please use 122-158°F warm water for cleaning and disinfection, dry and use.)

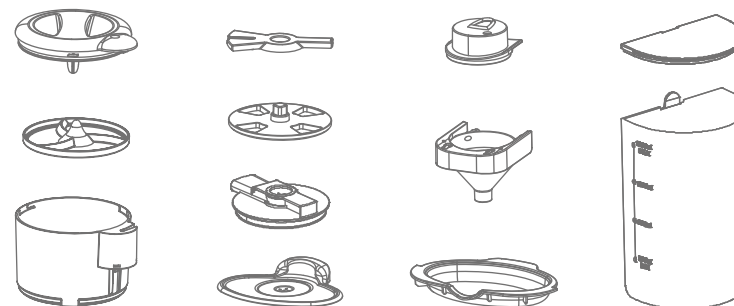

- 2 Pour milk powder into the powder box (300G recommended, no more than 400G) and close the powder cover

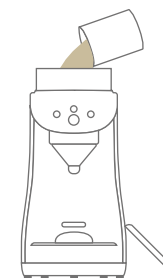

- 3 pour pure or cold water into the water tank, do not exceed the maximum value, do not pour the tap water directly for the baby's health

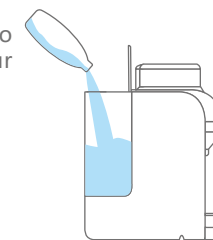

- 4 Press the menu button ,set the water ,concentration as you want and the temperature to 113°F



- 5 Turn on the switch, wait until the milk indicator light is on, indicating that the heating is complete, you can use



Attention:
place the bottle on the tray. When the milking machine senses the bottle, the body will light up in white. Then the bottle warning light of the display goes out, indicating that it is correctly placed.



Adjust the tray to the right height



White light is on

Cleaning and Care

Clean the funnel(clean every day)

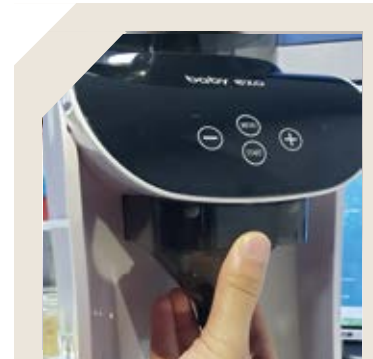

Please remove the funnel for cleaning after it is no longer used within 2 hours.

Clean the Powder box

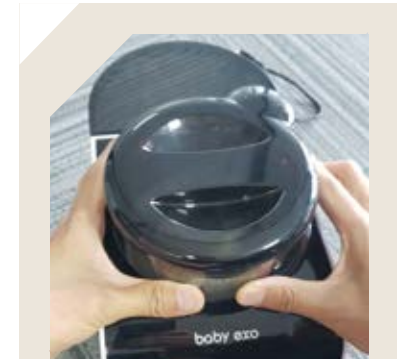

Please remove and clean the powder box every time after using all the powder in the box

Note: When removing the powder box, please press the fuselage with both hands and pull it out.

E How to make the first bottle of your baby formula

1. Add the water to the tank, add the powder into the powder box and turn on the machine.

2. Press the menu button and set the water as you want and the temperature to 113°F

Note: As it's the first use, it may take a few minutes for the water to get to setting temperature.

3. Check the formula information on the package.

For example.



This formula shows you need mix 8.7g powder with 2 fl oz water which means $8.7/2=4.35\text{g}$ powder in 1 fl oz water.

$$\frac{\text{POWDER}}{\text{WATER}} = C2$$

So you just need to set the C2 value to 4.4g or 4.3g. (don't worry about 0.05g deviation, it will not effect your baby's health).

4. After you setting the formula concentration. Just press the Start button.

F Safe Operation Instruction

Attention

1. Please read the instructions carefully before use.
2. This instruction manual contains important information and should not be discarded.
3. Please read the following warnings and safety instructions carefully.
4. After the finished milk powder, confirm the proper temperature and give it to your baby.

Warning

1. Do not use the power supply or power cord if it is damaged or the plug is loose. It may cause fire, electric shock or personal injury. If the power cord is damaged, in order to avoid danger, it must be replaced by the manufacturer's maintenance department or a similar department.
2. Use only under 110V AC power supply, otherwise it may cause electric shock, fire and performance abnormality.
3. Please insert the power supply correctly, otherwise it may cause personal injury such as fire and electric shock.
4. Prohibit excessive bending, bundling, dragging, or pressing the power cord with heavy objects, and rushing the power cord close to the high temperature and fire source. If the power cord is caught in the crack or the power cord is changed by yourself, the power cord may be damaged, resulting in electric shock or fire.
5. It is forbidden to modify, disassemble or repair it by yourself. It is forbidden to insert foreign objects such as fingers and iron sheets into the gap of the precursor. It is easy to cause fire, electric shock, personal injury, malfunction and other accidents. Please call the after-sales service hotline for A/S and inspection of the product.

6. Do not plug or unplug the power supply directly with wet hands, which may cause electric shock or personal injury.
7. Do not allow the body to get in or spray on the water to prevent foreign matter and water from entering the ON/OFF button.
8. Do not touch the switch when the hand is wet, which may cause electric shock, fire, etc.
9. For safety reasons, be sure to use it after connecting it to a grounded outlet. Otherwise, it may become an electric shock, fire, malfunction or explosion.
The cause of the accident.
10. Do not insert spoons, chopsticks, etc. at the milking mouth. Do not move the machine or disassemble or assemble parts during operation. Personal injury or machine malfunction.
11. Keep the product away from where children can touch.
12. Do not clean the machine's unremovable parts
13. Please confirm the temperature before you give it to your baby.

Storage, Transportation And Operation Regulation

1. The Preparing Machine for Baby Formula should be transported at an ambient temperature of +41°F to +86°F and maximum relevant humidity of no more than 75%.
2. Do not subject the unit to sharp temperature changes or high humidity.
3. Remove and dry the water tank if you do not plan to use the machine for a long time (over 30 days)

Q & A

Q1: The display shows «E05»

When the display shows E05, it means the water tank is short of water.

Q2: Excessive amount of milk powder

1. The lid of powder box has not closed
2. The powder box has not installed correctly

Q3: Short amount of milk powder

1. The powder box has not installed correctly
2. The powder box is short of formula powder
3. The rotor in the box is stuck.

Q4: There is no formula came out when press the Start button

1. If the milking light is flashing, that means the water does not reach the set temperature, please wait a few minutes.
2. The Warning lights turn on, please check the corresponding warning light and operate.
3. The machine is equipped with a bottle sensor to prevent the milk from being accidentally touched after the milk is flushed. If the secondary brewing is required, the bottle must be removed before re-positioning and the machine can be started.

Q5: The water output is not accurate enough

As there is a 5% error in the milk powder scale of the bottle, if you think that the water output is too much or too little, please take the electronic weighing result as the standard.

Q & A

Q6.The cleaning of funnel and powder box

We will advice you clean the funnel everyday and clean the powder box every time before you re-full it.

Q7:Why do you get more formula milk than you can see on the display ?

The numerical value on the display is the amount of water.The excess is the volume added after the milk powder is dissolved.

Refund Policy

If you have any questions about our product,Please feel free to contact us(customerservice@babyexo.com),or check www.babyexo.com.Our customer service would solve your problem in 24 hours.