

7. Recording operation: In the main menu mode, press the "-" or "+" key to select the "RECORD" icon, and press the "AV" key to confirm, press the "-" or "+" key to select

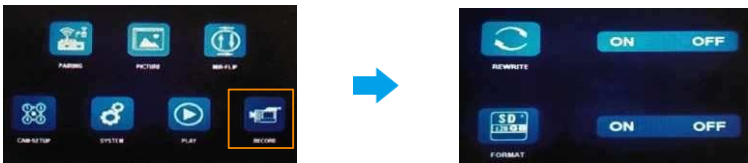

### RECORDING TIME

TF	8G	196G	32G	64G	128G
Mode					
Full view ( 640*480*1 )	14H	28H	55H	110H	220H
QUAD screen ( 320*240*4 )	11H	22H	43H	86H	172H
Split version ( 400*480*2 )	13H	25H	50H	101H	201H

### CONNECTION DIAGRAM

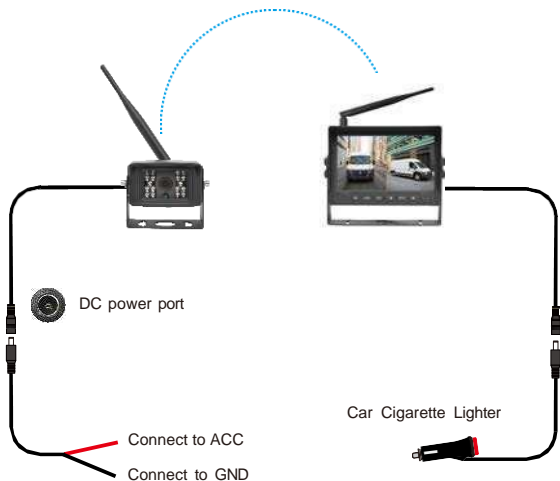

### IMPORTANT NOTES

- 1T. he rear(front) view camera functions technically as a driver assistance device, which cannot be taken as substitute for driver' s responsibility when operating the vehicle.
- 2T. o keep the camera working properly, please clean the camera regularly to free it from dirt, water drops, snowdrops,etc.
- 3A. lthough the camera is designed to be waterproof, please do NOT use high-pressure water jet to wash the camera as this may break the glass lens.
4. Keep the cables of the camera away from high temperature objects such as engine or exhaust.
- 5I. f the camera model you have comes without in-built LED lights, please turn on your license plate light for better vision at night or in dark areas.
- 6T. he camera are applicable to vehicles with DC 12V power output(10% higher or lower allowed), please do NOT use it on vehicles with DC 24V or other power output out of this range, otherwise it is very likely to get burned.
- 7T. he specifications of the camera are subject to change without prior notice.

# USER MANUAL

## 7" AHD Wireless Camera Monitor



Before operating the monitor, please read this manual thoroughly and retain it for future reference.

## PACKAGE CONTENTS LIST



7" Digital LCD Monitor  
(0.5M cable)



Instruction Manual



DC Power Cable  
(1.2M cable)



Car Cigarette Lighter  
(2M cable)



Camera (0.5M cable)



Packing Box

## PARAMETERS

7" Monitor		Camera	
Power Supply	DC 9V~ 30V	Waterproof Grade	IP69K
Resolution	VGA:640*480/D1:720*480	TV Singal	VGA
SD Card	128G Max	Resolution	720P
TV System	PAL/NTSC	TV System	PAL/NTSC
Transmission Distance	>200m	Power Supply	DC 9V~ 30V
AVinput	2way , split mode	Power Current	TYPE:170mA,Max.250mA
Delay Time	180ms	View Angle	80°

**\*\*THE SPECIFICATIONS ARE SUBJECT TO CHANGE WITHOUT PRIOR NOTICE\*\***

**Distributed by:**

**Point to Point Distributions PTY LTD**  
**9/7-8 Len Thomas Place**  
**Narre Warren VIC 3805**  
**1300 882 182**



- Power On/Off
- Mode
- Cam
- Adjusting
- Menu
- Adjusting

## INTERFACE

- The menu is only allowed to operate in single-screen mode. Press the "M" key on the display to bring up the menu as follows:

- PAIRING
- PICTURE
- MIR-FLIP
- CAM SETUP
- SYSTEM
- PLAY
- RECORD

- For pairing operation, press the "M" key, press the "-" or "+" key to select "PAIRING", and then press the "AV" key to confirm. At this time, the display shows a 50-second pairing countdown, and the camera is powered on within the countdown range. After 5 seconds, the camera and the monitor are successfully paired with the code, and the screen displays the received camera image; if the pairing is unsuccessful, the monitor will display "No Signal".

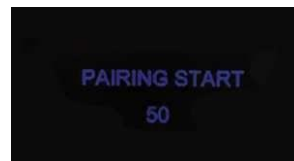
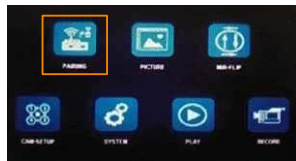

- Image adjustment operation: press "M" to enter the menu state, press the "-" or "+" key to select the "PICTURE" icon (the selected icon is yellow), press the "AV" key to confirm and enter the image adjustment state, press "-" or "+" key to select BRIGHTNESS/CONTRACT/HUE/VOLUME respectively and then press the "AV" key to confirm. When the selected picture turns red, press the "-" or "+" key to adjust the settings. After setting, press "M" to return to the main menu.

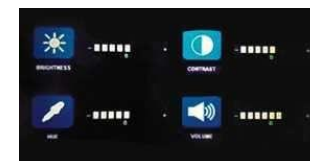

- Image mirroring/flip operation: Press the "-" or "+" key to select the "MIR-FLIP" icon, and press the "AV" key to confirm, enter the image mirroring or flip adjustment state, press "-" or "+" Button to select (the selected icon is yellow), press the "M" button to confirm and return to the previous menu;



- Camera setting operation: press "-" or "+" key to select "CAM-SETUP" icon, and press "AV" key to confirm, press "-" or "+" key to select CAM1/CAM2/CAM3/ respectively After CAM/SCANTIME, press the "AV" key to confirm. When the selected icon turns red, press the "-" or "+" key to change its setting. After setting, press the "M" key to return to the main menu.
- SYSTEM menu operation: In the main menu mode, press the "-" or "+" key to select the "SYSTEM" icon, and press the "AV" key to confirm, press the "-" or "+" key to select TIME/ After LANGUAGE/COLOR-SYS/AUTO-DIM/DELAYTIME/P-LINE, press the "AV" key to confirm. When the selected icon turns red, press the "-" or "+" key to change its setting. After setting, press "M" key returns to the main menu.



- Play operation: In the main menu mode, press the "-" or "+" key to select the "PLAY" icon, and press the "AV" key to confirm, press the "-" or "+" key to select the video file, and press the "AV" button to confirm playback.

