

## Solid Nozzles



All solid nozzles are made from a special high strength chrome/vanadium/tungsten tool steel and are supplied in pre-heat-treated 'T' condition, or fully hardened and tempered in our heat-treatment ovens.

Shock resistant and tough, our nozzles will withstand high temperatures up to 800°F (430°C) for extended periods without undue fatigue.

Do not compare these top quality nozzles with nozzles which are made from "easy to machine" common tool steels.

- OEM or Custom design style
- Highest quality- we manufacture for many OEMs
- Inside surfaces are polished to a mirror finish for minimum hang-up and flow resistance
- Made in our workshop- fastest delivery
- Made from top quality tool steel for longest possible life
- In-house heat treatment for fast turn-around
- Gas Injection and water cooled options
- Any shape and size available to your order

Solid Nozzles available from £80

### Material Specifications:

**S1:** Chrome vanadium tool steel through hardened used for through-hardened one-piece "solid" nozzles and removable tips.

**EN19T:** Standard material for removable tip nozzle bodies. Pre Heat-Treated

**EN24:** Through Hardened Steel for Tips and Nozzle bodies in more demanding applications.

**D2:** Through Hardened Tool Steel for solid one-piece nozzles in demanding applications

**Copper nickel:** Used for removable tips when a high degree of thermal conductivity is required, or if space limitations do not permit the use of a heater band.

### Internal design:

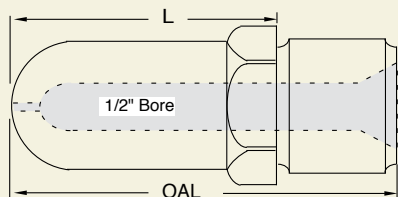

#### GENERAL PURPOSE

Standard free flow internal design, General Purpose, provides minimum flow resistance and back pressure buildup. 1/2" standard diameter flow path unless otherwise stated.

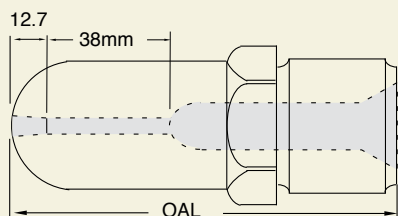

#### NYLON REVERSE TAPER

For use with polyamides, acrylics, and similar expansive and heat sensitive materials. Material flows 1 1/2" through 1/8" diameter restricted throat into 1" long reverse taper. Sprue breaks inside nozzle providing expansion area and reducing drool.

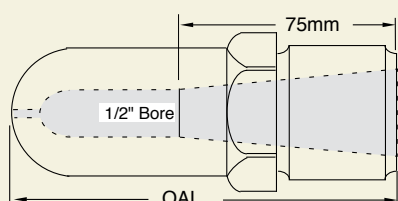

#### FULL TAPER - ABS

For use with ABS, PVC and other viscous hard-flow materials. Reduces frictional heat and areas of hangup. Recommend large orifices for minimum flow resistance. Taper 3" longitudinal distance from rear opening to 1/2" internal bore.

When ordering, please state radius and orifice. To complete part number, add Radius and Orifice Suffixes as shown below.

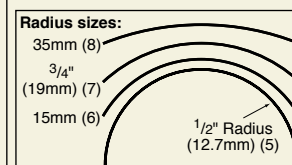

Orifice (mm)	1.5	2.5	3	4	5	6	8	9.5
Part no suffix:	I	J	K	L	M	N	O	P

note: 1.5 & 2.5mm orifice only available in GP tip