

Size: 13" x 6.5" fold in 3.25" x 1.625"

Cover - 封面

**Sensor
Brite
OUTDOOR**

THANK YOU FOR YOUR PURCHASE OF
SENSOR BRITE OUTDOOR

INSTRUCTIONS/USER MANUAL:

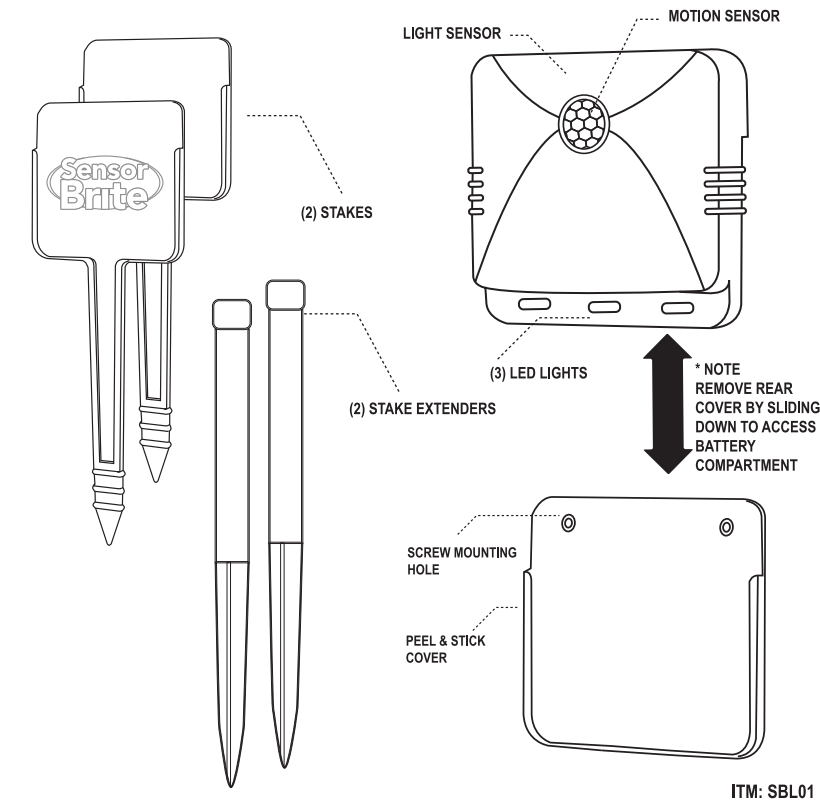

PLEASE READ THIS
MANUAL FRONT AND BACK
BEFORE USING THE
SENSOR BRITE. FOR BEST
RESULTS FOLLOW THESE
INSTRUCTIONS EXACTLY.

STOP

Placing multiple lights near one another is not recommended since the built-in light sensor allows the light to come on only in a dark environment.

The light casted from one light may cause other light to not come on.

ONCE BATTERIES ARE INSTALLED, SENSOR BRITE WILL ONLY COME ON WHEN IN DARKNESS.

32 Lumens (each unit)
Requires (3) 1.5V AAA Batteries
(per unit not included)
Water/ Weather Resistant-IP64
50,000 Hour Bulb Life
ABS Plastic Housing

DISTRIBUTED BY:
TRENDSTAR CORP.
FAIRFIELD, NJ, 07004
©2017 ALL RIGHTS RESERVED
PATENTS PENDING

TRENDSTAR
CORP.

MADE IN CHINA

Size: 13" x 6.5" fold in 3.25" x 1.625"

Content - 內頁

INSTRUCTIONS FOR USE:

1. To install batteries, slide rear cover down to reveal sealed battery compartment. (FIG 1.)
2. Remove screws to open compartment. (FIG 1.)
3. Insert 3 AAA batteries into battery compartment according to polarity markings (+/-)
4. Reattach cover. Do not over tighten the screws.
5. Slide rear cover back onto unit.

2 WAYS TO MOUNT - PEEL AND STICK OR STAKE MOUNT

6. For use with ground stakes, remove rear cover and slide unit onto ground stake by aligning grooves on the unit with the slots on the stake. Gently push stake to desired height into ground, avoid hard or solid ground when using ground stakes. FIG 2. - Use optional stake extenders if desired.
7. For use with the adhesive mounting, remove the protective layer from the peel and stick adhesive (FIG 3.). Clean the desired mounting surface with rubbing alcohol prior to application. Ensure area is free of debris and 100% dry. Press the Sensor Brite Outdoor unit firmly to area for 5-10 seconds to ensure secure application.
8. For installation with screws, remove rear cover and attach cover to desired mounting surface using the included mounting screws. When panel is securely attached, slide unit onto rear cover.

ADDITIONAL INFORMATION:

- The built-in motion sensor will detect movement from up to 15ft and will automatically turn on the 3 LED bulbs.
- To clean, wipe with a damp cloth or sponge.
- Avoid exposing light sensor to direct sunlight.
- Intended for outdoor / indoor use.
- NOTE: Painted surfaces may be damaged upon removal of peel and stick adhesive.

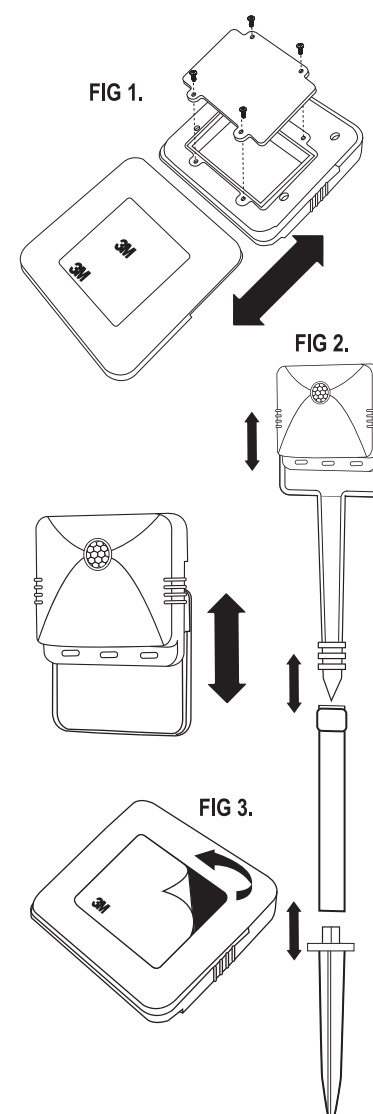

ADDITIONAL INFORMATION (cont.):

- Ground Stake Method- GENTLY PULL STAKE OUT OF GROUND AND SLIDE UNIT OFF STAKE.
- Screw Mount Method- REMOVE UNIT FROM REAR COVER. UNSCREW THE MOUNTING SCREWS FROM SURFACE.

TO CLEAN: Wipe with damp cloth or sponge. Do not submerge in water or use harsh chemicals to clean.

CAUTION: When applying adhesive tape on wall, ensure the mounting surface is not in an area that has heavy vibration or on moveable area such as a door surface. This can cause unit to lose the hold and fall off.

Note: Painted surfaces may be damaged upon removal of the peel & stick adhesive. To Remove Unit base when using the adhesive – use a fine string or dental floss and work it between adhesive and surface using a back and forth motion to saw through the adhesive bit by bit. Then use rubbing alcohol to remove any sticky mess remaining on surface.

BATTERY CARE, USE, & DISPOSAL TIPS:

- Use correct size batteries as per specifications. Insert batteries correctly, with the + and - terminals aligned properly.
- Do not mix old and new batteries
- Do not mix alkaline, standard (carbon-zinc), or rechargeable (ni-cad, ni-mh, etc.) batteries.
- Recycle batteries as per your local area guidelines.
- Never dispose Batteries in fire as they could explode.
- For more information on battery responsibility go to: www.batteryresponsibility.org
- 1.5V AAA batteries - use Alkaline batteries for best performance.

LIMITATION OF LIABILITY

Liability is limited to the purchase price of this product. Trendstar Corporation shall not be responsible for any incidental or consequential damages or any implied warranty on this product. Some states do not allow the exclusion or limitation of incidental or consequential damages, so the above limitation or exclusion may not apply to you.

For questions or comments on product please send email to admin@trendstarinc.com
- Please allow 48 hours for a response.

www.sensorbriteoutdoor.com