

6.5” x 6.5” trimline

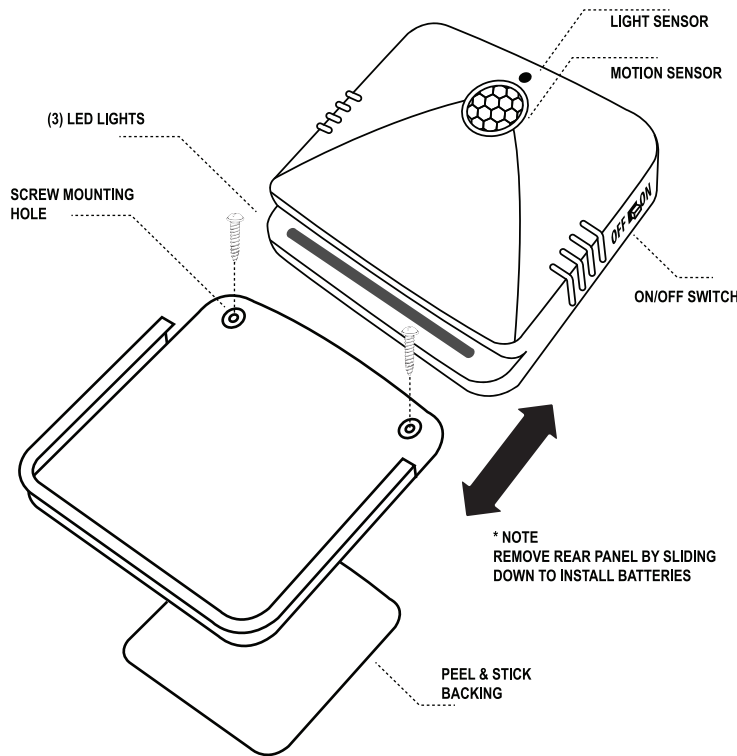

THANK YOU FOR YOUR
PURCHASE OF SENSOR BRITE!

INSTRUCTIONS/USER MANUAL:



PLEASE READ THIS
MANUAL FRONT AND BACK
BEFORE USING THE
SENSOR BRITE. FOR BEST
RESULTS FOLLOW THESE
INSTRUCTIONS EXACTLY.



Placing multiple lights near one another
is not recommended since the
built-in light sensor allows the light
to come on only in a dark environment.

The light casted from one light may
cause other light to not come on.

ONCE BATTERIES ARE
INSTALLED AND ON/OFF
SWITCH IS IN THE ON
POSITION, SENSOR
BRITE WILL ONLY COME
ON WHEN IN DARKNESS.

Made in China
32 Lumens (each unit)
Requires (3) AAA Batteries
(not included)
Peel & Stick Backing

TRENDSTAR
CORP.

DISTRIBUTED BY:
TRENDSTAR CORP.
FAIRFIELD, NJ, 07004
©2017 ALL RIGHTS RESERVED

INSTRUCTIONS FOR USE:

1. To install batteries, slide rear cover down to access battery compartment. (FIG A.)
2. Insert 3 (AAA) batteries into the battery compartment according to the polarity markings (+/-). (FIG B.)
3. Reattach rear cover by sliding back onto the rear of unit.
4. For best results, clean the desired mounting surface of area you will be attaching Sensor Brite to with rubbing alcohol.
5. Ensure mounting area is 100% dry and debris-free before mounting the Sensor Brite. Install onto smooth flat surface.
6. Remove the protective layer from the peel & stick tape. (FIG C.)
7. Press the Sensor Brite firmly onto desired mounting surface and hold for 5-10 seconds. (FIG D.)
8. For installation with screws, remove rear panel and attach panel to mounting surface using included mounting screws. When rear panel is securely attached to desired position, slide unit onto rear panel.
9. Turn unit On by adjusting switch into On position and leave in On position. Sensor Brite will begin to function automatically.

ADDITIONAL INFORMATION:

- The built in motion sensor will detect movement from up to 10ft and will automatically turn on the 3 bright LED bulbs.
 - Each light sensor has a built in light sensor and lights will only come on when unit is in On position and room is dark.
 - When not in use, turn unit into Off position.
 - To clean wipe with a damp cloth or sponge.
 - Never point light sensor directly towards the sun.
 - Intended for indoor use only.
- Do not place near wet areas.

FIG A.

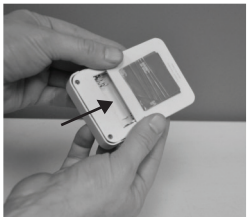

FIG B.

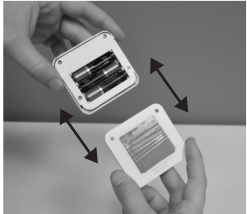

FIG C.



FIG D.



ADDITIONAL INFORMATION (cont.):

TO CLEAN: Wipe with damp cloth or sponge. Do not submerge in water or use harsh chemicals to clean.

CAUTION: When applying adhesive tape on wall, ensure the mounting surface is not in an area that has heavy vibration or on moveable area such as a door surface. This can cause unit to lose the hold and fall off.

Note: Painted surfaces may be damaged upon removal of the peel & stick adhesive. To Remove Unit base when using the adhesive – use a fine string or dental floss and work it between adhesive and surface using a back and forth motion to saw through the adhesive bit by bit. Then use rubbing alcohol to remove any sticky mess remaining on surface.

BATTERY CARE, USE, & DISPOSAL TIPS:

- Use correct size batteries as per specifications. Insert batteries correctly, with the + and - terminals aligned properly.
- Do not mix old with new batteries for optimum performance.
- Do not mix different types of batteries (for example Alkaline with Zinc Chloride, or rechargeable in same device).
- Recycle batteries as per your local area guidelines.
- Never dispose Batteries in fire as they could explode.
- For more information on battery responsibility go to:
www.batteryresponsibility.org

LIMITATION OF LIABILITY

Liability is limited to the purchase price of this product. Trendstar Corporation shall not be responsible for any incidental or consequential damages or any implied warranty on this product. Some states do not allow the exclusion or limitation of incidental or consequential damages, so the above limitation or exclusion may not apply to you. For questions or comments on product please send email to admin@trendstarinc.com - Please allow 48 hours for a response.

www.sensorbrite.com

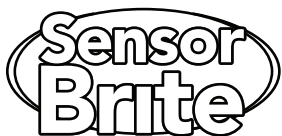

SENSORBRITE_IM_TS_010919