



OPERATION MANUAL

DUAL HANDHELD UHF DSP WIRELESS MICROPHONE SYSTEM

MHU-402



UHF

blastking.com



Thank you for your purchase of our BLASTKING wireless microphone system. We know you have a world full of choices and we thank you for selecting us.

Please read this entire user guide before operating this unit.

CAUTIONS

- All operating instructions should be read before using this equipment.
- To reduce risk of electrical shock, do not open the unit. There are NO USER OR SERVICEABLE PARTS INSIDE. Please refer servicing to a qualified service technician.
- Do not expose this unit to direct sunlight or a heat source such as a radiator or stove.
- Dust, dirt and debris can interfere with the performance of this unit. Make an effort to keep this unit away from dusty, dirty environments, and cover the unit when it is not in use. Dust it regularly with a soft clean brush.
- DO NOT EXPOSE THIS UNIT TO RAIN OR MOISTURE.
- DO NOT USE ANY SPRAY CLEANER OR LUBRICANT ON ANY CONTROLS OR SWITCHES.

Handheld Microphone:

- Do not drop the microphone onto hard surfaces.
- Do not strike the microphone head front with fist or fingers, and do not blow strongly into the microphone head front.
- Do not use the microphone in areas of high humidity and/or high temperatures as this could lead to damage of the microphone.

FCC RULES AND REGULATIONS

IMPORTANT REGULATORY INFORMATION

This device complies with Part 15 of FCC rules. Operation is subject to the following two conditions:

- (1) This device may not cause harmful interference and
- (2) This device must accept any interference that is received, including any interference that may cause undesired operation.

WARNING: Changes or modifications to this unit not expressly approved by the party responsible for compliance could void the user's authority to operate the equipment.

Parts of the design of this product may be protected by worldwide patents.

Information in this manual is subject to change without notice and does not represent a commitment on the part of the vendor. BLASTKING shall not be liable for any loss or damage whatsoever arising from the use or information or any error contained in this manual.

No part of this manual may be reproduced, stored in a retrieval system or transmitted, in any form or by any means, electronic, electrical, mechanical, optical, chemical, including photocopying and recording, for any purpose without the express written permission of BLASTKING.

It is recommended that all maintenance and service on the product should be carried out by a licensed professional. BLASTKING cannot accept any liability whatsoever for any loss or damage caused by service, maintenance or repair by unauthorized personnel.

Main Features

Receiver with LCD display
Digital Signal Processor
High-fidelity cartridge module
Infrared carrier-frequency synchronization
Unique ID address
Super anti-jamming circuit design
Super-low background noise
Frequency auto search

Specifications

Modulation Method: $\pi/4$ -DQPSK
Frequency Range: 610-786MHz, 2X100/4X50 CH's
Sampling Ratio: 48KHz
Transmission Rate: 204.8Kbps
Dynamic Range: >90dB
Total Harmonic Distortion: < 0.1 %
Delay Time of Audio Transmission: <3ms
S/N Ratio: >96 dB
Frequency Response: 30 ~ 20 KHz
RX Sensitivity: < -94dBm
Unique ID Address: Yes

Some tips to improve the performance of the system

- The transmitter and antenna should be kept in the relative position of accessibility of a straight line.
- Don't put the receiver close to metal surfaces or near any digital device (such as a CD player, computer etc.)
- Try to place the receiver at a height of 5 feet from the ground and at a distance of 3 feet away from the wall.

Handheld Transmitter

Main Functions

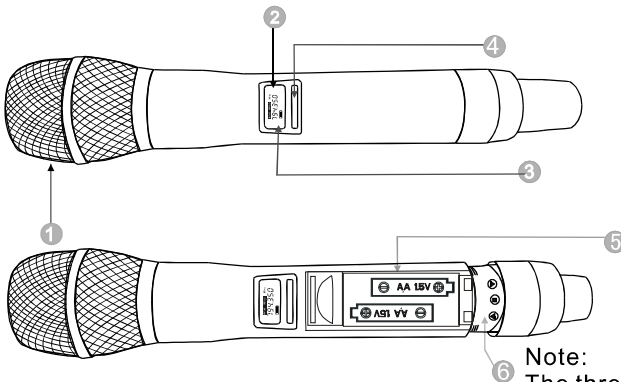

Note:
The three key not function

1. INTERCHANGEABLE MICROPHONE HEAD
2. LCD DIGITAL DISPLAY: Displays frequency, and battery status.
3. IR PORT: Infrared port for the Wireless Infrared Auto Sync Technology. Point the microphone's infrared port at the receiver's infrared port to allow communication.
4. POWER BUTTON
5. BATTERY COMPARTMENT: Insert 2x1.5V AA battery or 2x1.2V rechargeable AA battery.

Replace the battery

1. Turn off the tail screw
2. Take off the battery house cover
3. Make sure that you insert the battery at the right electric poles, as show in picture.
4. Close the battery cover. Turn on the tail screw.

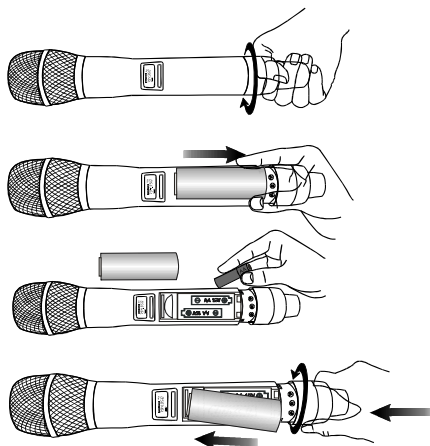

Receiver

Controls and Functions

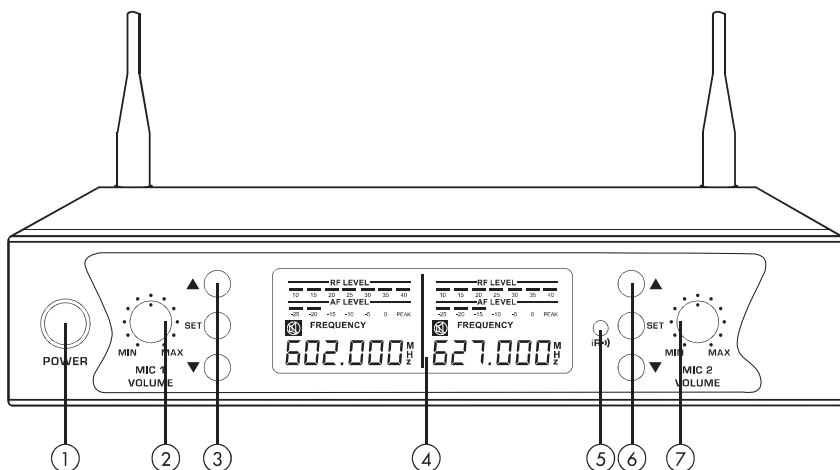

Front Panel:

1. POWER BUTTON: Turns the system on/off.
2. MIC 1 VOLUME CONTROL: Controls Microphone 1 volume
3. MIC 1 SELECTOR BUTTONS (UP/SET/DOWN): Allows control of LCD screen and functions for Microphone 1
4. LCD SCREEN: Displays system status.
5. IR PORT: Infrared port for the Wireless Infrared Auto Sync System. Pointing the handheld microphone's infrared port at the receiver's infrared port to allow communication.
6. MIC 2 SELECTOR BUTTONS (UP/SET/DOWN): Allows control of LCD screen and functions for Microphone 2.
7. MIC 2 VOLUME CONTROL: Controls Microphone 2 volume.

LCD Panel:

After turning on the "POWER", LCD screen will display the following:

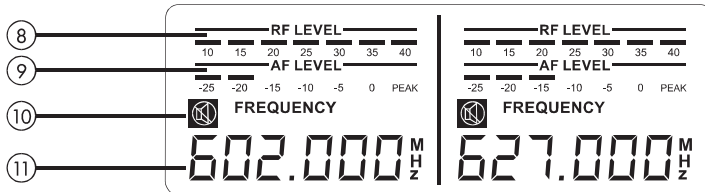

- 8. RADIO FREQUENCY LEVEL: Strength indicator of radio signal.
- 9. AUDIO FREQUENCY LEVEL: Strength indicator of incoming audio signal.
- 10. MUTE: Indicates if microphone is powered off.
- 11. FREQUENCY & CHANNEL: Displays current frequency and channel.

Rear Panel:

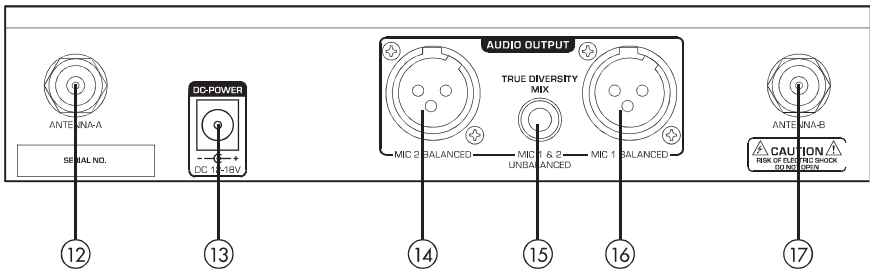

- 12. ANTENNA-A: Connect the antenna to the BNC socket.
- 13. POWER SUPPLY: For power adapter with DC12-18V 500mA.
- 14. MIC 2 BALANCED OUTPUT: Balanced XLR audio output.
- 15. MIXED OUTPUT: Unbalanced 1/4" audio output for MIC 1 & MIC 2
- 16. MIC 1 BALANCED OUTPUT: Balanced XLR audio output.
- 17. ANTENNA-B: Connect the antenna to the BNC socket.

Operation

How to select frequencies/channels for the receiver

The module comes with two handheld microphones and each microphone is preset with 50 frequency channels. The frequency can be selected either automatically or manually.

1. AUTOMATIC FREQUENCY/CHANNEL SELECT

Press and hold "DOWN ▼" until "SCAN" displays. Then the best frequency will be selected.

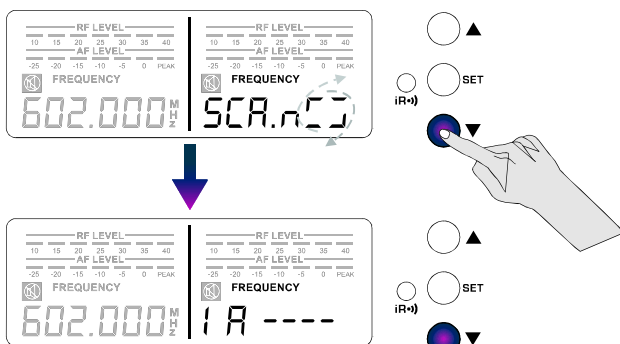

2. MANUAL FREQUENCY/CHANNEL SELECT

STEP 1: Press and hold "UP ▲" on the receiver until the channel blinks.



STEP 2: While the channel is blinking, press "UP ▲" or "DOWN ▼" to select the desired channel. Then press "SET" to confirm the channel.

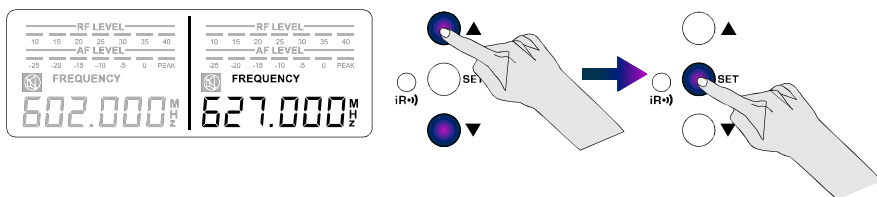

3. HOW TO MATCH RECEIVER'S FREQUENCY WITH MICROPHONE

STEP 1: Turn ON the microphone, point the microphone infrared port (IR) directly at the receiver's IR PORT.

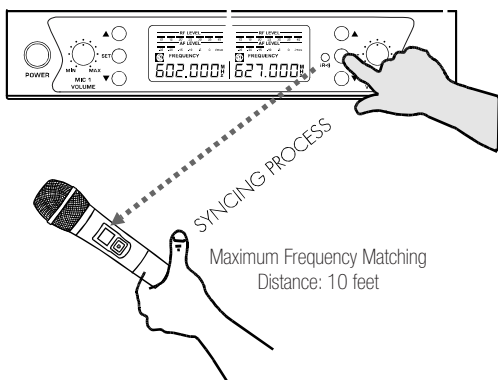

NOTE: Please make sure that the other handheld microphone is powered off when adjusting the frequency on one microphone.

Each unit is fully tested and qualified by BLASTKING. However, due to the nature of wireless connection, interference may occur because of local environments and/or radio signals emitted by other wireless devices within the household.

STEP 2: Press and hold "SET" until "1A ----" displays. Once syncing is completed the RF level bar appears and the "MUTE" icon disappears

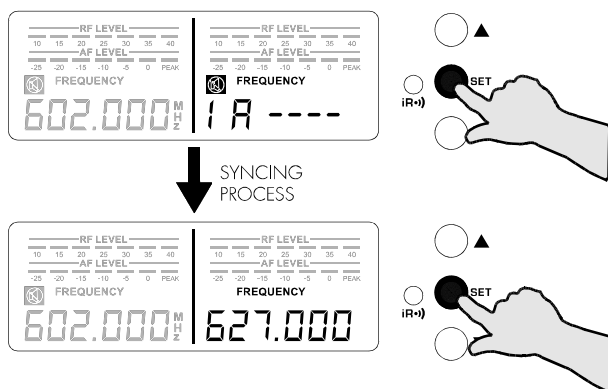

4. HOW TO LOCK/UNLOCK THE DISPLAY

Press and hold "UP ▲" and "DOWN ▼" at the same time to lock/unlock the setting.

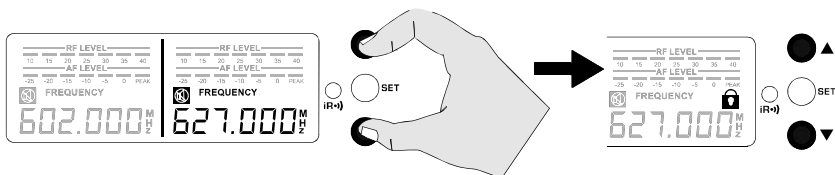

Troubles	Status	Solutions
No sound or weak voice.	The transmitter LCD display off.	Turn on the transmitter power. Confirm that the +/- marks on the battery match with the head joint of the transmitter. Insert a new battery.
	Receiver LCD display off.	Confirm whether a head of the AC power adapter is plugged into the power outlet and whether the other end is inserted into the DC power supply socket on the rear panel of the receiver. Check whether the AC power outlet is normal and confirm whether the power supply voltage is normal.
	The display screen of the receiver shows that there is RF signal.	Increase the receiver's volume control. Check the cable connection between the receiver and the amplifier or mixer.
	The display screen of the receiver shows that there is no RF signal. The transmitter and receiver power indicators light.	Elongate vertically the receiver antenna. Move the receiver away from metal objects. Check if there are obstacles between the transmitter and the receiver. Move the transmitter closer to the receiver. Check whether the receiver and transmitter are using the same frequency.
Distortion or excess of burst noise.	The display screen of the receiver shows that there is RF signal.	Remove the interference source nearby. (Such as CD player, Computers, Digital device, Earplugs monitoring system, etc). Change the receiver and transmitter to different frequency. Replace the transmitter battery. If you are using multiple systems, you can increase the frequency interval between various systems.
The transmitter can't be opened.	After pressing the transmitter switch, and it doesn't work or it opens once and closes automatically.	Replace the transmitter battery.