



## LALI Dining Chair



### Assembly Instructions

Part 1.

After Opening the box, lay out and separate all the pieces.

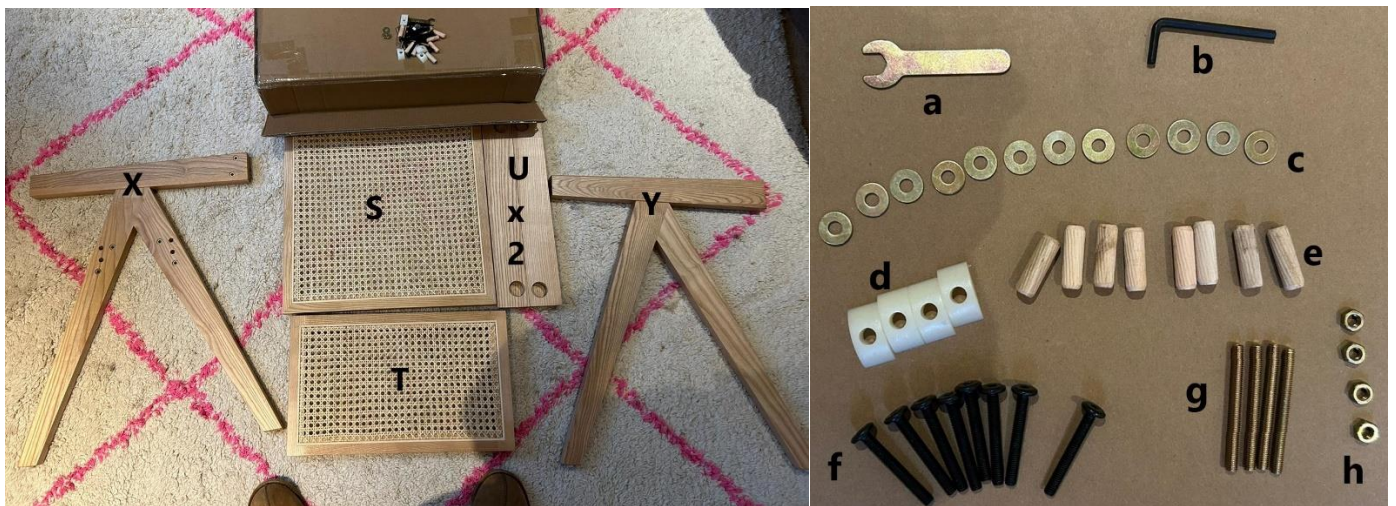

\*There are 12 washers where only 8 are required for the proper assembly of the Lali Dining Chair

2. Set-up side (X) as per the Image below by screwing part g into the bottom holes and inserting e into the wider holes.

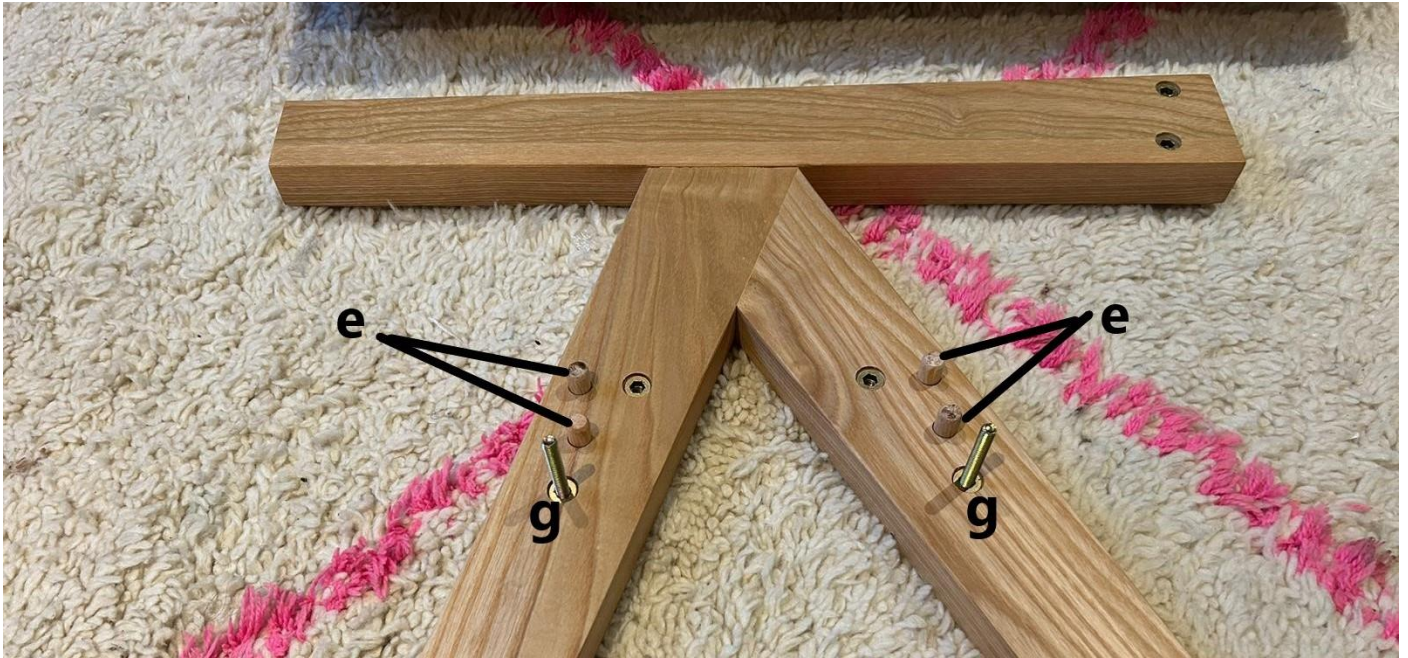

3. Attach Seat (S) and supports (U x 2) to Side (X) using tools (a) and (b).

\*Tightening screws (f) can be fiddly using tool (b) so we would advise tightening the screw as far as you can with fingers before using the tool.

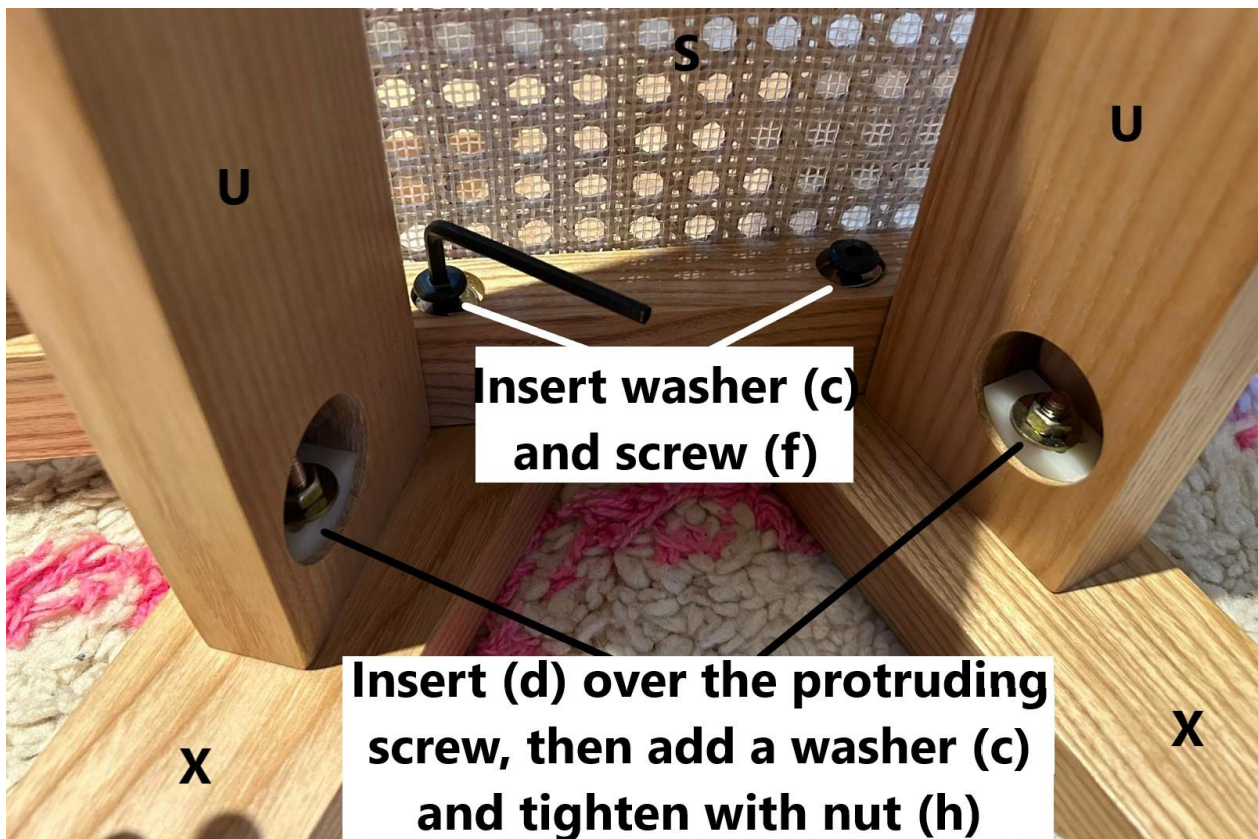

\*Tighten nut (h) using tool (a) – again tightening as far as possible using fingers before employing the tool

Once done – it should look like this:



4. Attach the top backrest to side (X)

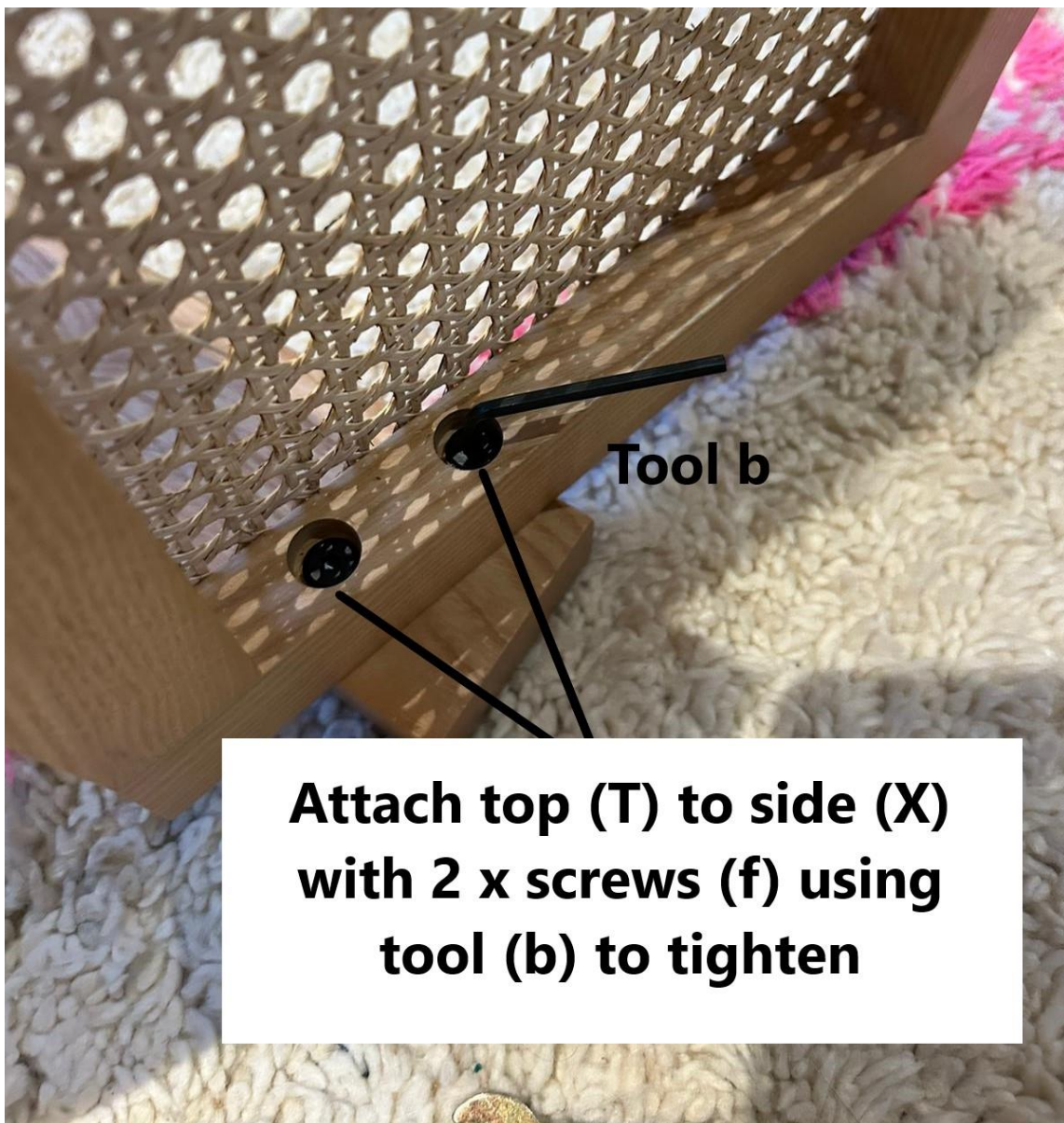

6. Now you have one side of the chair connected, set-up for the attachment of the other side (Y) as below - screwing parts (g) into the lower holes of side (Y) and inserting the wooden pegs (e) to the seat side.

Next, insert the protruding screws (g) into their holes in parts (U) to guide size (Y) into place. You may have to make slight adjustments to line up the holes with the wooden pegs. Once lined up you will be able to give (Y) a tap and it will hold in place so you can flip the chair and have side Y on the bottom.



7. Finish attaching side (Y) by repeating instruction no. 3

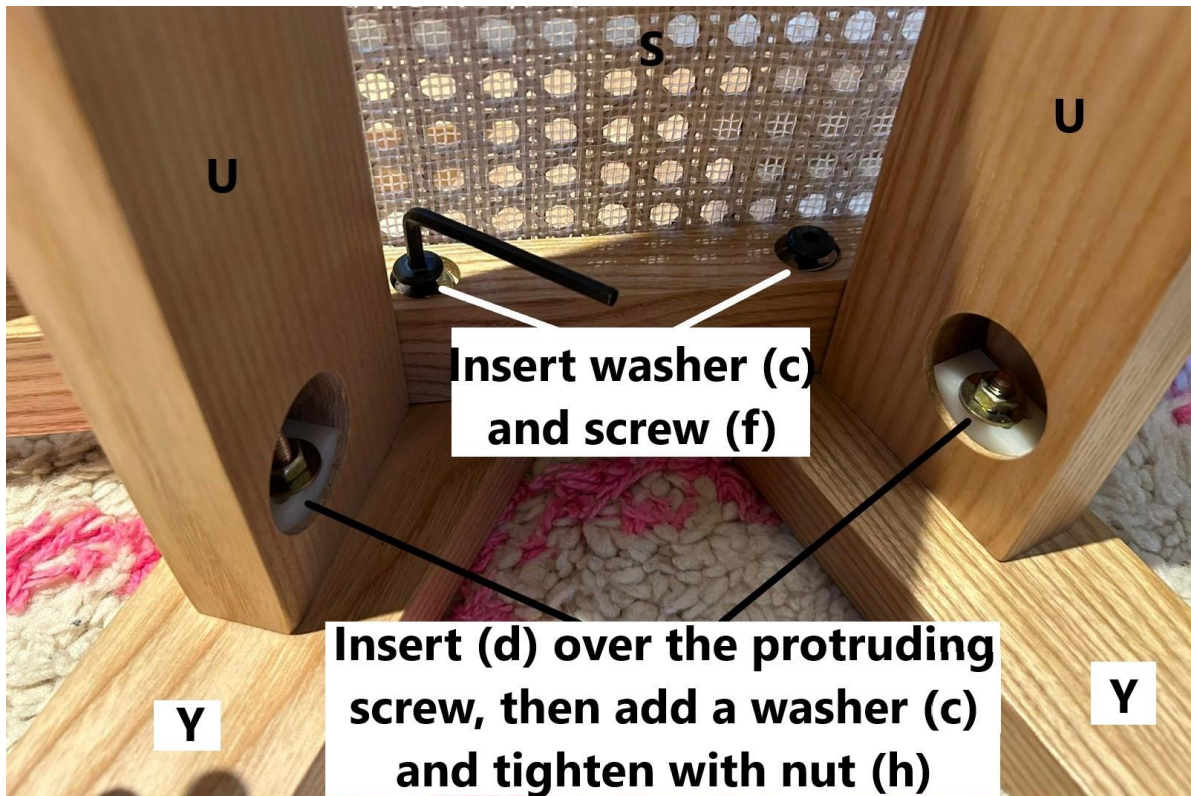

8. Attach side (Y) to top backrest (T) by repeating instruction no. 4

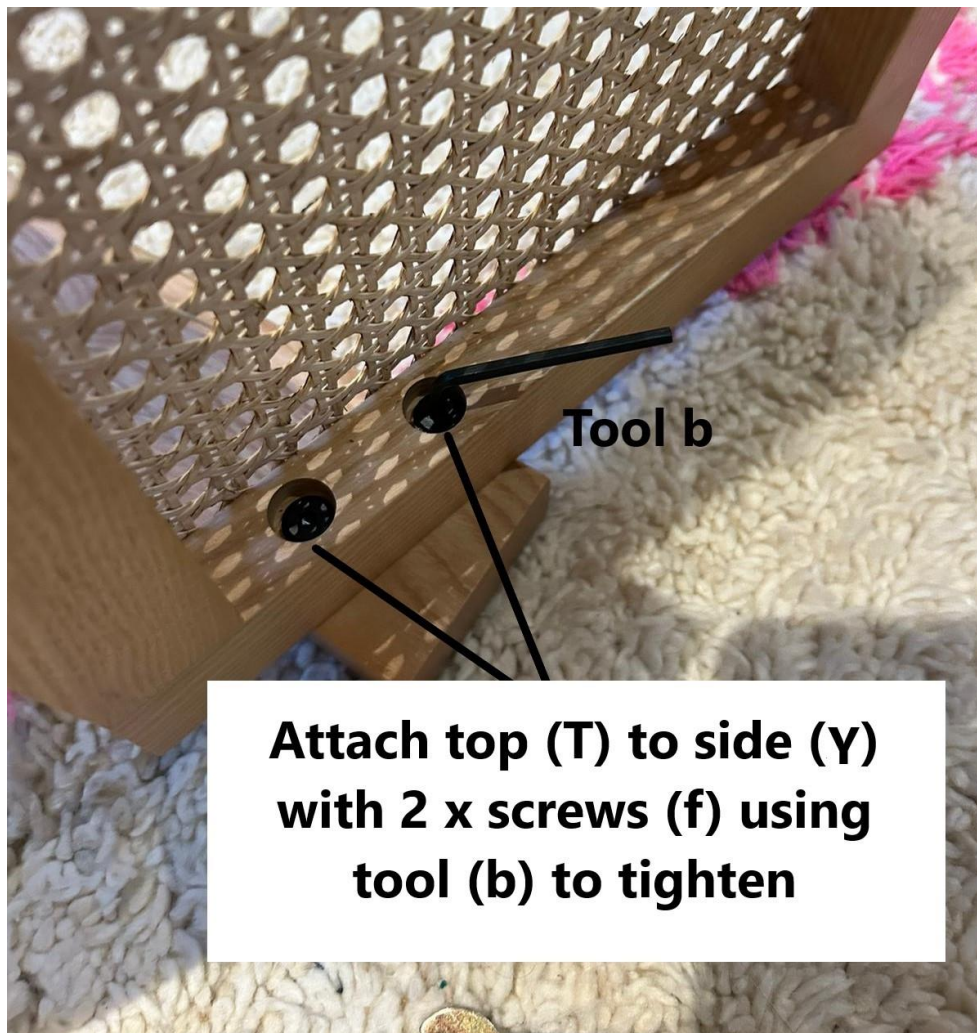

9. The Lali Dining Chair is now fully assembled. Please make sure all the screws and nuts are fully tightened using the tools (a) and (b) provided.

ENJOY!

