



Washer - Spinner - Dryer

USER'S MANUAL

Model: FP-92LFC100GMTH-W2
FP-92LFC120GMTH-W1

Read this Manual

Use all instructions and explanations on installation before use. Follow the instructions carefully. Keep the operation instructions handy for later use. If the product is sold or passed on then ensure that the new owner always receives this manual.



CAUTION: HOT SURFACE !



CAUTION: RISK OF FIRE !

CONTENTS

SAFETY INSTRUCTIONS

Safety Instructions	2
---------------------------	---

INSTALLATION

Product Description	8
Installation	9

OPERATION

Quick Start	12
Before Each Wash	13
Detergent Dispenser	14
Control Panel	16
Options	17
Other Functions	19
Programs	23
Washing Program Table	24

MAINTENANCE

Cleaning and Care	25
Troubleshooting	28
Technical Specifications	29

SAFETY INSTRUCTIONS

■ Safety Instructions

For your safety, the information in this manual must be followed to minimize the risk of fire or explosion, electric shock, or to prevent property damage, personal injury or loss of life. Explanation of the symbols:

Warning!

This combination of symbol and descriptive words indicates a potentially dangerous situation which may result in death or serious injuries unless it's avoided.

Caution

This combination of symbol and descriptive words indicates a potentially dangerous situation which may result in slight and minor injuries or damage to property and the environment.

Note

This combination of symbol and descriptive words indicates a potentially dangerous situation which may result in slight or minor injuries.

Warning!

Electric Shock!

- If the supply cord is damaged, it must be replaced by the manufacturer, its service agent or similarly qualified person, in order to avoid hazards.
- The new hose sets supplied with the appliance must be used and the old hose sets must not be used.
- Before maintenance, unplug the appliance.

SAFETY INSTRUCTIONS

- Always unplug the machine and turn off the water supply after use. The standard inlet water pressure: 0.05MPa~1MPa.
- This appliance must be grounded. In the event of malfunction or breakdown, grounding will reduce the risk of electric shock by providing a path of at least resistance for electric current.
- This appliance is equipped with a cord having an equipment-grounding conductor and grounding plug. The plug must be inserted into an appropriate outlet that is properly installed and grounded in accordance with all local codes and ordinances.
- Pull out its plug from the power socket before cleaning or maintenance.
- Do not use any socket with rated current less than that of appliance. Never pull out power plug with wet hands.
- Please remember to disconnect water and power supply immediately after the clothes are washed.



Risk to Children!

- The appliance can be used by children aged 8 years and above and persons with reduced physical, sensory or mental capabilities or lack of experience and knowledge if they have been given supervision or instruction concerning use of the appliance in a safe way and understand the hazards involved. Children shall not play with appliance. Cleaning and user maintenance shall not be done by children without supervision.
- Children of less than 3 years should be supervised to ensure that they do not play with appliance.
- Animals and children can climb on the machine. Check the machine before every operation.
- Children should be supervised that they do not play with the appliance.

SAFETY INSTRUCTIONS

- The glass door may be very hot during the operation. Keep children and pets far away from the machine during operation.
- Remove all the packaging materials and transport bolts before using the appliance. Otherwise, serious damage may result



Risk of Explosion!

- Do not wash or dry articles that have been cleaned in, washed in, soaked in, or spotted with combustible or explosive substances (such as wax, oil, paint, gasoline, degreasers, dry-cleaning solvents, kerosene, etc.) This may result in fire or explosion.
- The washer/dryer is not to be used if industrial chemicals have been used for cleaning.
- The exhaust air must not be discharged into a duct that is for exhausting fumes from appliances that burn gas or other fuels.
- Rinse the above mentioned articles thoroughly by hand before putting them in the appliance.



Caution

Installing the product

- This washing machine is for indoor use only.
- Its not intended for built-in use.
- The openings must not be obstructed by a carpet.
- The washing machine shall not be installed in the bathroom or very wet rooms with explosive or explosive and corrosive gases.
- The washing machine with a single inlet valve only can be connected to cold water supply.

SAFETY INSTRUCTIONS

- Plug must be accessible after installation.
- The appliance must not be installed behind a lockable door, a sliding door or a door with a hinge on the opposite side to that of the washer dryer.
- The appliance shall not be installed in humid places.
- This household appliance isn't intended for built-in installation.
- Remove all the packages and transport bolts before using the appliance. Otherwise, serious damage may result.

Risk of damaging the appliance!

- The product is only for home use and is only designed for the textiles suitable for machine washing and drying.
- Do not climb up the sit on top cover of the machine.
- Do not lean against machine door.
- Cautions during handling machine:
 1. Transport bolts shall be reinstalled to the machine by a qualified person.
 2. The accumulated water shall be drained out of the machine.
 3. Handle the machine carefully. Never hold protruding parts of the machine while lifting. Machined door cannot be used as the handle during the transport.
 4. This appliance is heavy. Transport with care.
 5. Hands shall not be inserted into the rotating drum.
- Please do not close the door with excessive forces. If it is found difficult to close the door, please check if the clothes are put in or distributed well.
- It is forbidden to wash carpets.

Operating the appliance!

SAFETY INSTRUCTIONS

- Before washing the clothes for the first time, the product should be operated without clothes, using AUTO CLEAN as the suggested program.
- Flammable and explosive or toxic solvents are forbidden. Gasoline and alcohol etc. shall not be used as detergents. Please only select the detergents suitable for machine washing, especially for front load washing machines.
- Make sure that all pockets are emptied. Sharp and rigid items such as coins, brooches, nails, screws, or stones, etc., may cause serious damages to this machine.
- Please check whether the water inside the drum has been drained before opening its door. Please do not open the door if there is any water visible.
- Be careful of being scalded when the product drains hot washing water.
- Never refill the water by hand during washing.
- After the program is completed, please wait for two minutes before opening the door.
- If it is unavoidable to tumble dry fabrics stained with vegetable/cooking oil contaminated by hair care products, the affected fabrics should first be washed in hot water with an extra amount of detergent. This will reduce the risk of combustion but not totally eliminate it.
- Adequate ventilation has to be provided to avoid the back flow of gases into the room from other gas-fed appliances, and open fires.
- Do not dry unwashed items in this appliance. Items that have been soiled with substances such as cooking oil, acetone, alcohol, petrol, kerosene, spot removers, turpentine, waxes, wax removers should be washed in hot water with an extra amount of detergent before being dried in the appliance.

SAFETY INSTRUCTIONS

- Items such as foam rubber (latex foam), shower caps, waterproof textiles, rubber backed articles and clothes or pillows fitted with foam rubber pads should not be dried in the machine.
- Fabric softener or similar products should be used as specified in the fabric softener instruction guide.
- The final part of a washer dryer cycle occurs without heat (cool down cycle) to ensure that the items are left at a temperature not harmful to clothing and textiles.
- Remove all objects from pockets (such as lighters and matches) before using the appliance.
- Warning: Never stop the machine before the end of the drying cycle, unless all items can be quickly removed and spread out so that the heat is dissipated.

INSTALLATION

■ Product Description

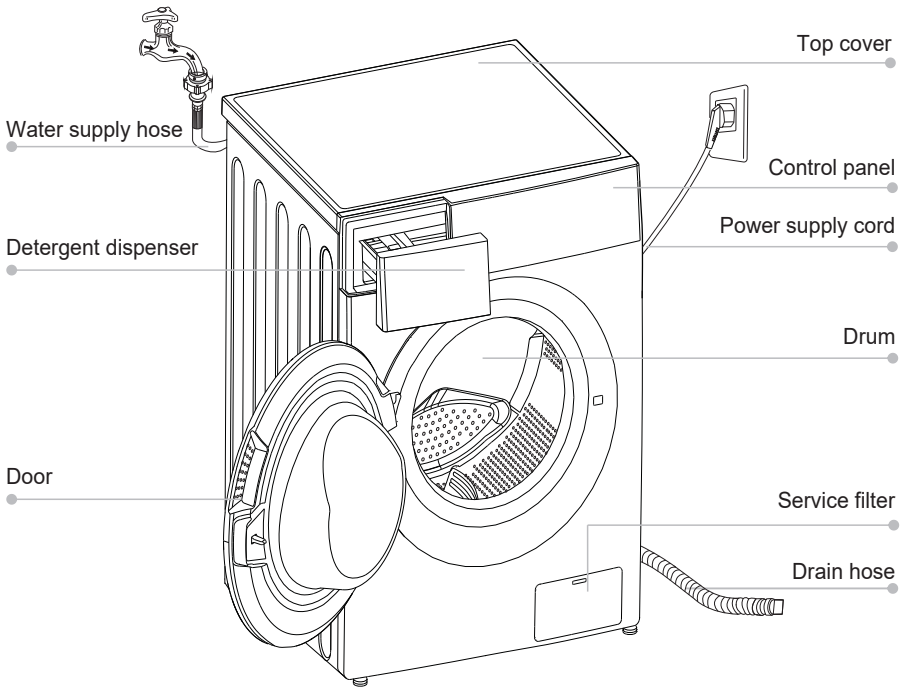

📌 Note

- The product line chart is for reference only, please refer to the actual product as standard.

Accessories

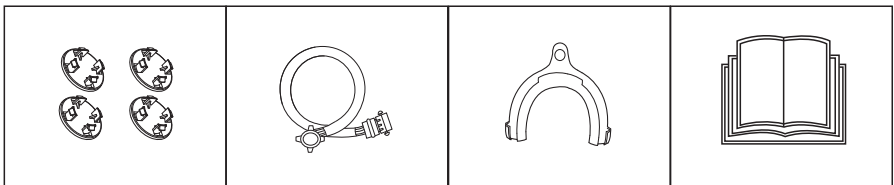

Transport hole plug

Supply hose cold water

Drain hose support (optional)

User's Manual

INSTALLATION

■ Installation

Installation Area



Warning!

- Stability is important to prevent the product from moving.
- Make sure that the product does not stand on power cord.

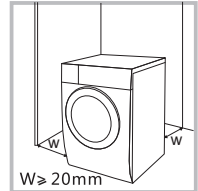

Before installing the machine, the location characterized as follows shall be selected:

1. Rigid, dry and level surface
2. Avoid direct sunlight
3. Sufficient ventilation
4. Room temperature is above 0°C
5. Keep away from the heat resources such as coal or gas.

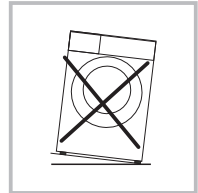

Unpacking the washing machine



Warning!

- Packaging material (e.g. films, Styrofoam) can be dangerous to children.
- There is a risk of suffocation. Keep all packaging materials well away from children.

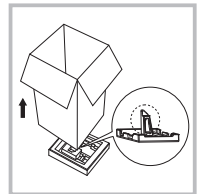

Remove transport bolts



Warning!

- You must remove the transport bolts from the back before using the product.
- You'll need the transport bolts again if you will transport the product, so make sure you keep them in safe place.

Please do the following steps to remove the bolts:

1. Loosen 4 bolts with spanner and then remove them.
2. Cover the holes with transport hole plugs
3. Keep the transport bolts properly, for future use.

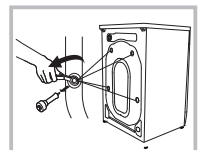

INSTALLATION

Levelling the washing machine

⚠ Warning!

- The lock nuts on all four feet must be screwed tightly against the housing.

1. Check if the legs are closely attached to the cabinet. If not, please turn them to their original position then tighten the nuts.
2. Loosen the lock nut then turn the feet until it closely contacts with the floor.
3. Adjust the legs and lock them with a wrench, make sure the machine is steady

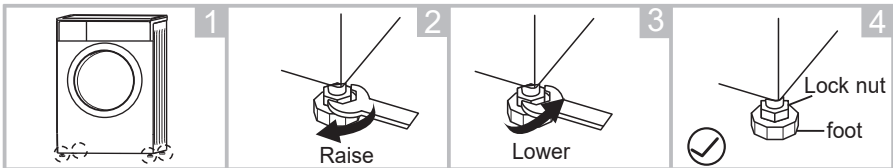

Connect Water Supply Hose

⚠ Warning!

- To prevent leakage or water damage, follow the instructions below. Do not kink, crush, modify or cut the water inlet hose.

Connect the inlet pipe as indicated, There are two ways to connect the inlet pipe.

1. Connection between ordinary tap and inlet hose.

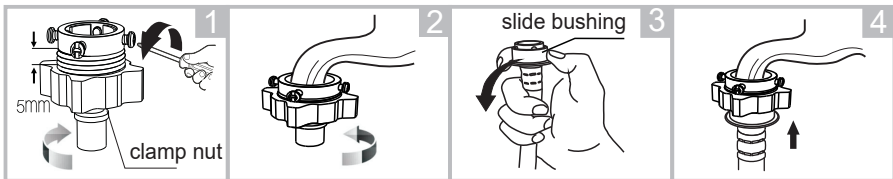

Loosen clamp nut and four bolts

Press the tap end against the rubber ring inside the clamp then tighten the 4 screws.

Press slide bushing, insert inlet hose into connecting base

Connection finished

2. Connection between screw tap and inlet hose.

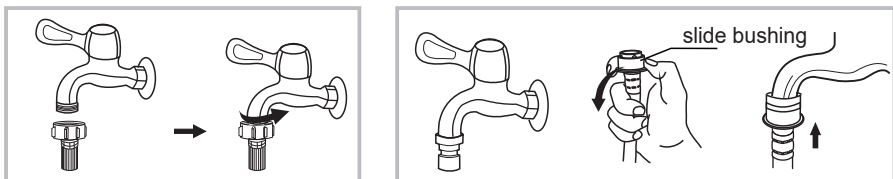

Tap with threads and inlet hose

Special tap for washing machine

INSTALLATION

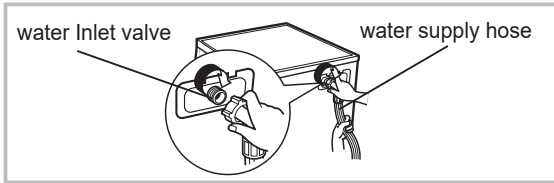

Connect the other end of inlet pipe to the inlet valve at the back of the product and fasten the pipe tightly clockwise.

Drain Hose



Warning!

- Do not kink or protract the drain hose.
- Position drain hose properly ,otherwise damage might result due to water leakage.

There are two ways to place the end of drain hose:

1.Put it into the floor drain.

2.Connect it to the pipe of the floor drain

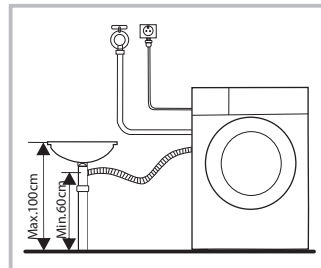
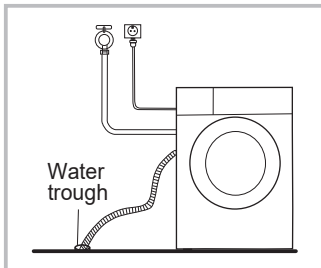

Note!

- If the machine has drain hose support, please install it as shown below.

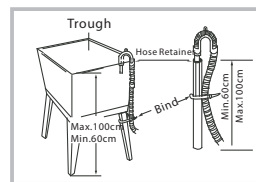
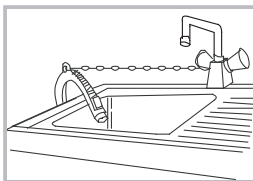

Warning!

- When installing drain hose, fix it properly with a rope.
- If drain hose is too long, do not force it into washing machine as it will cause abnormal noises.

OPERATION

■ Quick Start

⚠ Caution!

- Before washing, please make sure that the unit is installed properly.
- Before washing at first time, the washing machine shall be operated without clothes using RAPID (at SPEED WASH setting) as the suggested program.

1. Before Washing

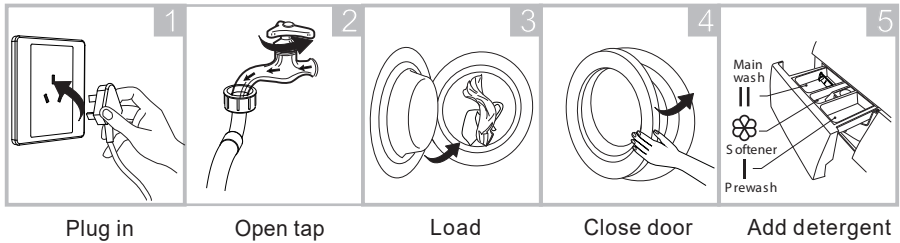

📌 Note!

- Detergent only needs to be added in "case I" after selecting pre-washing (for models with this function).

2. Washing

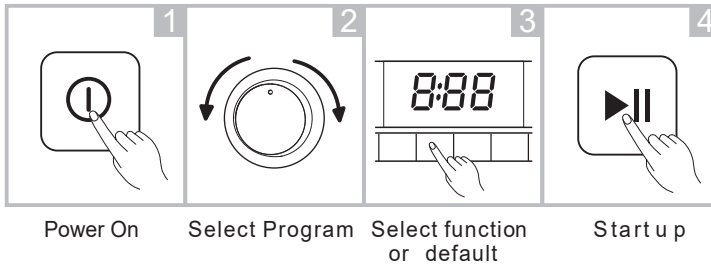

📌 Note!

1. If default is selected, step 3 can be skipped.
2. The function button's table is for reference only, please refer to the actual product as standard.

3. After Washing

The buzzer will sound or "END" will be displayed.

OPERATION

■ Before Each Wash

Please check the labels and the explanation of using detergent before wash. Use non-foaming or less-foaming detergent suitable for machine washing properly.

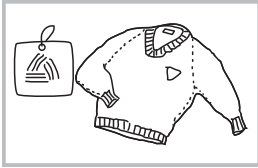

Check the label

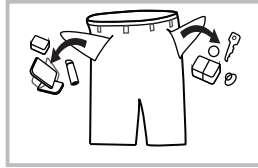

Take items out of the pockets

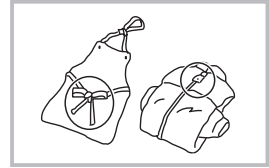

Tie tassels into knots; fasten zippers and buttons

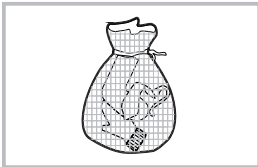

Put small clothes into a laundry net

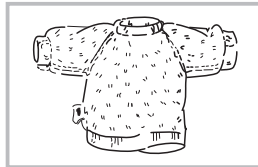

Turn the following clothes inside out: those that easily form fiber balls on its surface and those with long strands of fiber

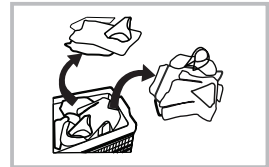

Segregate clothes with varying textures or materials



Warning!

Washing a single piece of clothing may cause severe unbalance and consequently sound alarm. In this case, it is suggested to add one or two more pieces of clothing to the wash load that will also make draining smoother. Do not wash clothes stained with kerosene, gasoline, alcohol, and other flammable materials.

OPERATION

■ Detergent Dispenser

- I Pre wash detergent
- II Main wash detergent
- ☼ Softener

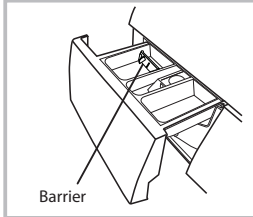

Liquid detergent

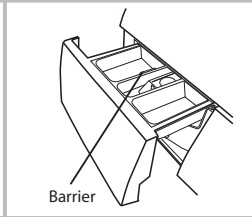

Powder detergent

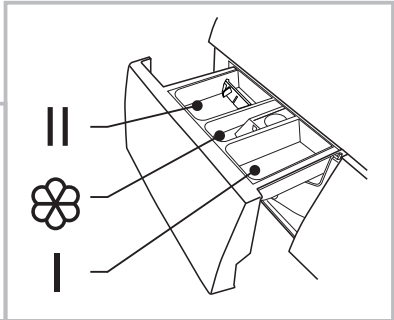

Pull out the dispenser

⚠ Caution!

Detergent only needs to be added in “case I” after selecting pre-washing (for models with this function).

OPERATION

Program			☼	Program			☼
ECO Wash		●	○	Dry Only			
Delicate		●	○	Cotton	○	●	○
Silent		●	○	Duvet		●	○
Antiallergic	●	●	○	Normal	○	●	○
Towel	○	●	○	Jeans	○	●	○
Shoes	○	●	○	Stain Wash	○	●	○
Auto Clean				Rapid		●	○
Spin Only							

● Means required ○ Means optional

Note!

- As for powder detergents that have formed into cluster or masses, it is suggested to dilute the detergent in some water, before pouring into the detergent box. This will prevent the inlet of the detergent box from clogging and water from overflowing during the filling process.
- Choose the suitable type of detergent for the various washing temperatures, to get the best washing effect with less water and energy consumption.
- Pay attention to whether the detergent has dried up in the dispenser, and clean the dispenser regularly especially when the washing machine is not used for long periods of time

OPERATION

Control panel

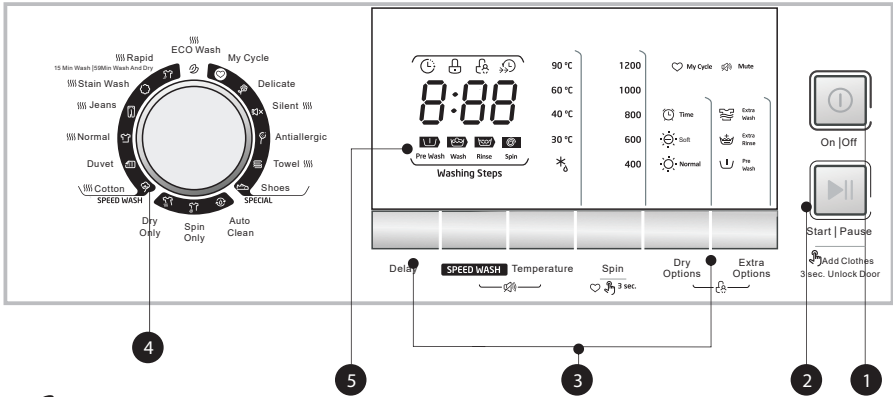

Note!

- The illustration for reference only, Please refer to the actual product as standard.
- The program with the icon has the Speed Wash option.

1 On/Off

Switches the product on or off.

2 Start / Pause

Press this button to commence or temporarily stop the washing cycle.

3 Option

This allows you to select an additional function that will light up when selected

4 Program

Available according to the laundry type.

5 Display

Shows the settings, estimated remaining time, options and status messages for your washer. The display will remain on throughout the cycle.

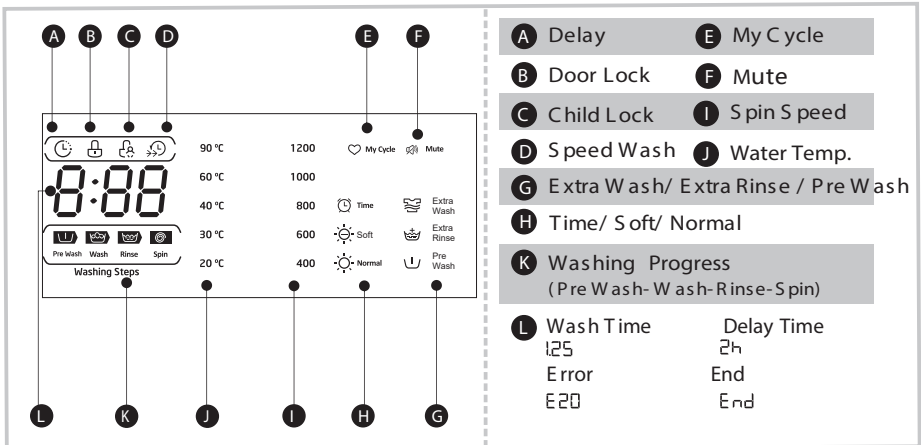

OPERATION

■ Options



PREWASH

The PREWASH function provides an extra wash before the main wash is executed. It's suitable for cleaning soiled clothes and needs detergent in case 1.



Extra Rinse

This setting provides an extra rinse, when selected.



Speed Wash

The function decreases the washing time.



DELAY

To set the Delay function:

1. Select program
2. Press the DELAY END button to choose the start time delay (the delay time is 0-24 hours).
3. Press [START/PAUSE] to commence the delay operation



ON/OFF



Choose the Program



Set the time



Start

To cancel the Delay function:

Press the DELAY button until the display becomes 0H. It should be pressed before starting the program. If the program has already started, the [ON/OFF] button should be pressed, to reset the program.



Caution!

If there is an interruption in the power supply while the machine is operating, a special memory stores the selected program and when the power is restarted, the machine will run the previous program automatically.



Extra Wash

This option is for very dirty clothes. The washing time and intensity increase, to also increase the washing performance.



Anti-crease

This can be used to reduce the wrinkles of clothes.



Soak

The clothes are soaked for 20 minutes after the drum is automatically filled with water up to the proper level.

OPERATION

Program	Option				
	Delay	Pre Wash	Extra Wash	Speed Wash	Extra Rinse
ECO Wash	<input type="radio"/>		<input type="radio"/>		<input type="radio"/>
Delicate	<input type="radio"/>				<input type="radio"/>
Silent	<input type="radio"/>				
Antiallergic	<input type="radio"/>	<input checked="" type="radio"/>	<input type="radio"/>		<input type="radio"/>
Towel	<input type="radio"/>	<input type="radio"/>			<input type="radio"/>
Shoes	<input type="radio"/>	<input type="radio"/>	<input type="radio"/>		
Auto Clean	<input type="radio"/>				
Spin Only	<input type="radio"/>				<input type="radio"/>
Dry Only	<input type="radio"/>				
Cotton	<input type="radio"/>	<input type="radio"/>	<input type="radio"/>	<input type="radio"/>	<input type="radio"/>
Duvet	<input type="radio"/>		<input type="radio"/>	<input type="radio"/>	<input type="radio"/>
Normal	<input type="radio"/>	<input type="radio"/>	<input type="radio"/>	<input type="radio"/>	<input type="radio"/>
Jeans	<input type="radio"/>	<input type="radio"/>	<input type="radio"/>	<input type="radio"/>	<input type="radio"/>
Stain Wash	<input type="radio"/>	<input type="radio"/>		<input type="radio"/>	<input type="radio"/>
Rapid	<input type="radio"/>			<input type="radio"/>	

● Means required

○ Means optional

OPERATION

Dry

Dry

Users can choose Soft drying, Normal drying and Timer drying when using the drying function.

Among them, Soft drying and Normal drying are conventional drying, and Timer drying offers customized drying time.

1. The drying function is only available for programs with drying symbol “☼”, as shown in instructions of the operation panel program.
2. Press the Dry button continuously to switch between between Normal drying, Soft drying and Timer drying. The default is Soft Drying.
3. Timer drying setting time: 30, 60, 120 , 180 (min)

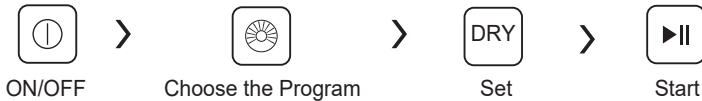

Other Functions



RELOAD

With this operation, the user can add pieces of laundry into the machine, even after washing has begun. At this point, however, the drum is rotating and there is a large amount of hot water in it. This is an unsafe condition and the door cannot be opened forcibly. To reload, press [START/PAUSE] for 3 seconds and follow the steps below.

- 1.Wait until the drum stops rotating.
- 2.The door will be automatically unlocked.
- 3.Open the door , add clothes to the drum, and close the door. Press the [START/PAUSE] button.

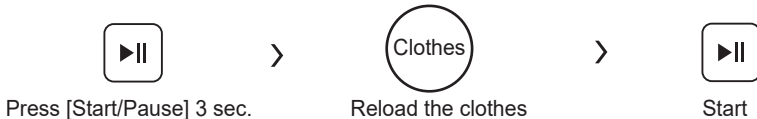

Caution

- Don't use the Reload function when the water level is over the edge of the inner tub or when the temperature is high.Please add clothes when the drum stops rotating.

OPERATION



My Cycle

Frequently – used programs can be stored here. After choosing the setting for your customized program, press [] for 3 seconds to store it in the memory. The default program stored is Cotton.



Child Lock

To avoid mis operation by children



ON/OFF



Start/
Pause



or



Press [Function] and [Select] or [Dry] and [Extra Options] 3 seconds until the buzzer beeps



Caution

- Press the two buttons also for 3 seconds, to deactivate CHILD LOCK.
 - The CHILD LOCK will lock all buttons except [ON/OFF]
 - When the power supply is cut, the CHILD LOCK function is deactivated
 - For some models, the CHILD LOCK will not be deactivated when the power supply is cut.
-



Temperature

Press the button to regulate the water temperature (Cold, 20°C, 30°C,40°C,60°C,90°C).



Speed

Press this button to change the spin speed.

OPERATION

Program	Default S speed(rpm)	Program	Default S speed(rpm)
	1200		1200
ECO Wash	800	Dry Only	1200
Delicate	600	Cotton	800
Silent	800	Duvet	800
Antiallergic	800	Normal	800
Towel	800	Jeans	800
Shoes	800	Stain Wash	1200
Auto clean	----	Rapid	1200
Spin Only	800		

! Caution

- When the lights of SPEED are off, it means that the spin process will not be executed.



To Mute the buzzer



ON/OFF



Press [Speed Wash] and [Temp.] button
for 3 seconds and the buzzer will be muted.

To activate the buzzer function, press the two buttons again for 3 seconds. This setting will be kept, unless deactivation is done again.

! Caution

- After Muting the buzzer function, the other control panel sounds will be deactivated.

OPERATION



Dry

Press the Dry button continually to choose the dry level:
Extra Dry / Normal Dry (Normal) / Gentle Dry (Soft) / Time / Air Dry

 Extra Dry: When you need to wear the clothes immediately after drying is finished

 Normal Dry: When clothes will be ironed and stored

 Gentle Dry: For light clothes

 Air Dry: Clothes are spun without heat, to remove peculiar smell



Time

Can be used when there are fewer clothes to be dried. The drying time settings to choose from are as follows (in minutes):

30, 60, 120, 180 and actual time that will be displayed will show an additional 10 minutes (for the default spinning time).

The corresponding drying capacity recommended per setting is as follows:
0.5kg , 1kg, 2kg, 3kg.

Note!

- Drying hints
 - Clothes should be dried after spinning.
 - To ensure proper drying, classify clothes according to fabric type and the drying temperature.
 - Be sure to set the proper drying time for synthetic fabrics/ textiles.
 - if you want to iron clothes, set shorter drying time, to retain a little moisture in your clothes
- Clothed not suitable for drying
 - Particularly delicate items such as synthetic curtains, wool, silk, garments with metal inserts, nylon stockings, bulky garments such as anoraks, bed covers, quilts, sleeping bags and duvets must not be machine dried.
 - Garments padded with foam-rubber or materials similar to foam-rubber must also not be machine dried.
 - Fabrics containing residues of setting lotions, hair sprays, nail solvents or similar solutions must not be machine dried, in order to avoid the formation of harmful vapors.



Option Confirm

Confirms selection of the Pre Wash, Extra Rinse, Extra Wash.

OPERATION

■ Programs

Programs are available according to the laundry type.

Program	Description
ECO Wash	Uses room-temperature water, preserving original colors, saving energy, and still delivering great cleaning performance
Delicate	For light, washable textiles such as silk, satin, synthetic fiber, or blended fabrics
Silent	In this program, the button sound is deactivated, thereby, allowing a relatively more quiet operation, especially late at night.
Anti-allergic	Uses 60°C water for sterilization and effectively kills some allergens
Towel	Designed to effectively wash the thick fabric of towels
Shoes	Can wash a pair of sneakers or other washable types of shoes
Auto-Clean	Cleans the inside and outside surfaces of the drum, with 90°C high-temperature water and without clothes loaded. When the proper amount of bleach is added, the cleaning effect will be better. This program may be done regularly or as needed.
Spin Only	May be used when an extra spin is needed or when spinning hand-washed clothes or those from other washing machines. There are several spin speeds to choose from.
Dry Only	For drying clothes that have just been spun. The drying time is automatically adjusted, based on the cloth load.
Cotton	For long-lasting textiles and heat-resistant textiles made of cotton or linen
Duvet	Especially designed to wash duvet coats
Normal	For daily-washable clothes, this program has a long washing period and a strong wash action. Recommended for washing daily cotton articles such as bed sheets, quilt covers, pillow cases, underwear, etc.
Jeans	Designed to effectively wash the thick and tough fabric of jeans
Stain Wash	Removes most stains from various types of clothing
Rapid	You can choose between a 15-minute wash only program or a 59-minute Wash and Dry (with heat) program.

OPERATION

■ Washing Program Table

Program	Washing/Drying Load (kg)		Temp.(°C)	Default Time(H)	
	10.0	12.0	Default	10.0	12.0
				1200	1200
☼ ECO Wash	2.0/2.0	2.0/2.0	Cold	0:58	0:58
Delicate	3.0	3.0	30	0:50	0:50
☼ Silent	10.0/7.0	12.0/8.0	60	2:10	2:10
Antiallergic	10.0	12.0	60	2:44	2:44
☼ Towel	10.0/5.0	12.0/6.0	60	1:45	1:45
Shoes	2.0	2.0	30	1:04	1:04
Auto Clean	-	-	90	1:18	1:18
Spin Only	10.0	12.0	-	0:12	0:12
☼ Dry Only	-/7.0	-/8.0	-	-	-
☼ Cotton	10.0/7.0	12.0/8.0	60	2:45	2:45
Duvet	2.5	2.5	40	1:27	1:27
☼ Normal	10.0/7.0	12.0/8.0	Cold	1:30	1:30
☼ Jeans	10.0/7.0	12.0/8.0	40	1:48	1:48
☼ Stain Wash	10.0/7.0	12.0/8.0	60	2:50	2:50
☼ Rapid	1.0/1.0	1.0/1.0	Cold	0:59	0:59

Note!

- The parameter in this table are for user's reference only. The actual parameters maybe different with those in above mentioned table.
- The programs with the ☼ icon have the dry function option.

MAINTENANCE

■ Cleaning and Care



Warning!

- Before proceeding with maintenance of the unit, disconnect the power plug and turn off the water supply.

Cleaning the Cabinet

Proper maintenance on the washing machine can extend its lifespan. The surface can be cleaned with diluted non-abrasive neutral detergents when necessary. If there is any water on the surfaces, use a piece cloth to wipe it off immediately. No sharp items are allowed to hit the cabinet.

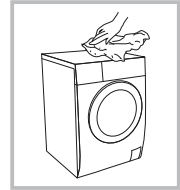

Note!

- Formic acid and its diluted solvents or equivalent are forbidden.

Cleaning the Drum

Rust (from metal articles) left inside the drum shall be removed immediately with chlorine-free detergents. Never use steel wool.



Note!

- Don't put laundry in the washing machine during the drum cleaning.

Cleaning the Door Seal And Glass

Wipe the glass and door seal after each wash, to remove lint and stains. If lint builds up, water leak may occur. Remove any coins, buttons, and other objects from the door seal after each wash.

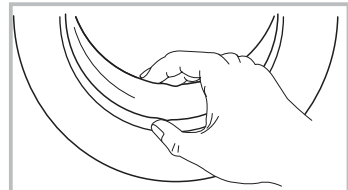

MAINTENANCE

■ Cleaning the inlet filter

Note!

- The inlet filter must be cleaned if the pressure of water flow into the unit decreases.

Washing the filter at the faucet side

1. Close the faucet.
2. Remove the water supply hose from the faucet
3. Clean the filter.
4. Reconnect the water supply hose

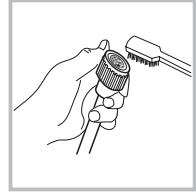
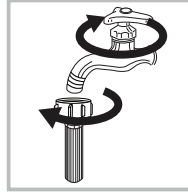

Washing the filter at washing machine side:

1. Remove the inlet pipe from the back of the machine
2. Pull out the filter with long nose pliers and reinstall it after washing.
3. Use a brush to clean the filter.
4. Reconnect the inlet pipe.

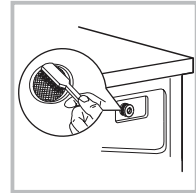
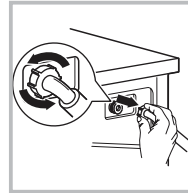

Cleaning the Detergent Dispenser

1. Press down the arrow located on softener cover inside the drawer.
2. Lift the clip, take out the detergent box and wash all compartments with water.
3. Put back the softener cover and push the drawer into position.

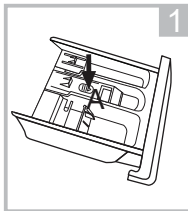

Pull out the dispenser drawer and press at "A".

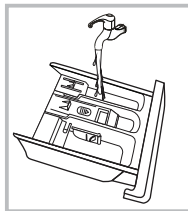

Clean the dispenser drawer with running water

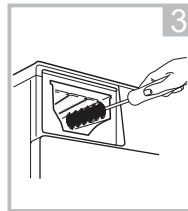

Clean the inside recesses with an old toothbrush

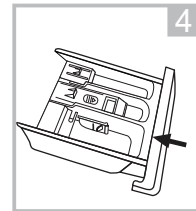

Insert the dispenser drawer.

Note!

- Do not use alcohol, solvents or chemical products to clean the machine.

MAINTENANCE

■ Cleaning the Drain Pump Filter

⚠ Warning!

- Beware of hot water!
- Allow detergent solution to cool down, before opening the service filter.
- Unplug the machine to avoid electrical shock before washing.
- The drain pump filter can collect thread strands and small foreign matter from the wash load.
- Clean the filter periodically to ensure the normal operation of the washing machine.

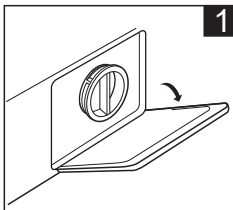

Open the lower cover cap

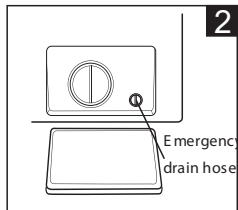

Rotate 90°C and pull out the emergency drain hose, and take off the hose cap

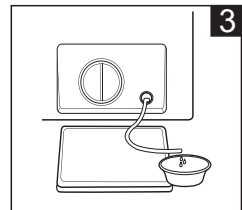

After water runs out, reset the drain hose

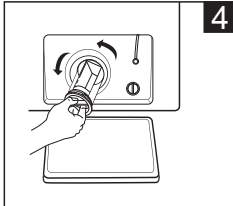

Open the filter by turning to the counter clockwise

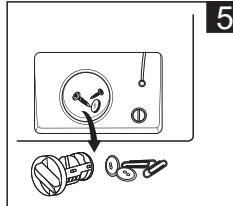

Remove extraneous matter

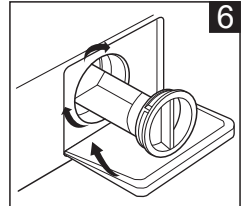

Close the lower cover cap

⚠ Caution

- Make sure that the lower cover cap and the emergency drain hose are reinstalled properly. The cap plates should be aligned with the hole plates, to avoid water leak.
- Some models do not have an emergency hose. Rotate the lower cover cap directly, to make water run into a basin or similar container.
- When the appliance is in use and depending on the program selected, there can be hot water in the pump. Never remove the pump cover during a wash cycle. Always wait until the appliance has finished the cycle and is empty. When putting back the cover, ensure that it is securely re-tightened, in order to prevent leaks and children from opening it.

MAINTENANCE

■ Troubleshooting

The appliance does not start or it stops during operation. Initially, try to find a solution to the problem. If there is none, contact the service center.

Description	Reason	Solution
Washing machine cannot start	Door is not closed properly.	Restart after the door is closed Check if clothes are stuck.
Door cannot be opened	Washer's safety protection design is activated.	Disconnect the power, restart the product.
Water leakage	The connection between inlet pipe or outlet hose is not tight.	Check and fasten water pipes. Clean the outlet hose.
Detergent residues in the dispenser	Detergent is damp or lumpy.	Clean and wipe the detergent box.
Indicator or display does not light up	Disconnect the power. PC board or wire harness has connection problem.	Check if the power is shut down and if the power plug is connected correctly.
Abnormal noise		Check if the transport bolts have been removed Check if it is installed on a solid and level floor.

Alarm indication	Reason	Solution
E30	Door is not closed properly	Restart after the door is closed Check if the clothes is stuck
E10	Water filling problem during washing	Check if the water pressure is too low. Straighten the water pipe. Check if the inlet valve filter is blocked.
E21	Draining exceeds time limit.	Check if the drain hose is blocked.
E12	Water overflow	Restart the washer.
EXX	Others	Try to look for a solution again then call for service if none is found

Note!

- After checking, turn on the appliance. If the problem occurs again, contact a service center.

MAINTENANCE

■ Technical Specifications

Maximum Current 10A

Standard Water Pressure 0.05 MPa~1MPa

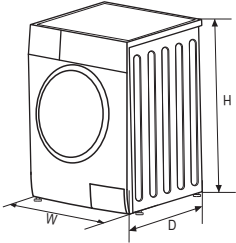

Model	FP-92LFC120GMTH-W1	FP-92LFC100GMTH-W2
Power supply	220V~, 60Hz	220V~, 60Hz
Washing Capacity	12.0kg	10.0kg
Drying Capacity	8.0kg	7.0kg
Dimension (W*D*H) mm	595*595*850	595*565*850
Weight	73kg	71kg
Rated Power	1800W	1800W
Drying Power	1200W	1200W