

RUNNING BOARD FOR RANGE ROVER

NOTICE:

- ≡ The figures here are for reference only and may have differences with the actual product you received, however they share the same assembly way.
- ≡ Please read the instruction completely for easy installation, which will also help you to avoid scratches or other potential damages to your appealing car.
- ≡ Please periodically check and retighten all the hardware and clean the investment for a refresh look.

PART LIST:

No.	Name	Qty	Remarks	No.	Name	Qty	Remarks
①	Running board	2		⑨	Flat washer	8	6mm
②	Front mount bracket	2		⑩	Spring washer	8	6mm
③	Rear mount bracket	2		⑪	Spacer Plates	2	M8
④	T-bolt	2	M8×35	⑫	Square bolt	4	M6×20
⑤	Flat washer(BIG)	2	8mm	⑬	Flat washer	4	6mm
⑥	Spring washer	2	8mm	⑭	Spring washer	4	6mm
⑦	Hex nut	2	M8	⑮	Hex bolt	4	M6
⑧	Hex bolt	8	M6×30	⑯	Support bracket	2	

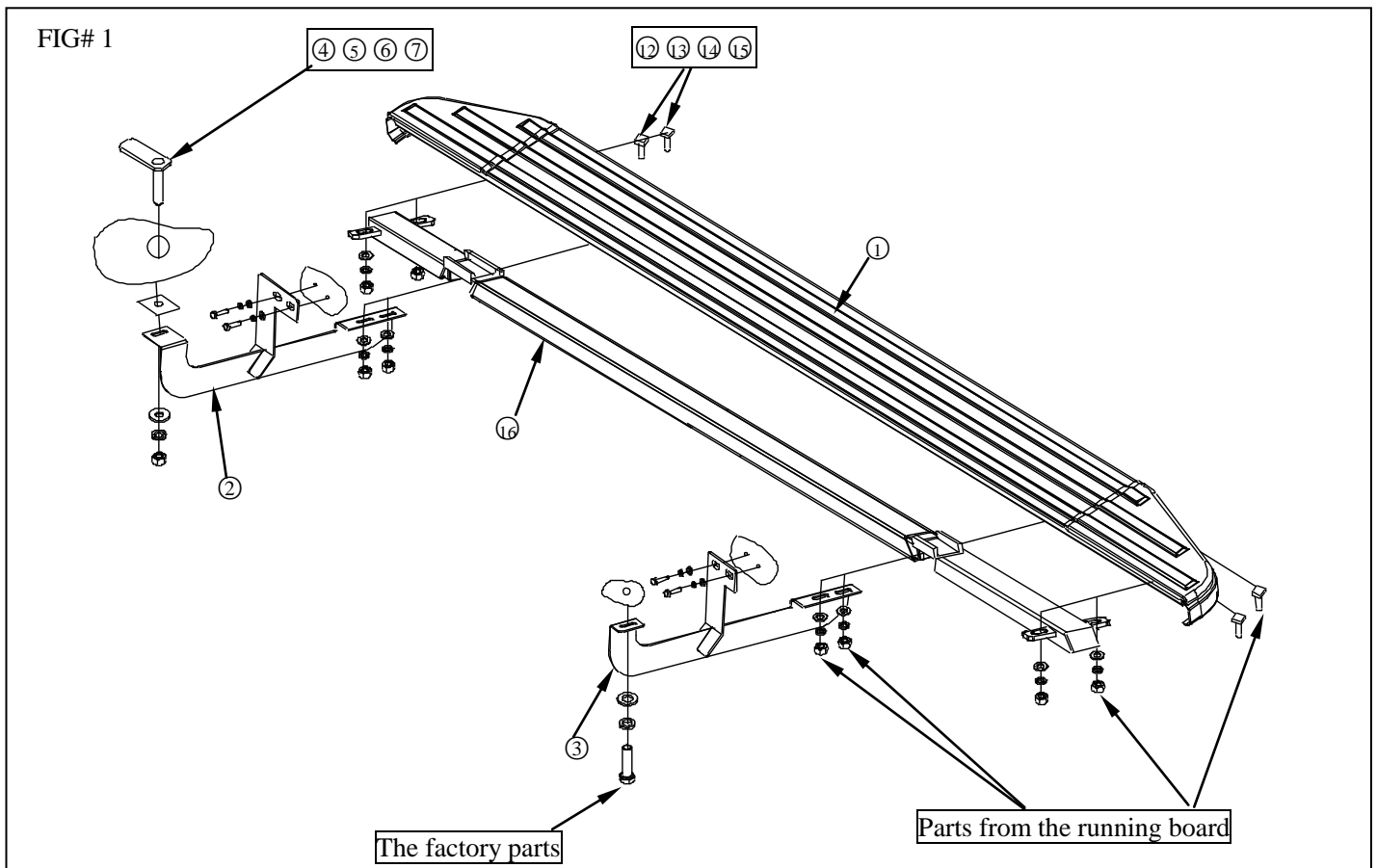



INSTALLATION INSTRUCTION
Part# PW003534
RUNNING BOARD FOR RANGE ROVER

ASSEMBLY PROCEDURE:

Step1: Check all the contents are available in accordance with the above list.

Step2: Remove the factory parts, and install mount brackets to the chassis as shown in fig# 1.

Step3: Loosen the both ends bolts of the running board, install the hardware ② in flute, and then install the hardware ③ in running board.

Step4: Install running board to the mount brackets as shown in fig# 1.

Step5: Test and make sure that the running board is steadily fixed.