

## **ADA HAND SINK ELITE, SINGLE STATION 24" = 2'- 0", WITH ELECTRONIC FAUCET**



### **ADA Commercial HAND SINK ELITE**

with brackets support system MODEL HS24210508EFBS

NSF & ETL Approved Fabrication

ADA compliant

SINGLE ADA STATION

Heavy duty **14 gauge (0.0781")** type 304 stainless steel

Interior and exterior surfaces brushed/polished finish

Seamless, fully welded corners

Dimensions: **24"L** x 21"W x 5"Deep

Back Splash Dimensions: **24"L** x 2"W x 7-3/4"H

Side Splash Dimensions: 18"L x 2"H, Double wall **14 gauge (0.0781")**  
with 3/16" w

Includes:

1 ADA Electronic Faucet

2 Stainless Steel Wall clip 3" x 4" **14ga (0.0781")**

2 Stainless Steel Brackets 8" x 11" x 1-5/8" **16ga (0.0625")**

1 Solid welded 1-1/2" NPT, schedule 40 Stainless Steel 304 plus a Welded Strainer

**14 gauge (0.0781")** Stainless Steel perforated screen.

10 2-1/2" Standard Screws for clips & brackets

1 ADA Sticker 2"x2"

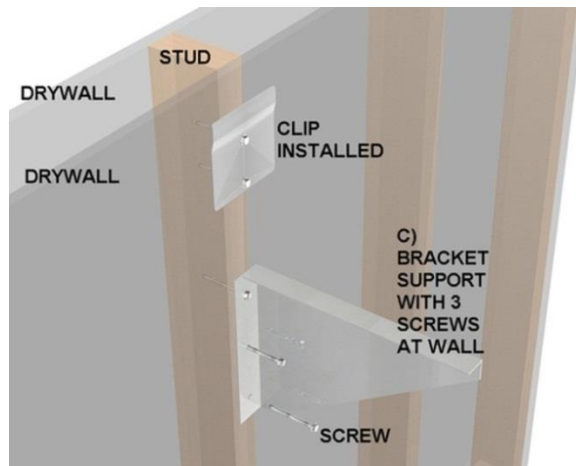

**WASH UP SINK INSTALATION**

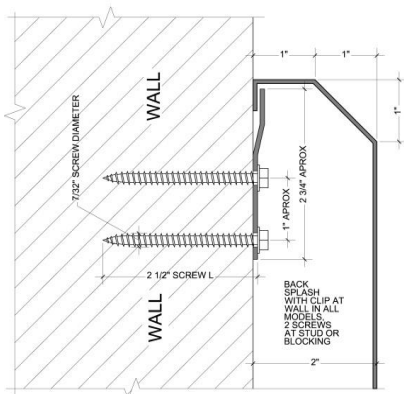

BACK SPLASH WALL ANCHOR WITH SS CLIP  
 CL  
 -  
 DETAIL

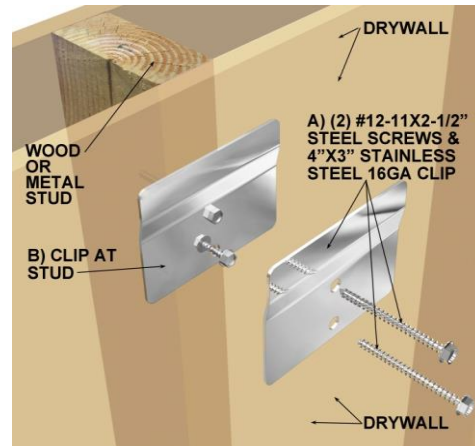

**ALL ITEMS INCLUDED:**



**ELECTRONIC FAUCET  
 MODEL:  
 BSM-K1**



**SOAP DISPENSER  
 MODEL: BSM-6322**

# SHOP DRAWING

