

PLUMBERS INSTALLATION INSTRUCTIONS

Important Information

- * Not suitable for gravity feed systems.
- * This handset (1) is fitted with flow regulator (2). This lower flow rate may not be suitable for connection to some gravity fed Water Heaters, low pressure supply networks, Instantaneous Water Heaters, Tempering Valves, Solar Water Heaters & Thermostatic Mixing Valves. Check with the manufacturers of these products.
- * All pipework must be thoroughly flushed prior to installation, as foreign materials may block the flow regulating device and reduce the flow of water.
- * Turn off hot and cold water supplies before installation.
- * Where showers incorporate flow controllers care must be exercised during installation to ensure that the male connecting threads do not damage flow controllers.

Installation

- 1) Ensure that the check valves (4) are fitted into handset (1) and the flat washer (5) is fitted into the conical end of shower hose (6), then screw the hose onto the outlet bracket(not shown) and handset (1).
Note: The Handshower spray can be adjusted between "Firm" and "Gentle" by sliding the slider up and down.

IMPORTANT

Pressure & Temperature Requirements.

- Hot and cold water inlet pressures should be equal.
- Static inlet pressure range : 150 -1000 kPa
New Regulation :-500 kPa maximum operating pressure at any outlet within a building.(Ref. AS/NZS 3500.1)
- Maximum hot water temperature : 80°C.

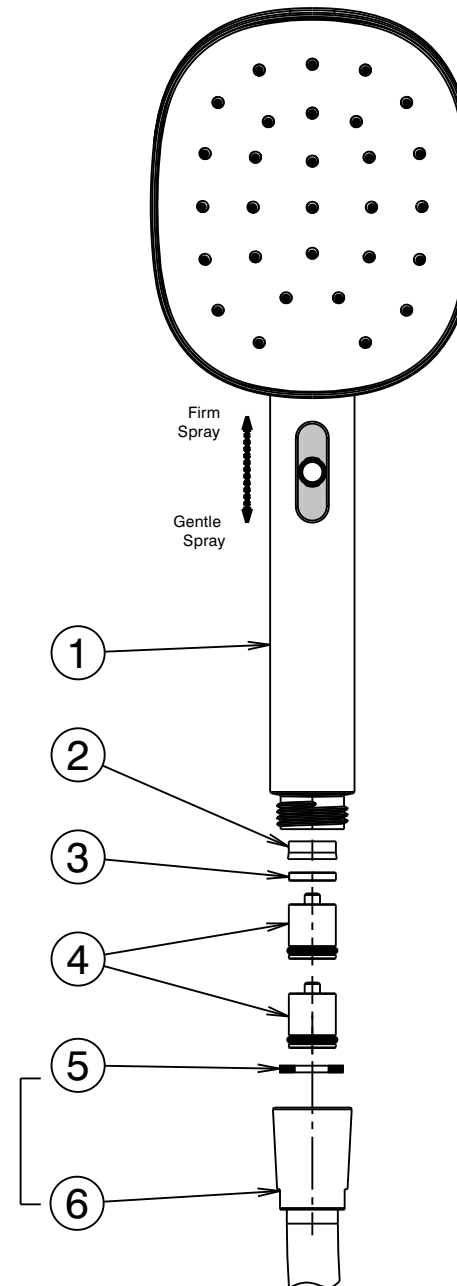

+ Not supplied