

# Zen SS316L Metal Shower Shelf

Nero

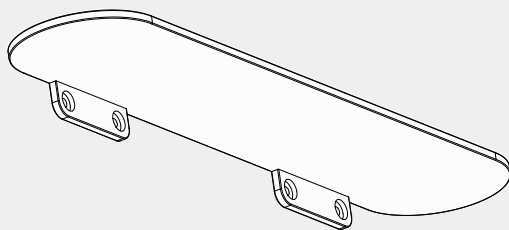

Versions:202405

25 YEARS WARRANTY  
**25**  
25 YEARS WARRANTY

## Drawing

## Features

## Packaging Includes

- 316L grade stainless steel construction for durability
- Easy to install

1x Metal Shower Shelf

## Finish & SKU

 **Brushed Bronze**  
NR1687aBZ

 **Graphite**  
NR1687aGR

 **Brushed Gold**  
NR1687aBG

 **Brushed Nickel**  
NR1687aBN

\*Dimensions are nominal measurements only.

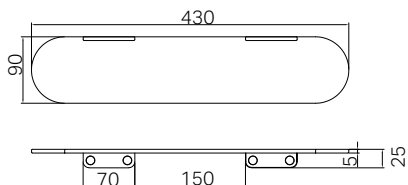

# Installation Instruction

## GENERAL PRECAUTIONS AND WARNINGS

- Before installation, make sure the wall surface is clean and dry to ensure a secure attachment.
- When tightening screws, do not apply excessive force to prevent damage to the wall or the fixtures.
- Use the correct tools: a drill with a 6mm bit, screwdriver, and level.
- Wear appropriate safety gear, such as gloves and safety glasses, to protect yourself during installation.
- Before drilling, check the wall for any hidden pipes or electrical wires to avoid accidental damage.
- Ensure all measurements are accurate before drilling holes to prevent misalignment of the accessories.

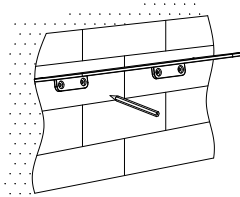

1. Place the towel bar in the desired installation position. Use a level to ensure the towel bar is horizontal. Mark the positions directly below the bases with a marking pen.

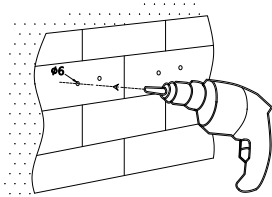

2. Position the fixing blocks at the marked spots. Mark the drilling points through the fixing block holes.

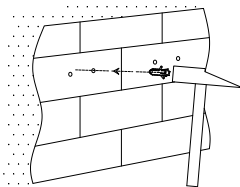

3. Use an electric drill with a 6mm drill bit to drill holes at the marked points.

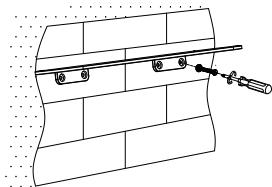

4. Insert the expansion plugs into the drilled holes using a hammer.

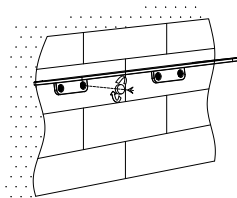

5. Place the fixing block covers over the holes and secure them firmly with expansion screws.