

**CABINET DETAILS**

|                    |                     |
|--------------------|---------------------|
| Range              | Nevada 1200         |
| Description        | Left Bowl Wall Hung |
| Cabinet SKU        | NEV-VCO-1200-L-X-W  |
| <b>TOP DETAILS</b> |                     |
| Available Tops:    | Waste Centres (mm): |
| Regal Acrylic      | 310                 |
| SilkSurface        | 320                 |
| Stone              | 320                 |
|                    |                     |
|                    |                     |

**Timberline Bathroom Products Pty Ltd**  
 22 Myrtle Drive, Armidale NSW 2350  
 www.timberline.com.au | 02 6773 8500

PLEASE NOTE: Due to the manufacturing process of ceramic tops, size variation (+/- 3%) is to be expected. E&OE. Copyright ©

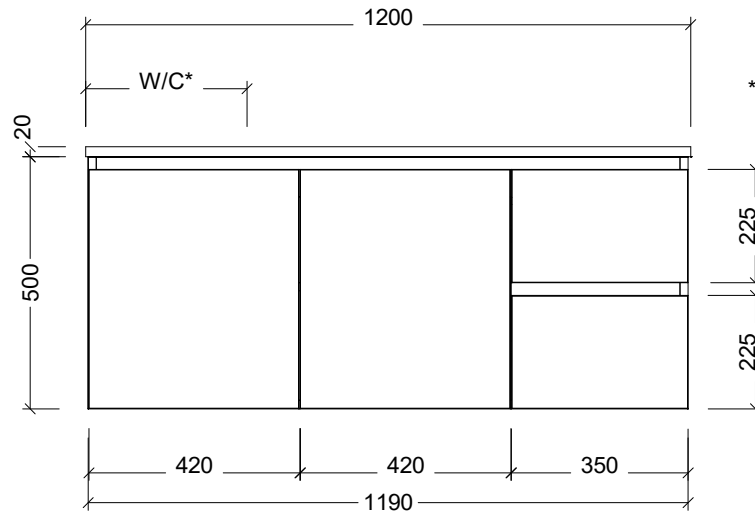

\*Refer to table for waste centre details

