

Note: This product must be installed by a Licensed Plumber. This is a general installation guide – factors may alter the installation method.

Ciara Hand Shower

Before Installation

Flush through the pipe work to ensure removal of debris.

Turn off the water mains and close any isolating valves.

Ensure the mounting surface is clean.

Installing the tap to the mounting deck

Check that threaded nipple (1) is the correct length. Cut to length if required ensuring end face is square. Apply thread tape to the thread.

Fit seal (2) into groove in base of cover plate (3).

Screw wall elbow (4) together with cover plate (3) onto threaded nipple (1) and position so that the hose (10) will hang vertically down. Do not over-tighten.

Ensure that check valve (6) is in position in wall elbow (4) and retained with circlip (7).

Check that rubber washers (8) are installed into shower hose fittings then screw hexagonal fitting (9) of shower hose (10) onto wall elbow (3) and tighten.

Screw remaining conical fitting (11) onto hand shower (5) and tighten.

Fit hand shower (5) onto holder (4a).

Hand shower holder inclination angle is adjustable by pivoting.

Note: If water does not flow from hand shower (5) make sure that check valve (6) is installed with the arrow pointing in the direction of flow.

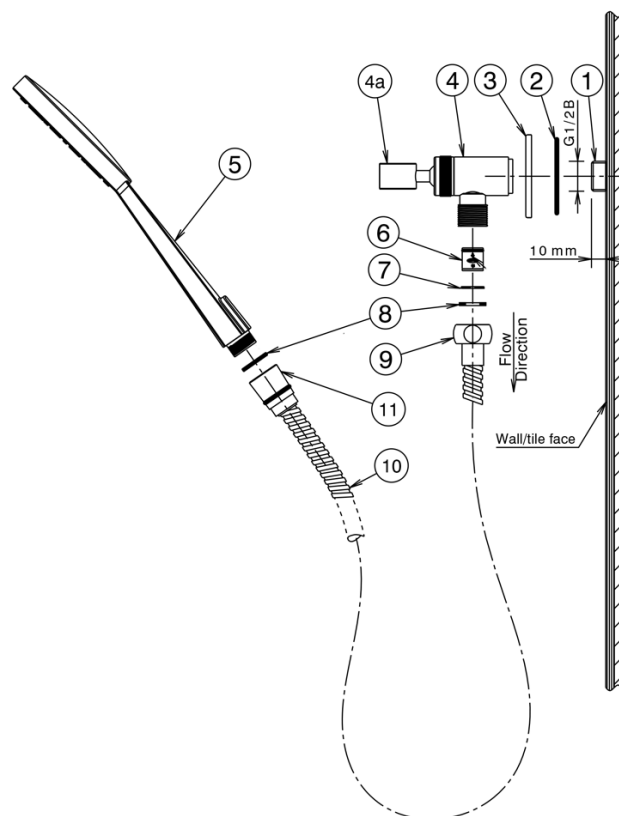

Turning on the supply

Turn on the water supply and check for leaks.

- 1 Threaded Nipple
- 2 Seal
- 3 Cover Plate
- 4 Wall Elbow
- 5 Hand Shower
- 6 Check Valve
- 7 Circlip
- 8 Rubber Washers
- 9 Hexagonal Fitting
- 10 Hose
- 11 Conical Fitting

Operating Pressure: Min. 150 – max. 1000kPa

For optimum performance, the hot and cold water pressure should be equal



Always use a soft, damp cloth with mild detergent to wipe your tap clean. Avoid using abrasive detergents, cleaning powders, scouring pads, strong disinfectants, cleaners containing hydrochloric acid or phosphoric acid as this will cause damage to the finish.